

How the Joints Work

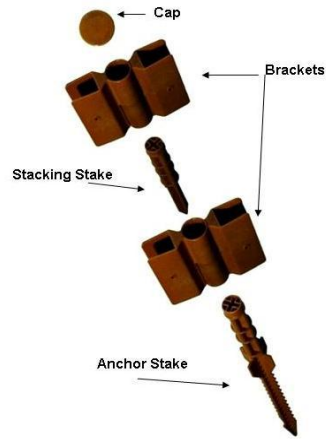
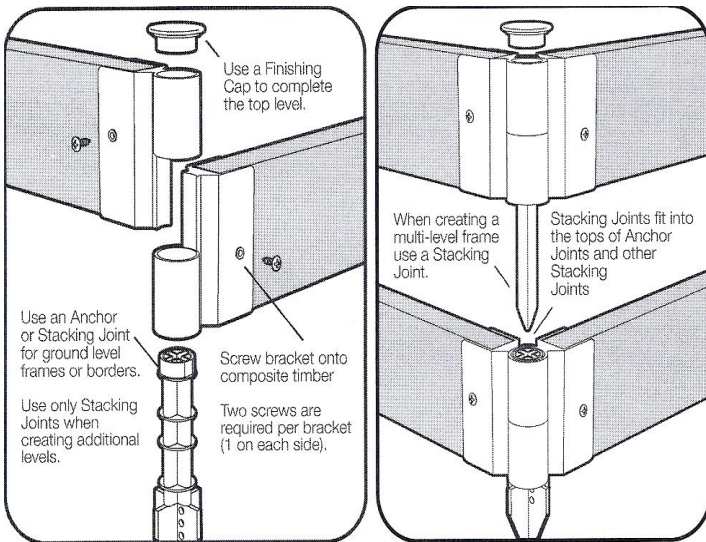

The Anchor/Stacking Joint Contains;

- 2 Stakes
- 4 Brackets
- 4 Caps
- 8 Screws

Tools Required:

Hammer or mallet, tape measure, Phillips screwdriver or screw gun.



Diagram 1-Fasten Brackets to sideboard



Diagram 2- They should look like this

1. **Preparing for installation:** Slide your Timber into the channel end of one of the brackets until it's centered and flush on all sides. Use the supplied screws to fasten the timbers to the bracket as shown in **diagram 1** (manually or with a screw gun). Repeat this process on the opposite end of the timber flipping the bracket in the opposite direction as pictured in **diagram 2** (this will save you time later when installing the timbers). Repeat this process until all of your timbers are fully bracketed on both ends.
2. **Installing Your Frame:** Layout base level of design with stake fins facing up as shown in **diagram 3**. Design adjustments should now be done if needed. Once desired position of base level is achieved, flip stake and hammer stakes into ground see **diagram 4** (**do not fasten cap unless level is finished**).
3. **Stacking Additional Levels:** If a multi-level design is desired, slide a stacking stake into all of the exposed tops of level 1 stakes and put the level 2 timbers in place until level 2 is complete see **diagram 5 & 6** (you can continue stacking additional levels until reaching your desired height).
4. **Finish:** To finish the appearance of each joint and to secure the brackets over the stake, push or tap the supplied caps into the tops of the stakes until they snap in place see **diagram 7**.



Diagram 3
Layout the base level



Diagram 4 - do not fasten caps unless level is complete



Diagram 5 -
Stack additional levels



Diagram 6 -



Diagram 7- Lock caps in place