

ASSEMBLY



Do not plug in the power cord until assembly is complete.

TOOLS NEEDED

- Two 6" adjustable wrenches
- 1.** Attach the tool box doors to the top of the sprayer as shown. Snap one peg into one of the orifices, and then snap the other peg into the other orifice. The pegs on the ends will snap into the orifices on the unit.
 - 2. METAL FRAME** - Attach the handle:
Line up the handle with the frame as shown. Push the snap buttons on each side and drop the handle into the frame. The snap-buttons will secure the handle into place.
 - 3. PLASTIC FRAME** - Attach the handle:
Align the handle to the tabs on the unit and press into place until it snaps (no snap buttons).



Plastic Frame - Do not attempt to remove the plastic handle once installed. Removal can damage the snap connection.

- 4.** Remove the plug from inside the hose fittings and remove the cap on the spray hose port. Discard both.

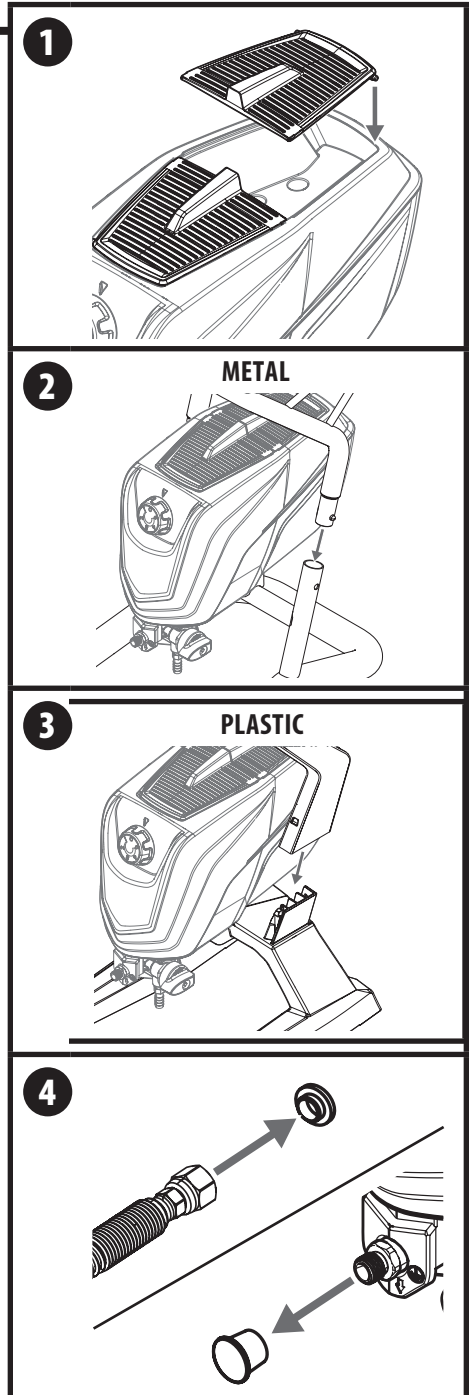

5. Thread one end of the high pressure spray hose to the spray hose port. Hold the port with an adjustable wrench, and tighten the hose with the other. Do not over-tighten.
6. Spin the gun onto the male fitting on the other end of the spray hose. Turning the gun instead of the hose will make it easier to align the threads. Tighten the hose end with a wrench.
7. Press the hose into the opening in the restraint at the bottom of the gun handle. The hose will flex slightly to fit through the smaller opening and then "pop" into place with no strain remaining on the hose.

 Attention	<p>Do not kink the hose when attaching it to the gun or when placing it into the restraint.</p>
---	---

8. Slide the suction tube onto the inlet valve. Secure with the suction tube clamp.
9. Press the return tube onto the return tube fitting. Squeeze hose clamp over the return tube fitting to secure the return tube.

