

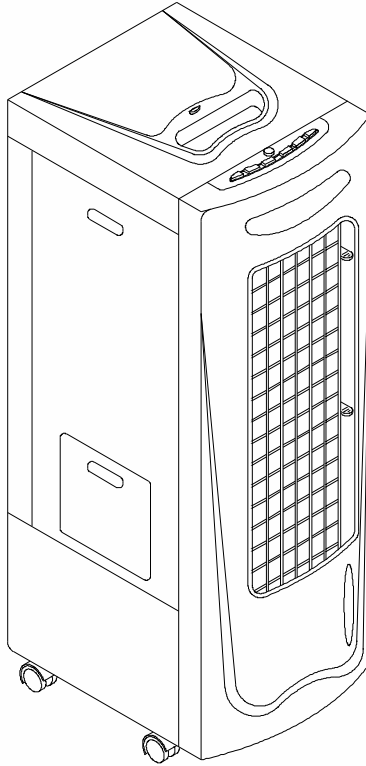

Instruction Manual  
**Evaporative Air Cooler**



It is important that you read these instructions before using your new cooler and we strongly recommend that you keep in a safe place for future reference.

**Model No. SF-610**

---

## CONTENTS

<b>A. PRODUCT INTRODUCTION .....</b>	<b>2</b>
<b>B. BRIEF INTRODUCTION OF FEATURES .....</b>	<b>2</b>
<b>C. CONTROL PANEL AND PARTS IDENTIFICATION .....</b>	<b>3</b>
<b>D. OPERATING INSTRUCTIONS AND FUNCTIONS .....</b>	<b>4</b>
<b>E. CARE AND MAINTENANCE .....</b>	<b>6</b>
<b>F. CAUTION .....</b>	<b>7</b>
<b>G. TECHNICAL PARAMETER .....</b>	<b>8</b>
<b>DEFECTIVE NOTICE .....</b>	<b>8</b>
<b>WARRANTY .....</b>	<b>9</b>

---

## **A、 PRODUCT INTRODUCTION**

The Evaporative Air Cooler is capable of providing various types of airflows: quiet and soft air like the spring breeze; fresh air simulating the Coastal breeze; cool, damp air like after a rainfall.

The different type of airflows will accommodate your needs to provide a comfortable environment and reduce the heat of summer. The humidifying function will help keep your skin in good condition. The Ionizer feature cleans the air for a pure and clean breathing space.

Thank you for purchasing SPT Evaporative Air Cooler. To have an in-depth understanding of the product and to ensure its proper usage, please read this instructions manual thoroughly, especially the relevant information marked Warning and Caution.

## **B、 BRIEF INTRODUCTION OF FEATURES**

1. High quality computer-controlled system.
2. Mechanical and full function remote control operation.
3. Features humidifier, air filter and Ionizer.
4. The composition of filter, water curtain and ionizer produces fresher air.
5. Supplies moisture to the environment in dry climates.
6. 0.5 to 7.5-hour timer.
7. Ice compartment for extra cooling.
8. Oxygen Bar with Negative Ions: Negative ions have the effect of cleaning the air, providing you a clean healthy surrounding.
9. Three air modes and three fan speeds to select from.
10. 120° oscillating sweep angle cools maximum space.
11. Energy efficient, input power of 60W.

## C、CONTROL PANEL AND PARTS IDENTIFICATION

### 1. Control panel and remote functions (Fig. 1)

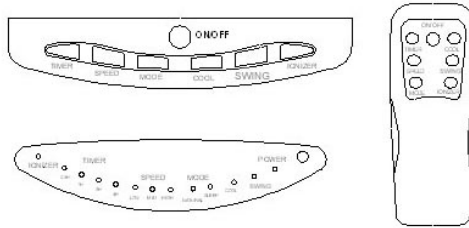

Fig1 (control panel)

### 2. Construction diagram. (Fig. 2)

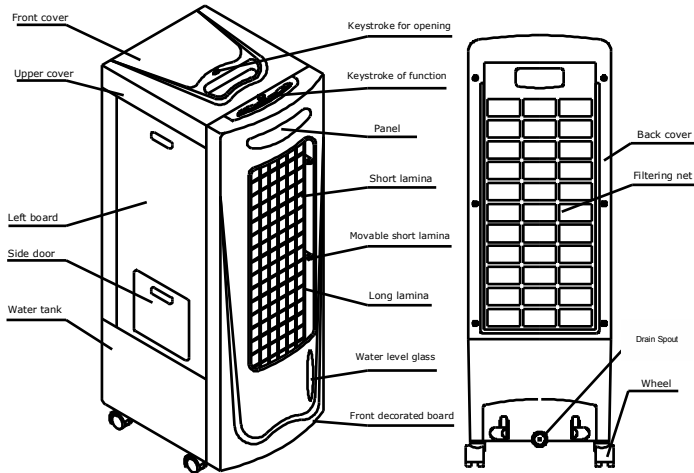

Fig2

### 3. Accessories included:

- Remote Control (1)
- Instruction Manual (1)

---

## D、 OPERATING INSTRUCTIONS AND FUNCTIONS

1. Unpack and remove all packaging materials.
2. Check contents and see that all accessories are included.
3. Place unit on a flat, sturdy surface. Make sure there is no tilt during operation.
4. Check the power supply and refer to the rating label at the back of the unit.
5. Functions:
  - ON/OFF: Press once to turn unit ON, Power indicator light will illuminate. Press again to turn unit OFF.
  - SWING: Press once to have the louvers swing automatically in a left-to-right motion, Swing indicator light will illuminate. The louvers will swing in continuous range of 120°. Press again to stop auto-swing for fixed air direction. To adjust vertical airflow, manually move the long Air Guide Blade up or down.
  - SPEED: Press to choose your desired fan speed, High – Medium – Low. The corresponding indicator light will illuminate.
  - TIMER: Press to set timer in increment of .5 hours from 0.5 to 7.5 hours. Indicator lights that illuminate add up to the set time. For example, a timer of 7 hours will have the following indicator light on: 1H, 2H and 4H. If timer is not set, unit will run continuously.
  - COOL: Press once to start the evaporative cooling function, COOL indicator light will illuminate. Make sure water is added before turning on this function. Unit will begin to cycle the water and blow cool, humidified air. Press again to stop this function and unit will run in normal fan mode. *Note: If water is not added or runs empty in Cool mode, unit will run as normal fan mode (but the Cool indicator light remains on). Once water is added, unit will run in COOL mode again.*
  - **MODE: Press to select one of three computer-controlled airflows. Unit starts in Normal mode (no indicator lights on). Press once for Natural mode (Natural indicator light will illuminate, this mode turns the fan on and off to simulate a outdoor breeze). Press again for Sleep mode**

---

(Sleep indicator light will illuminate, this mode works like Natural mode but it will lower the set fan speed after approximately 30 minutes if set on medium or high). You can select your desired fan speed in any of these modes.

- IONIZER: Press to turn on the ionizer function, Ionizer indicator light will illuminate. Unit will begin to release negative ions into the air. Press again to turn off this function.

**REMARK:** When unit is turned off the Power indicator and Ionizer indicator (if function was on) will stay lit. All settings will be resumed, except the timer, when powered back on.

6. Before running unit in COOL mode, add clean water through the Water Inlet or through the side door. Keep an eye on the Water Level Indicator and do not fill over the Maximum line. Water level can also be noted through the side door. The power supply should be disconnected before filling to prevent electrical parts from damage. For

maximum cooling, add ice directly into water tank through side door or in the top Ice Compartment. (Fig. 3 and 4)

When adding water or ice to the top compartment, add only into the corresponding box of "ICE ONLY" or "WATER ONLY". When water level runs low, near the MIN line, add water immediately to continue the cooling effect.

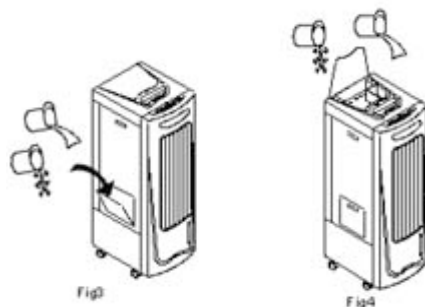

7. The remote control functions the same as those on the control panel. To use the remote, point the remote's infrared emitter towards the Evaporative Cooler. There should be no obstructions in between.

## E、 CARE AND MAINTENANCE

*Always unplug the unit before cleaning and maintenance.*

After a period of operation, the filter and water curtain may become clogged with dust or dirt, which will greatly affect the performance of the unit. It is recommended to clean the filter and water curtain once every two weeks.

- Clean exterior panels using a soft, damp cloth with a mild cleanser. Never use strong chemicals, oil-based products, detergent, chemically treated cloths or other strong cleaning solutions.

### Filter

1. Slide filter upwards to remove.
2. Clean with vacuum cleaner's brush attachment or wash under lukewarm water. Dry completely before replacing. (Fig. 5)

### Water Curtain

1. Remove 6 screws on the back panel (3 on each side). (Fig. 6)
2. Remove water tube connection at upper left corner (as you face the back of the unit).
3. Remove water curtain at **Velcro** closure.
4. Wash with warm water and gentle cleanser.



Abb.5

Abb.6

## STORAGE

If you do not plan to use the unit for a long period of time, drain out all water and clean the water tank, filter and water curtain. Operate the unit in normal fan mode for approx. 30~60 minutes. This will dry the interior and prevent mold growth. It is recommended to pack the unit in its original box and store in a dry, cool place.

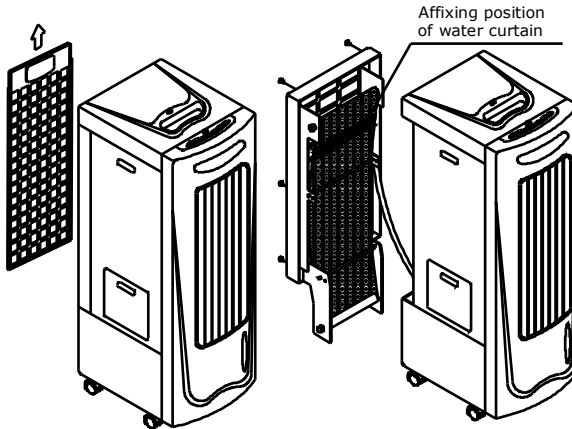
## F. CAUTION

1. Use standard supply of 120V / 60Hz. Plug unit into dedicated socket with rating of more than 3A. All sockets should comply with National Standards.
2. After filling with water, the Evaporative Cooler should not be tilted. If you need to move the unit, push gently and slowly on the side to avoid water spilling. (Fig. 8)
3. Do not place heavy objects on top of the unit. Do not obstruct the air outlet. Keep a minimum space of 6 inches around the unit. (Fig. 9)
4. Suitable ambient temperature range is 40°F ~ 100°F. When temperature is high, change water frequently to prevent mildew and mold growth.
5. Do not place unit under direct sunlight or near a heat source.
6. Never clean unit under running water or immerse unit under water. (Fig. 10)
8. Always unplug unit when not in use.
9. To avoid risk of shock, the product should never be used in bathrooms, shower rooms or other wet areas.
10. If the power cord is damaged, contact the manufacture or a qualified electrician.
11. Do not use the COOL function if unit is used in a damp and closed space.
12. Unplug unit before servicing or maintaining.
13. Never push fingers or objects into the louver. (Fig. 11)
14. Basic precautions should be taken when operating unit near young children.



Fig8



Fig9

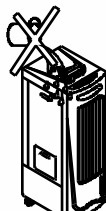

Fig10

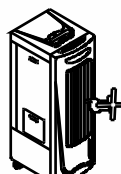

Fig11



---

## G、 TECHNICAL PARAMETER

Main technical parameter	
Rating voltage frequency	120V / 60Hz
Input power	60W
Water consumption	0.5-0.6L/h
Max air volume	≥20m/min
Fan Speeds	9
N. W.	16.5 lbs
Dimension	12.01 × 9.45 × 28.35 in.

### **DEFECTIVE NOTICE**

If this product is defective or not working properly  
Please DO NOT return to your retail store  
Please contact us directly with any Service or Technical Assistance  
Contact us toll free at:  
**SUNPENTOWN INTERNATIONAL INC.**  
**909-468-5288**  
**21415 Baker Parkway, City of Industry, CA 91789**



## **Evaporative Air Cooler**

(Model: SF-610)

### *Your Guarantee*

If this product is found to be faulty as a result of faulty materials or workmanship within one year from date of purchase, it will be repaired free of charge.

This guarantee is subject to the following terms:

- Sunpentown must be notified of the fault.
- Proof of purchase must be presented to Sunpentown's nominated representative.
- The warranty will be void if the product is modified, misused or repaired by an unauthorized person.
- The warranty after repair will not be extended beyond the original one-year period.
- All replacement parts will be new or reconditioned.
- Parts, which are replaced, become the property of Sunpentown.
- The warranty applies for the use of the product in the USA only.

What is NOT COVERED:

- Warranty does not include freight charges.
- Incidental or consequential damage caused by possible defects with this product.
- Damage to product caused by improper power supply voltage, accident, fire, floods or acts of nature.
- Failure of product resulting from unauthorized modifications to the product.
- Improper installation or failure to perform the necessary maintenance.

This GUARANTEE is in addition to your Statutory Rights