

88 5555 33

Biscayne Metal 42"x72" Oval Dining Table

IMPORTANT NOTE

Carefully remove all the parts from the carton and put them individually on a soft cloth to prevent scratches or other damages occurring to the parts.

We have taken great care in the design of this product and request that you carefully and strictly follow our assembly instructions to ensure a completed product as it was designed.

Home
Styles

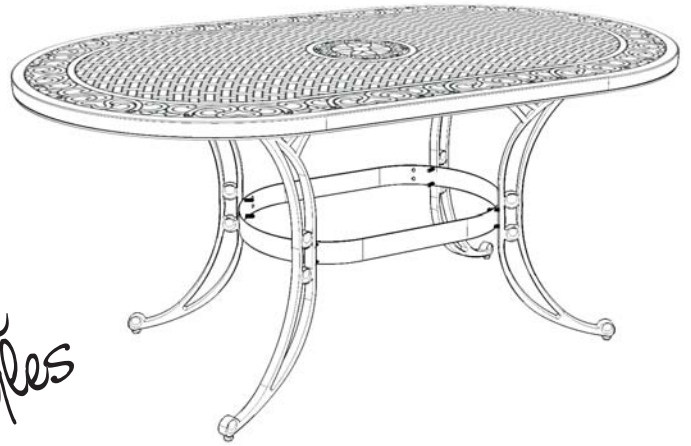

Part List

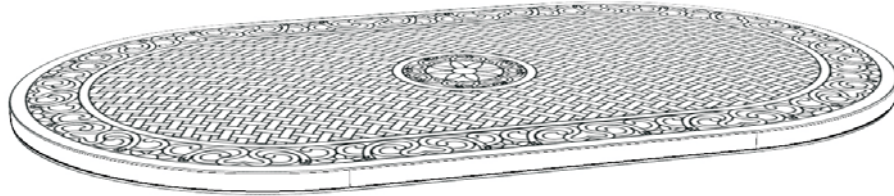

A.
Top
1 pc.

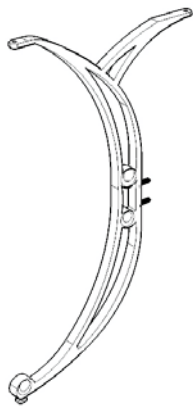

B.
Leg
4 pcs.

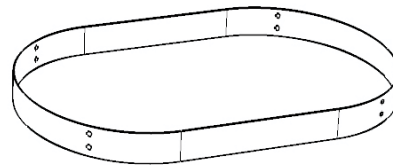

C.
Stretcher
1 pc.

Hardware List



Key Wrench
1 pc.



Spring
Washer
16 pcs.(+1 extra)



Nut
16 pcs.(+1 extra)



Bolt
8 pcs.(+1 extra)



Flat
Washer
16 pcs.(+1 extra)

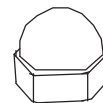

Nut Cap
16 pcs.(+1 extra)

Tools required for assembly : **Slotted** screwdriver

Tools recommended for assembly : Level

Home Styles Consumer Assistance Line 888-680-7460 and 877-831-0319

servicedesk@homestyles-furniture.com

Revised 17Mar2011

Assembly Instructions

IMPORTANT

- * Do not tighten up all the screws until each part is properly assembled.
- * You should keep Key Wrench in a safe place as you may need to tighten up the Head Cap Bolts in the future.
- * After assembly, item must be level to work properly. Use the included adjustable levelers to level.

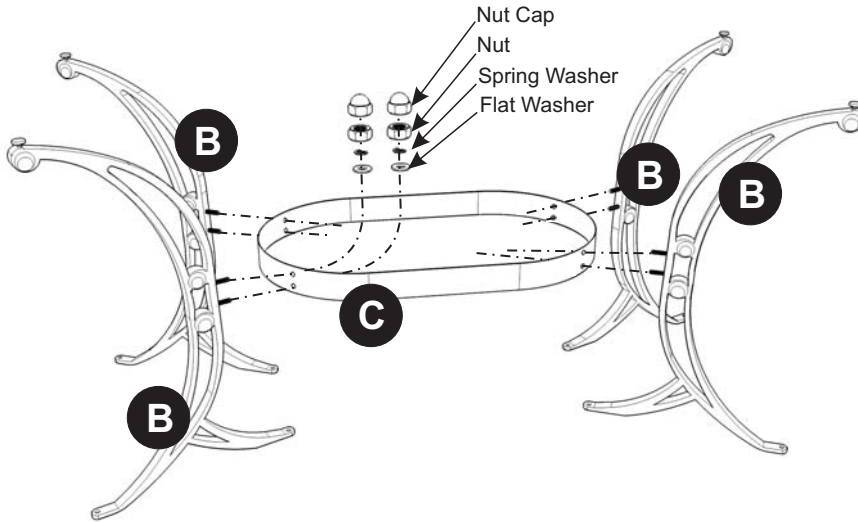

STEP 1

Attach Legs (B) to Stretcher (C) with Flat Washers, Spring Washers, Nuts and Nut Caps.

STEP 2

Place Top (A) upside down on a soft cloth.

Insert all Bolts into the pre-drilled holes of Top (A). (See figure 1)

Attach unit from Step 1 to Top (A) with Flat Washers, Spring Washers, Nuts and Nut Caps.

Nut Cap
Nut
Spring Washer
Flat Washer
Bolt

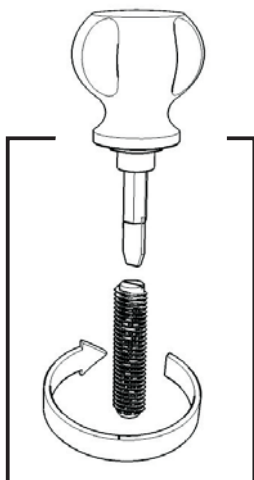
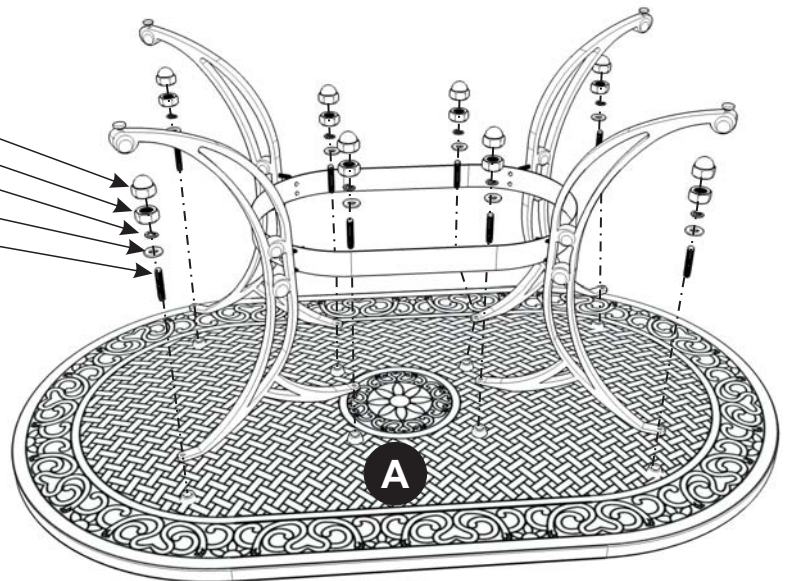

Figure 1

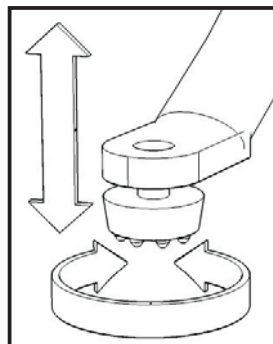

Figure 2

STEP 3

Turn the table to its' upright position.

To level the table, adjust the adjustable levelers on the bottom of legs. (See figure 2)