



GASOLINE / ELECTRIC GENERATOR 63CC 2 STROKE 2HP 1200W

ITEM: 65060



OWNER'S MANUAL AND SAFETY INSTRUCTIONS

SAVE THIS MANUAL: KEEP THIS MANUAL FOR SAFETY WARNINGS, PRECAUTIONS, ASSEMBLY, OPERATING, INSPECTION, MAINTENANCE AND CLEANING PROCEDURES. WRITE THE PRODUCT'S SERIAL NUMBER ON THE BACK OF THE MANUAL NEAR THE ASSEMBLY DIAGRAM (OR MONTH AND YEAR OF PURCHASE IF PRODUCT HAS NO NUMBER)

FOR QUESTIONS PLEASE CALL OUR CUSTOMER SUPPORT: 909.628.0880 MON-FRI 9AM TO 3PM PST



GENERAL SAFETY WARNINGS

Read all safety warnings and instructions. Failure to follow the warnings and instructions may result in electric shock, fire and/or serious injury. Save all warnings and instructions for future reference.

SAFETY

The warnings, precautions, and instructions discussed in this instruction manual cannot cover all possible conditions and situations that may occur. It must be understood by the operator that common sense and caution are factors which cannot be built into this product, but must be supplied by the operator. Read carefully and understand all **ASSEMBLY AND OPERATION INSTRUCTIONS** before operating. Failure to follow the safety rules and other basic safety precautions may result in serious personal injury.

SET UP PRECAUTIONS:

- Gasoline fuel and fumes are flammable, and potentially explosive. Use proper fuel storage and handling procedures. **DO NOT** store fuel or other flammable materials nearby.
- Have multiple ABC class fire extinguishers nearby.
- Operation of this equipment may create sparks that can start fires around dry vegetation. The operator should contact local fire agencies for laws or regulations relating to fire prevention requirements.
- Set up and use only on a flat, level, well ventilated surface.
- Wear ANSI-approved safety goggles and heavy-duty work gloves during set up.
- Use only oil and fuel recommended in the “Specifications” section of this manual.

OPERATING PRECAUTIONS:



Carbon Monoxide Hazard Using a generator indoors CAN KILL YOU IN MINUTES. Generator exhaust contains carbon monoxide. This is a poison you cannot see or smell.



NEVER use inside a home or garage, **EVEN IF** doors and windows are open. Only use **OUTSIDE** and far away from windows, doors, and vents.

- Keep all safety guards in place and in proper working order at all times.
- **NEVER** place fingers, hands, or body near the Generator when it is running. **DO NOT** lean or reach over the Generator when the machine is running.
- Keep all people (except the operator) a minimum of six feet from the Generator during operation.

IMPORTANT SAFETY INFORMATION

- **DO NOT** transport the Generator with the Engine running
- **DO NOT** sit or stand on this machine.
- **DO NOT** tilt the machine while the Engine is running.
- Wear ANSI-approved safety goggles, hearing protection, and heavy duty work gloves during use.
- People with pacemakers should consult their physician(s) before use. Electromagnetic fields in close proximity to a heart pacemaker could cause pacemaker interference or pacemaker failure. Caution is necessary when near the engine's magneto or recoil starter.
- Use only accessories that are recommended by XtremePowerUS for your model. Accessories that may be suitable for one piece of equipment may become hazardous when used on another piece of equipment.
- **DO NOT** operate in explosive atmospheres, such as in the presence of flammable liquids, gases, or dust. Gasoline-powered engines may ignite the dust or fumes.
- Stay alert, watch what you are doing and use common sense when operating this piece of equipment. **DO NOT** use this piece of equipment while tired or under the influence of drugs, alcohol or medication.
- **DO NOT** overreach. Keep proper footing and balance at all times. This enables better control of the equipment in unexpected situations.
- Dress properly. **DO NOT** wear loose clothing or jewelry. Keep hair, clothing and gloves away from moving parts. Loose clothes, jewelry or long hair can be caught in moving parts.
- Parts, especially exhaust system components, get very hot during use. Stay clear of hot parts.
- **DO NOT** cover the Generator during operation.
- Use the equipment, accessories, etc., in accordance with these instructions and in the manner intended for the particular type of equipment, taking into account the working conditions and the work to be performed. Use of the equipment for operations different from those intended could result in a hazardous situation.
- **DO NOT** operate the equipment with known leaks in the Engine's fuel system.
- This product contains or, when used, produces a chemical known to the State of California to cause cancer and birth defects or other reproductive harm. (California Health & Safety Code § 25249.5, et seq.)
- When spills of fuel or oil occur, they must be cleaned up immediately. Dispose of fluids and cleaning materials as per any local, state, or federal codes and regulations. Store oil rags in a bottom ventilated, covered, metal container.
- Before use, check for misalignment or binding of moving parts, breakage of parts, and any other condition that may affect the equipment's operation. If damaged, have the equipment serviced before using. Many accidents are caused by poorly maintained equipment.
- Use the correct equipment for the application. **DO NOT** modify the equipment and do not use the equipment

IMPORTANT SAFETY INFORMATION

SERVICE PRECAUTIONS:

- Before service, maintenance, or cleaning: a. Turn the Power Switch of the Engine to its “OFF” position. b. Allow the Engine to completely cool. c. Then, remove the Spark Plug.
- Keep all safety guards in place and in proper working order. Safety guards include muffler, air cleaner, mechanical guards, and heat shields, among other guards.
- Do not alter or adjust any part of the equipment or its Engine that is sealed by the manufacturer or distributor. Only a qualified service technician may adjust parts that may increase or decrease governed Engine speed.
- Wear ANSI-approved safety goggles and heavy duty work gloves during service.
- Have the equipment serviced by a qualified repair person using only identical replacement parts. This will ensure that the safety of the equipment is maintained. Do not attempt any service or maintenance procedures not explained in this manual or any procedures that you are uncertain about your ability to perform safely or correctly.
- Do not smoke, or allow sparks, flames, or other sources of ignition around the equipment, especially when refuelling.
- Do not refill the Fuel Tank while the engine is running or hot.
- Do not fill Fuel Tank to the top. Leave a little room for the fuel to expand as needed.
- Refuel in a well-ventilated area only.
- **CAUTION:** This generator is not intended to power sensitive electronic equipment* without the addition of an appropriate line conditioner and surge protector (both not included). Sensitive electronic equipment should be operated on approved inverter type generators or pure sine wave generators.
- If the plugged in product operates abnormally or unusually slow, immediately stop using the generator as a power source. Always read and adhere to the instruction manual of the product to be powered, to make sure that it can be safely and efficiently powered by a portable generator.
- **NOTE:** When using a generator to provide home standby electricity, a transfer switch (sold separately) is needed to prevent back feeding power into the utility line.
- Connections for standby power to a building electrical system must be made by a qualified electrician. The connection must isolate the generator power from utility power, and must comply with all applicable laws and electrical codes.
- **WARNING:** Improper connections to a building electrical system can allow electrical current from the generator to backfeed into the utility lines. Such backfeed may electrocute utility company workers or others who contact the lines during a power outage, and the generator may explode, burn, or cause fires when utility power is restored. Consult the utility company or a qualified electrician.



SAVE THESE WARNINGS

APPLICATIONS

1. Before connecting an appliance or power cord to the generator: Make sure that it is in good working order. Faulty appliances or power cords can create a potential for electrical shock.
2. If an appliance begins to operate abnormally, becomes sluggish or stops suddenly, turn it off immediately. Disconnect the appliance, and determine whether the problem is the appliance, or if the rated load capacity of the generator has been exceeded.
3. Make sure that the electrical rating of the tool or appliance does not exceed that of the generator. Never exceed the maximum power rating of the generator. Power levels between rated and maximum may be used for no more than 30 minutes.
4. Substantial overloading will open the circuit breaker. Exceeding the time limit for maximum power operation or slightly overloading the generator may not switch the circuit breaker or circuit protector OFF, but will shorten the service life of the generator.

GENERATOR PRECAUTIONS:

1. Do not connect the Generator directly into a home's utility electrical line. Do not plug this Generator into an outlet in the home. Connecting a generator directly to a utility power supply can "back feed" along the power lines and kill or injure utility workers working on the lines.
2. All connections and conduits from the Generator to the load must only be installed by trained and licensed electricians, and in compliance with all relevant local, state, and federal electrical codes and standards, and other regulations where applicable.
3. The Generator must be earth-grounded in accordance with all relevant electrical codes and standards before operation. A 10-gauge copper wire should be used to connect the ground terminal of the Generator to a grounding rod. A wire that is too thin may not provide sufficient electrical current carrying capacity to be an adequate ground path.

The other end of the ground wire must be securely fastened to an approved ground source. (See Figure A.) Refer to local regulations for ground source information. If unsure of regulations or procedures, obtain assistance from a licensed or certified electrician.

4. Insulate all connections and disconnected wires.
5. Connect the Generator only to a load or electrical system (120 V~) that is compatible with the electrical characteristics and rated capacities of the Generator.
6. Set up the Generator outdoors in a wellventilated, dry area, away from building air intakes. The Generator should be protected from direct exposure to rain and snow. Do not set up the Generator on a conductive surface such as a metal deck.

FIGURE A

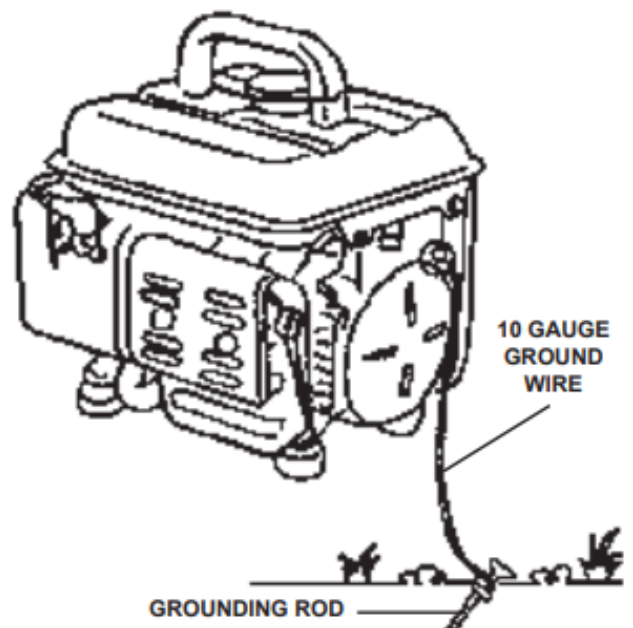

OPERATION

- DO NOT** attempt to connect or disconnect load connections while standing in water, or on wet or soggy ground.
- DO NOT** touch electrically energized parts of the Generator and interconnecting cables or conductors with any part of the body, or with any non-insulated conductive object.
- Use only Class BC or Class ABC fire extinguishers on electrical fires.
- DO NOT** overload the Generator. Overloading can cause fires in the electrical cords, in addition to Generator and appliance damage.

THIS UNIT CAN POWER THE FOLLOWING:

ITEM	RUNNING WATTS	START-UP WATTS
Ten 75 Watt Light Bulbs	750	
1/4HP Compressor	600	900
1/6HP Motor	500	800
3/8" Drill	400	600
Mini Refrigerator	400	700
15 Amp Battery Charger	380	
String Trimmer	350	500
Table/Box Fan	200	300
Radio	50	

BASIC SPECIFICATIONS:

Fuel	Required Mixture (50:1)	50 Parts 89+ octane unleaded gasoline mixed with 1 part 2-cycle oil
	Capacity	1.1 Gallons

NOTE: Wattages listed above are estimates for that type of equipment only. Check nameplate wattages on all loads before connecting to Generator.



To prevent serious injury: Operate only with proper spark arrestor installed. Operation of this equipment may create sparks that can start fires around dry vegetation. The operator should contact local fire agencies for laws or regulations relating to fire prevention requirements.

STARTING THE ENGINE:

Inspect the Generator looking for damaged, loose, and missing parts before set up and starting. If any problems are found, do not use the unit until properly repaired.

CAUTION! Your Warranty is **VOID** if the Engine's Fuel Tank (73) is not filled with the proper mixture (50:1) of unleaded gasoline and 2-cycle oil before each use. Before each use, check the fuel level. **DO NOT** run the Engine with an improper unleaded gasoline/2-cycle oil mixture. Running the Engine with an improper mixture **WILL** permanently damage the Engine.

- The Fuel Tank (73) holds approximately 1 gallon of fuel.
- To obtain the proper gasoline and 2-cycle oil mixture, mix 2.5 fluid ounces of 2-cycle oil with 1 gallon of unleaded gasoline into an approved container. Then slowly shake the container to thoroughly mix the gasoline/2-cycle oil. (See Figure B)
- Remove the Fuel Tank Cap (76) and check the fuel level. (See Figure C)

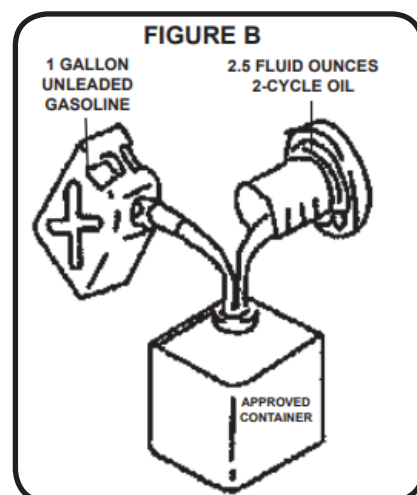

OPERATION

4. To fill the Fuel Tank (73), first wipe off the Fuel Tank Cap (76) and the surrounding area. (See Figure C).
5. Unscrew, and remove the Fuel Tank Cap.
6. Remove the Strainer (74) and remove any dirt and debris. Then replace the Strainer.
7. Fill the Fuel Tank (73) to about 1 inch under the fill neck of the Tank with the pre-mixed unleaded gasoline/2-cycle oil mixture.
8. Then replace the Fuel Tank Cap.

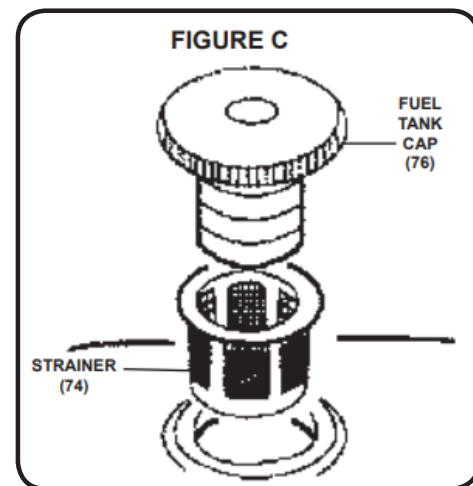

BEFORE STARTING THE ENGINE:

A. Inspect the Generator and Engine. **B.** Fill the Fuel Tank (73) with the proper amount and type of unleaded gasoline and 2-cycle oil. **C. NOTE:** Only after the Generator has stabilized and is running smoothly should an appliance or tool be plugged into the AC Outlet of the Generator.

1. Turn the Engine Fuel Switch (80) to its “OPEN” position. (See Figure D).
2. Turn the Engine Choke Lever (82) to its “CHOKE” position. Set the Choke Lever in the “RUN” position when starting a warm Engine. (See Figure E).
3. Then turn the Engine Power Switch to its “ON” position. (See Figure F).
4. Grasp the Recoil Starter Handle (42) and pull slowly until resistance is felt. While holding the Handle, allow the Starter Rope to rewind slowly. Then, pull the Starter Handle with a rapid, full arm stroke. Once again while holding the Handle, allow the Rope to rewind slowly. Repeat as necessary, until the Engine starts. (See Figure G).

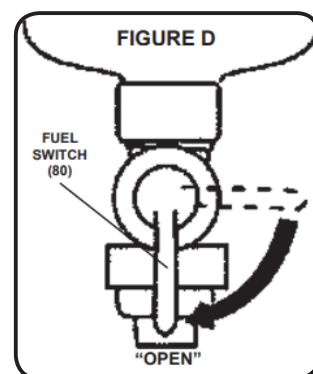

5. After the Engine starts and warms up, slowly move the Choke Lever (82) to its “RUN” position. (See Figure H).

5. IMPORTANT: Allow the Engine to run at no load until warm (approx. 3 minutes) after each start-up to allow the Engine to stabilize.

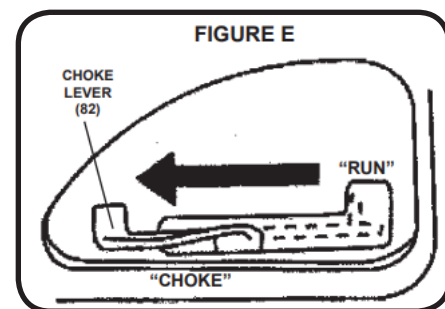

BREAK-IN PERIOD:

4. Breaking-in the Engine will help to ensure proper equipment and Engine operation, and will extend the Engine’s lifespan. The warranty is void if the Engine is not broken in properly. The first 25 hours of operation is the break-in period.

During this time frame, **DO NOT** exceed 75% of the Generator’s load limit. In other words, the maximum load during this break-in period should be no more than 600 watts.

After the first 25 hours of use: Change the unleaded gasoline/2-cycle oil fuel mixture.

Under normal operating conditions subsequent maintenance follows the schedule explained in the Maintenance and Servicing section.

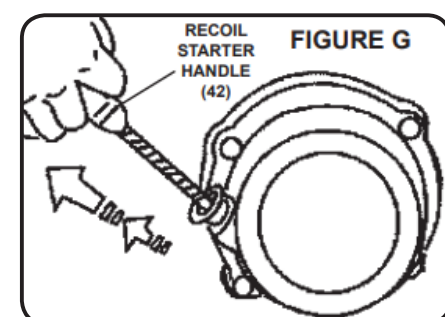
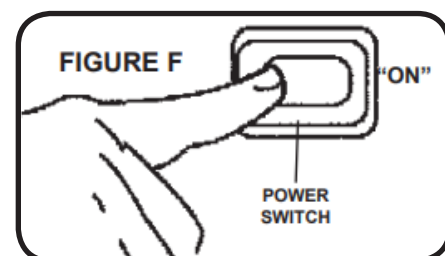

OPERATION

LOAD AND CIRCUIT BREAKER:

1. The total combined load through the outlet on the Generator must not exceed the rated maximum power (1200 watts) of the unit.
2. Always reduce the load if the AC Circuit Breaker turns off. Once the load is reduced, press the Breaker to reset the Generator and continue operation. (See Figure I).

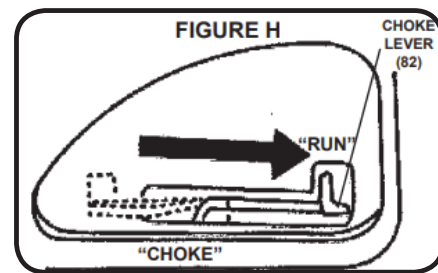

CALCULATING POWER DRAW:

Power draw can be calculated by multiplying volts and amps. The resulting number is wattage. Never exceed the rated maximum wattage (1200) for the Generator or outlet. Long power cords and extension cords draw additional power. Keep cord length at a minimum.

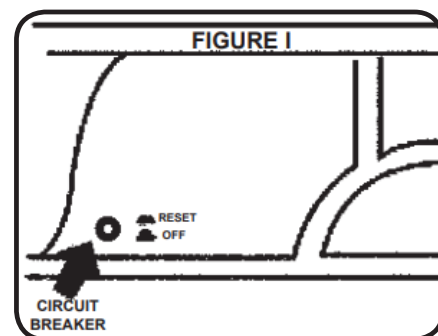

AC APPLICATION:

1. Allow the Engine to run at no load until warm (approx. 3 minutes) after each start-up to allow the Engine to stabilize.
2. Plug the power cord of the 120 volt appliance/tool into the 120 volt AC Outlet on the Generator. (See Figure J).

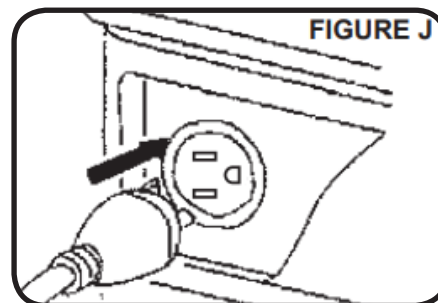

NOTE: DO NOT allow the generator to completely run out of fuel with devices attached. A generator's output may sharply spike as it runs out of fuel, causing damage to attached devices.

3. When finished using the appliance/tool, unplug its power cord from the AC Outlet on the Generator. (See Figure K).

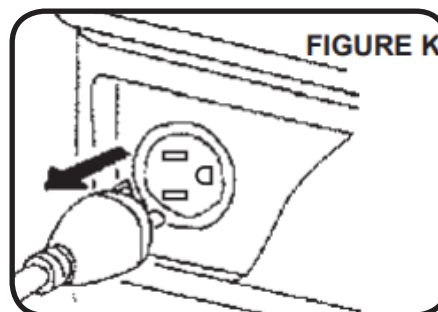

GENERATOR SHUT OFF:

1. Remove all electrical load devices from the Generator. (See Figure K)
2. Allow the Engine to run for approximately 3 minutes with no electrical load.
3. Turn off the Generator's Power Switch to stop the Engine. (See Figure L)
4. Turn the Fuel Switch (80) to its "OFF" position. (See Figure M)
5. Allow the Generator to completely cool before storing.

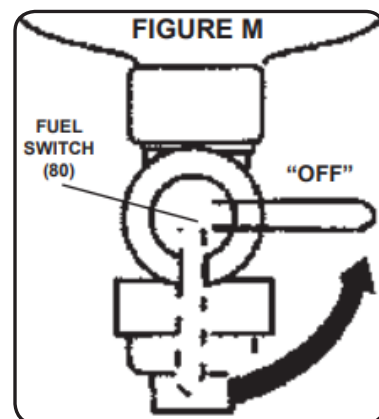
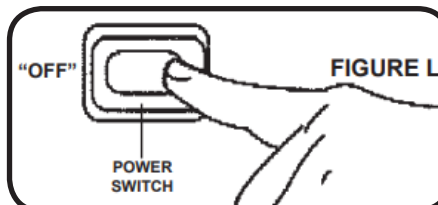

OPERATION

CONNECTION:

1. Wind the lead two to three times around the handle and start the engine.
2. Plug into an AC socket.
3. Connect the red lead (included) to the positive (+) terminal and the black lead to the negative (-) terminal.



SAFETY FEATURES:

Press to reset the AC or DC protector. Reduce the load within the rated output if the AC and DC protector (if equipped) turns off.

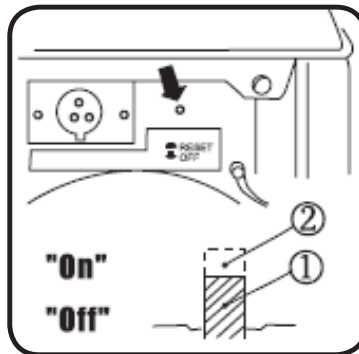
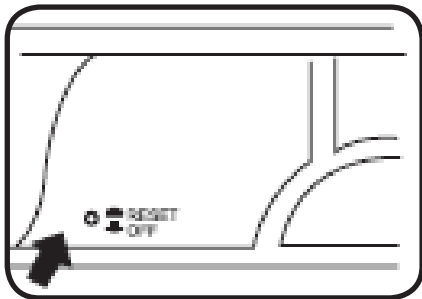

REMOVE THE SPARK PLUG:

1. Remove the spark plug and carbon deposits.
2. Check for discoloration. Standard color should be a tan color.
3. Check the spark plug gap. It should fall within this range: 0.7~0.8mm (0.028~0.031)

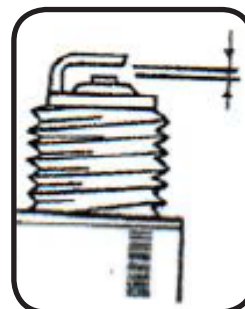
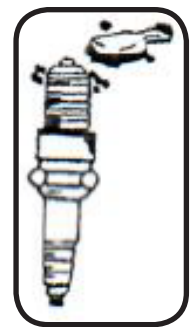
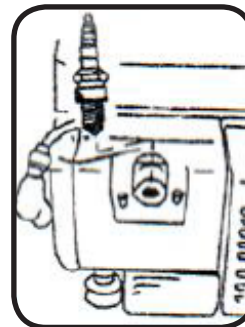

AIR FILTER:

1. Wash the air filter in solvent.
2. Squeeze out the air filter
3. **DO NOT** run the engine without the air filter.

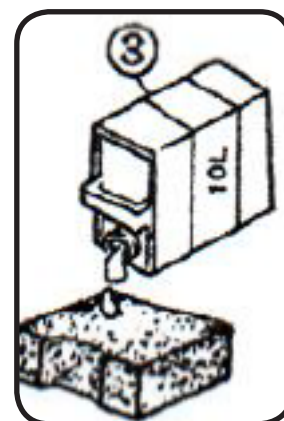
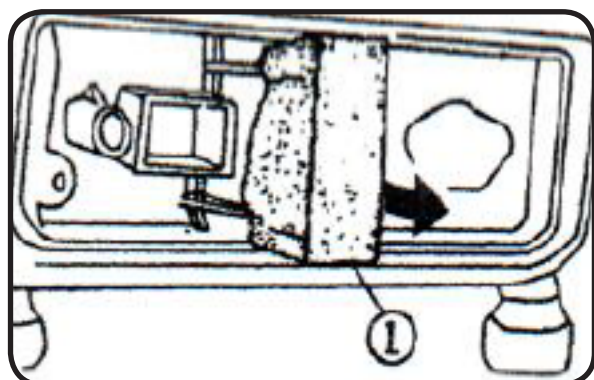



OPERATION

FUEL FILTER:

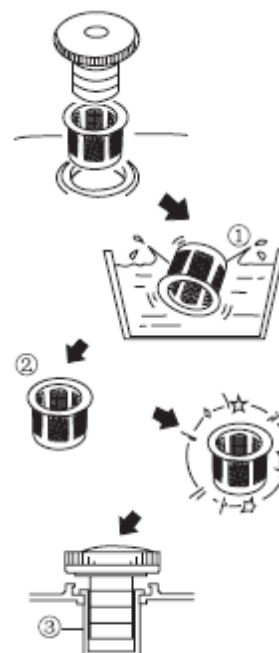
1. Stop the engine
2. Turn the fuel lever to OFF
3. Clean with solvent
4. Wipe off
5. Insert



APPLICATION RANGE:

APPARATUS		650	900	950	1000	1200	POWER FACTOR
	50HZ	~450W	~650W	~650W	~800W	~880W	1
	60HZ	~550W	~800W	~800W	~900W	~1000W	
	50HZ	~330W	~480W	~480W	~600W	~650W	0.7~0.8
	60HZ	~410W	~600W	~600W	~720W	~750W	
	50HZ	~390W	~570W	~570W	~690W	~720W	0.7~0.95
	60HZ	~480W	~700W	~700W	~820W	~850W	

IF DC OUTPUT IS EQUIPPED:

	12V/8.3A	12V/8.3A	12V/8.3A	Max Chargeable Battery Capacity: 40A.h
--	----------	----------	----------	--

	UNIT	950			1000			1200				
AC Output Rated Voltage Frequency	V	120	220	240	120	220	240	110	120	220	220	240
	Hz	60	50	50	60	50	60	60	60	60	50	50
Frequency AC Current Rated Output	A	6.1	3	3.3	7.5	3.6	3.75	9.1	8.3	4.5	3.9	3.5
	VA	800	650	800	900	800	900	1000			850	

SPECIFICATIONS

	MODEL	65060
ALTERNATOR	TYPE	Single phase, brushless, self excitation alternator
	FREQUENCY Hz	60
	VOLTAGE	110, 115, 120, 220, 230, 240 Optional
	RATED OUTPUT	1000W
	MAX OUTPUT	1200W
	VOLT REGULATOR	Capacitor
ENGINE	TYPE	Single-Cylinder, air-cooled, Reed-valve, 2-Stroke Gas engine
	DISPLACEMENT	63cc
	STARTING SYSTEM	Recoil starter
	FUEL TYPE	Unleaded gasoline
	LUBE OIL	2-Stroke Engine oil, Pre-mixed with fuel 50:1
UNIT	FUEL TANK CAPACITY	4.2
	RUNNING TIME	4.5
	NOISE LEVEL	65 (At7m)
	DIMENSIONS	385x330x330
	DRY WEIGHT	16.5

	REMARKS	EVERY 50 HOURS OR EVERY MONTH	EVERY 150 HOURS OR EVERY 3 MONTHS
SPARK PLUG	Remove carbon, adjust gab	✓	
AIR FILTER	Clean, replace if necessary		✓
FUEL FILTER	Clean, replace if necessary		✓
CARBON DEPOSITS	Clean, replace if necessary		✓

PARTS LIST

1	Panel	8	Circuit breaker
2	Lighter	9	Compress Plate
3	Screw M5x20	10	Screw M4x10
4	Switch	11	Cover Plate
5	Capacitor	12	AC Socket
6	Compress Plate	13	Screw M4x10
7	Screw M4x10	14	Screw M4x10

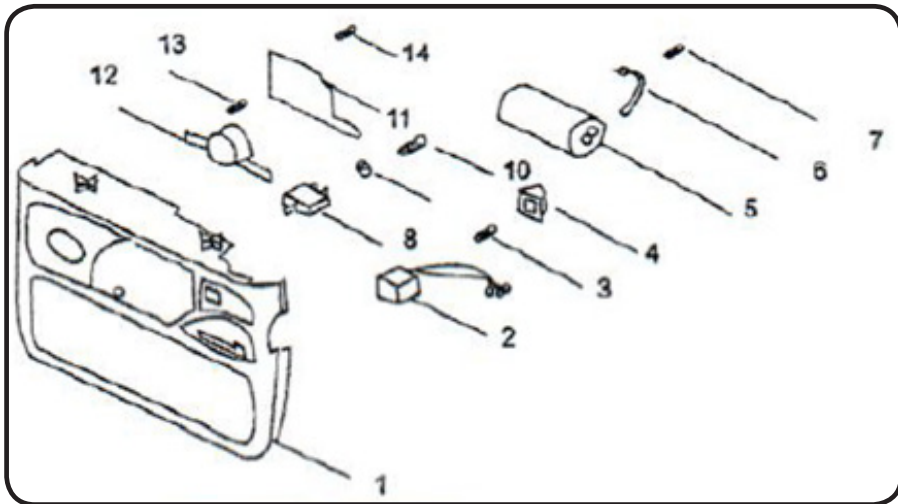

1	Case Assembly
2	Starter Handle
3	Starter Rope
4	Spiral Spring
5	Starter Reel
6	Starter Pane
7	Cir-Clip
8	Compress Plate
9	Bolt M6x12

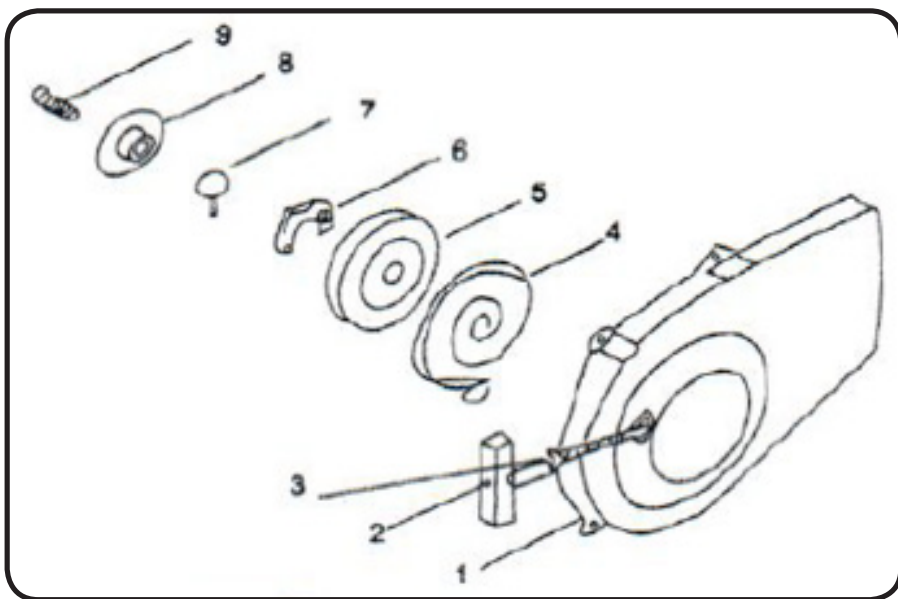

1	Generator Stator	9	Damper
2	Generator Motor	10	Real End Cover
3	Two-Pole tube	11	Bolt M6x12
4	Fan	12	Line
5	Bearing 6203	13	Rectifier
6	Bolt M8x155	14	DC Socket
7	Circuit Breaker	15	Screw M4x30
8	Circuit Breaker Support		

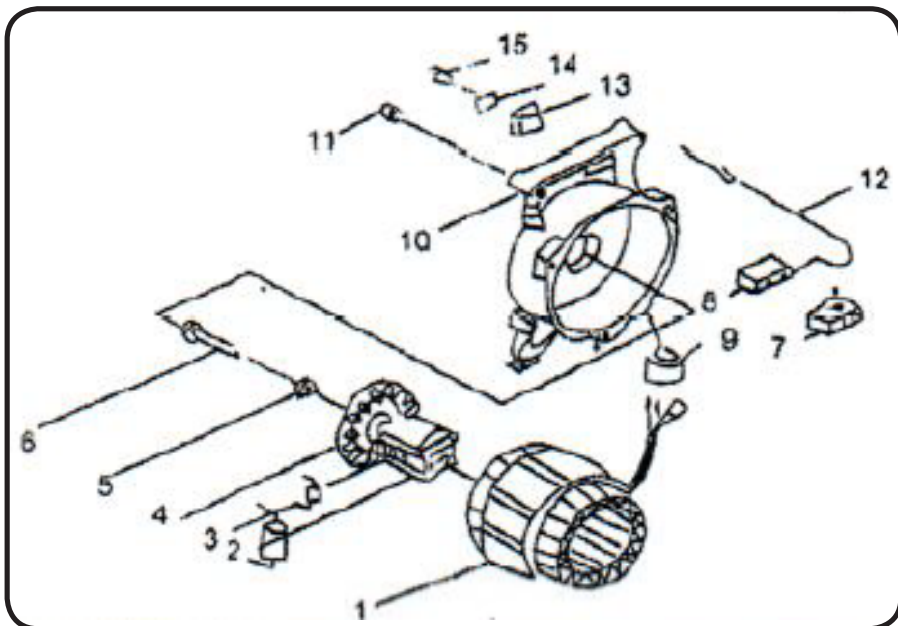

PARTS LIST

1	Intake Valve Support
2	Gasket
3	Intake Valve
4	Troy
5	Washer 3
6	Washer 3
7	Screw M3x10

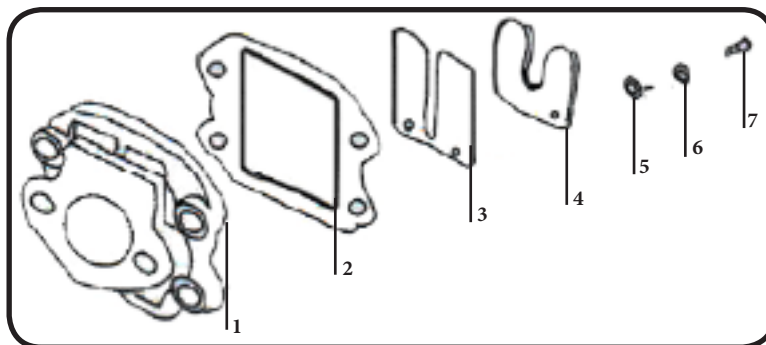

1	Fuel Tank	15	Governor Link Rod
2	Engine	16	Link Rod Spring
3	Generator	17	Bolt M6x80
4	Silencer	18	Bolt M6x12
5	Panel	19	Bolt M6x12
6	Carburetor	20	Bolt M6x12
7	Hand Starter Assembly	21	Bolt M6x20
8	Fuel Tank Lock	22	Washer 6
9	Air Cleaner Element	23	Washer 6
10	Sealing Washer	24	Filter Gasket
11	Air Cleaner Cover	25	Bolt M6x65
12	Plate	26	Washer 6
13	Gasket	27	Washer 6
14	Gasket		

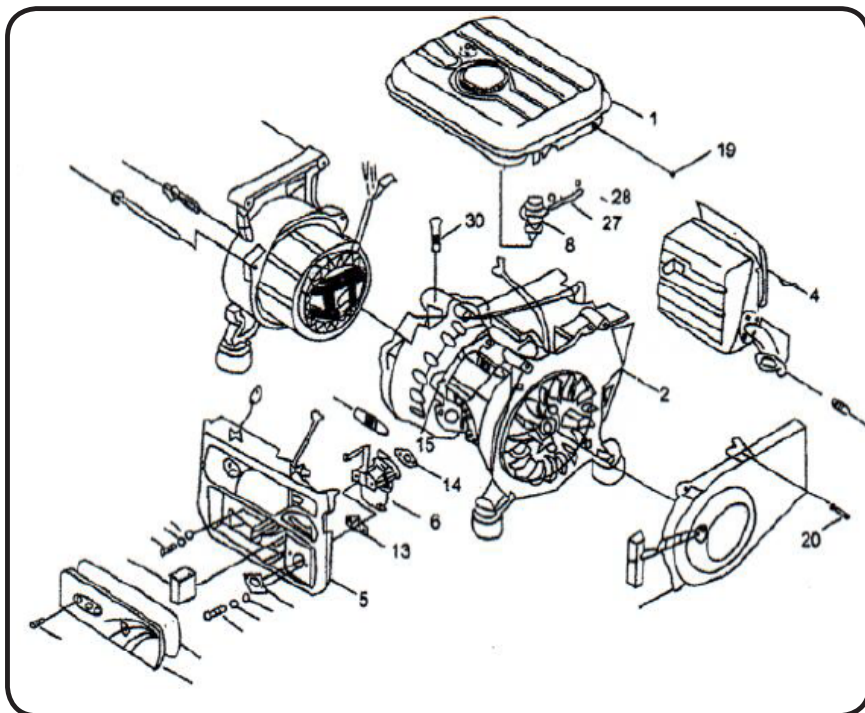

1	Crank Shaft	28	Pressure Bag
2	Crank Shaft Box-L	29	Governor Spring
3	Crank Shaft Box-R	30	Governor Set
4	Fly Wheel	31	Stud Am6x103
5	Cylinder Cover	32	Washer 6
6	Cylinder Head	33	Washer 6
7	Piston	34	Cylinder Head Nut
8	Piston Ring	35	Washer 6
9	Needle Bearing	36	Washer 6
10	Piston Pin	37	Bolt M6x12
11	Piston Pin dip	38	Bolt M6x45
12	Gasket	39	Bolt M6x55
13	Gasket	40	Screw M6x40
14	Spark Plug	41	Bolt M6x20
15	Cover Bonnet	42	Washer 10
16	CDL Unit	43	Washer 10
17	Bearing 6004	44	Nut M10x16
18	Clip 47	45	Nut M6
19	Governor Fork	46	Screw M6x16
20	Block Ring	47	Washer 6
21	Clamp	48	Washer 6
22	Fly Block Assembly	49	Bolt M6x16
23	Oil Seal	50	Washer 6
24	Intake Valve	51	Washer 6
25	Oil Seal	52	Pin
26	Governor Arm	53	Wire Compr Plate
27	Governor Rod	54	Bolt M6x20

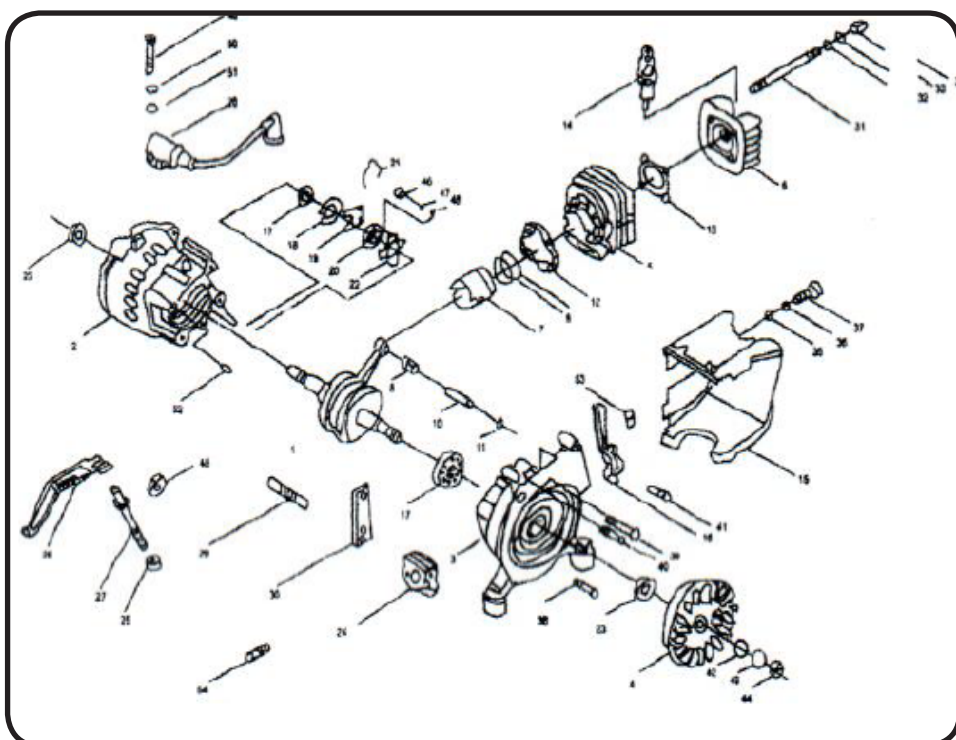

PLEASE READ THE FOLLOWING CAREFULLY

THE MANUFACTURER AND/OR DISTRIBUTOR HAS PROVIDED THE PARTS LIST AND ASSEMBLY DIAGRAM IN THIS MANUAL AS A REFERENCE TOOL ONLY. NEITHER THE MANUFACTURER OR DISTRIBUTOR MAKES ANY REPRESENTATION OR WARRANTY OF ANY KIND TO THE BUYER THAT HE OR SHE IS QUALIFIED TO MAKE ANY REPAIRS TO THE PRODUCT, OR THAT HE OR SHE IS QUALIFIED TO REPLACE ANY PARTS OF THE PRODUCT. IN FACT, THE MANUFACTURER AND/OR DISTRIBUTOR EXPRESSLY STATES THAT ALL REPAIRS AND PARTS REPLACEMENTS SHOULD BE UNDERTAKEN BY CERTIFIED AND LICENSED TECHNICIANS, AND NOT BY THE BUYER. THE BUYER ASSUMES ALL RISK AND LIABILITY ARISING OUT OF HIS OR HER REPAIRS TO THE ORIGINAL PRODUCT OR REPLACEMENT PARTS THERETO, OR ARISING OUT OF HIS OR HER INSTALLATION OF REPLACEMENT PARTS THERETO.

Record Product's Serial Number Here: _____

Note: If product has no serial number, record month and year of purchase instead.

Note: Some parts are listed and shown for illustration purposes only and are not available individually as replacement parts.



SAVE THESE INSTRUCTIONS.



Questions, problems, missing parts?

Before returning to your retailer, our exceptional customer service is available.

Call us Tel: **909 628 0880**

Hour : **9am To 3pm PST (Monday to Friday)**

Email : **customer@xtremepowerusa.com**

PRODUCT MADE IN CHINA