

TEKNO 25 INSTALLATION INSTRUCTIONS

STEP 1 - Installing Supports

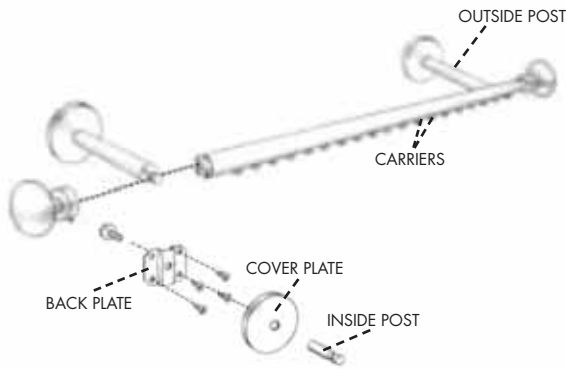

Height calculation for regular clips.

Add 1" to length of drapes, plus at least 1/2" clearance from the floor. This measurement is the distance from floor to center point of Back Plate. **Please note drapes should not touch rail, install pin on hooks with this in consideration.**



1. Install Back Plate to wall. Make sure all M-6 bolts are level. If you have a spliced track the Center Support must be installed at the position of splice.
2. Cover Back Plate with Cover Plate.
3. Screw on Inside Post very securely. Do not leave any play.

STEP 2 - Splice track if necessary



1. Join the track sections together.
2. Tighten set screws.
3. Screw Center Support directly into center hole of Splice.

STEP 3 - Installing Outside Posts



1. Loosen all screws on Outside Posts.
2. Slide Outside Posts into back channel of Rail.
3. Align Outside Posts with Inside Posts from **Step 1**.

STEP 4 - Mount rail onto supports

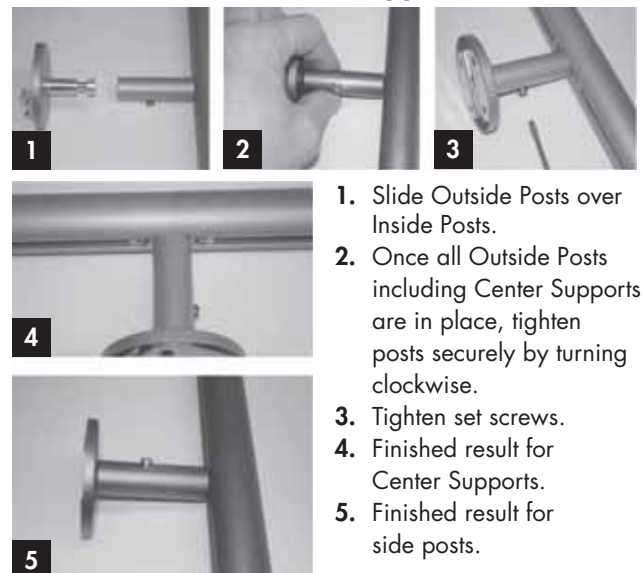

1. Slide Outside Posts over Inside Posts.
2. Once all Outside Posts including Center Supports are in place, tighten posts securely by turning clockwise.
3. Tighten set screws.
4. Finished result for Center Supports.
5. Finished result for side posts.

STEP 5 - Hand draw systems

1. Install Finials, and then click in carriers.
 2. Attach Fling Rod to side of drape you wish to operate from, by clipping it into first carrier.
 3. Use plastic plug to lock last carrier in place so end of drape does not move when the drape is closed.
-

STEP 6 - Installing regular carriers (corded system)

1. Install Finials, and then click in carriers.
2. For center opening tracks greater than 84", click in plastic plug at center point of rail.



STEP 7 - Cord Draw Systems, Installing Pulley

1. Attach pulley to cord. Stretch pulley until cord is tight. It is not necessary to use excessive tension. Mark spot with pencil on wall or floor. Remove cords and install pulley then re-install cords.
- **THE PULLEY MUST BE INSTALLED. IT IS THE LAW.
FAILURE TO DO SO CAN RESULT IN
INJURY TO CHILDREN OR PETS!**
2. IF NEEDED - To adjust CONTROL cord drop, pull cord through master carrier until pulley is at desired height. Pull cord an extra few inches and knot cord at proper spot.
When you install the pulley the cord will slide back into place.

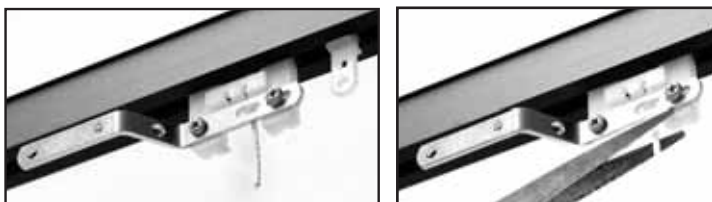

INSTALLATION OF EURO-SCOPE UPGRADE KONTUR, NEXGEN, TEKNO 25, TEKNO 40

STEP 1 - Assembling track when splicer is included

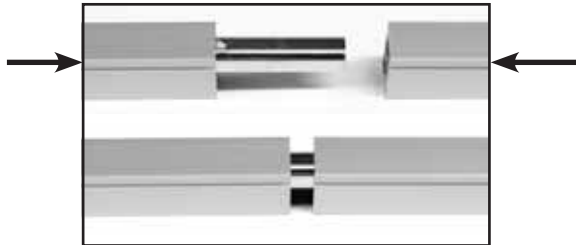

STEP 2 - Installing mounting hardware

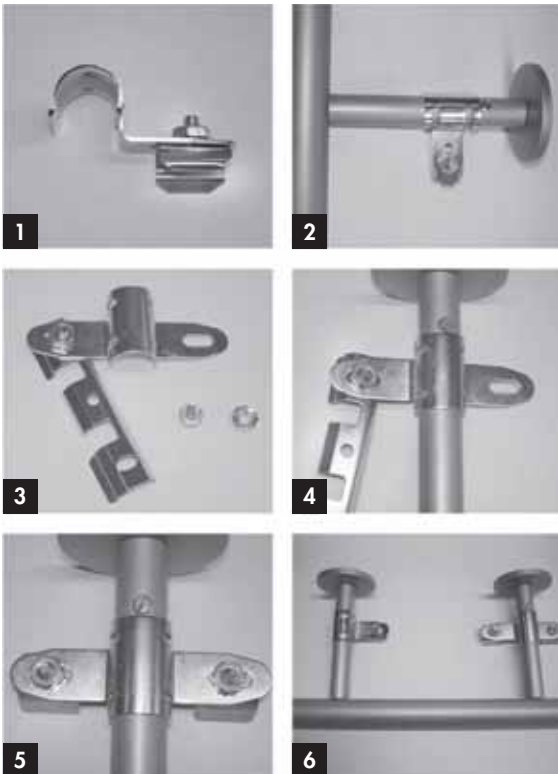

1. Assemble Upgrade Clips for Outside Posts.
2. Attach assembled clip to Outside Posts.
3. Partially assemble Upgrade Clip for Center Post.
4. Mount Center Clip to Center Post and finish assembly.
5. Finished result of Center Clip
6. Clips must align to be able to install track.

STEP 3 - Installing track



1. Place the front lip of the track into the front edge of the clip. Rotate the back of the track up into the clips and snap into place.

STEP 4 - Installing baton

1. Click-in carriers.
2. Attach baton to side or rail you wish to operate from. Clip baton either into a carrier or directly into the rail.

STEP 5 - Installing Pulley

1. Determine if cord is on the side you wish to operate. Control side can be changed by pulling cord through opposite control.
2. Attach cord to pulley. Stretch pulley and create sufficient tension so cord remains in track. Do not apply excessive tension. Mark spot with pencil on wall or floor.
3. Remove cords and fasten pulley to wall or floor. Re-install cords.
 - **THE PULLEY MUST BE INSTALLED. IT IS THE LAW. FAILURE TO DO SO CAN RESULT IN INJURY TO CHILDREN OR PETS.**
4. For center opening tracks greater than 84", click in plastic plug at center point of rail to help support cords.

