

APPLICATION INSTRUCTIONS FOR DINGEWOOD SIDING

<http://www.dingewood.com/>

SQUARE FOOTAGE

First, determine the amount of lumber you will need. You will need to determine the square footage of your space by multiplying the length x width of your project, making sure to subtract for windows and doors. Next determine how much siding to purchase. Use the charts below to determine coverage on your Dingewood purchase.

TONGUE AND GROOVE SIDING NOMINAL SIZES (Chart 1)

Thickness (in.)	Nominal Width (in.)	Finished Width (in.)
11/16	4, 6	3-3/8, 5-3/8

TONGUE AND GROOVE SIDING COVERAGE TABLE (Chart 2)

Nominal Width (inches)	Dressed Width (inches)	Exposed Face Width (inches)	Lineal Feet Factor	Board Feet Factor
4	3-3/8	3	4.0	1.33
6	5-3/8	5	2.4	1.2

PREPARATION

Remove the trim around windows and doors. Use a stud finder to locate wall studs and ceiling joists. Tongue & Groove Siding can be installed horizontally or vertically, so determine which direction you would like the wood to go.

HORIZONTAL APPLICATION

In horizontal application, start at the bottom and work up, with the groove edges facing downwards. Leave a gap .5" at each wall to allow for expansion and contraction.

Siding up to 6 inches wide can be blind nailed with one siding nail per bearing toe-nailed through the base of each tongue. (See Chart 3) Nails should be installed at an angle so they cannot work their way back out of the wood. Nails should be applied with enough force that they must penetrate 1-1/4 inches into solid wood and are flush with the wood.

Measure the length of the wall for your first row and install your first board. Butt the second board against the first and work across the wall, until the final piece of the first row. Make any necessary cuts for the last piece and install. Check every few rows that

For additional information – <http://www.dingewood.com/>



you are still parallel with the first row or the wall. To fill the wall exactly, it may be necessary to fit a board or two together loosely.

NAIL INSTALLATION (Chart 3)

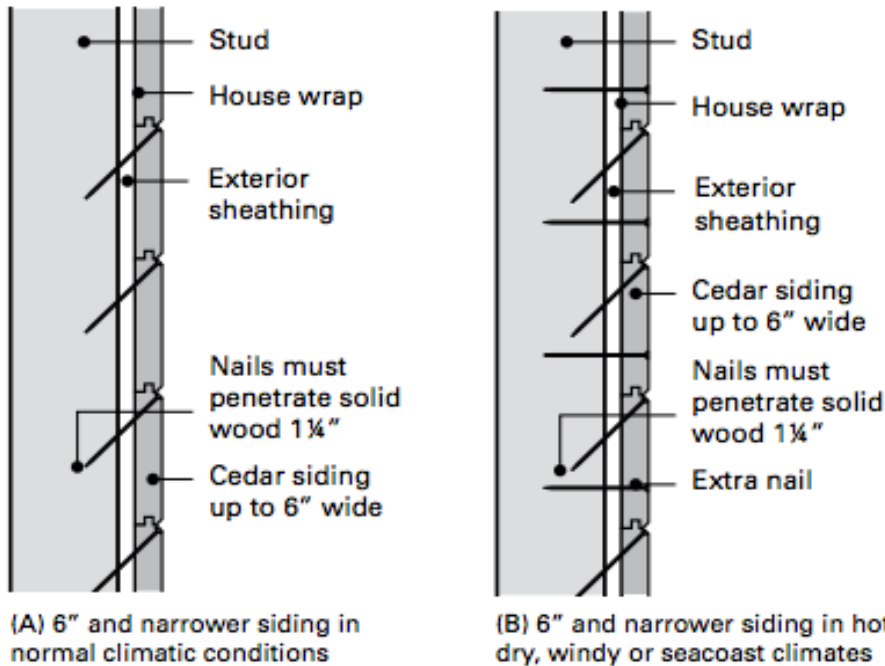

VERTICAL APPLICATION

In vertical application, start at one corner with grooved edge toward the adjacent wall. Leave a gap .5" at each wall to allow for expansion and contraction. Use a level or plumb line to ensure that the first board is installed plumb.

Siding is nailed to horizontal blocking lines installed between studs or to furring strips. (See Chart 3) As with horizontal installation, pieces up to 6 inches can be blind nailed and wider pieces should be face nailed. Nails should be installed at an angle so they cannot work their way back out of the wood. Nails should be applied with enough force that they must penetrate 1-1/4 inches into solid wood and are flush with the wood.

The grooved edge of the first board may have to be trimmed to ensure a better fit. Measure the length of the wall for your first row and install your first board. Butt the second board against the first and work across the wall, until the final piece of the first row. Make any necessary cuts for the last piece and install. Check every few rows that you are still parallel with the first row or the wall. To fill the wall exactly, it may be necessary to fit a board or two together loosely.

NAILS

Nails should be stainless steel, high tensile strength aluminum, or galvanized. Nails should be rust proof. They should be small enough to enter the tongue without splitting

For additional information – <http://www.dingewood.com/>



the wood and small enough to not need predrilling. They should not be visible once inserted into the wood. Points should be diamond or blunt.

TRIM

Purchase Dingewood 1 in. x 6 in. x 8 ft. trim in coordinating colors, to trim out half walls, headboards or similar projects.

FINISHES

If you would like to protect your wood surface, installed wood may be top-coated with Weather Wash brand topcoats. These finishes can successfully hold the weathered look. Use White Maintenance Oil to add the look of patina. Use Clear Maintenance Oil to bring back more of the warm browns in the wood. Use Varnish topcoats for a high degree of wood protection and select the sheen you desire. Dingewood siding is compatible with paint, for a customized weathered look. www.WeatherWashCoatings.com

COLOR MATCH

If you need to purchase more alder to trim windows, corners, etc. you can color match with Weather Wash Coatings aging stains. www.WeatherWashCoatings.com

- Color Match = Rustic Barn on Alder with Weather Wash color “Mist.”
- Color Match = Driftwood Gray on Alder with Weather Wash color “Storm.”

EXTERIOR APPLICATION

For exterior projects, ensure the wood species you’ve selected is compatible for exteriors. Dingewood sells many fine exterior woods, like cedar, fir, spruce, & redwood.

For additional information – <http://www.dingewood.com/>

