

**(EN) Parts List**  
**(ES) La Lista de partes**  
**(FR) Liste des pièces**



**(EN) Note: Check all parts prior to installation.**  
**(ES) Nota: Verifica todo despide antes de instalación.**  
**(FR) Note: Vérifier toutes les pièces avant l'installation.**

(EN)CODE (ES)CODE (FR)CODE	(EN)QTY (ES)QTY (FR)QTÉ
BLB	1
BRB	1
BSB	2
BBF	2
ECB	1
DCLSP	1
DCRSP	1
SCB	1
SSB	1
SLP	1
SRP	1
ASLP	2
ABBLR	2
RSRP	1
RSLP	1
RSMP	1
SBSLR	1
SBSP	2
AFBLP	1
AFBRP	1
AFTLP	1
AFTRP	1
RFSP	4

(EN)CODE (ES)CODE (FR)CODE	(EN)QTY (ES)QTY (FR)QTÉ
RFLB	2
RFRB	2
TSLB	1
TSRB	1
BSLB	1
BSRB	1
DSSP	2
DSCP	4
WSP	6
WCFP	2
WCBP	2
WFP	2
RPSLP	2
RPCLP	3
GPS	2
GPSLP	1
GPSRP	1
DPLP	1
DPRP	1
FS1P	2
FS2P	2
FSLP	1
FSRP	1

(EN) ACCESSORIES (FR) ACCESSOIRES (ES) ACCESORIOS	
(EN)CODE (ES)CODE (FR)CODE	(EN)QTY (ES)QTY (FR)QTÉ
FPPF	2
BS	4
H	2
TC	4
TS	4
PW	3 Slabs
PC	3 Slabs
S1	205
S2	28
S3	70

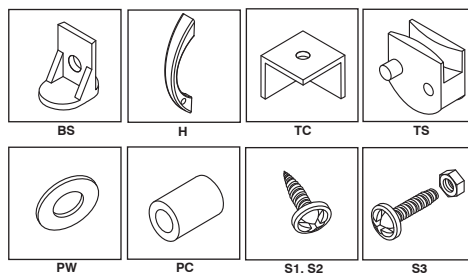
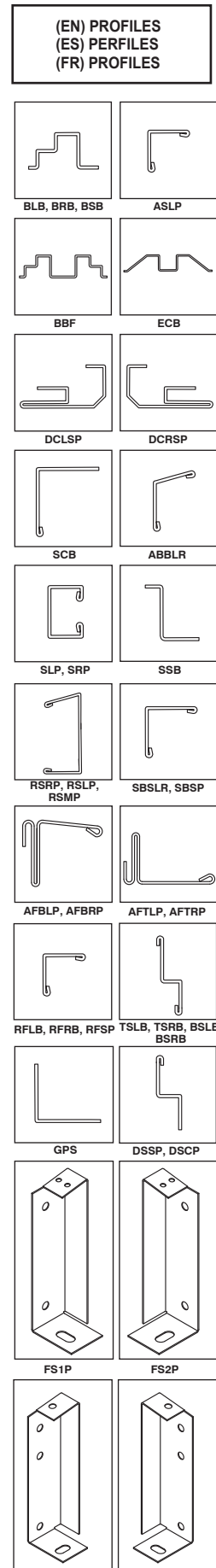

**(EN) IMPORTANT: USE HAND GLOVES TO PREVENT INJURY.**  
**(ES) IMPORTANTE: GUANTES DE MANO DE USO PARA PREVENIR LA HERIDA.**  
**(FR) IMPORTANT: UTILISER LES GANTS POUR PREVENIR LES ACCIDENTS.**

(EN) Exploded View  
 (ES) El Panorama estallado  
 (FR) Vue Explosée

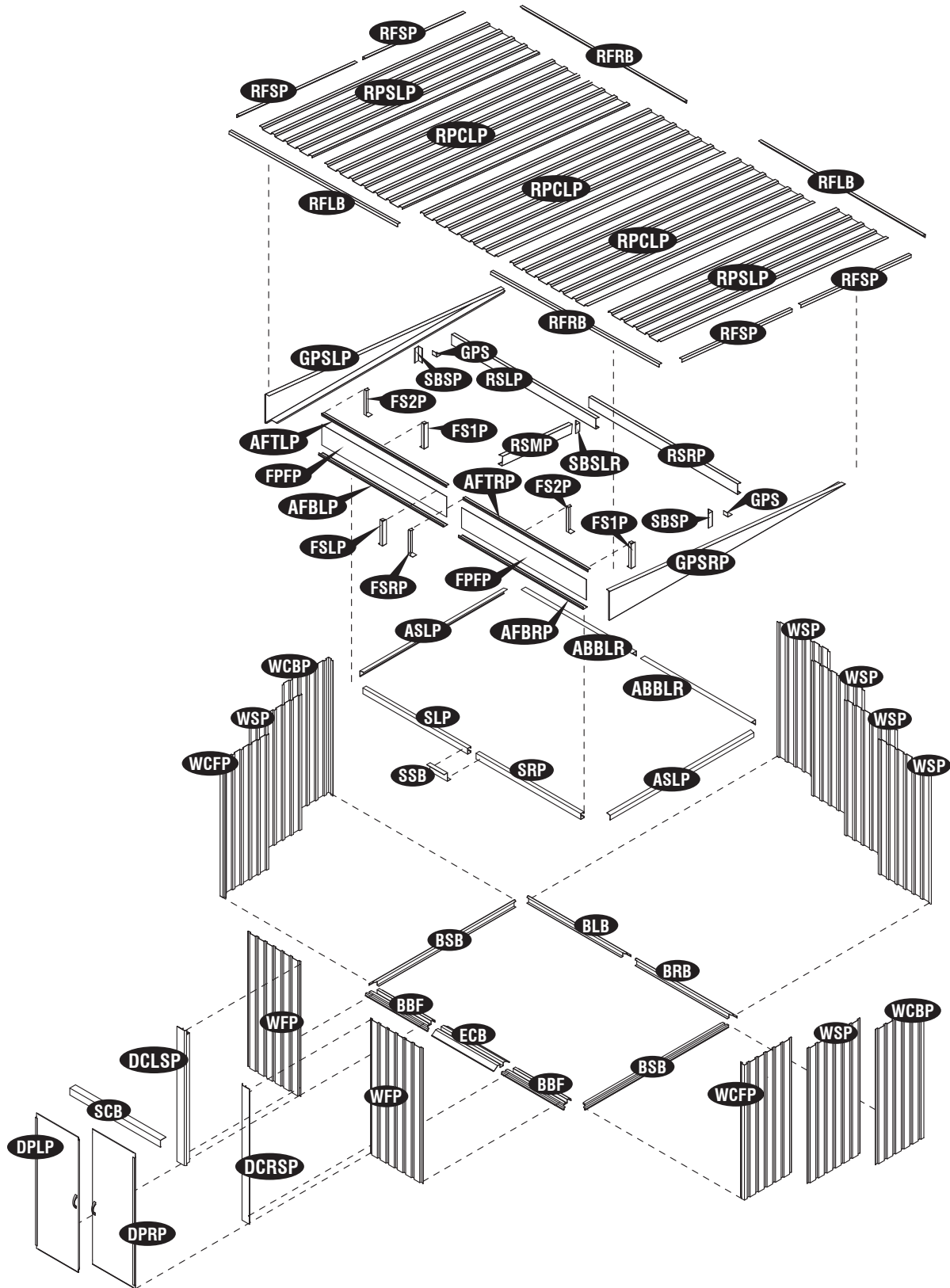
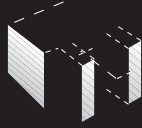

(EN) IMPORTANT: USE HAND GLOVES TO PREVENT INJURY.  
 (ES) IMPORTANTE: GUANTES DE MANO DE USO PARA PREVENIR LA HERIDA.  
 (FR) IMPORTANT: UTILISER LES GANTS POUR PREVENIR LES ACCIDENTS.