



Item # 000-000
Model # FT-51161

USE AND CARE GUIDE

26" QUADRIPOD FIRE PIT



Questions, problems, missing parts? Before returning to the store,
call Hampton Bay Customer Service
8 a.m. - 6 p.m., EST, Monday-Friday

1-877-527-0313

HAMPTONBAY.COM

THANK YOU

We appreciate the trust and confidence you have placed in Hampton Bay through the purchase of this [PRODUCT]. We strive to continually create quality products designed to enhance your home. Visit us online to see our full line of products available for your home improvement needs. Thank you for choosing Hampton Bay!

Table of Contents

Table of Contents.....	2	Package Contents.....	4
Safety Information.....	2	Installation.....	5
Warranty.....	3	Installation(continued)	6
What is Covered.....	3	Maintenance	7
What is Not Covered	3	Care and Cleaning	7
Pre-installation.....	3	Service Parts	8
Planning Installation	3	Model Type	8
Tools required	3		
Hardware Included	3		

Safety Information

PLEASE READ AND UNDERSTAND THIS ENTIRE MANUAL BEFORE ATTEMPTING TO ASSEMBLE, OPERATE OR INSTALL THE PRODUCT.



WARNING

1. **FOR OUTDOOR USE ONLY! NEVER LEASE FIRE UNATTENDED!**
2. **DO NOT USE THE FIRE PIT TO COOK FOOD!** The fire pit is not designed for grilling food.
3. **DO NOT** allow children or pets near the fire pit without supervision.
4. **DO NOT** touch the surface of fire pit while in use as it may cause burns.
5. **NEVER** burn in vehicles, tents or indoors. **CARBON MONOXIDE HAZARD.**
6. Use poker and/ or hear-resistant gloves to open/close mesh cover while in use.
7. **DO NOT** use water to extinguish as this is dangerous and can cause damage to the fire pit.



CAUTION

1. Burn only untreated wood or fire logs in this fire pit.
2. **DO NOT** use gasoline or kerosene to start the fire in this fire pit.
3. **DO NOT** use this unit on a wood deck, long or dry grass and / or leaves, or on combustible surfaces.
4. **DO NOT** attempt to move the fire pit while it is hot or in use.
5. Place the fire pit no closer than 8 feet from walls or combustibles during use.
6. Adequate fire extinguishing material should be readily available.
7. Always ensure that the mesh cover is secured over the fire bowl while in use.
8. Poker handle may become hot during and after use.

PROPOSITION 65 WARNING: Fuel used in wood and charcoal burning appliances and the products of combustion of such fuels contain chemicals known to cause cancer, birth defects or other reproductive harm.

Consumers should check State and Provincial, in addition to local codes and regulations regarding the use of the product.

Warranty

1 YEAR LIMITED WARRANTY

WHAT IS COVERED

We warrant the metal frame to be free of manufacturing defects to the original purchaser for one year.

WHAT IS NOT COVERED

It remains the customer's responsibility for freight and packaging charge to and from our service center. This warranty does not cover commercial use, hardware, acts of nature, fire, freezing and abusive use. In addition, purchased parts are not covered under this warranty. We reserve the right to make substitutions with similar merchandise, if the model in question is no longer in production.

Contact the Customer Service Team at 1-877-527-0313 or visit [www. Hamptonbay.com](http://www.Hamptonbay.com).

Pre-installation

PLANNING INSTALLATION

Carefully remove all pieces from carton and make sure that you have all parts (refer to parts list). If you are missing parts, please contact 1-877-527-0313 for further assistance.



NOTE: Please read and understand the entire manual before assemble, operate or install the fire pit.

TOOLS REQUIRED



Phillips
screwdriver



M6 Wrench

HARDWARE INCLUDED



NOTE: Hardware not shown to actual size.



AA

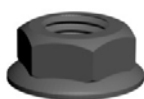

BB

Part	Description	Quantity
AA	M6 x 10mm Bolt	8
BB	M6 Nut	5

Pre-installation (continued)

PACKAGE CONTENTS

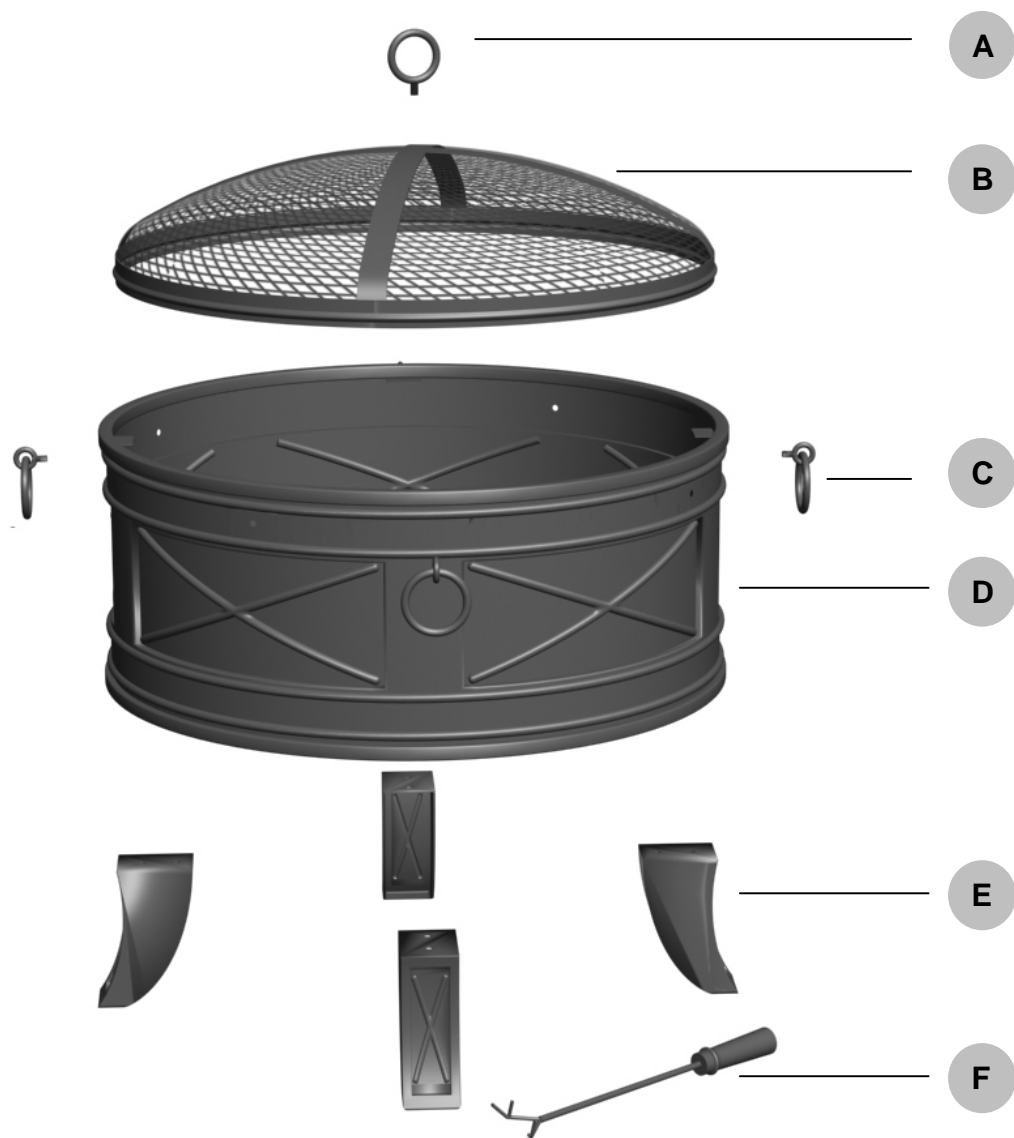

Part	Description	Quantity
A	Handle	1
B	Mesh Cover	1
C	Decoration Ring	4
D	Fire Bowl	1
E	Stand	4
F	Poker	1

Installation

1 Mesh Cover Installation

- Insert handle (A) into hole in mesh cover (B).
- Use wrench (not included) to secure M6 nut (BB) to underside of mesh cover (B).



CAUTION:
Please wear glove during installation.

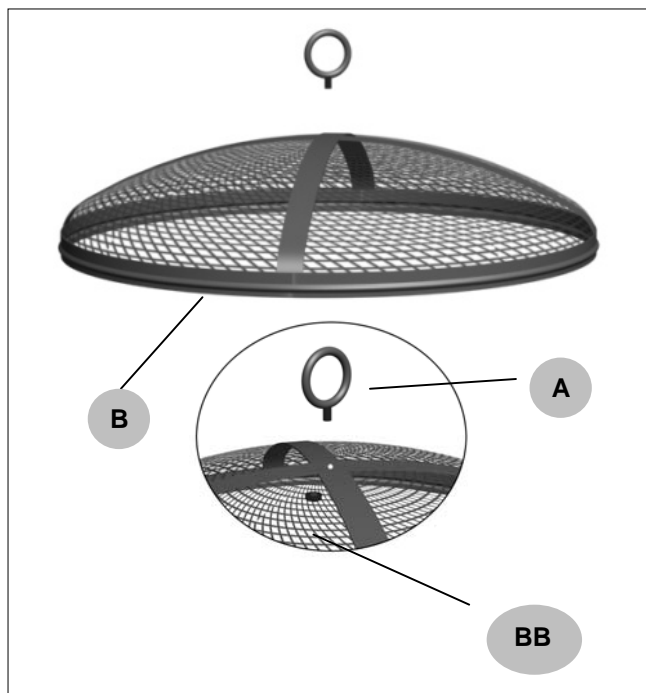

2 Stand Installation

- Attach the stand (E) to fire bowl (D) using M6x10mm bolt (AA).
- Tighten with Phillips screwdriver (not included).



CAUTION:
Please wear glove during installation.

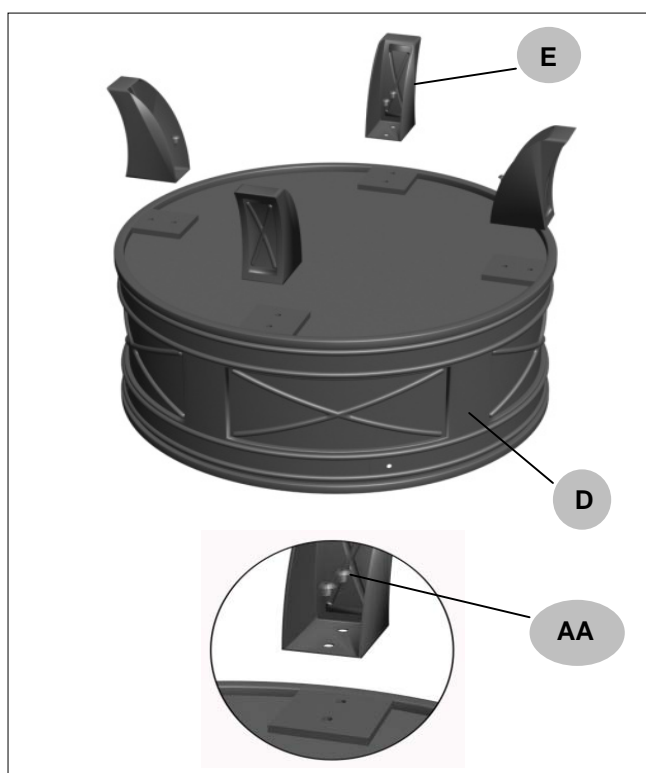

Installation (continued)

3 Decoration Ring Installation

- Insert decoration ring (C) into hole in fire bowl (D).
- Use wrench (not included) to secure M6 nut (BB) to inside of fire bowl (D).



CAUTION:
Please wear glove during installation.

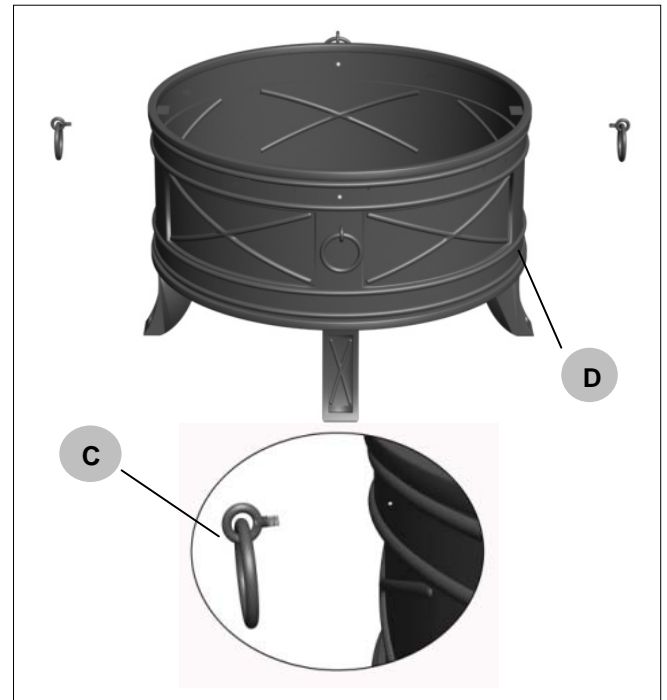

4 Installation Done

- Place the mesh cover (B) on the base assembly..
- Place the poker (F) conveniently near fire pit.



CAUTION:
Please wear glove during installation.

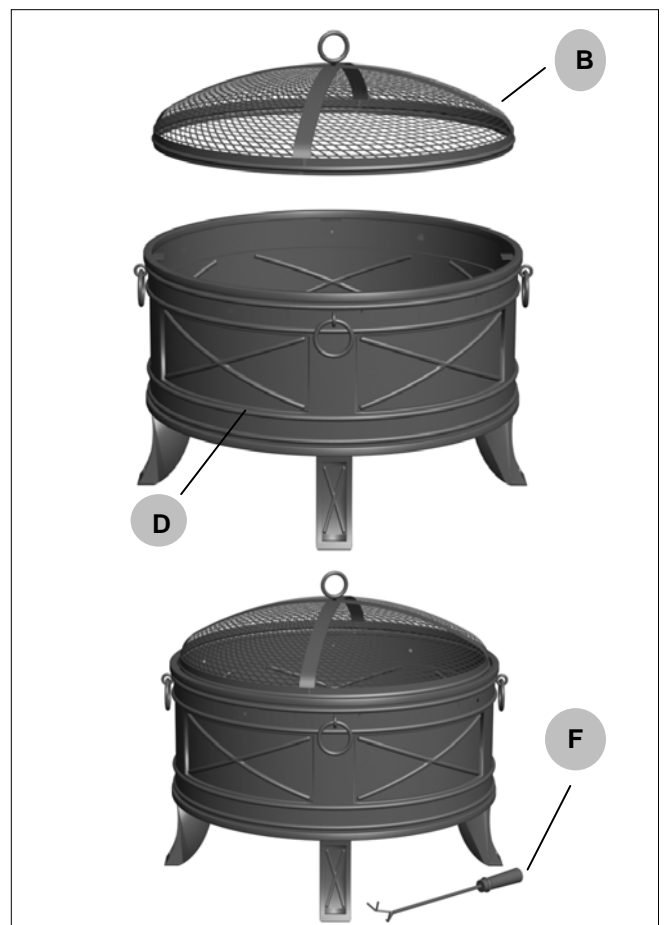

Maintenance

- To extend the life of your fire pit, clean it after each use.
- To protect fire pit finish, use a soft cloth in lieu of bare hands while handling.
- Clean fire bowl after each use once ashes have cooled.
- Store assembled in a cool, dry location away from children and pets.

Care and Cleaning

- Do not attempt to clean the fire pit until the fire is completely out and cooled completely.
- Use a soft cloth to wipe fire pit and poker
- Do not attempt to clean while hot.
- Keeping the fire pit covered when cooled and not in use.

Service Parts

MODEL TYPE

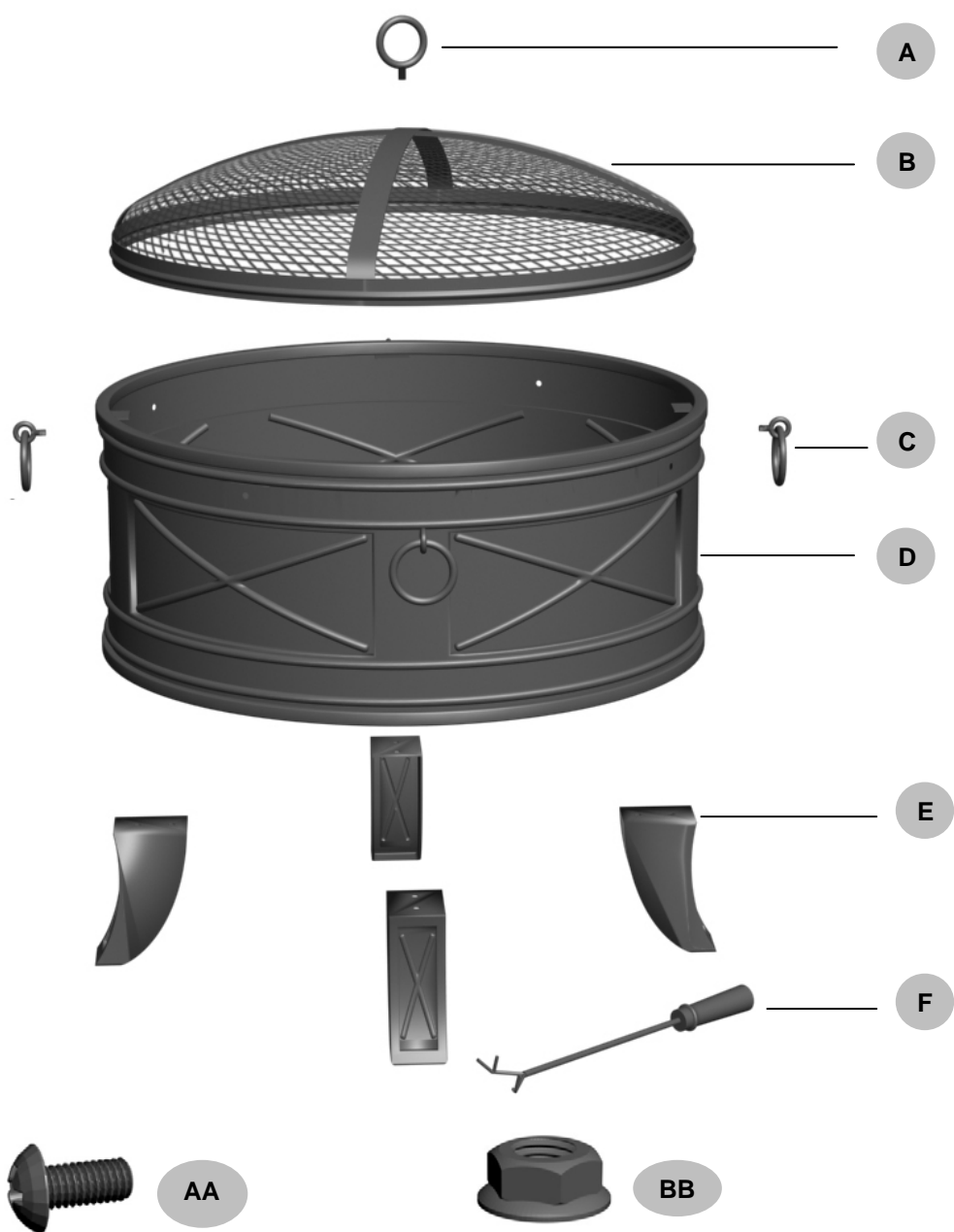

Part	Description	Quantity
A	Handle	1
B	Mesh Cover	1
C	Decoration Ring	4
D	Fire Bowl	1

Part	Description	Quantity
E	Stand	4
F	Poker	1
AA	M6x 10mm Bolt	8
BB	M6 Nut	5



Questions, problems, missing parts? Before returning to the store,
call Hampton Bay Customer Service
8 a.m. - 6 p.m., EST, Monday-Friday

1-877-527-0313

HAMPTONBAY.COM

Retain this manual for future use.