

**I'm Smart Herb Garden!  
Let's get to know each other!**

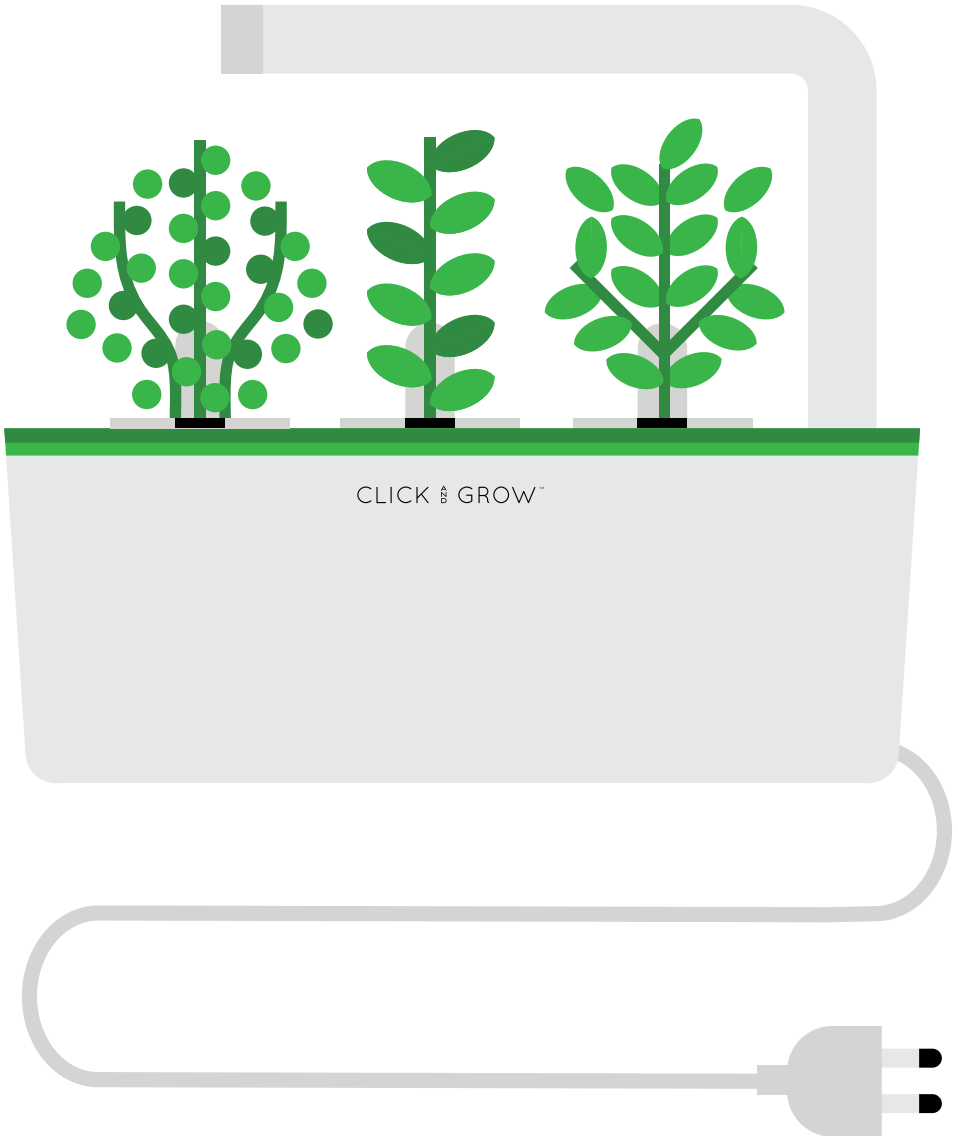

# Let's get started!

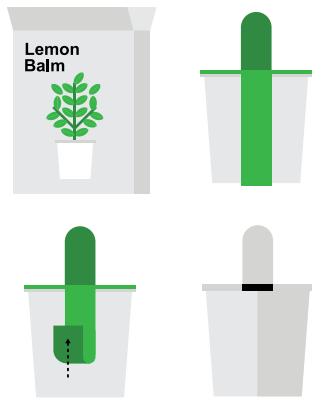

## 1. First, prepare the cartridges

Remove my cartridges from their individual packages, then carefully pull off the green sticker that encloses the cartridge. Be sure to leave my round-shaped white lids on!

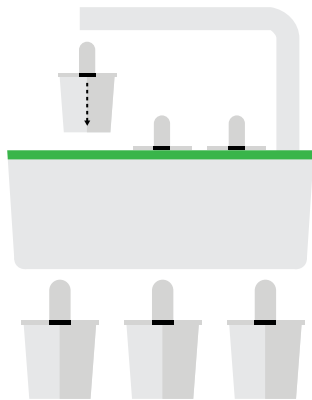

## 3. Install the cartridges

Place all cartridges in the housing provided and press until you feel or hear a slight click.

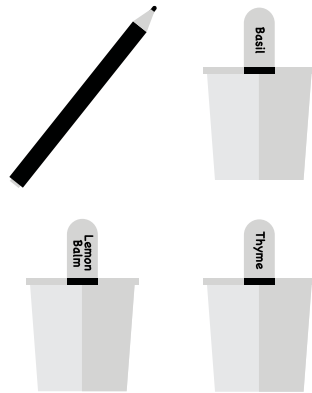

## 2. Give me a name

Name all of my plants with their original name or something that you create yourself, so that you'll remember whether they'll grow up to be Basil, Chili, or some other plant

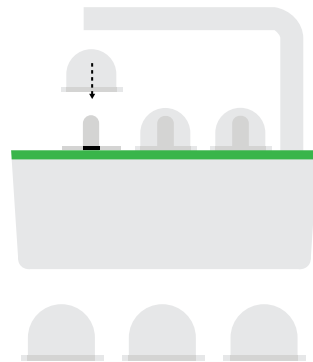

## 4. Place domes over the cartridges

All of my cartridges come with a transparent dome to create a greenhouse effect. Remember to place the domes over all of the cartridges. Each sprout must be covered until it starts to reach the dome.

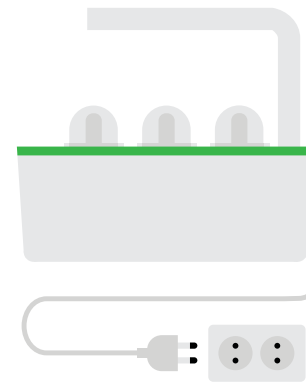

## 5. Plug me in

Now connect my power cord. You should see the lamp light up and start flashing. This tells you that my watertank is empty. Connecting power starts me on an 18 (day) / 6 (dim night) hour light cycle.

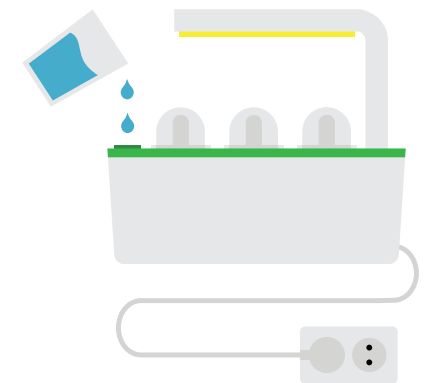

## 6. Fill the tank

Pour water into my tank until the level indicator is perfectly aligned with the top of the surface. Please do not overwater me. I can hold 5 cups / 1.3 L of water. The lamp should stop blinking, showing that the water level is correct.

## And then?

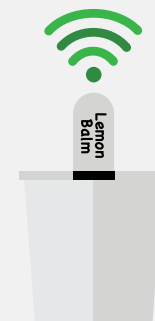

Register your garden online



1st sprouts appear- 2-3 weeks



Full plant in 2-4 months  
Ready to enjoy for 6-8 months

# How to become a perfect gardener

## Here are some tips to make sure we become the best friends.

### **Remember to remove the domes when my sprouts start to reach them**

Place the domes as soon you have started to grow plants. I recommend leaving the domes (transparent caps) on until my plants start to reach the domes. My white, round-shaped plastic lids should not be taken off at all.

### **You can change my grow light timer as you wish**

My timer schedule works 16 hours on and 8 hours off. Every time you plug me into the power socket it will start my schedule from the beginning. For example, if you plug me in at 8 AM, I will turn myself off at 12 AM (after remaining on for 16 hours) and then on again at 8 AM. During off hours the lamp is on dim mode.

### **The lamp starts to flash when my plants get thirsty**

I was built smart, so I will let you know when to water me by starting to flash. Water me until the light stops flashing and make sure my floater is exactly even with the surface and not higher than the surface.

### **3-level adjustable lamp**

My lamp arm has 3 different positions. In the beginning, put the lamp at the lowest position, and then lift it according to my plants' growth.

### **You can expect sprouts to appear in 1–3 weeks**

Different plants grow at different rates, so some of them will sprout within a week, while others may take up to 3 weeks. This depends on the natural sunlight provided and room temperature.

### **Enjoy my herbs when they start to reach the light**

This is the moment we have both been waiting for, and now you can enjoy your own homegrown herbs and veggies! You may use my plants day by day or start to use them when they have grown bigger. Be creative and get the most out of the freshness at your fingertips.

### **Trim my plants if they start to reach the light**

My plants tend to grow by height, not width. Cutting them can make them yield more and live longer. Cut the plant with a sharp knife or scissors near a branch. The remaining part should have at least 2–4 pairs of leaves. Two new shoots will soon appear and the process can be repeated.

### **I come with a full warranty**

If I happen to show manufacturing defects, Click and Grow will happily exchange me for a new unit during the first 12 months from purchase.

### **Special warning**

Smart Herb Garden may potentially trigger seizures in people with photosensitive epilepsy. The flashing light indicates an empty tank, but it can be a visual stimulus that may cause seizures.

### **For more information about me:**

Check the webpage for help and support, or write to [support@clickandgrow.com](mailto:support@clickandgrow.com)

We wish you a fruitful relationship with Smart Herb Garden!