



OZCO BUILDING PRODUCTS

Product & Packaging Specs

Truss Base Fan's

Common Dimensions-All Configurations

56644
12:12 Truss Base Fan
(shown)

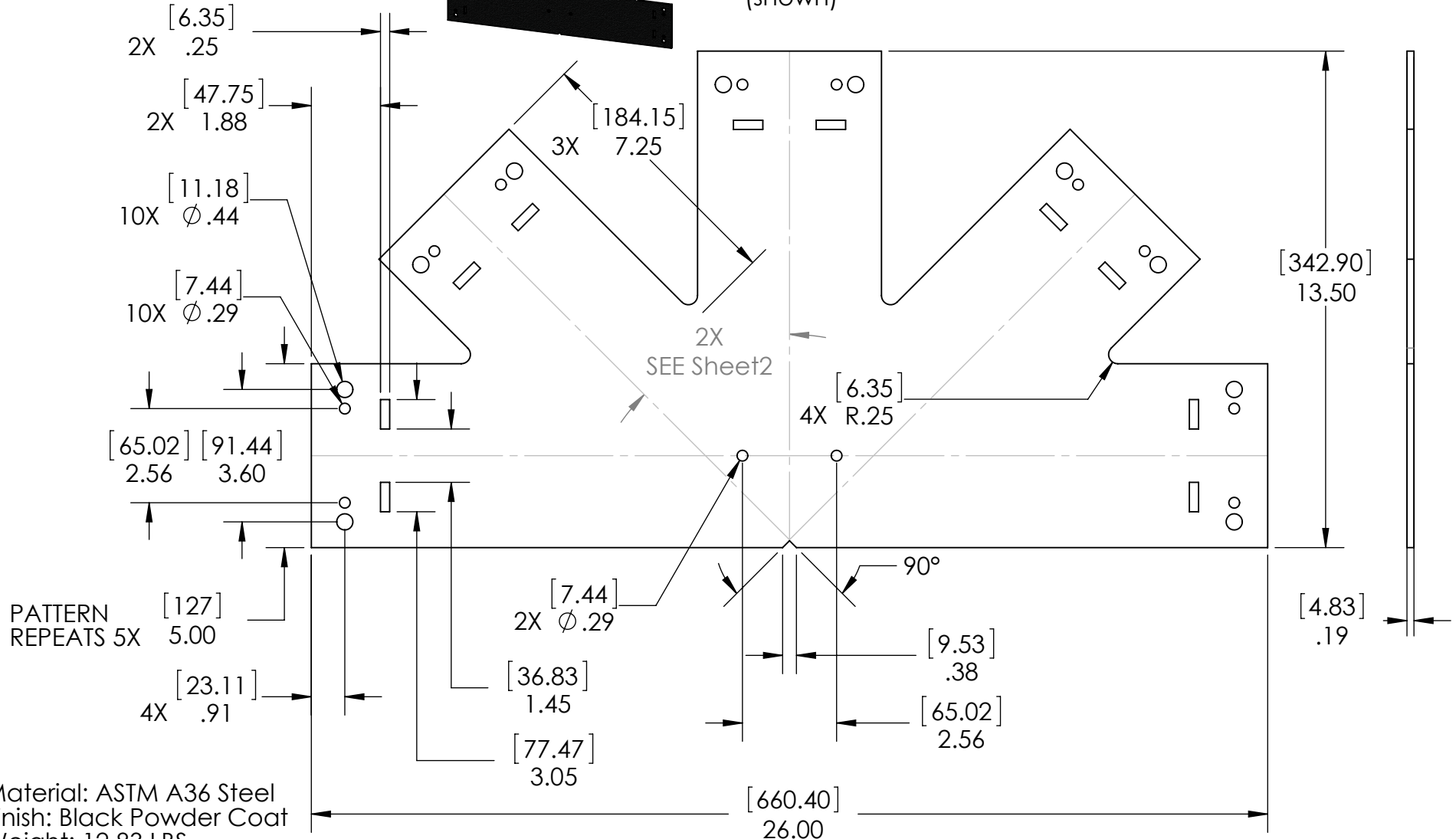

Product & Packaging Specs

Truss Base Fan

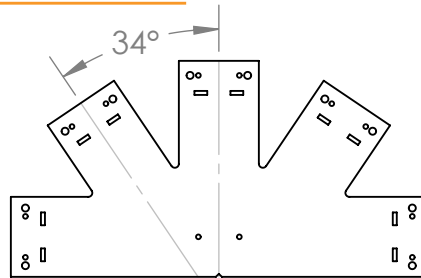

56619
8:12 Truss Base Fan

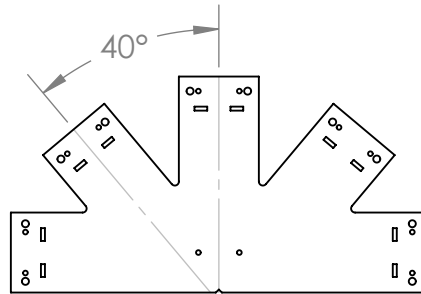

56620
10:12 Truss Base Fan

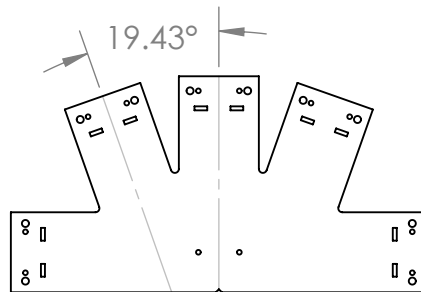

56642
4:12 Truss Base Fan

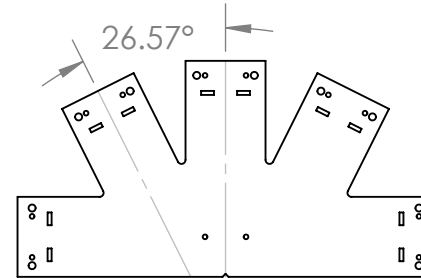

56643
6:12 Truss Base Fan

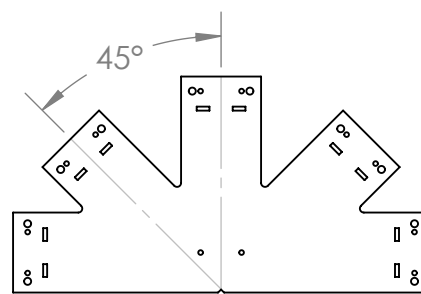

56644
12:12 Truss Base Fan

Scale: 1:12
Last updated: 4/14/2015

Truss Base Fan

Product & Packaging Specs

Box, Truss Base Fan

Item #: Box

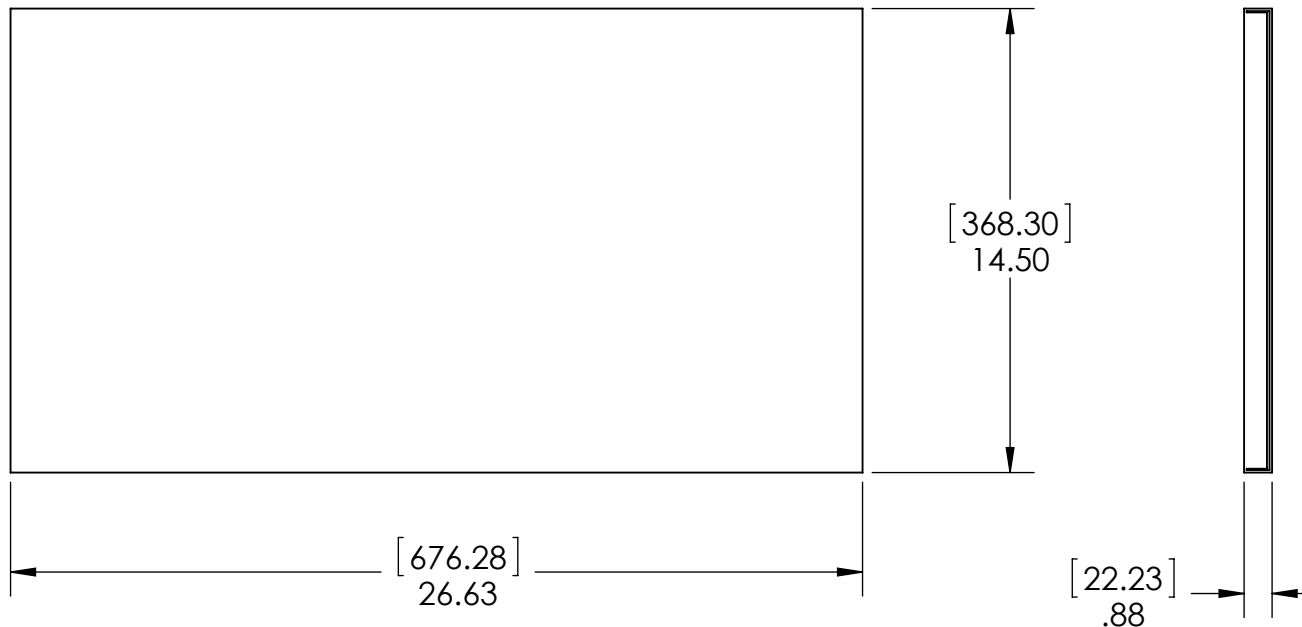
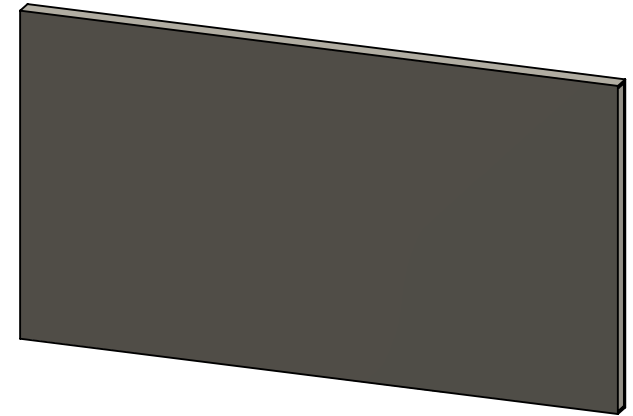

Material: Corrugated Paper
 Finish: See Artwork
 Weight: 0.37 LBS
 Scale: 1:8
 Last updated: 4/14/2015

Truss Base Fan

Product & Packaging Specs

Truss Base Fan Packing

Item #: Box packing

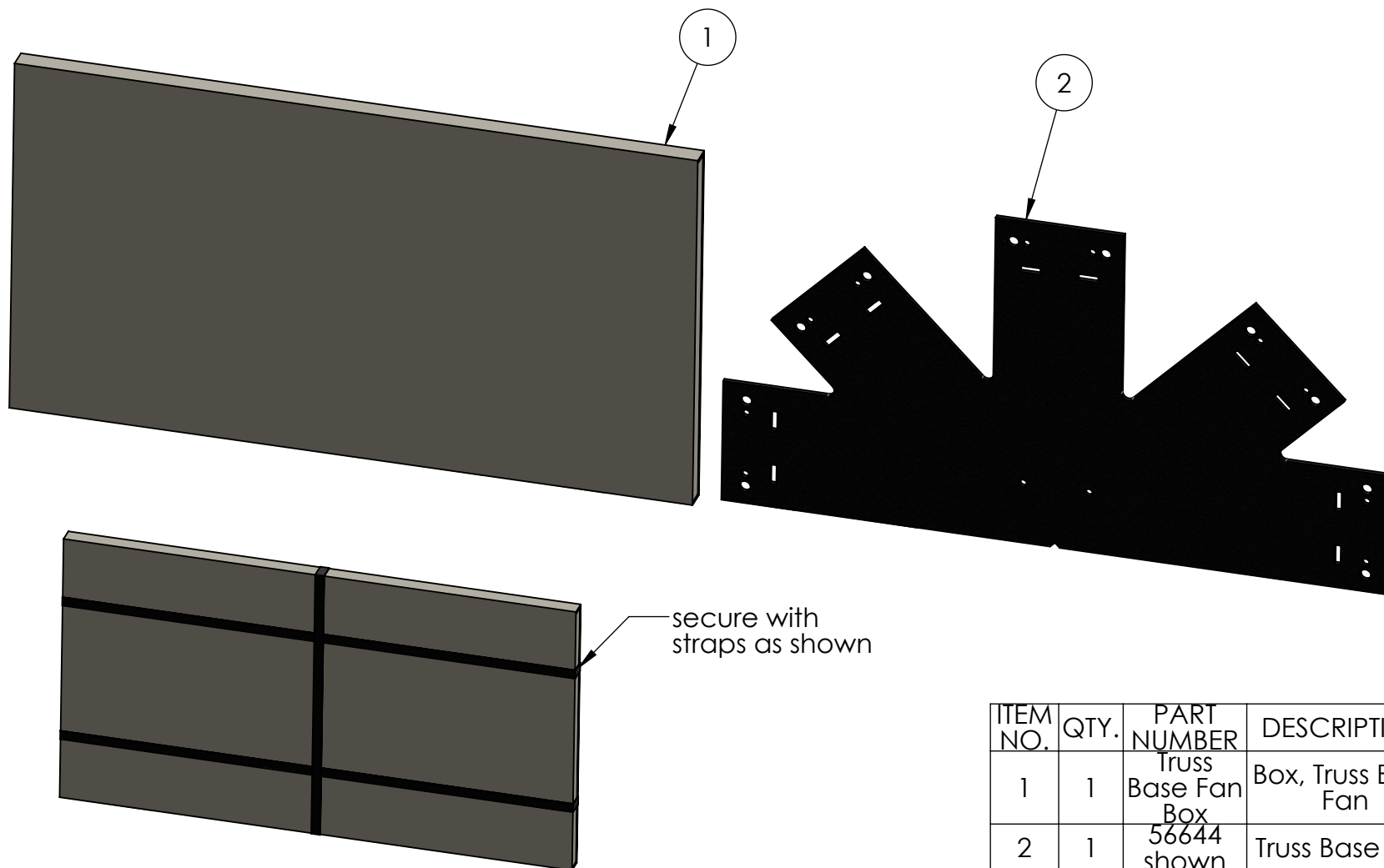

ITEM NO.	QTY.	PART NUMBER	DESCRIPTION
1	1	Truss Base Fan Box	Box, Truss Base Fan
2	1	56644 shown	Truss Base Fan

items not shown:

- installation instructions
- parts wrapped in packing foam sheet

Weight: 12.88 LBS
Scale: 1:6
Last updated: 4/14/2015

Truss Base Fan

Product & Packaging Specs

Case, Truss Base Fan Box

Item #: Case

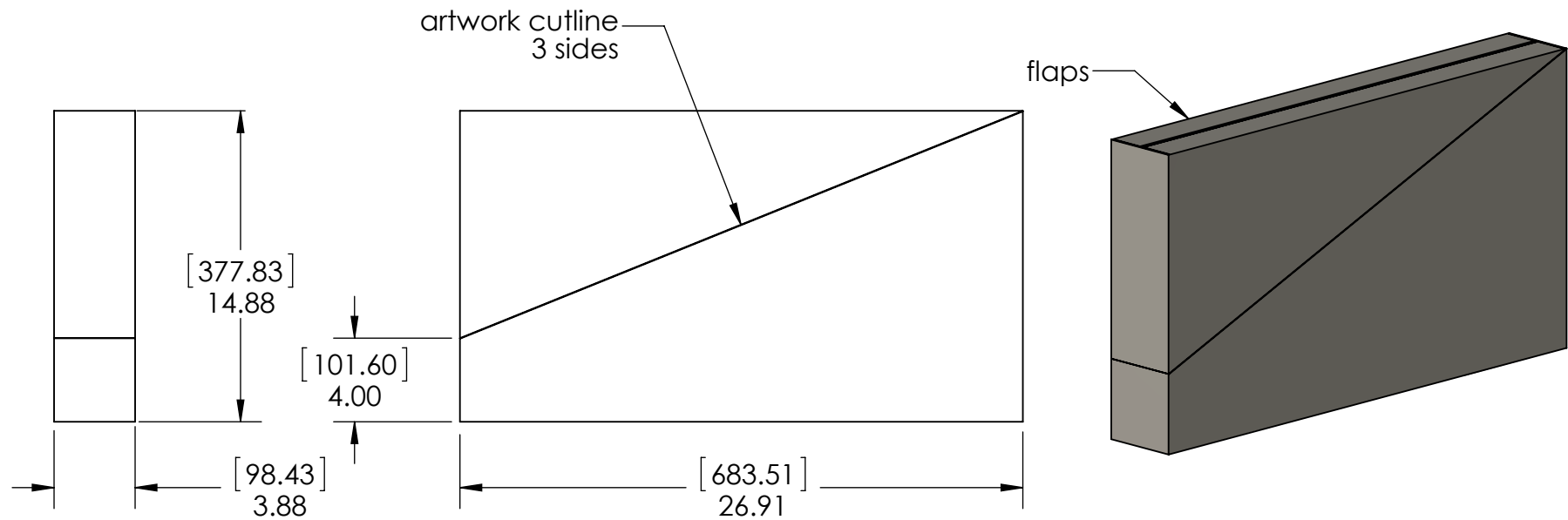

Material: Corrugated Paper
 Finish: See Artwork
 Weight: 0.50 LBS
 Scale: 1:8
 Last updated: 4/14/2015

Truss Base Fan

Product & Packaging Specs

Truss Base Fan Packing

Item #: Case packing

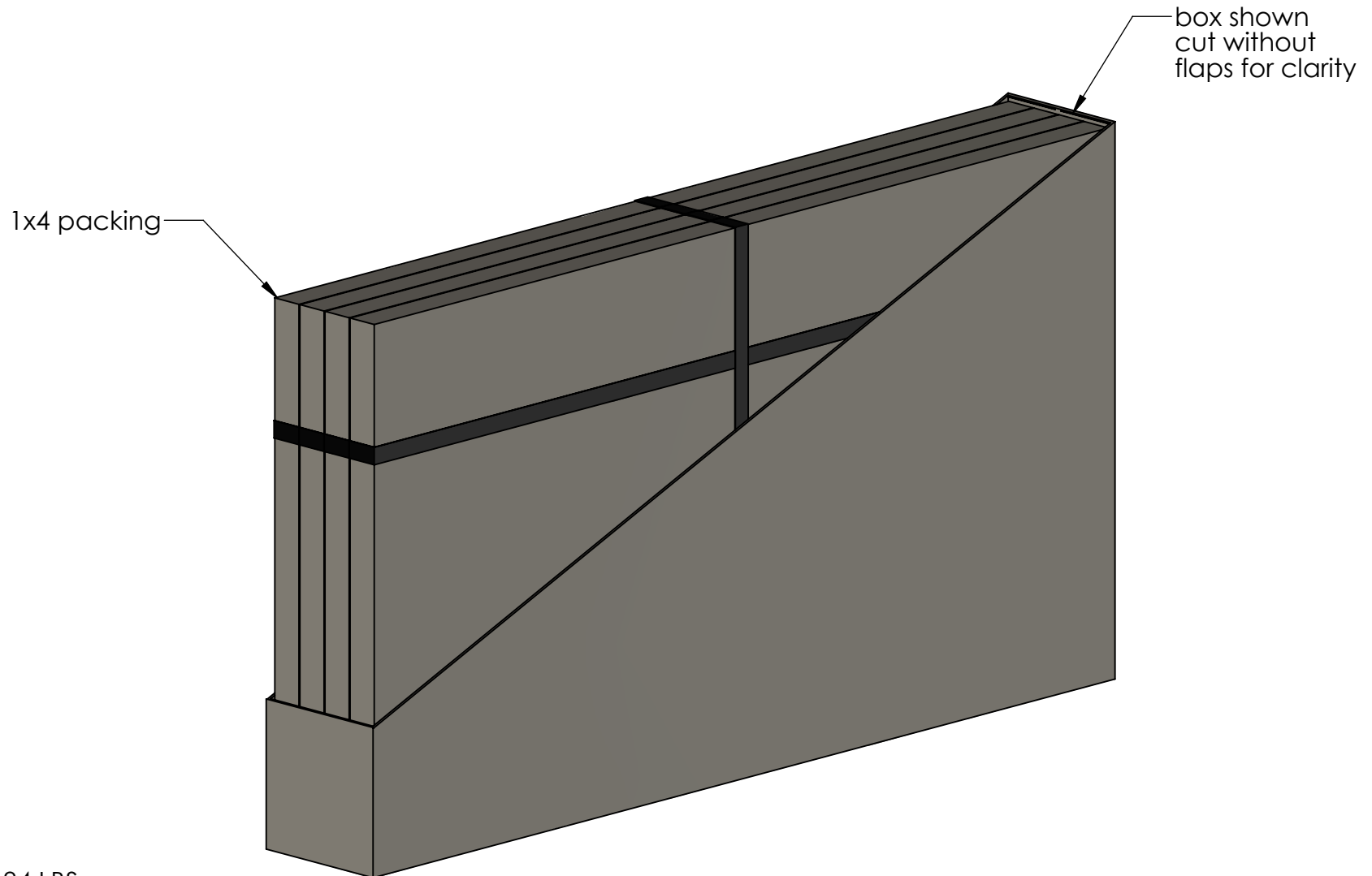

Weight: 51.84 LBS
Scale: 1:4
Last updated: 4/14/2015

Truss Base Fan

V1.00 - Installation Instructions effective May 1, 2015 and reflects information that available as of April 10, 2014. This information is updated periodically and should not be relied upon after May 1, 2015. Please visit www.OZCOBP.com to get current information

Product & Packaging Specs

Truss Base Fan Packing

Item #: Pallet packing

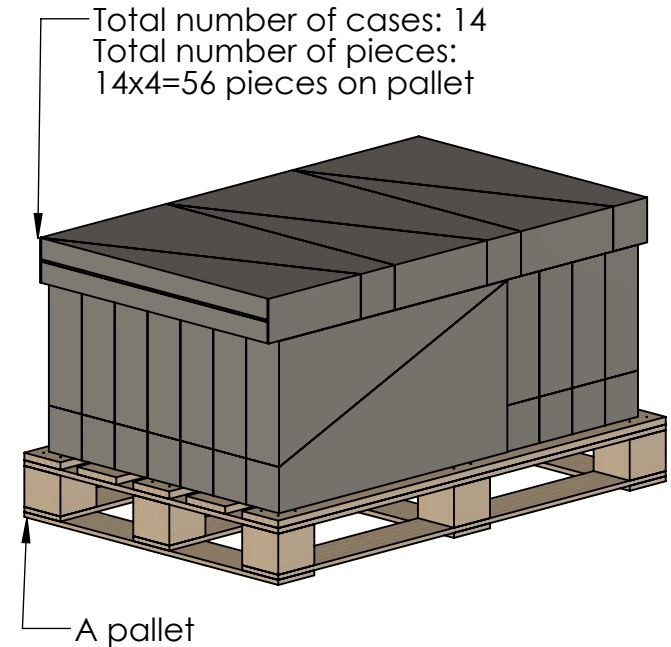
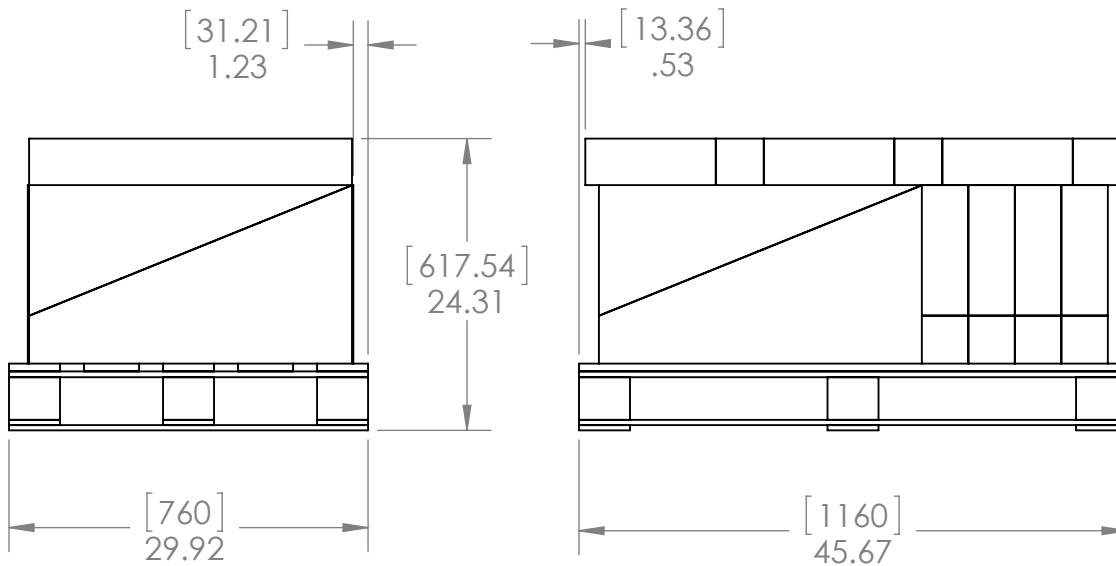

Weight: 784.49 LBS
Scale: 1:16
Last updated: 4/14/2015

Truss Base Fan

additional pallet packing instructions

- plywood on top layer
- strap to pallet
- clear wrap around boxes