

3-Seat Swing Assembly Instruction

Item# L-DNC373PST-C

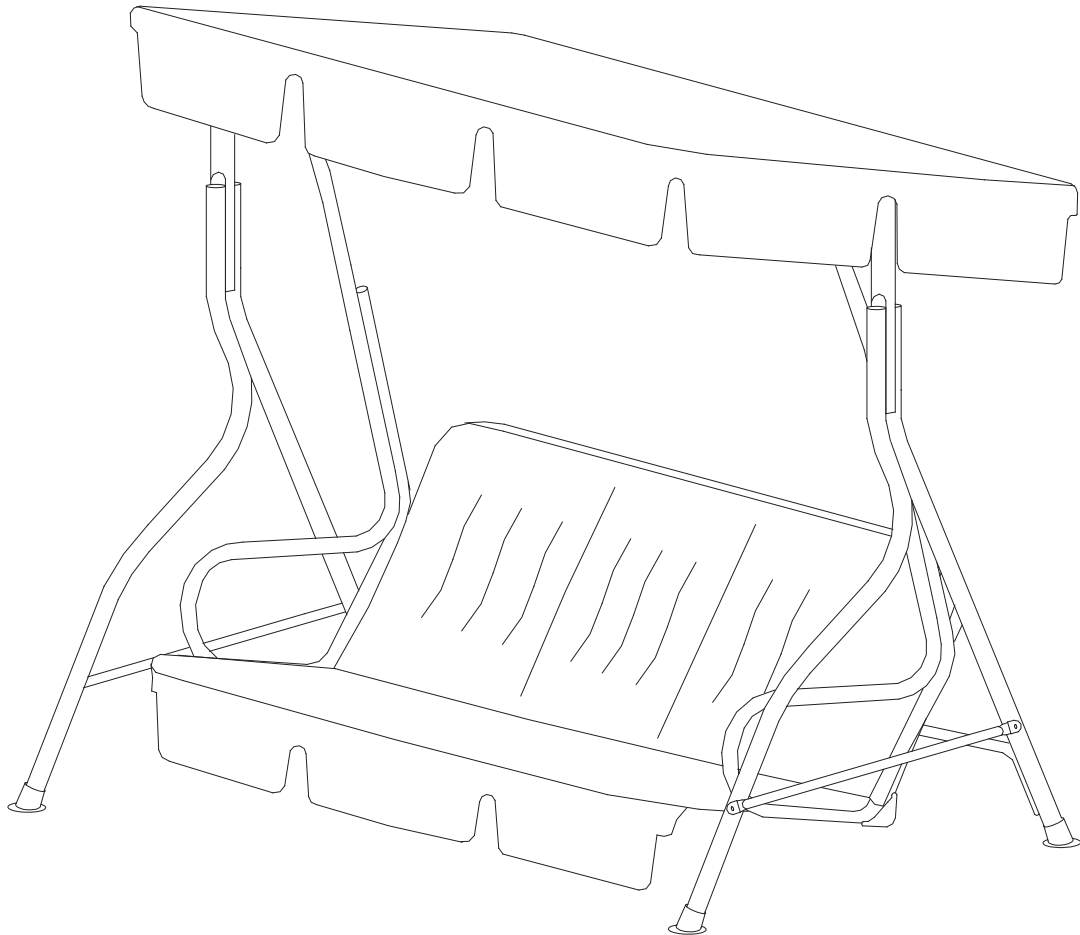

Warranty:

1. This swing must be assembled by two adults or more.
2. Tools are not included in packaging. The expected time required for assembly is usually 1-2hours.
3. Before assembly, ensure all parts are present and not damaged.
4. Assemble on a flat, hard, and debris-free surface.
5. Keep canopy swing away from fire or inflammable objects.
6. There are small parts present in the packaging. Keep all small parts away from children.
7. Children should be accompanied by an adult when using the swing.
8. Do not repack your swing until it is completely dry.
9. This swing must not be left erect in high wind conditions.

Part list:

No.	Part	Qty.	Image
1	Top support 1	1	
2	Top support 2	1	
3	Front leg	2	
4	Back leg	2	
5	Bottom support	2	
6	Back support 1	1	
7	Back support 2	1	

No.	Part	Qty.	Image
8	Handrail	2	
9	Seat	1	
10	Canopy side support	2	
11	Canopy support	2	
12	Canopy	1	
13	Cushion	1	

Hardware List:

No.	Part	Qty.	Image
A	M8*95 Screw	4	
B	M6*85 Screw	2	
C	M6*75 Screw	4	
D	M6*60 Screw	8	
E	M6*50 Screw	6	
F	M6*30 Screw	3	
G	Nut	2	

No.	Part	Qty.	Image
H	M6 Nut	23	
I	M6 Flat washer	46	
J	M6 Ball Nut	23	
K	Hook	2	
L	M8 Nut	4	
M	M8 Flat washer	8	
N	M8 Ball nut	4	

Assembly:

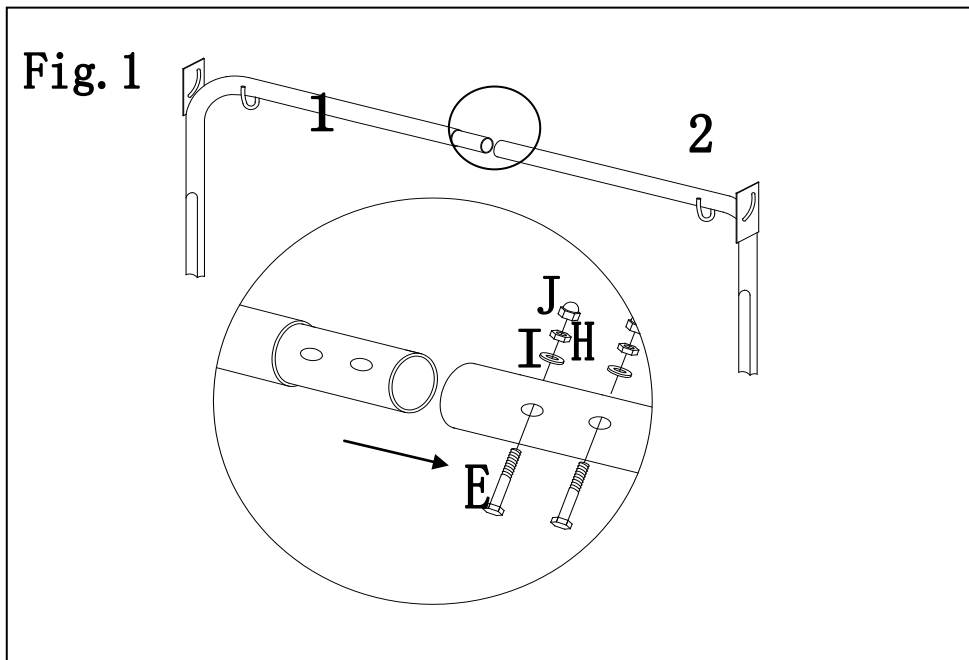

Fig.1: Insert the top support 1 (1) into the tube of the top support 2 (2) as the arrow direction by using screw (E), flat washer (I), nut (H) and ball nut (J) to connect.

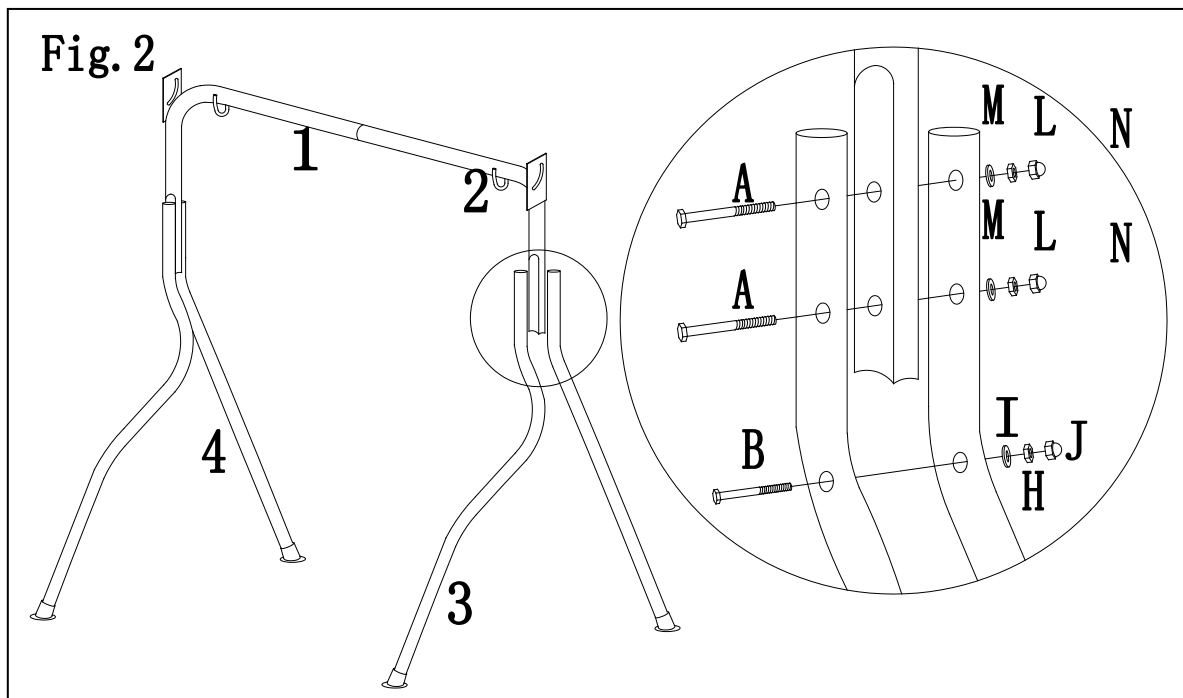

Fig.2: Using screw (A), flat washer (M), nut (L) and ball nut (N) to connect front leg (1) and back leg (2) with top supports (1 and 2). Then using screw (B), flat washer (I), nut (H) and ball nut (J) to connect front leg (3) with back leg (4).

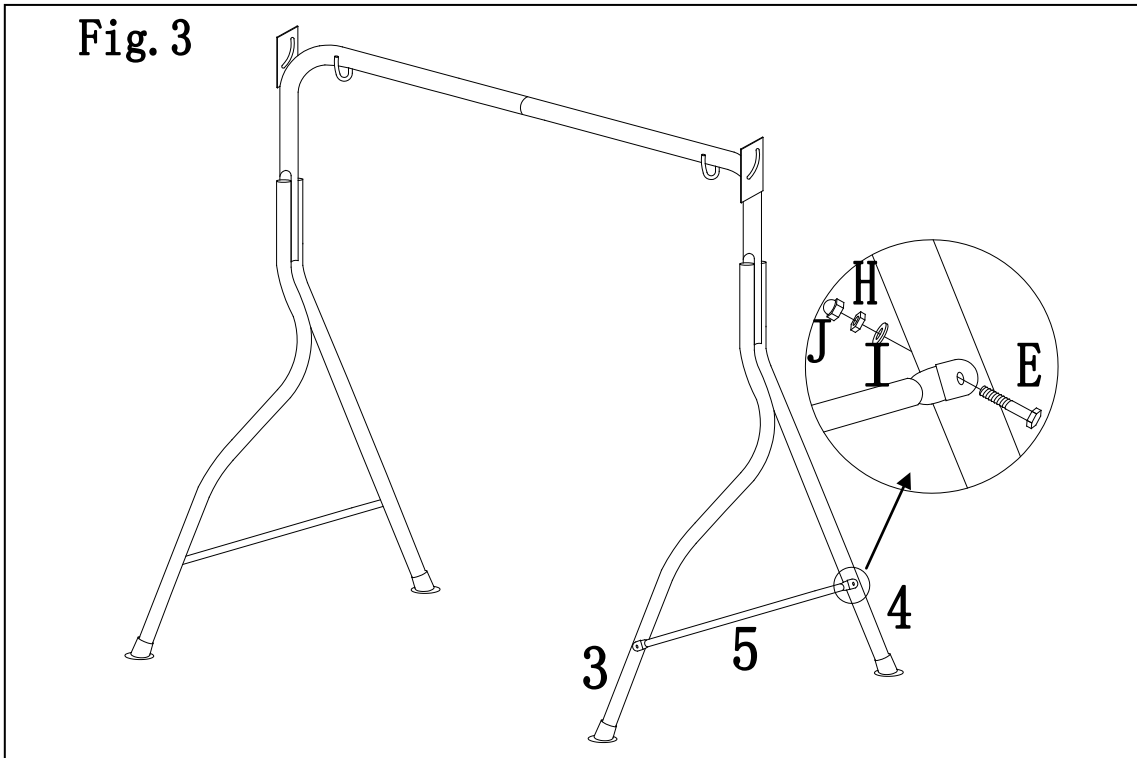

Fig.3: Using screw (E), flat washer (I), nut (H) and ball nut (J) to connect bottom support (5) with front leg (3) and back leg (4).

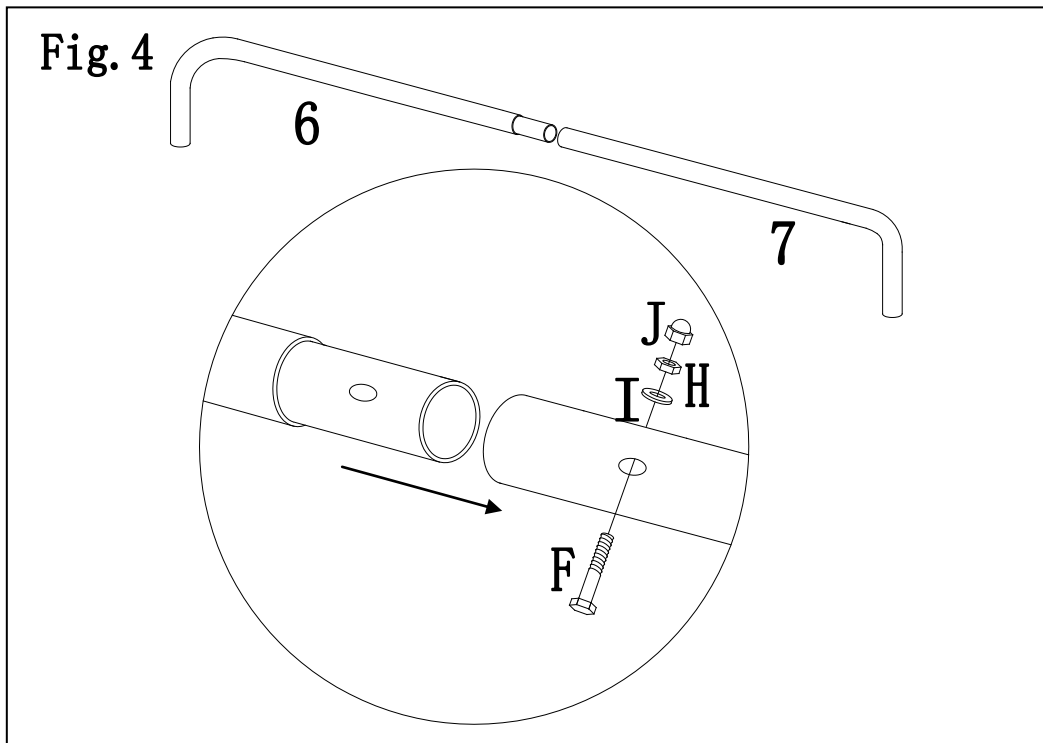

Fig.4: Insert the back support 1 (6) into the tube of back support 2 (7) by using screw (F), flat washer (I), nut (H) and ball nut (J) to connect the back supports (6 and 7).

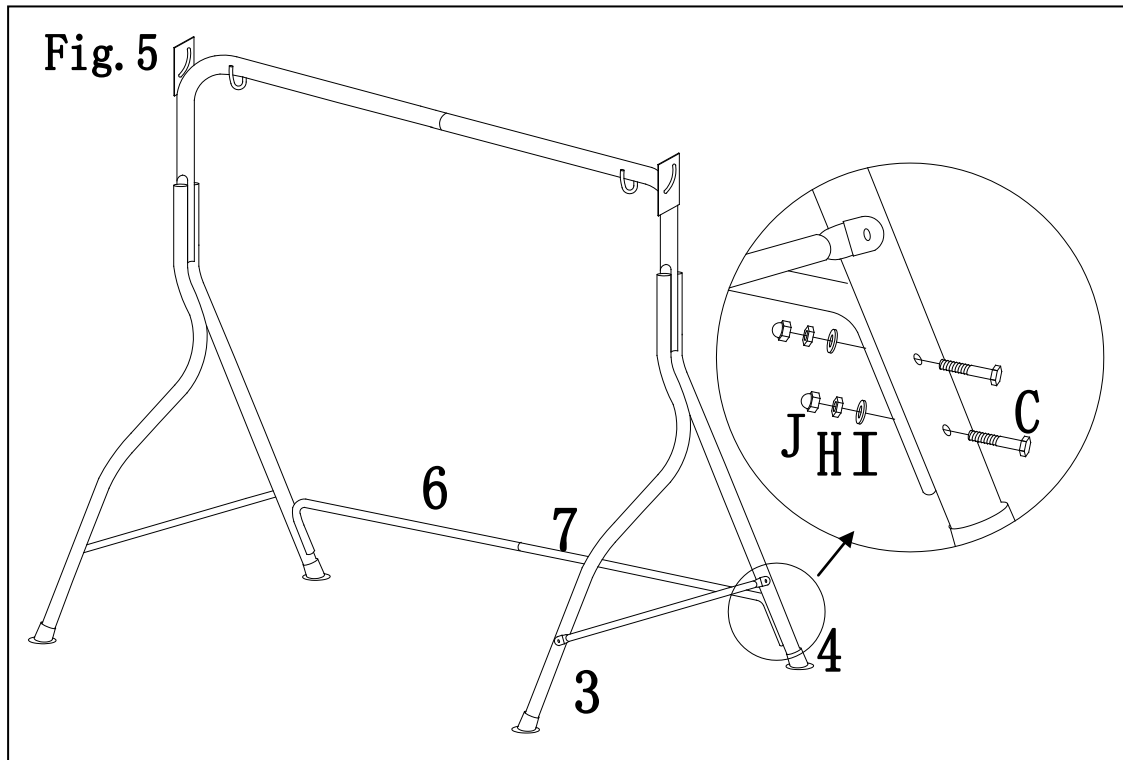

Fig.5: Using screw (C), flat washer (I), nut (H) and ball nut (J) to connect assembled back supports (6 and 7) with back leg (4).

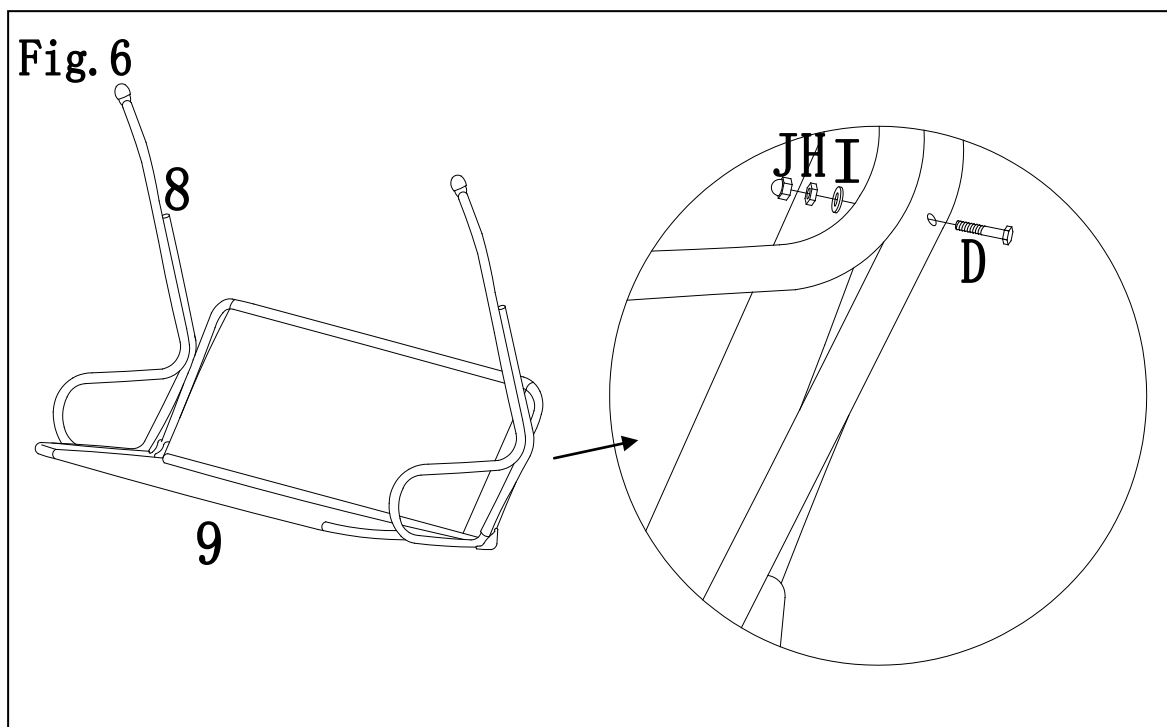

Fig.6: Using screw (D), flat washer (I), nut (H) and ball nut (J) to connect handrail (8) with seat (9).

Fig. 7

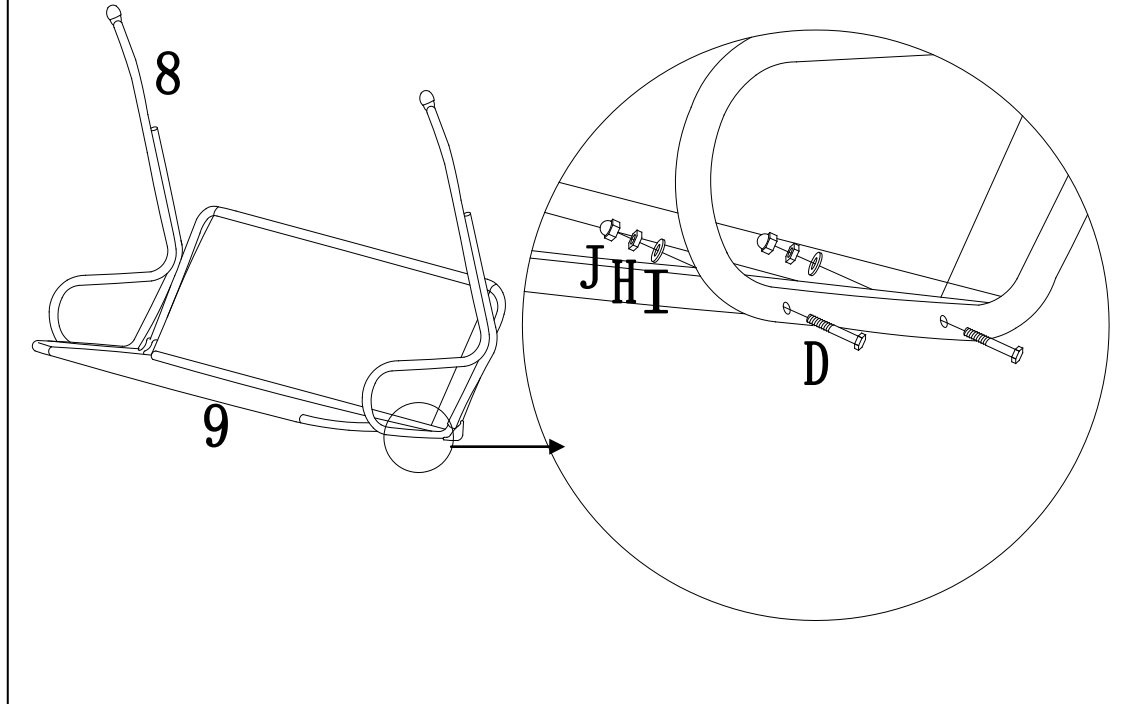

Fig.7: Using screw (D), flat washer (I), nut (H) and ball nut (J) to connect the bottom end of the handrail (8) with bottom end of the seat (9).

Fig. 8

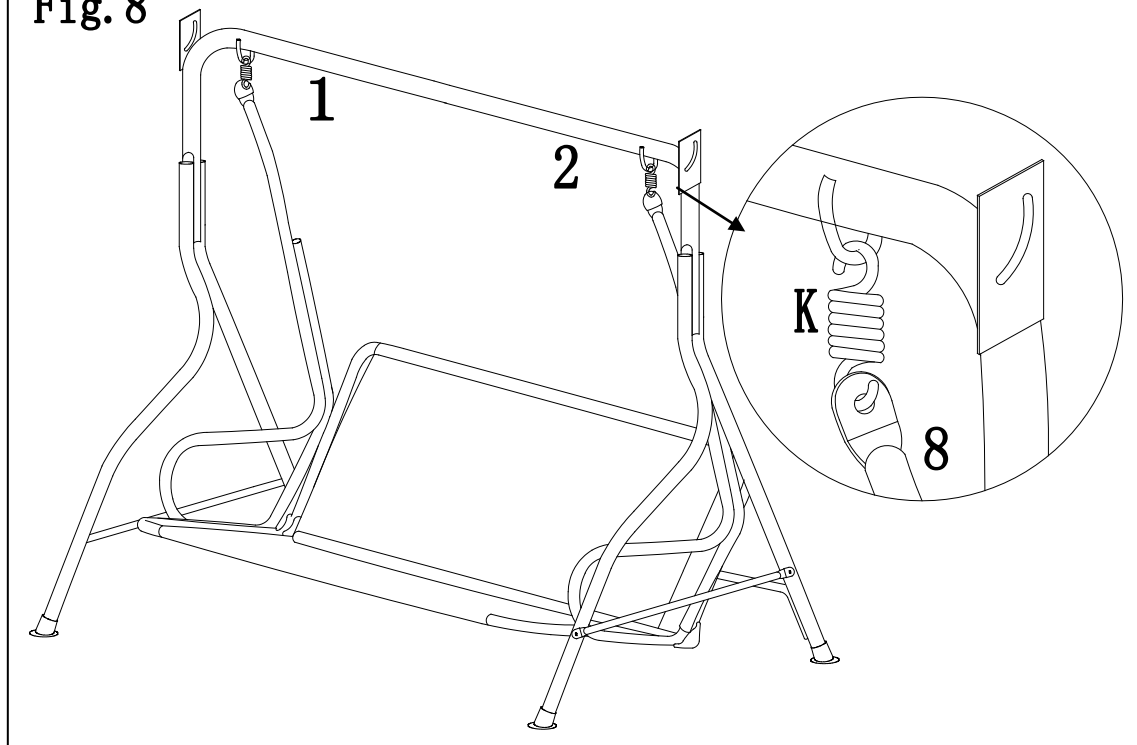

Fig.8: Attach one end of the hook (K) to the handrail (8) and other end to the rings on the top supports (1 and 2).

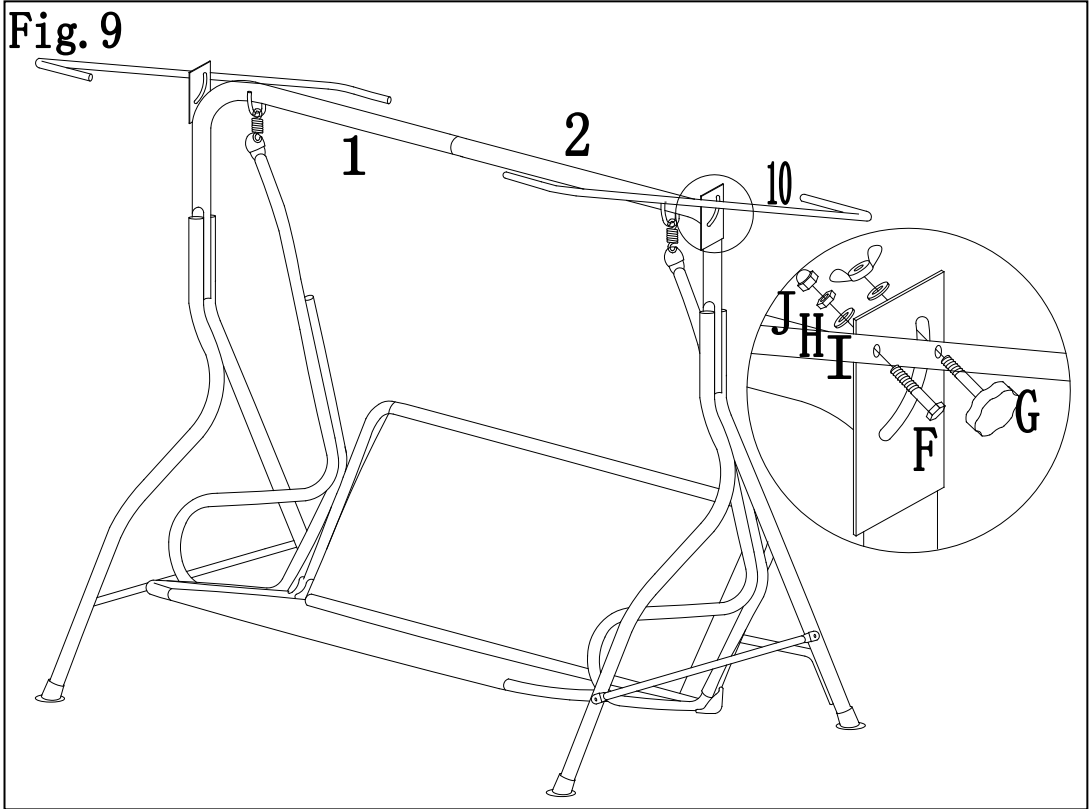

Fig.9: Using screw (F), flat washer (I), nut (H) and ball nut (J) to connect canopy side support (10) with top supports (1 and 2). Then using nut (G) to connect canopy side support (10) with top supports (1 and 2).

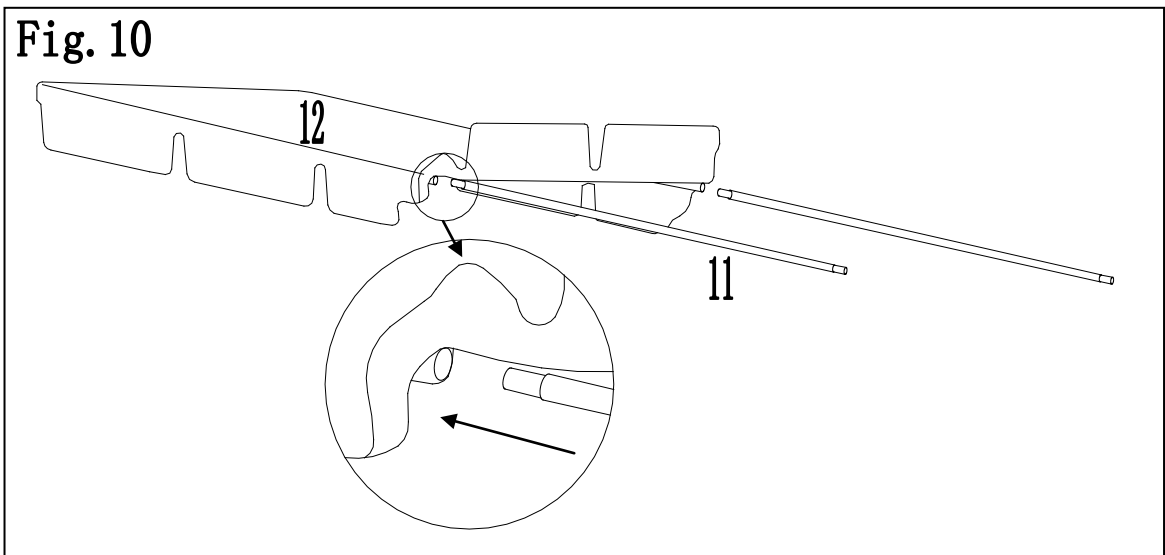

Fig.10: Insert the canopy support (11) into the canopy (12) as the arrow direction.

Fig. 11

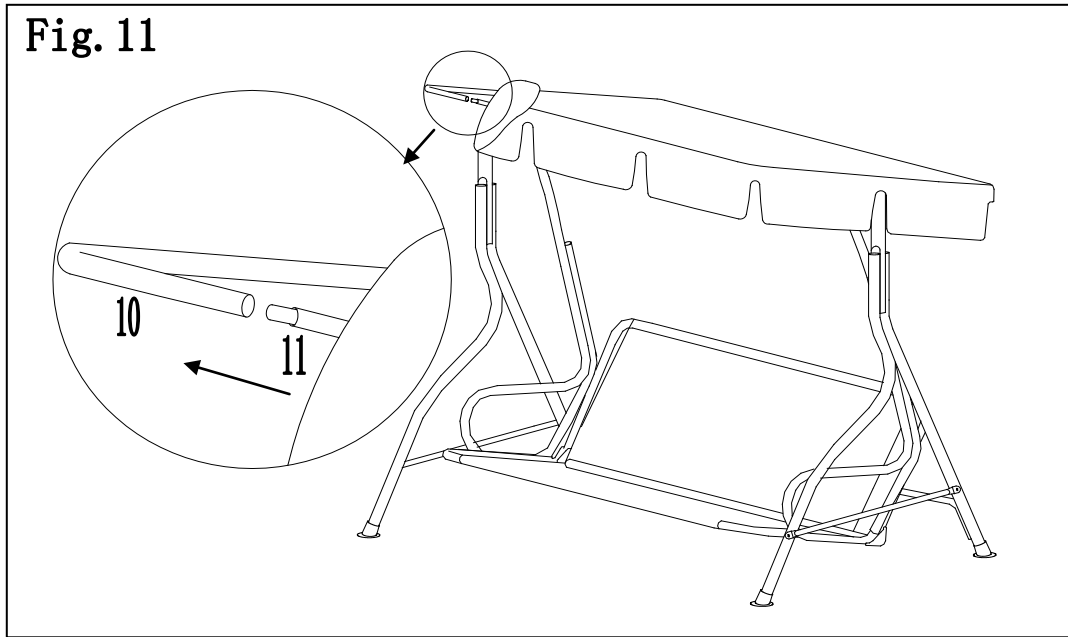

Fig.11: Insert the canopy support (11) into the canopy side support (10) as the arrow direction, then attach the canopy (12).

Fig. 12

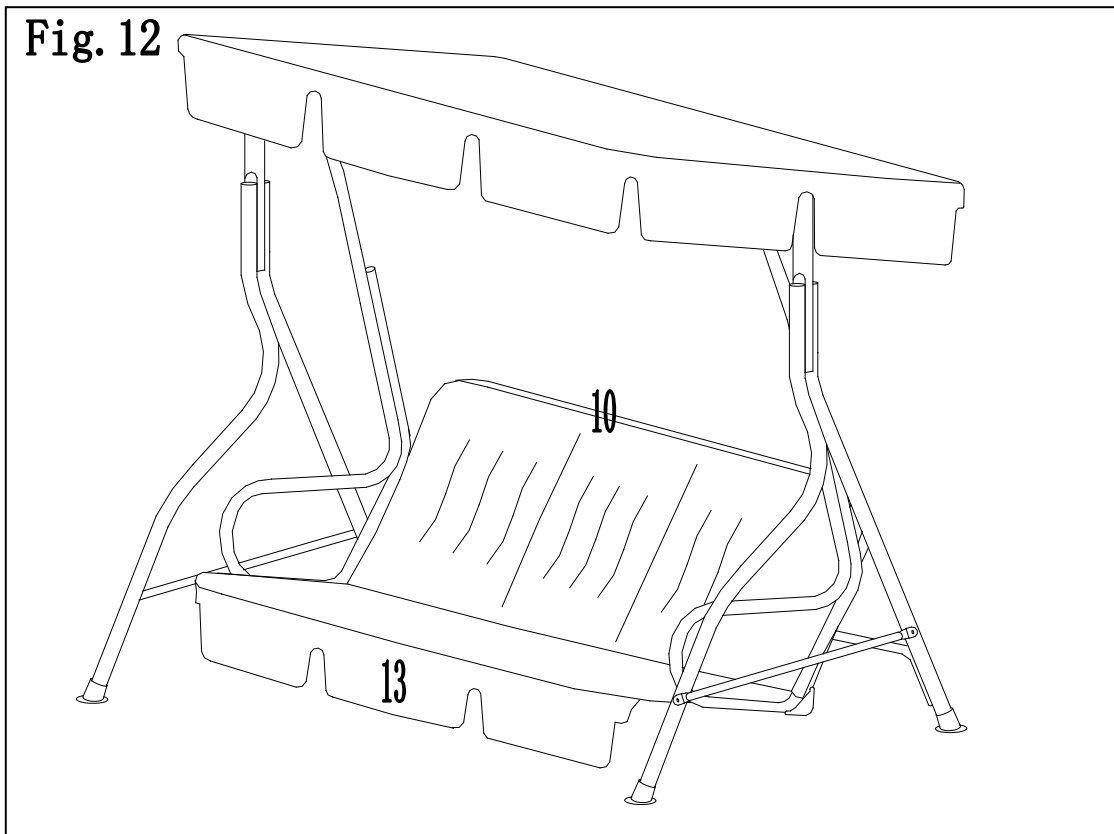

Fig.12: Attach the cushion (13) on the seat (10).