

A few simple steps to ensure
perfect water, every time.



Filter Installation Instructions

If you are having trouble with your water cooler please see the following solutions. You can also view our trouble shooting videos at the website below. Please feel free to contact us with any questions.



1-800-256-0695



support@avalonproducts.com



bit.ly/2Fv7zvg

Contents

About Your Filters

Tech Specs 5

Countertop Water Coolers

Replacing the Filters 7-10

Standing Water Coolers

Replacing the Filters 11-14

About Your Filters

Tech Specs

Activated Carbon Filter

Rated Flow	0.5GPM 1.9L/min
Max Purified Water Capacity	1500 US gal (2839L)/6 months
The Maximum Working Pressure	125PSI
Maximum Operating Temperature	100°F



This product conforms to NSF/ANSI 42 and 53 for the reduction of Chlorine taste and odor, nominal particulate class I, lead and cysts.

Sediment Filter

Rated Flow	0.79GPM 1.9L/min
Max Purified Water Capacity	1500 US gal (2839L)/6 months
The Maximum Working Pressure	58PSI
Maximum Operating Temperature	100°F

This product can reduce coarse filtration of original water, filter out mud, sand impurity, iron rust, suspension, etc.

Countertop Water Coolers

Replacing the Filters

1. Shut off the valve located at the connection to the water source or the valve located to the left of the Sediment filter on the back of the unit.

For models: A9CTELECTRICSS, A9ELECTRICBLK, A9ELECTRICWHT

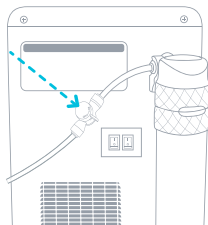

For models: A8CTBOTTLELESSBLK, A8CTBOTTLELESSWHT, A12-CTPOU, A15

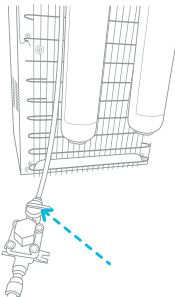

Replacing the Filters

2. Twist the expired filters to remove them from the Filter Adapters at the back of the unit or inside the side cabinet depending on the model. Insert the new filters into the Filter Flushing Adapters by twisting them into place and rotating them clockwise. Make sure the “Sediment” filter is on the left side of the “Carbon Block” filter for models that have both filters hanging on the back or both filters in the side cabinet.

For models: A9CTELECTRICSS, A9ELECTRICBLK, A9ELECTRICWHT

For A9 models make sure the “Sediment” filter is installed on the back of the unit while the “Carbon Block” filter is in the side cabinet.

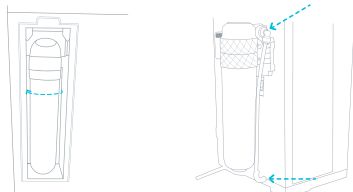

For models: A8CTBOTTLELESSBLK, A8CTBOTTLELESSWHT, A12-CTPOU, A15

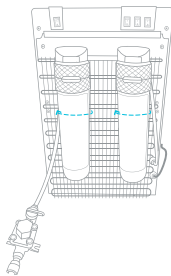

Replacing the Filters

After replacing the filters, use the following instructions to reset the filters based on your model. If you do not properly reset the filters, the filter change indicator will continue to alert you.

A9CTELECTRICSS, A9ELECTRICBLK, A9ELECTRICWHT

Press and hold the nightlight button for 5 seconds. Press and hold this button until the filter indicator stops blinking.



A8CTBOTTLELESSBLK, A8CTBOTTLELESSWHT, A12- CTPOU, A15

Press and hold the filter reset button located on the left side of the unit. Press and hold this button until the hot and cold indicator lights stop blinking.

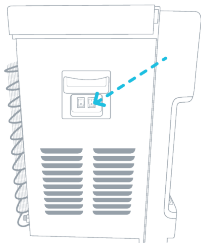

Replacing the Filters

In order to flush the new filters, allow the water to flow from the cold water spout for approximately 2 minutes.

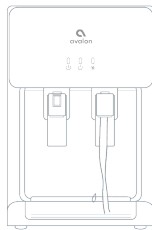
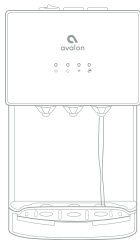

2 min

Standing Water Coolers

Replacing the Filters

1. Shut off the valve located at the connection to the water source or the valve located to the left of the Sediment filter inside the cabinet.

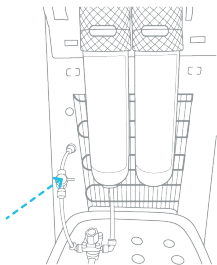

2. Twist the expired filters to remove them. Insert the new filters into the filter adapters by twisting them into place and rotating them clockwise. Make sure the Sediment Filter is on the left and the Carbon Block Filter is on the right.

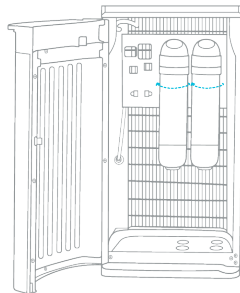

Replacing the Filters

After replacing the filters, use the following instructions to reset the filters based on your model. If you do not properly reset the filters, the filter change indicator will continue to alert you.

A5BOTTLELESS, A7BOTTLELESS, A13

After replacing the filters, press and hold the filter reset button located on the upper left side of the cabinet. Press and hold this button until the filter indicator light turns off (A5) or until the heating and cooling indicator lights stop blinking (A7).

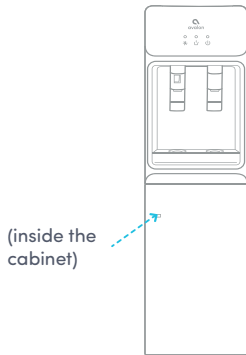
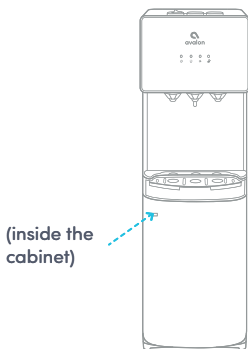

Replacing the Filters

In order to flush the new filters, allow the water to flow from the cold water spout for approximately 2 minutes.

