

Mounting Into the Ground

Privacy screens must be well secured in the event of high winds, etc. We have provided two ground anchoring stakes for securing the privacy screen either into the ground or into a concrete footing. If you are installing your trellis on concrete or a deck, see your hardware store for the appropriate galvanized bracket hardware.

STEP ONE

Install the Ground Anchor Stakes

Insert the ground anchoring stakes into the bottom of the privacy screen posts. Secure with screws into the four pre-drilled holes.

STEP TWO

Install Trellis into Ground

A

Move the screen to its final location. When you are satisfied with the location, mark the positions of the posts, then move the screen aside and lay it carefully on its side. Excavate the 2 post holes approximately 18" deep x 6" diameter. Carefully move the screen back into position.

B

Level it both vertically and horizontally into the excavated holes.

C

Backfill the holes with the excavated soil.

STEP THREE

Install the Post Caps

OPTIONAL

Mounting to Barcelona Planter Box

(Purchase Separately)

Please see instructions illustrated with the planter box.

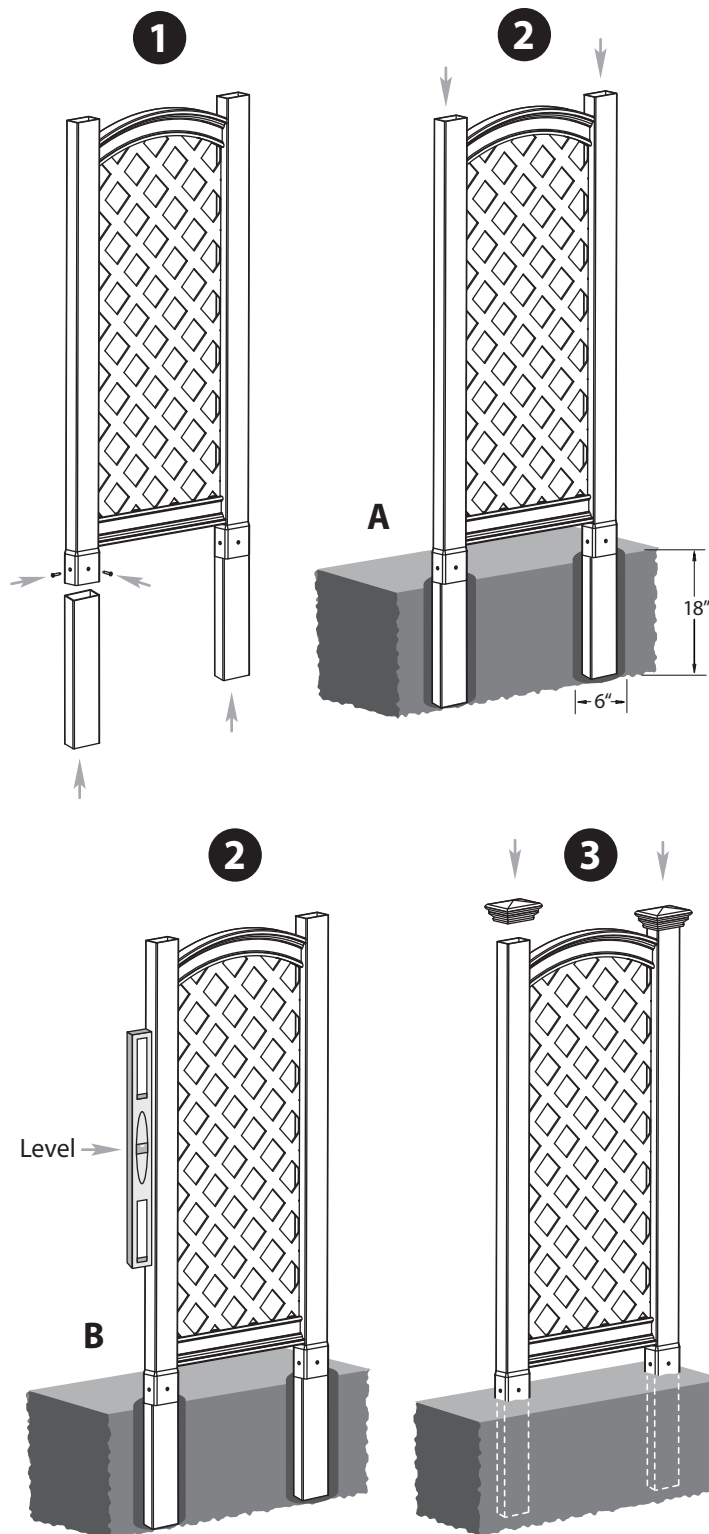

Eden[™]

Enduring Garden Architecture

1915 Dove St., Port Huron MI USA 48060
Toll Free Phone: 1 800 282 9346 Toll Free Fax: 1 877 464 9286