

CONVENIENT HEIGHT®

Product: Model S 20" bowl height two-piece elongated toilet

Let's Rise Above the Standard Height.™



CONVENIENT HEIGHT®

Product: Model S 20" bowl height two-piece elongated toilet

PRODUCT SPECIFICATION SHEET

Features

- Vitreous china
- Two-piece toilet: tank and bowl
- Bowl shape: Compact elongated
- Bowl height: 20 inches
- Dual flush valve flushing system
- 12" rough-in
- 2-1/8" glazed trapway
- 1.28 gpf full flush, 0.9 gpf partial flush
- Left-hand positioned trip lever location
- 7" x 9" water area
- 27" x 12-1/2" x 36"

Color/Finish

- Pearl White
- Color group: 0 White

Trip lever

- Left
- Front

CONVENIENT HEIGHT®

The Convenient Height® product Model S two-piece toilet

Diagram of measurements and specification drawings

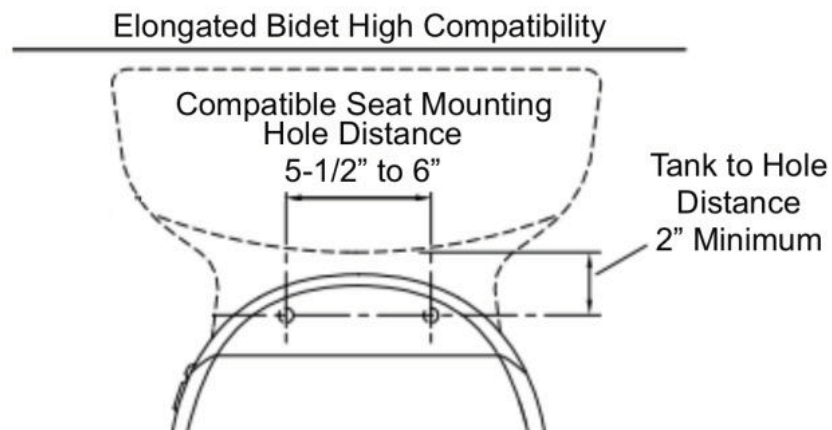
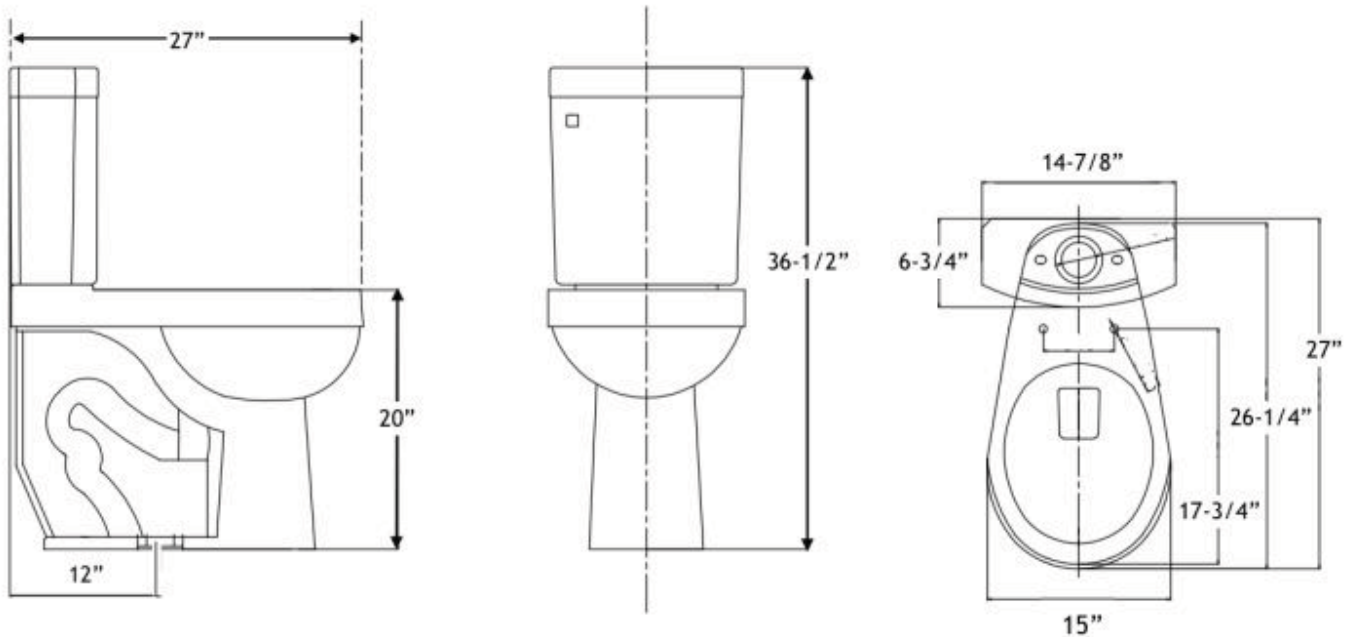

NOTE: Drawings for bidet installation are measurement reference purposes only.
Bidet wash seat is not included