

INSTALLATION GUIDELINES

FOUNDATION VENT WELLS

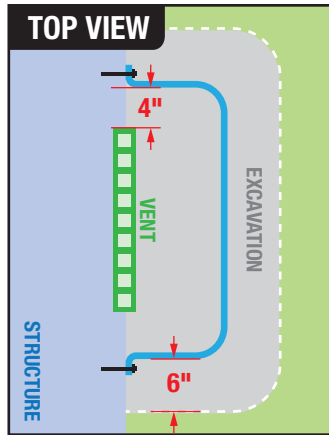
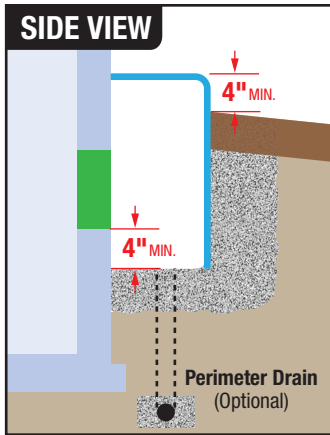

Sizing up the excavation.

The top of the **vent well** should be 4-6" above grade.

The depth of the hole should be at least 4" deeper than the bottom of the vent.

The **vent well** should be at least 4" wider than the vent opening.

The excavation should be approximately 6" larger than the **vent well**.

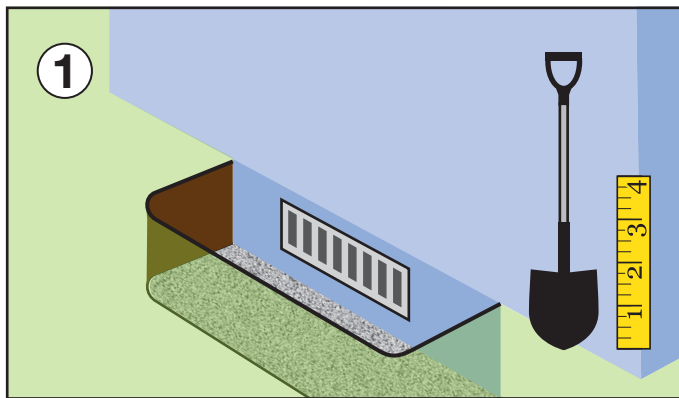

Pre-fill hole with at least 4" of gravel or drain rock to promote drainage. If flooding is a concern, connection to a perimeter drainage system might be required.

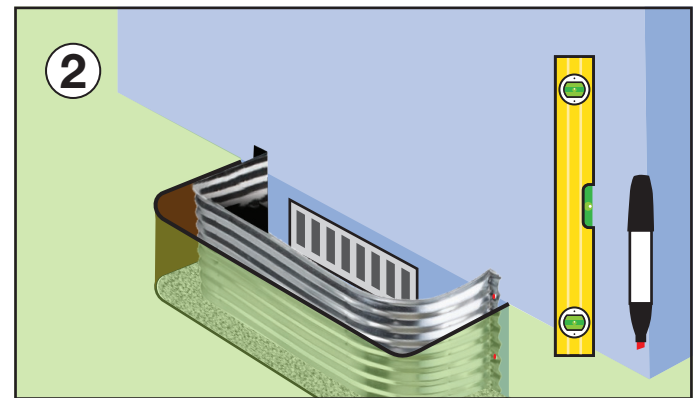

Position the vent well against the foundation and mark the location of the holes. Be sure the vent well is centered on the vent and level with the house.

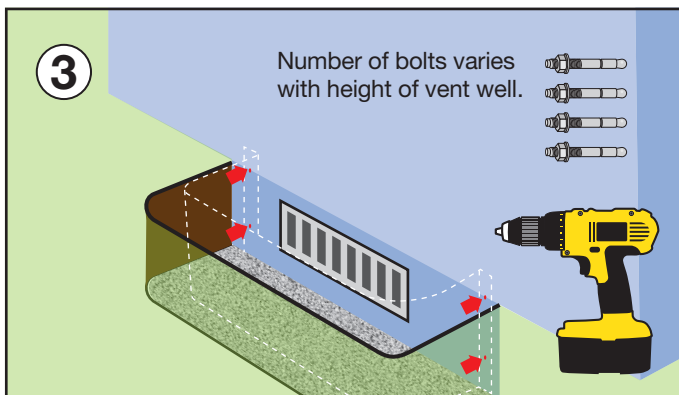

Drill holes to receive the anchor bolts, then secure the vent well to the foundation using anchor bolts and optional flat washers.

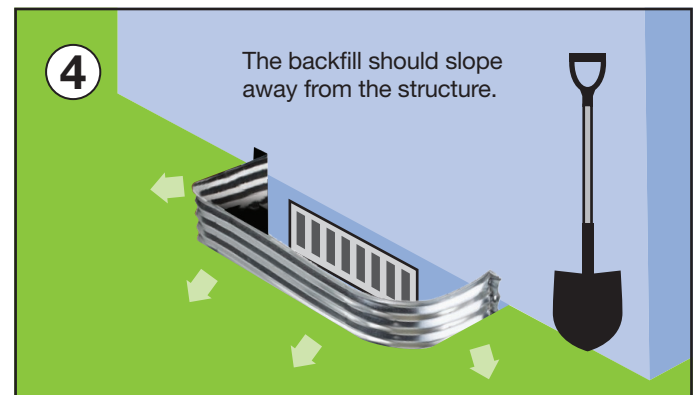

Add gravel to the well bringing the level up to 2" below the bottom of the vent opening. Backfill the area between the vent well and the hole.



CAUTION! Foundation Vent Wells have sharp edges. When working with galvanized sheet metal or power tools, gloves and eye protection are absolutely required.

These installation guidelines are for use with typical or standard applications. It is always recommended to seek advice from a licensed professional, and to check with your local building inspector or building permit office for approvals and possible variations that may apply.