

Model No. MSS507F

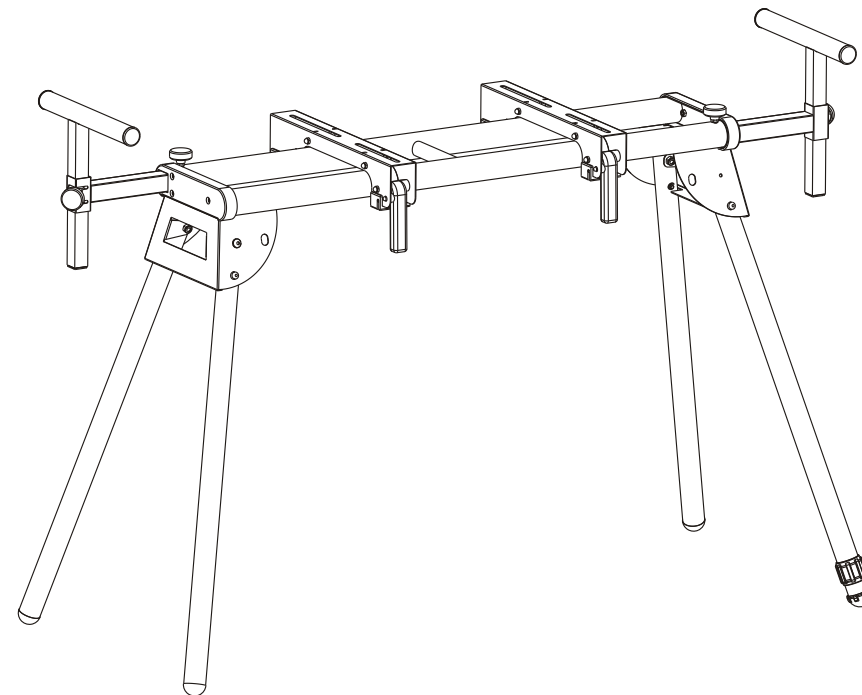

## MITER SAW STAND WITH EXTENSION SUPPORTS



**IMPORTANT:**  
Please read this manual before using this  
Miter Saw Stand and save it for reference.

**INSTRUCTION  
MANUAL**

# TABLE OF CONTENTS

Quick start guide	4-5
Specifications	6
Safety guidelines	7
Key parts diagram	8
Operating instructions	9
Warranty	10

**NOTE:** If any parts are missing or damaged, or if you have any questions, please call our toll-free helpline at 1-800-689-9928.



**SAVE THESE INSTRUCTIONS.**  
This manual contains important safety and operating instructions.  
Read all instructions and follow them with use of this product.

1

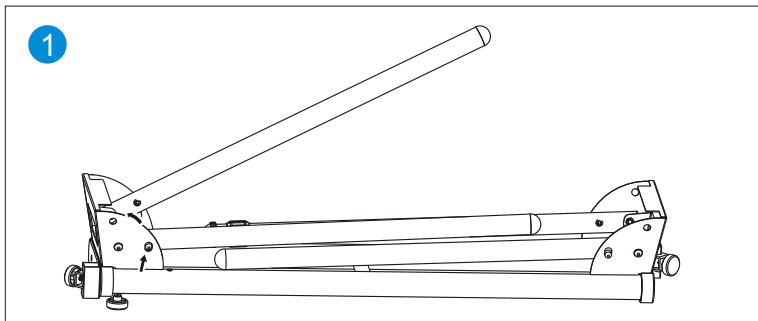

2

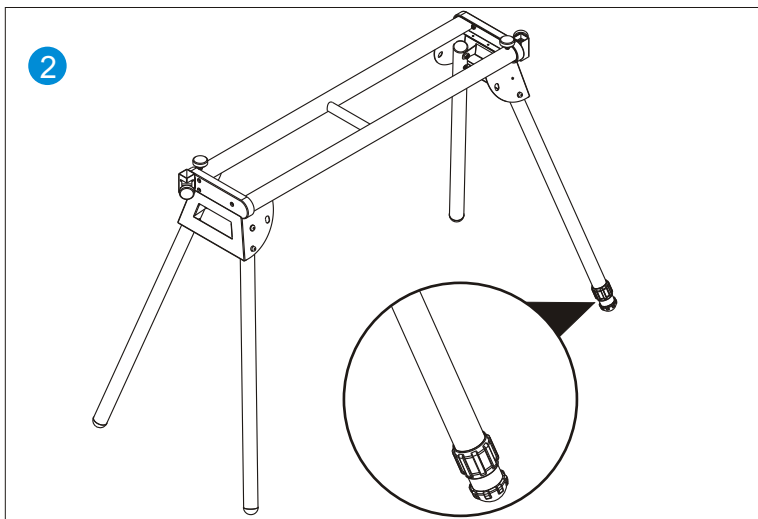

3

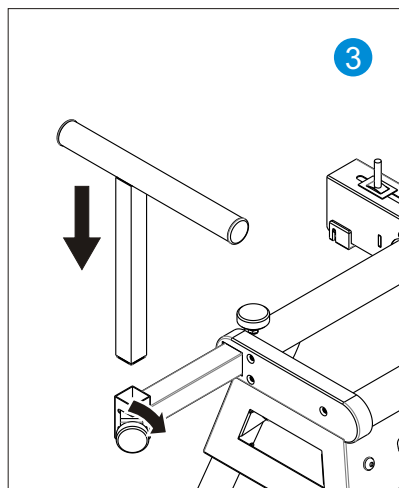

4

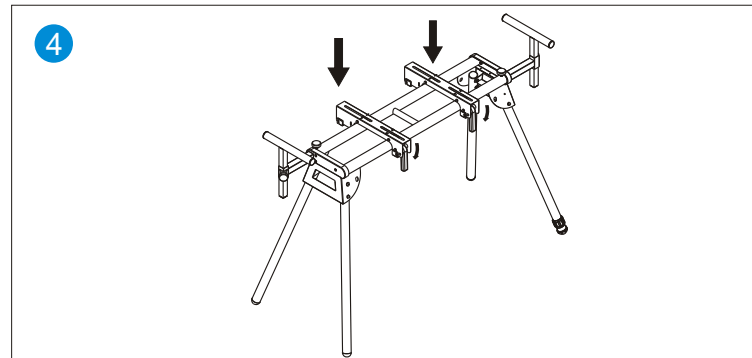

5

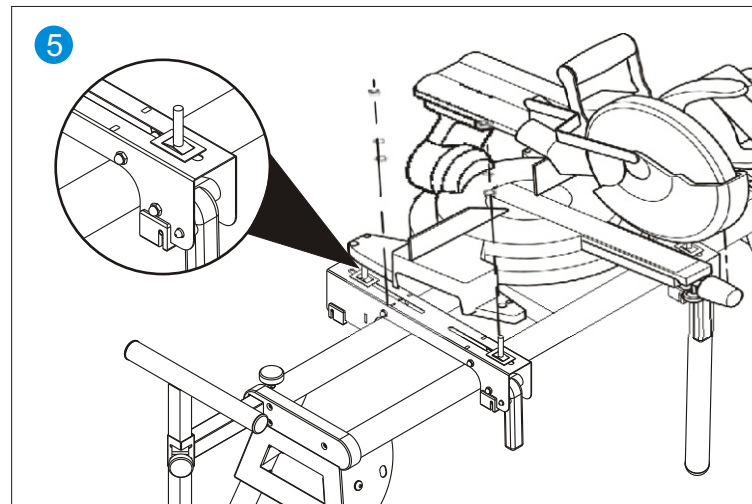

6

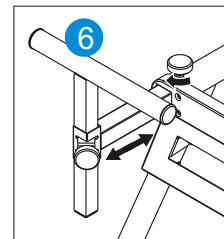

7

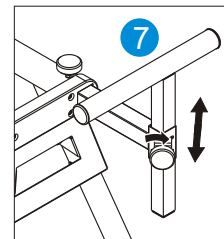

**NOTE:** If any parts are missing or damaged, or if you have any questions, please call our toll-free helpline at 1-800-689-9928.



#### WARNING

- Before operating this tool, carefully read this Instruction Manual and all of the labels affixed to the tool. Failure to follow all warnings and instructions may result in electric shock, fire and/or serious injury.
- Save all warnings and instructions for future reference.

SPECIFICATIONS

Maximum load	300 lb (136.1 kg)
Length of saw stand without table extension	39 3/4" (1. 01m)
Length of saw stand with table extension	71 1/2" (2. 4m)
Maximum height	32 1/4" ( 82 cm) from ground to tabletop
Weight	25 lb (11.3 kg)

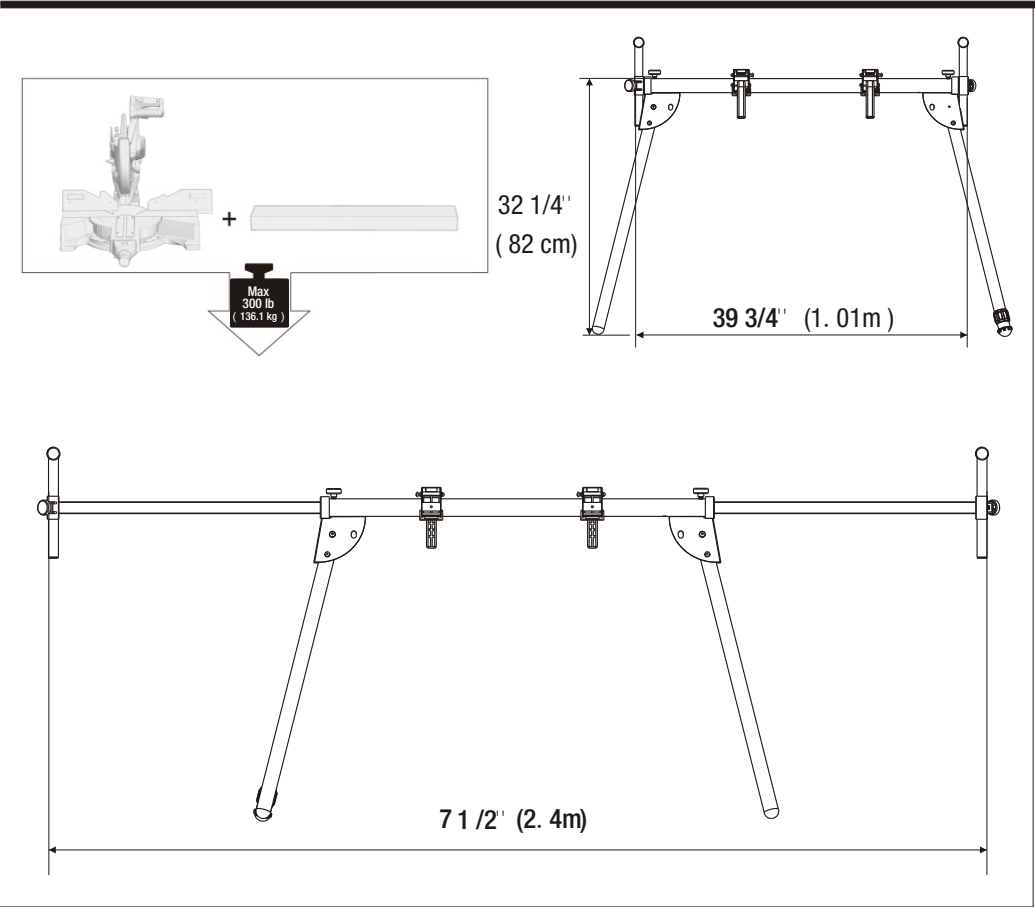

WARNING

• The maximum load (power tool+ workpiece) of the saw stand is 300 lb(136.1 kg). Do not overload the saw stand and do not use it as a ladder or scaffolding.

SAFETY GUIDELINES

General Safety Rules



Read all warning notes and instructions enclosed with the saw stand and the power tool to be mounted. Failure to follow the warnings and instructions may result in electric shock, fire and/or serious injury.

Safety Warnings for Saw Stands

- ▶ Pull the plug from the mains receptacle and/or remove the battery from the power tool before making adjustments on the tool or changing tool accessories. Unintentional switching on of the power tool is the cause of many accidents.
- ▶ Assemble the saw stand in the proper manner before mounting the power tool. Proper assembly is important to prevent the risk of a collapse of the saw stand.
- ▶ Attach the power tool securely to the saw stand before using it. Slipping off of the power tool on the saw stand can lead to loss of control.
- ▶ Place the saw stand on a firm, level and horizontal surface. If the saw stand can slip off or wobbles, the power tool or the workpiece cannot be uniformly and securely guided.
- ▶ Do not overload the saw stand and do not use it as a ladder or scaffolding. Overloading or standing on the saw stand can lead to the upward shifting of the centre of gravity of the stand and its tipping over.
- ▶ When working or transporting, take care that all bolts and connecting elements are firmly tightened. The Mounting Brackets for the power tool must always be firmly locked. Loose connections can lead to instability and inexact sawing.
- ▶ Mount and dismount the power tool only when it is in the transport position (for instructions on the transport position, also see the operating instructions of the respective power tool). Otherwise, the power tool can have such an unfavourable centre of gravity that it cannot be held securely.
- ▶ When the power tool is mounted to the Mounting Brackets operate it exclusively on the saw stand. Without the saw stand, the power tool with the Mounting Brackets on does not stand securely and can tip over.
- ▶ Ensure that long and heavy workpieces do not affect the equilibrium of the saw stand. Long and/or heavy workpieces must be supported at the free end.
- ▶ Keep your fingers clear of the hinge points while putting the saw stand together or pulling it apart. Otherwise, your fingers may get crushed or contused.

KEY PARTS DIAGRAM

1. Table × 1

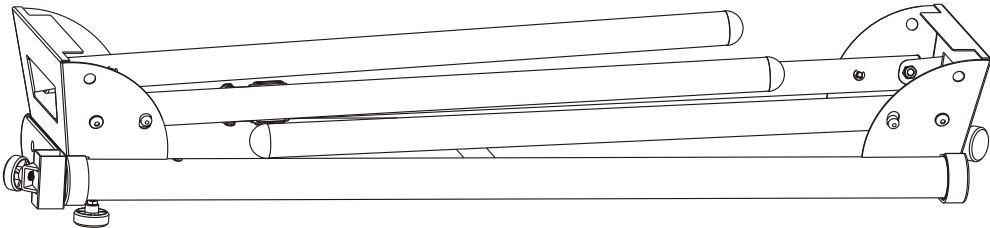

2. Workpiece Supports × 2

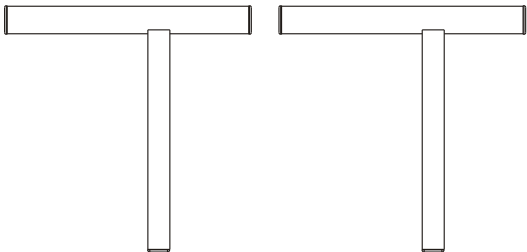

3. Mounting Brackets × 2

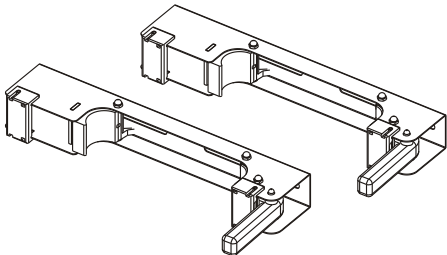

4. Locking Knobs × 2

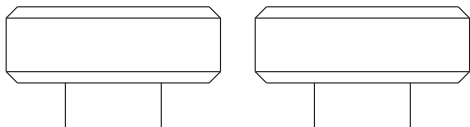

5. Locking Knobs with Bolt × 2

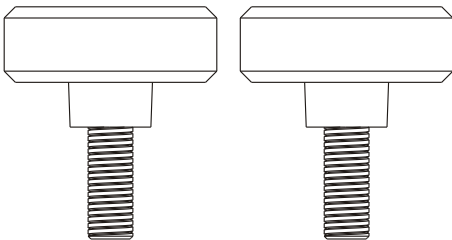

- 6
- A

Carriage Bolt M8×40 ×4
- B

Nut Locking Plate ×4
- C

Flat Washer×4
- D

Spring Washer×4
- E

Nut×4

Operation

Assembling the Saw Stand

- Carefully remove all parts included in the delivery from their packaging.
- Remove all packaging material.

Setting up the Saw Stand (see Fig. 1–2)

- Lay the saw stand upside down on the floor( legs facing upward).
- Push the locking pin in and tilt the leg out-ward until the locking pin can be heard to engage.
- Repeat this workstep with the other three legs.
- Turn around the saw stand to the working position. The manufacturer logo must face toward the front so that it can be read.
- Ensure that the saw stand is stable and that all locking pins have engaged. The saw stand is easily aligned with the height adjustable leg.
- Loosen lock nut and screw the leg in or out until the saw stand is aligned level and all four legs face against the floor.

Mounting Workpiece Supports (see Fig. 3)

- Insert the workpiece support (2) into the table extension.
- Tighten the locking knob 4 to lock the workpiece support.
- Repeat the worksteps with the second workpiece support.

Preparing the Saw Stand

Preparing the Mounting Brackets (see Fig. 4)

- Place both Mounting Brackets on the saw stand in such a manner that the labelling can be read.
- Hand-tighten both locking handles.

Fastening the Power Tool to the Mounting Brackets (see Fig. 5)

- Unplug the saw and lock the saw arm in the down position.
- Lift one side of the saw and place a saw mounting bracket underneath, aligning the carriage bolts with the mitre saw mounting holes.
- Lower the saw down onto the bracket, feeding the carriage bolts (A) through the mounting holes. Secure in place using a nut locking plate (B), then secure in place using a flat washer (C), spring washer (D), and nut (E).
- Repeat steps to install second bracket to the other side of the saw.
- After making sure both brackets are parallel to each other, finger tighten all four nuts (E) to hold in position.

Extending the Saw Stand

(See Fig. 6–7)

- Long workpieces must be underlaid or supported at their free end.
- Place your long workpiece onto the saw table of the power tool.
- Loosen locking knobs with bolt (5) and pull the table extension out to the desired clearance.
- Retighten the locking knobs with bolt (5).
- Loosen locking knobs and adjust the height of the workpiece support so that the workpiece rests level.
- The workpiece must be positioned level on the power tool's saw table.
- Retighten the locking knobs (4).



WARNING

- Do not overload the Saw Stand. Always observe the maximum load of the Saw Stand and the two table extensions.
- Always hold the workpiece firmly, especially the longer and heavier section. After cutting through the workpiece, the centre of gravity may become dislocated in such an unfavourable manner that the saw stand tips over.
- If possible, always place the workpiece on one or both workpiece supports.

Warranty

This frontierproduct carries a one–year warranty against defects in workmanship and materials. This product is not guaranteed against wear or breakage due to misuse and/or abuse.

Made in China