

## Machine Screw

Also known as stove bolts, machine screws are fully threaded.

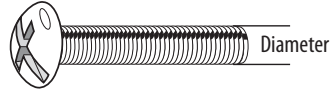

### US Machine Screw Diameter

Size	#0	#1	#2	#3	#4	#5	#6	#8	#10	#12	#14
Decimal	0.06	0.07	0.08	0.09	0.11	0.12	0.13	0.16	0.19	0.21	0.24
Fractional	1/16	5/64	3/32	7/64	7/64	1/8	9/64	5/32	3/16	7/32	1/4

## Nuts and Washers

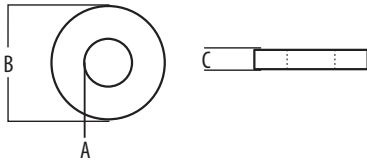

### USS & SAE Washer Dimensions

#### USS

Size	1/4"	5/16"	3/8"	7/16"	1/2"	9/16"
Inside Diameter (A)	5/16	3/8	7/16	1/2	9/16	5/8
Outside Diameter (B)	0.734	7/8	1	1-1/4	1-3/8	1-15/32
Thickness (C)	0.065	0.083	0.083	0.083	0.109	0.109

Size	5/8"	3/4"	7/8"	1"	1-1/8"	1-1/4"	1-3/8"	1-1/2"	1-5/8"	1-3/4"	2"
Inside Diameter (A)	11/16	13/16	15/16	1-1/16	1-1/4	1-3/8	1-1/2	1-5/8	1-3/4	1-7/8	2-1/8
Outside Diameter (B)	1-3/4	2	2-1/4	2-1/2	2-3/4	3	3-1/4	3-1/2	3-3/4	4	4-1/2
Thickness (C)	0.134	0.148	0.165	0.165	0.165	0.165	0.180	0.180	0.180	0.180	0.213

#### SAE

Size	#2	#4	#6	#8	#10	#12	1/4"	5/16"	3/8"	7/16"	1/2"	9/16"
Inside Diameter (A)	3/32	1/8	5/32	3/16	7/32	1/4	9/32	11/32	12/32	15/32	17/32	19/32
Outside Diameter (B)	1/4	5/16	3/8	7/16	1/2	9/16	5/8	11/16	13/16	15/16	1-1/16	1-5/32
Thickness (C)	0.020	0.032	0.049	0.049	0.049	0.065	0.065	0.065	0.065	0.065	0.095	0.095

Size	5/8"	3/4"	7/8"	1"
Inside Diameter (A)	21/32	13/16	15/16	1-1/16
Outside Diameter (B)	1-5/16	1-15/16	1-3/4	2
Thickness (C)	0.095	0.134	0.134	0.134

## Nuts and Washers



**AXLE HAT NUT:** Type of push nut used to cap the end of a solid smooth rod. Used to create axles for soap box derby cars.



**CAP NUT:** Offers protection and appearance, used as a decorative finishing fastener. Often used in furniture or hobby projects.



**JAM NUT:** A thinner version of a hex nut in sizes 1/4" and up. Used in areas where there is too little space for a standard hex nut.



**MACHINE SCREW NUT:** Used for fastening to a bolt when mechanically joining materials together. This type refers to nuts used with smaller machine screw sizes under 1/4".



**HEX NUT:** For general applications, most commonly used nut. Common applications include deck and fence building.



**WING NUT:** For quick and easy assembly by hand. Used when repeated removal and installation is desired, or when hand tightening is all that is required.



**NYLON LOCK NUT:** Used for fastening to a bolt when mechanically joining materials together. The bolt threads into the nylon material located at the top of the nut. Nylon insert helps prevent loosening from vibration. Common applications include machinery such as lawn mowers.



**TEE NUT:** Designed to be driven into wood to create a threaded hole.



**FLANGE NUT:** Type of nut with a built in washer similar to a flange.



**PREVAILING TORQUE LOCK NUT:** A non reversible lock used for high temperature, high vibration applications.



**SLOTTED NUT:** Used in conjunction with a cotter pin or drilled shank fasteners to prevent loosening.



**THUMB NUT:** Similar to the wing nut, this nut is designed to be assembled by thumb and forefinger without the use of tools.



**DOCK WASHER:** These washers feature a larger outer diameter and are thicker than the standard flat washer.



**SEALING WASHER:** Designed with a neoprene washer bonded to a metal backing, these washers are designed to seal out air or water as well as reduce noise and vibration. Used on metal roofs and corrugated metal buildings.



**FLAT WASHER:** Provides a greater bearing surface under the fastener, which helps prevent a nut, bolt or screw from pulling through the material. Commonly used in deck and fence building.



**FLAT WASHER SAE:** SAE pattern is a tighter fit on the bolt and a smaller outside diameter. Use where a smaller outer diameter is required. Often used in automotive machinery.



**LOCK WASHER - SPLIT:** Used to help prevent the nut from loosening by placing tension against the nut after tightening.



**LOCK WASHER - INTERNAL TOOTH:** Used to prevent nut or screw from loosening. Teeth bite into surface for superior holding. Commonly used in automotive applications.



**LOCK WASHER - EXTERNAL TOOTH:** Large diameter locking area, provides superior lock on equipment that vibrates (Lawn mowers, leaf blower, etc.).



**FINISHING WASHER:** Use with flat and oval head screws, where countersinking is not practicable. Used in furniture making or other wood hobby projects.



**FENDER WASHER:** Use where a larger outer diameter is required, helps cover up large odd size holes.



**COUPLING NUT:** Long nuts used to connect pieces of threaded rod or other metal threaded fasteners.



**ACORN NUT:** A high crown type of cap nut typically used for its decorative appearance and to protect from exposed threads (swingsets, porch swings, fencing, etc.).



**K-LOCK NUT:** Also known as Kep nut, this nut is designed with a free spinning external lock washer.



**CASTLE NUT:** Similar to slotted nuts but with the slots in a rounded section above the main nut.



**EYE NUT:** A type of fastener that are typically round or oval in shape. Designed to receive a hook or rope.



**OGEE WASHER:** Typically are thicker and larger in diameter and feature a curved appearance. Typically used in dock and wood construction.

**Note:** Zinc and Galvanized Nuts and Washers are not interchangeable with bolts. Galvanized Nuts & Washers will only work with Galvanized Bolts and vice versa.