

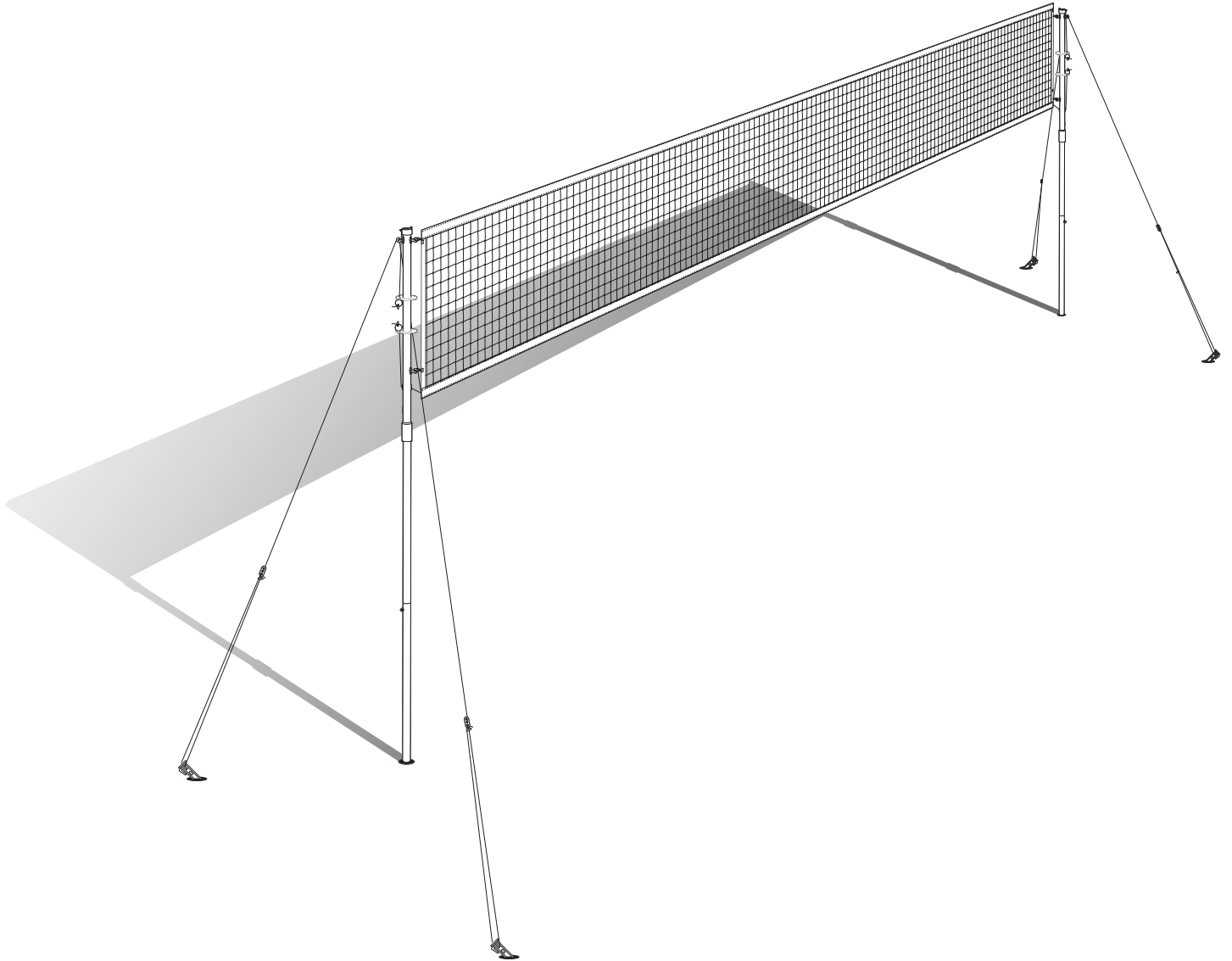

NET SYSTEM

US PATENT # 13/098431



Assembly Instructions Net System 1-1-41620

CONTACT INFO

Hours

Monday to Friday
(9am to 5pm EST)

Technical Support

Email us at : consumerservice@eastpointports.com
Visit us at: www.eastpointports.com
Call: 973-585-4747

www.eastpointports.com

TOOLS Required



- 1 - Rubber Mallet (for Ground Stakes)
- Not Included

How to use the PARTS IDENTIFIER

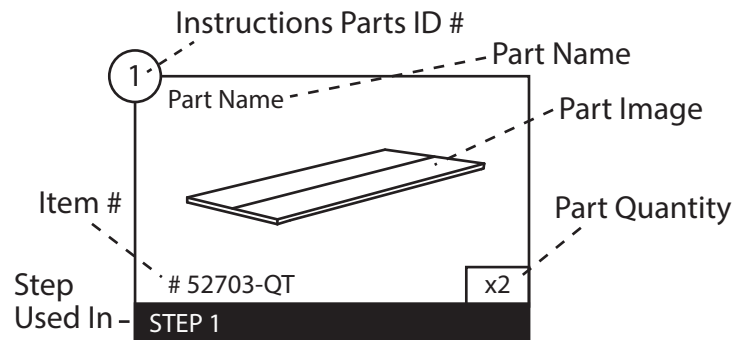
Before you begin assembly, please make sure that you have all the parts listed and in the correct quantities. This will ensure the quickest and most organized assembly.

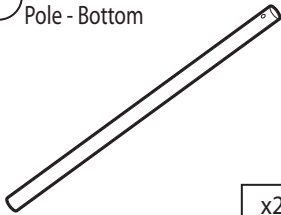
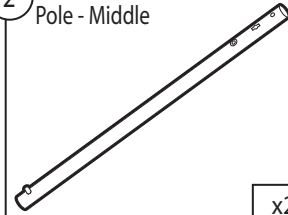
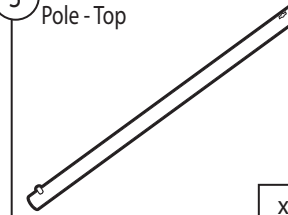

PARTS IDENTIFIER

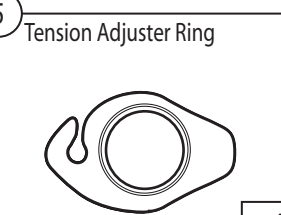
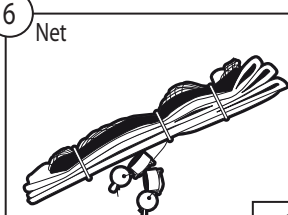
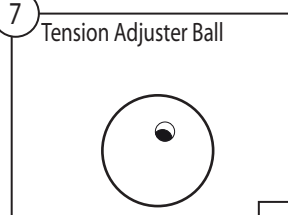
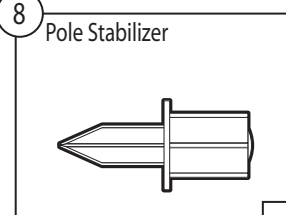
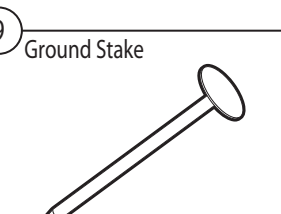
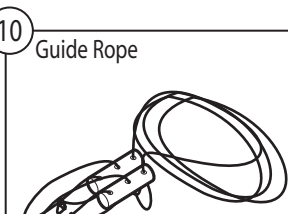
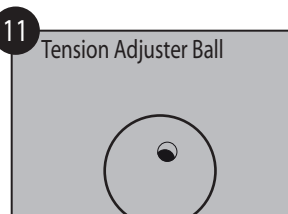
<p>1 Pole - Bottom</p>  <p>x2</p> <p>STEP 1</p>	<p>2 Pole - Middle</p>  <p>x2</p> <p>STEP 1</p>	<p>3 Pole - Top</p>  <p>x2</p> <p>STEP 2</p>	<p>4 Key Lock</p>  <p>x6</p> <p>STEP 3,4</p>
<p>5 Tension Adjuster Ring</p>  <p>x4</p> <p>STEP 3</p>	<p>6 Net</p>  <p>x1</p> <p>STEP 5</p>	<p>7 Tension Adjuster Ball</p>  <p>x2</p> <p>STEP 7</p>	<p>8 Pole Stabilizer</p>  <p>x2</p> <p>STEP 9</p>
<p>9 Ground Stake</p>  <p>x4</p> <p>STEP 10</p>	<p>10 Guide Rope</p>  <p>x2</p> <p>STEP 10</p>	<p>11 Tension Adjuster Ball</p>  <p>x2</p> <p>PRE-INSTALLED</p>	

ASSEMBLY INSTRUCTIONS

Net Assembly for Competitive Badminton (61in / 1.55 m)

START

BEFORE BUILDING - Please inspect and lay out all your PARTS

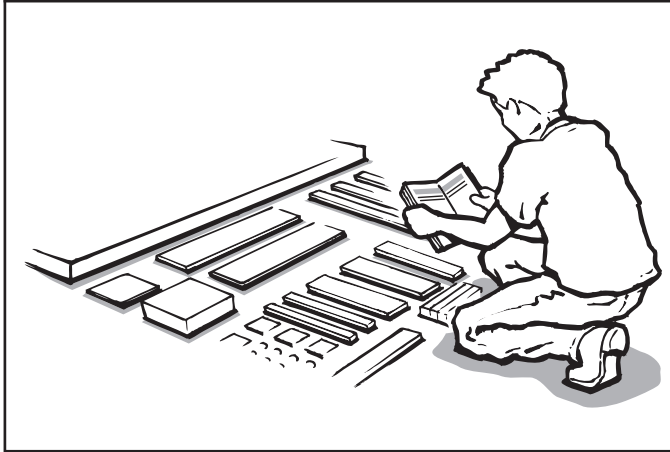

All parts and accessories are listed in the Parts Identifier.

Please review the Parts Identifier and make sure that you have all parts before beginning assembly.

STEP 1

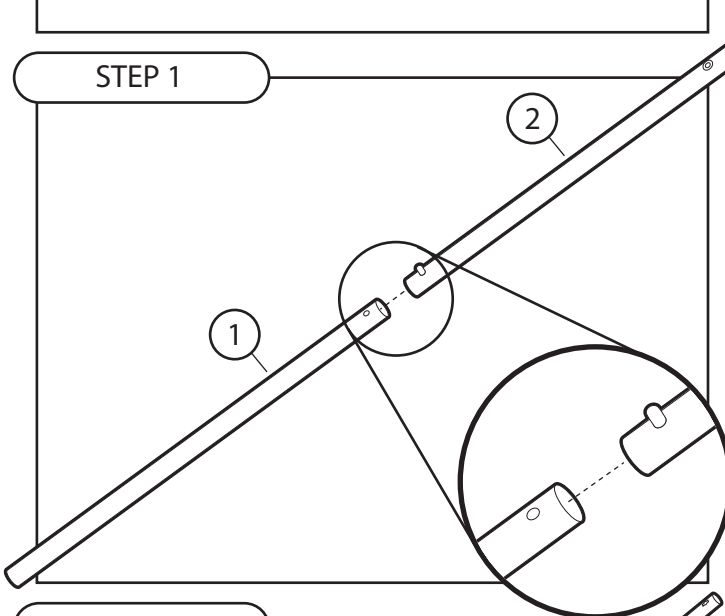

COMPONENTS

QTY.

- ① Pole - Bottom
- ② Pole - Middle

x2
x2

NOTE:

Assemble Poles.
Repeat for both Sets of Poles.

STEP 2

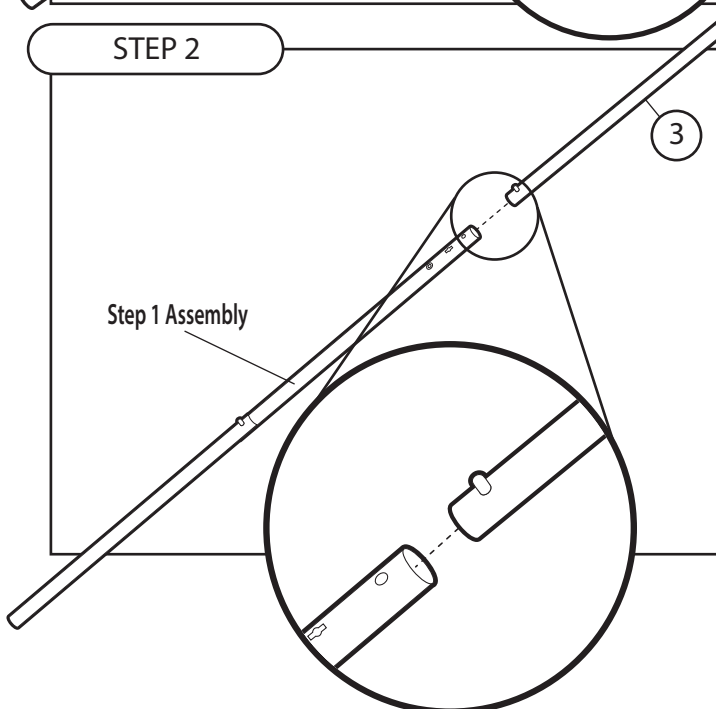

COMPONENTS

QTY.

- Step 1 Assembly
- ③ Pole - Top

x2
x2

NOTE:

Assemble Poles.
Repeat for both Sets of Poles.

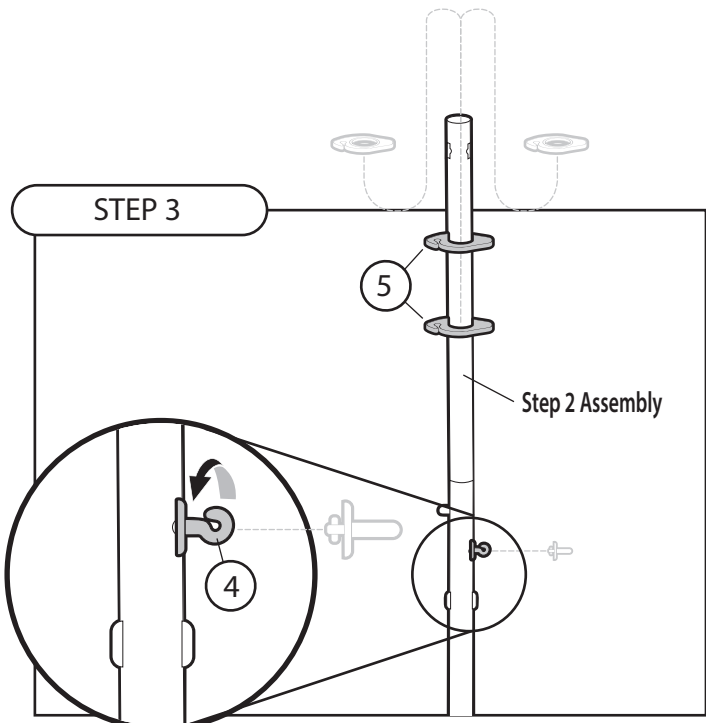

COMPONENTS	QTY.
Step 2 Assembly	x2
④ Key Lock	x2
⑤ Tension Adjuster Ring	x4

NOTE:
Twist the Key Lock into place.
Then slide the Tension Adjuster Ring down the Poles.
Repeat for second Pole Set.

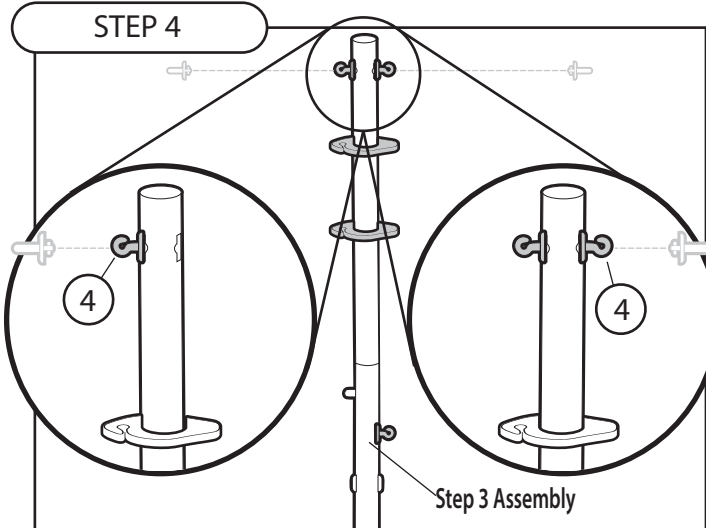

COMPONENTS	QTY.
Step 3 Assembly	x2
④ Key Lock	x4

NOTE:
Twist the Key Locks into place.
Repeat for second Pole Set.

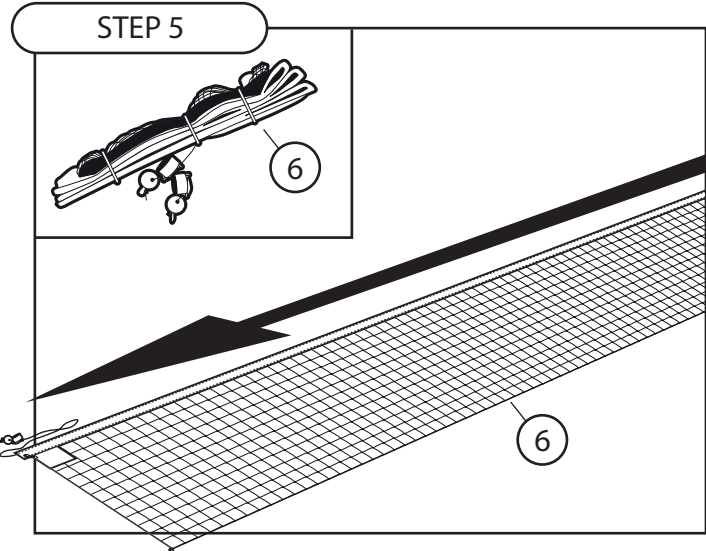

COMPONENTS	QTY.
⑥ Net	x1

NOTE:
Lay out Net.

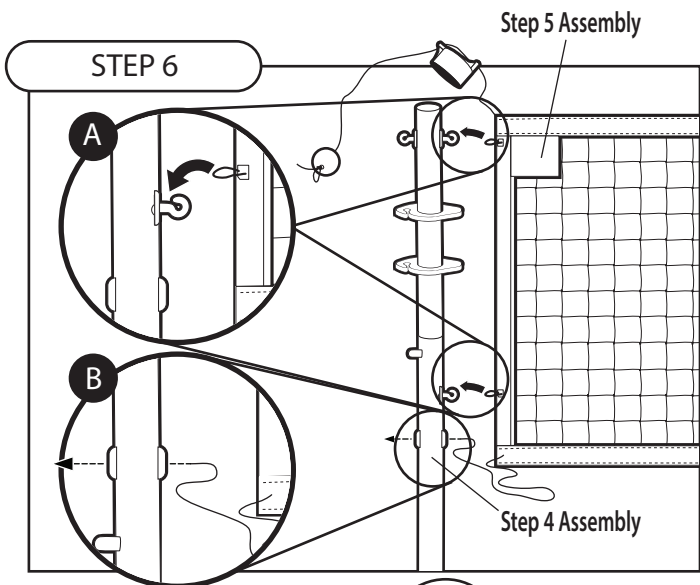

COMPONENTS	QTY.
Step 4 Assembly	x2
Step 5 Assembly	x1

NOTE:
 Attach Step 5 Assembly to Step 4 Assembly with the elastic loop.
 Repeat for both sides.

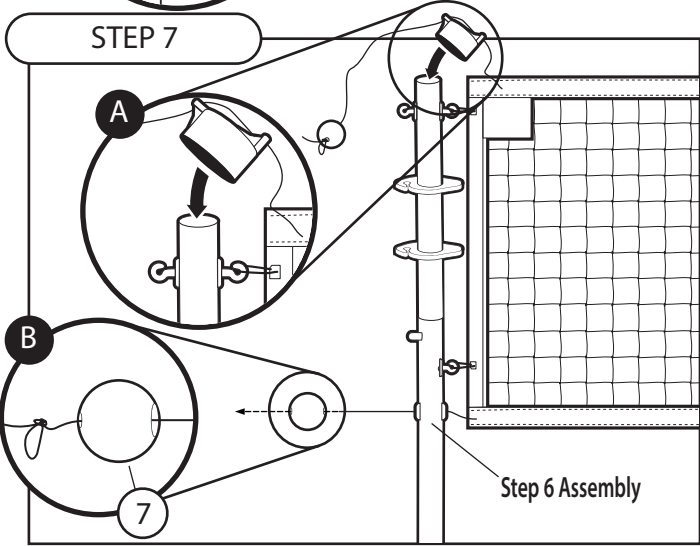

COMPONENTS	QTY.
Step 6 Assembly	x1
⑦ Tension Adjuster Ball	x2

NOTE:
A Attach the Pole Cap.
B Tie on Tension Adjuster Ball to the string on the bottom of the Net.

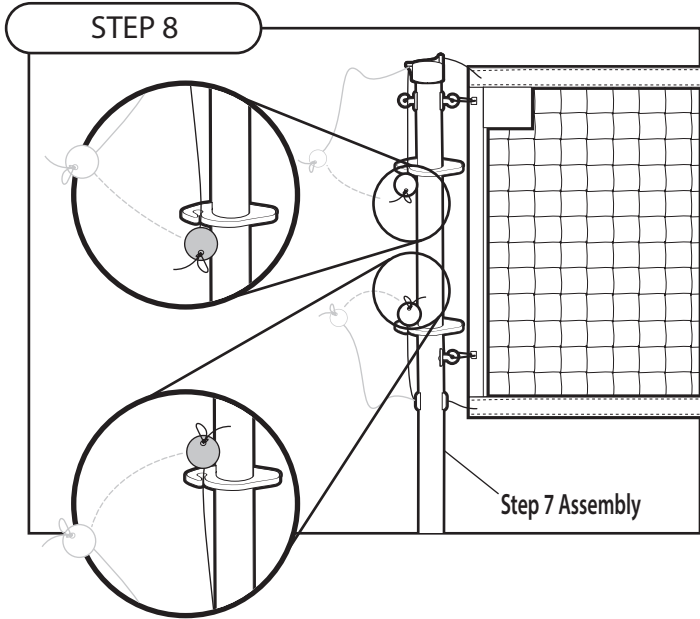

COMPONENTS	QTY.
Step 7 Assembly	x1

NOTE:
 Connect the Tension Adjuster Balls to the Tension Adjuster Rings.
 Repeat for Both Sides.

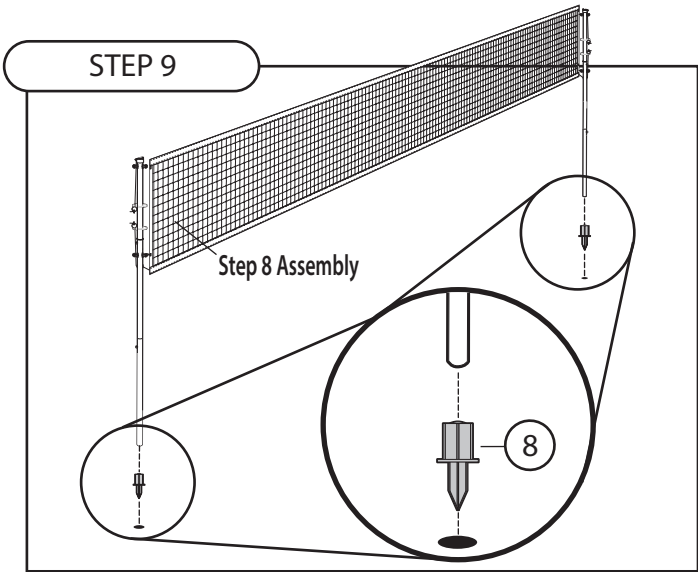

COMPONENTS	QTY.
Step 8 Assembly	x1
8 Pole Stabilizer	x2

NOTE:
With 2 Adults place Step 8 Assembly into the ground using the Pole Stabilizers.

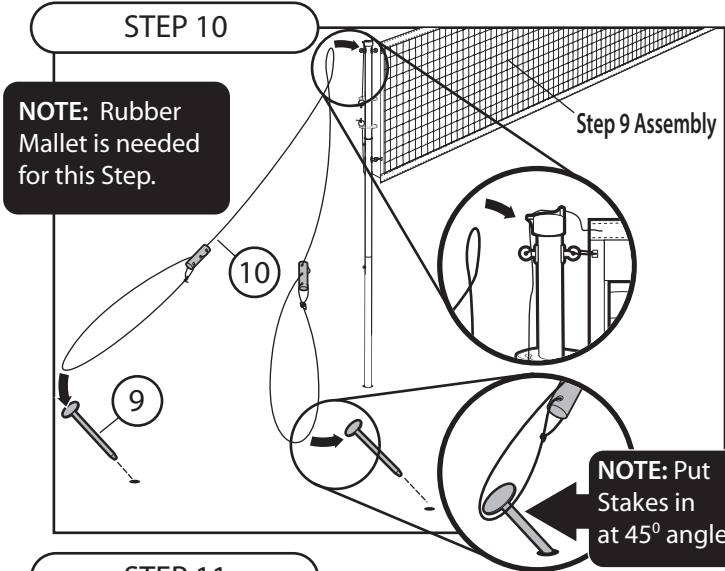

COMPONENTS	QTY.
Step 9 Assembly	x1
9 Ground Stake	x4
10 Guide Rope	x2

NOTE:
Attach the center of the Guide Ropes to the top Key Locks.

Repeat for both ends of the Net.

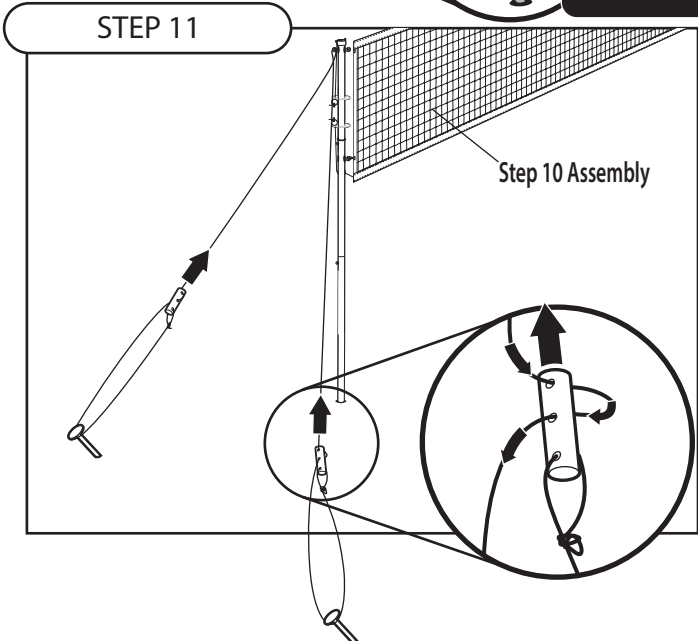
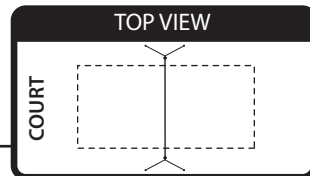

COMPONENTS	QTY.
Step 10 Assembly	x1

NOTE:
Adjust Guide Ropes as needed.

Repeat for both ends of the Net.

STEP 12

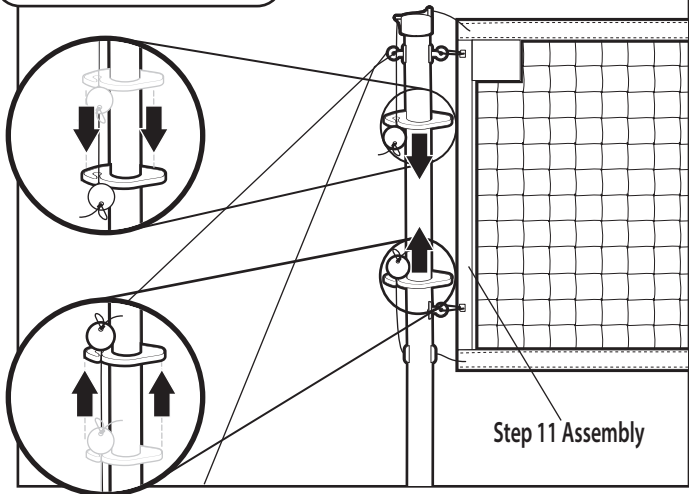

COMPONENTS	QTY.	NOTE:
Step 11 Assembly	x1	Adjust Guide Ropes and Tension Adjuster Balls as needed. Push down to tighten top of Net. Push up to tighten bottom of Net.

STEP 13

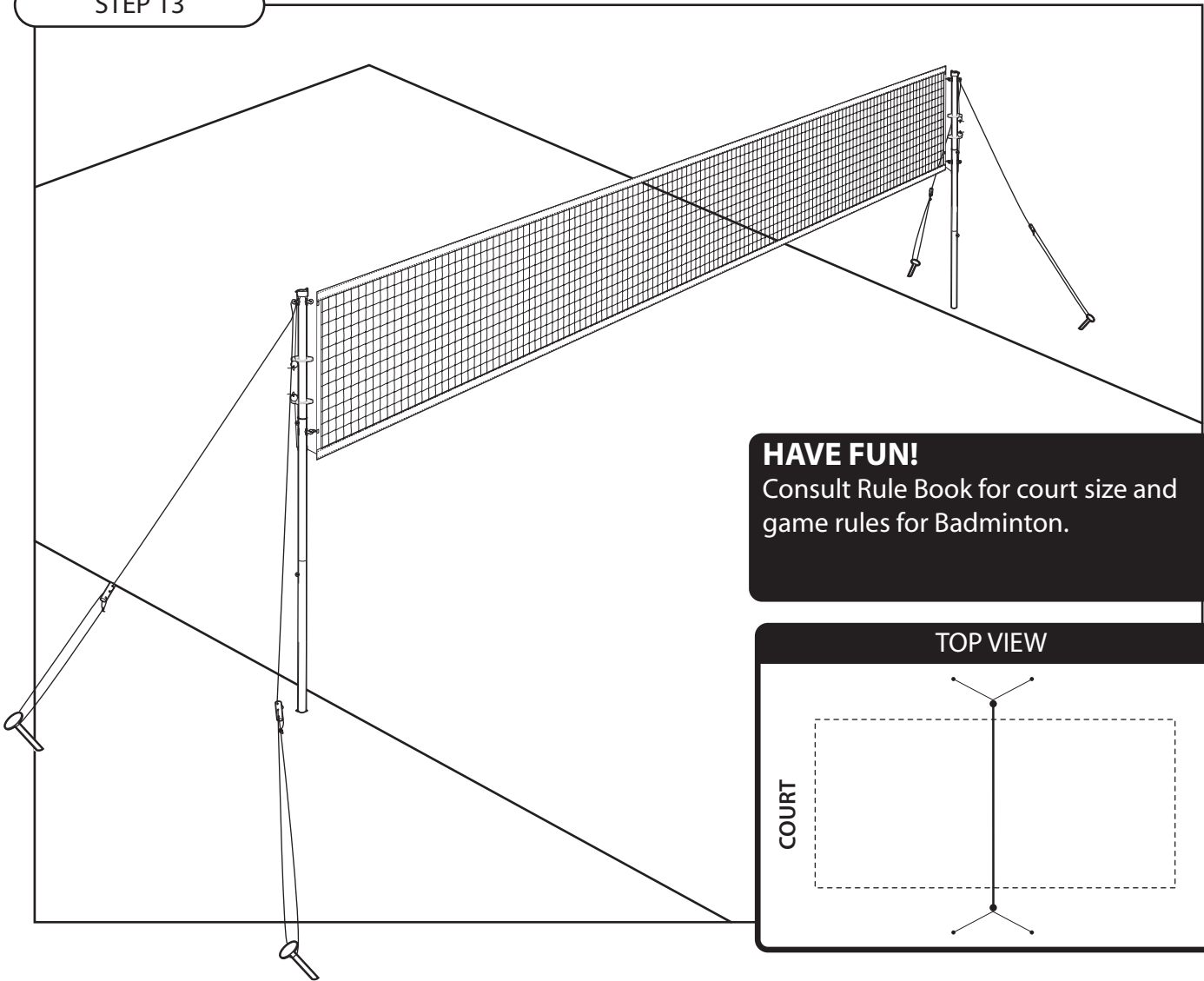

HAVE FUN!
Consult Rule Book for court size and game rules for Badminton.

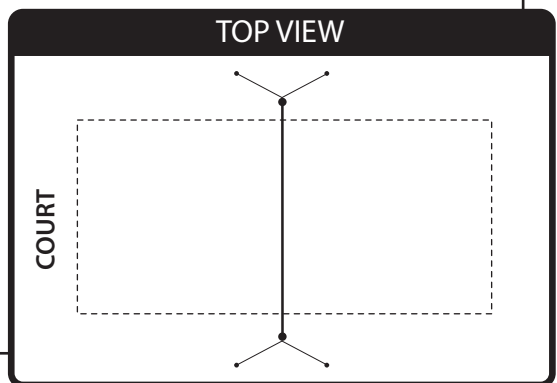

Limited Warranty

As described in and as limited by this Limited Warranty, EastPoint Sports Ltd., LLC (the "Company") warrants this Product to be free from defects in workmanship and materials for a period of 90 days from the date of original purchase. The term defects shall mean any imperfections that impair the use of the product. The Company reserves the right to request confirmation of Proof of Purchase when requesting parts or service in order to confirm that this Product is within its warranty period and terms.

What is Covered: Except as provided herein, this Limited Warranty covers all defects in materials and workmanship. This Limited Warranty is void if the Product is:

- Damaged through improper usage or storage, negligence, misuse, abuse, transportation damage, acts of nature, or accident (including failure to follow the instructions supplied with the product).
- Used in commercial applications, rentals or a commercial environment.
- Modified or repaired by anyone not authorized by the Company.

What is Not Covered:

The Limited Warranty does not cover:

- Expendable items such as cosmetic parts, game playing accessories, and any other items that may show signs of wear due to normal usage.
- Any transportation/delivery/installation costs incurred by the Consumer (either home from the original place of purchase or back to the original place of purchase).
- Items not purchased from an authorized retailer (ie: this warranty does not apply to so-called "grey market" goods (those goods purchased from a third party)).

What the Company Will Pay For:

- If any part or component of the Product which is covered by this Limited Warranty is found by the Company to be defective, the Company will provide replacement parts without charge. The Company's obligation to repair or replace the Product or any portion of thereof, shall be limited to the original purchase price of the product.
- If during the Limited Warranty period, the product is found to be defective, the Company will, at the Company's option, repair, replace or make remuneration for the Product (either the same or equivalent value) without charge.

How to Obtain Warranty Service: In order to enforce your rights under this Limited Warranty, you must follow these procedures:

- You must return the ORIGINAL COPY OF YOUR SALES RECEIPT to the Company showing a purchase from an authorized retailer.
- You must call the Company's Consumer Service Department at 1-973-585-4747 on Monday through Friday between the hours of 9:00 A.M. and 5:00 P.M. (EST) to notify the Company of the nature of the problem. At the Company's option, replacement parts or a new Product (either the same or equivalent value) will be sent to you at no charge.
- If you are instructed to return the Product to the Company for servicing, you are responsible for shipping the Product, at your expense, to the address designated by the Company in packaging that will protect against further damage.
- You must also include your name, address, daytime telephone number, Product model number, and a description of the problem.
- The Company will pay for any shipping charges to return the repaired or replaced Product to you.

THIS LIMITED WARRANTY IS AVAILABLE ONLY TO THE ORIGINAL PURCHASER OF THE PRODUCT, PURCHASING FROM AN AUTHORIZED RETAILER, AND IS VALID ONLY IN THE UNITED STATES. THE COMPANY'S LIABILITY IS LIMITED TO THE REPAIR, REPLACEMENT, OR REMUNERATION, AT ITS OPTION, OF ANY DEFECTIVE PRODUCT AND SHALL NOT INCLUDE ANY LIABILITY FOR INDIRECT, INCIDENTAL, OR CONSEQUENTIAL DAMAGES OF ANY KIND. THIS WARRANTY IS EXPRESSLY MADE IN LIEU OF ALL OTHER WARRANTIES, EXPRESSED OR IMPLIED, INCLUDING BUT NOT LIMITED TO THE IMPLIED WARRANTY OF MERCHANTABILITY AND THE IMPLIED WARRANTY OF FITNESS FOR A PARTICULAR PURPOSE. SOME STATES DO NOT ALLOW LIMITATIONS ON HOW LONG AN IMPLIED WARRANTY LASTS OR DO NOT ALLOW FOR EXCLUSION OF INCIDENTAL OR CONSEQUENTIAL DAMAGES. TO THAT EXTENT, THE ABOVE LIMITATIONS MAY NOT APPLY TO YOU.

This Limited Warranty gives you specific legal rights, but you may also have other rights that vary from state to state.

If you have questions regarding this Limited Warranty or the operation of the Product, you may call or write us.

ALL WARRANTY CLAIMS MUST BE ACCOMPANIED BY AN ORIGINAL COPY OF THE SALES RECEIPT/PROOF OF PURCHASE. REPORT ANY DEFECTS TO:



20 Commerce Boulevard Succasunna, NJ 07876 • 1-973-585-4747