

INSTALLATION INSTRUCTIONS

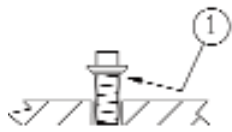

① PLACE WASHER UNDER ESCUTCHEON

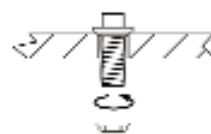

② SLIDE NIPPLE THROUGH 1 1/8" TO 1 3/8" HOLE IN DECK AND SCREW ON LOCKNUT THEN TIGHTEN BY HAND

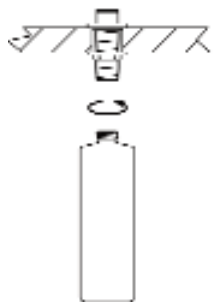

③ SCREW IN BOTTLE DO NOT OVERTIGHTEN

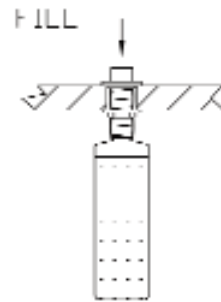

④ FILL WITH SOAP OR LOTION TO DEPTH SHOWN

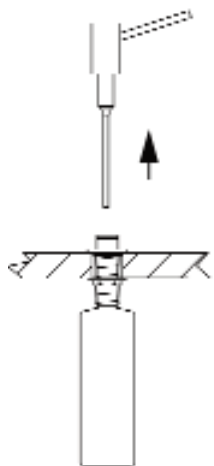

⑤ PUSH PLASTIC STRAW INTO PUMP BOTTOM THEN PUSH DISPENSER TOP INTO BODY

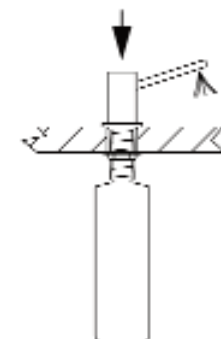

⑥ PUMP A FEW TIMES TO PRIME DISPENSER AND BEGIN FLOW

MAINTENANCE

PUMP CLOGS SUBMERGE THE DISPENSER TOP WITH PUMP ATTACHED INTO HOT WATER FOR SEVERAL MINUTES. HOLD PLASTIC PUMP BODY AND PUSH TOP DOWN SEVERAL TIMES TO FORCE HOT WATER THROUGH THE SPOUT AND CLEAR SOAP CLOG.

CLEANING CARE

NOT USE ANY HARSH ACID BASED DETERGENTS OR CLEANERS SUCH AS SOFT SCRUB®, RUBBING BUBBLES® OR COMET® TO CLEAN, USE ONLY A DAMP SOFT CLOTH. STANDARD BLEACH® CAN ALSO BE USED SPARINGLY.

WARRANTY

CONTACT BARCLAY FOR WARRANTY INFORMATION. CLAIMS REQUIRE PROOF OF PURCHASE.