

NEOPERL®

flow, stop and go®

Product Instructions

Description: Dual Thread for 3/4" Hose or M 55/64" Adapter

Model#: 37.0109.98

SKU#: 571493

- Top threads: Male 15/16"-27 + Female 55/64"-27
- Bottom threads: Male 3/4" Garden Hose + Male 55/64"-27
- Easy Installation

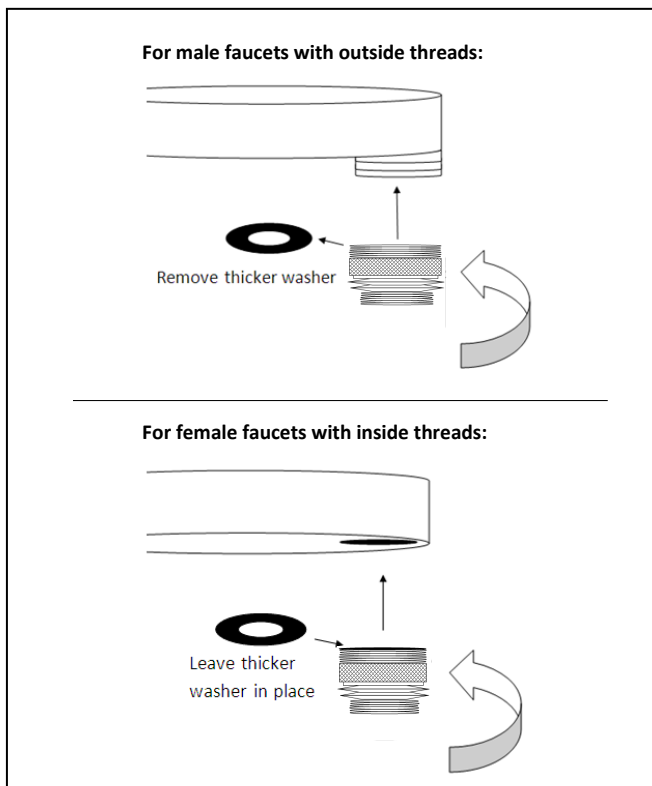

INSTRUCTIONS:

1. Remove aerator from faucet. If a wrench is necessary, place cloth over aerator to prevent damage.
2. Remove any old washers that might be caught inside the spout.
3. For faucets with outside threads, remove thicker washer. For faucets with inside threads, leave thicker washer in place. Install adapter onto spout by hand.
4. Connect regular female aerator or hose.
5. Turn on faucet. If leak occurs, tighten more firmly.

INSTRUCCIONES:

1. Quite el aireador del grifo. Si se necesita una llave inglesa, coloque un trapo sobre el aireador para evitar daños.
2. Quite todas las arandelas viejas que pudieran haber quedado atrapadas dentro del surtidor de agua.
3. Para grifos con roscas externas, quite la arandela más gruesa. Para grifos con roscas internas, deje la arandela más gruesa en su lugar. Instale el adaptador en forma manual.
4. Conecte el aireador regular hembra o la manguera.
5. Abra el grifo. Si ocurre un escape, ajuste más firmemente.

WARNING: Product may contain sharp edges.

ADVERTENCIA: El producto puede tener bordes filados.

Visit us at www.neoperl.com/consumer and make changing your aerator part of your yearly faucet maintenance.