

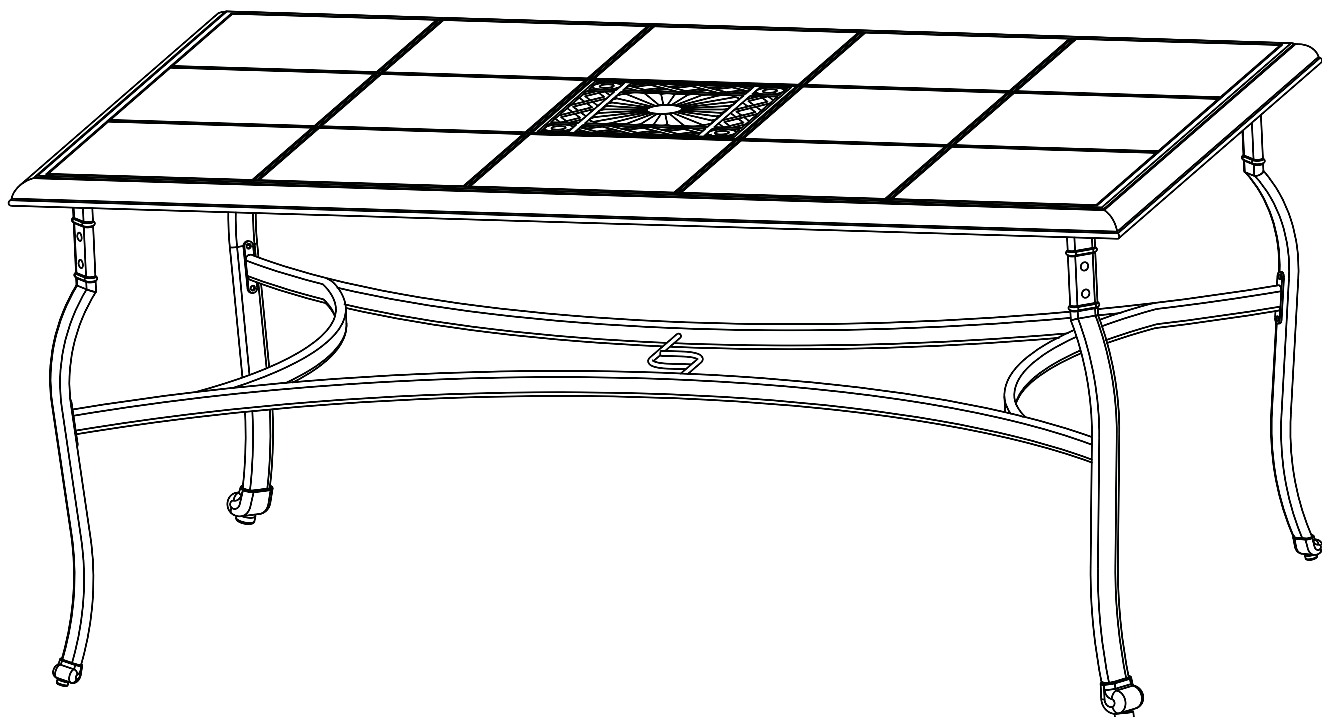

Item # 633 690  
Model # FTS80635

## USE AND CARE GUIDE

### BELLEVILLE DINING TABLE



Questions, problems, missing parts? Before returning to the store,  
call Hampton Bay Customer Service  
8 a.m. - 7 p.m., EST, Monday - Friday, 9 a.m. - 6 p.m., EST, Saturday

**1-855-HD-HAMPTON**

**HAMPTONBAY.COM**

#### **THANK YOU**

*We appreciate the trust and confidence you have placed in Hampton Bay through the purchase of these dining table. We strive to continually create quality products designed to enhance your home. Visit us online to see our full line of products available for your home improvement needs. Thank you for choosing Hampton Bay!*

# Table of Contents

Table of Contents.....	2	Package Contents.....	3
Warranty .....	2	Assembly.....	4
What is Covered .....	2	Care and Cleaning.....	6
What is Not Covered.....	2		
Pre-Assembly .....	2		
Planning Assembly .....	2		
Hardware Included .....	2		

## Warranty

### 2 YEAR FRAME WARRANTY

#### WHAT IS COVERED

We warrant the frame to be free of manufacturing defects to the original purchaser for two year.

#### WHAT IS NOT COVERED

It remains the customer's responsibility for freight and packaging charges to and from our service center. This warranty does not cover commercial use, hardware, acts of nature, fire, freezing and abusive use. In addition, purchased parts are not covered under this warranty. We reserve the right to make substitutions with similar merchandise, if the model in question is no longer in production.

Contact the Customer Service Team at 1-855-HD-HAMPTON or visit [www.HamptonBay.com](http://www.HamptonBay.com).

## Pre-Assembly

### PLANNING ASSEMBLY

Read all instructions before assembly.

To avoid damaging this product, assemble it on a soft, non-abrasive surface such as carpet or cardboard.



**NOTE:** More than one person may be required to complete the assembly of this product.

### HARDWARE INCLUDED



**NOTE:** Hardware not shown to actual size.

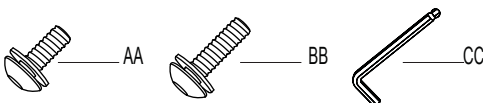

Part	Description	Quantity
AA	M6x15 Combination bolt	8+1
BB	M6x20 Combination bolt	8+1
CC	Hex wrench	1

# Pre-Assembly (continued)

## PACKAGE CONTENTS

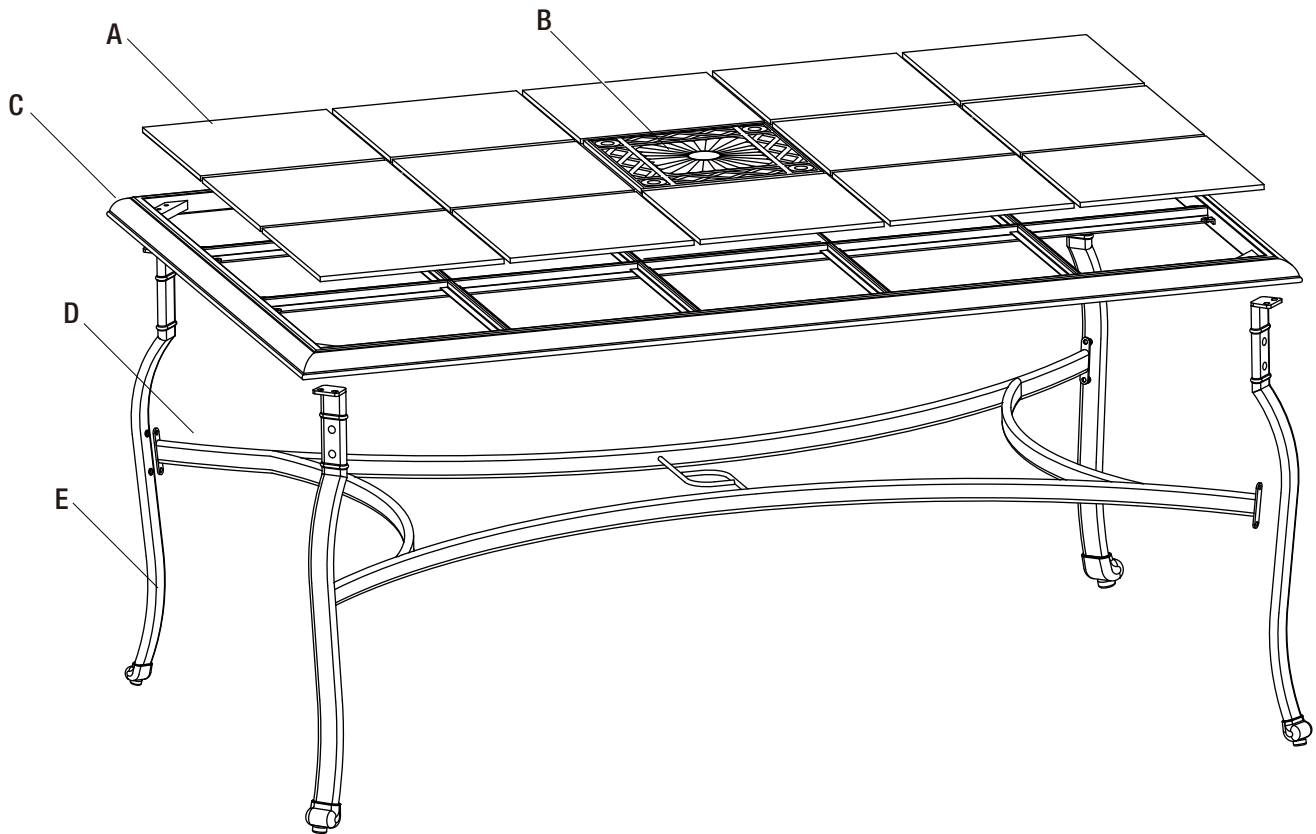

Part	Description	Quantity
A	Tile	15
B	Stamped metal	1
C	Table rim	1
D	Leg connector	1
E	Table leg	4

# Assembly

## 1 Connecting the table leg

- Place the table rim (C) upside down on a soft surface.
- Connect each of the table legs (E) with M6x20 combination bolts (BB) to the table rim (C).



**NOTE:** Loosely tighten the bolts using the hex wrench (CC).

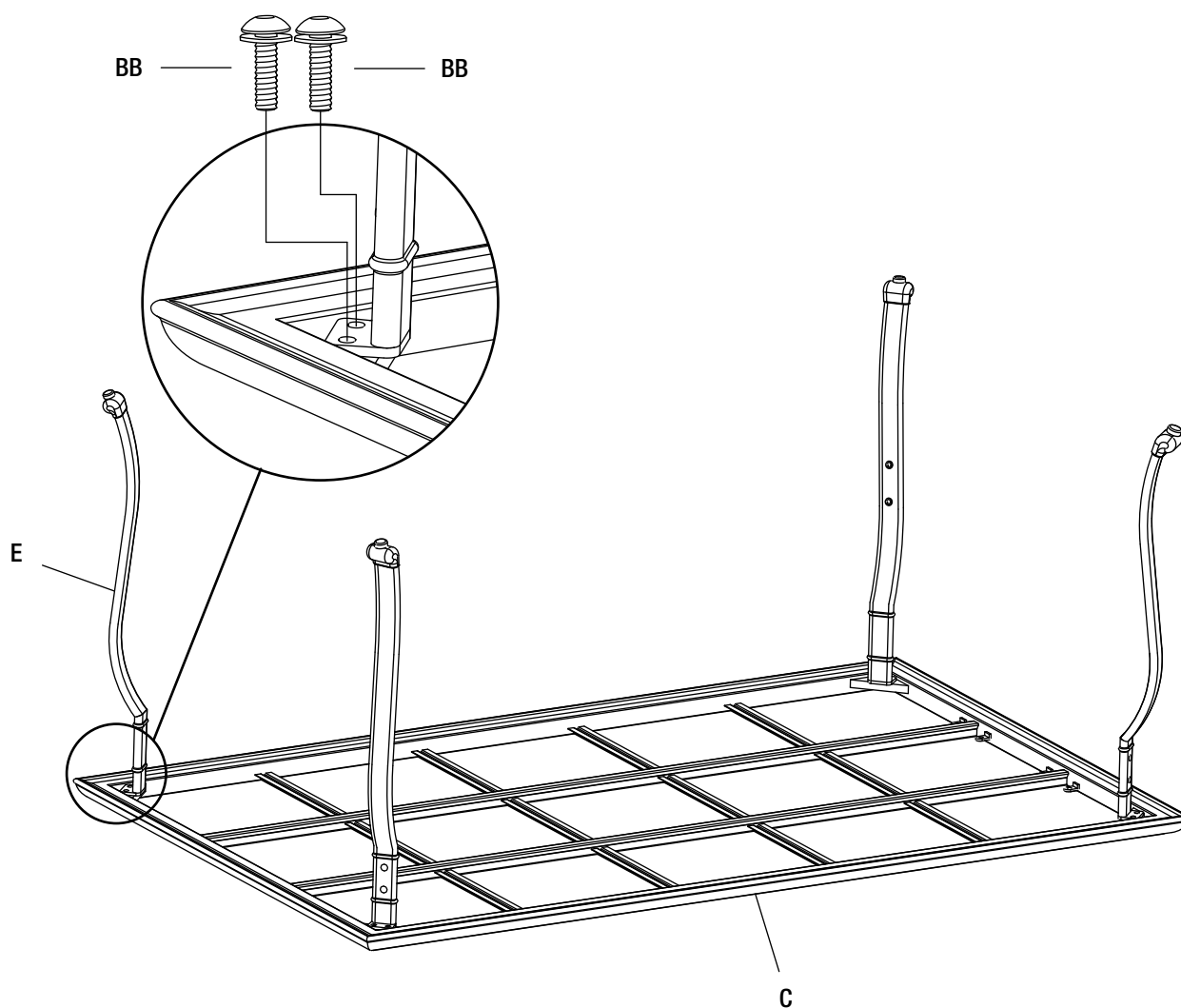

# Assembly (continued)

## 2 Connecting the leg connector to the table legs

- Align the holes of the leg connector (D) with the holes on the inside of each the table leg (E).
- Connect the leg connector (D) to the table legs (E) with M6x15 combination bolts (AA).
- Tighten all the bolts.



**NOTE:** Tighten all bolts using the hex wrench (CC).

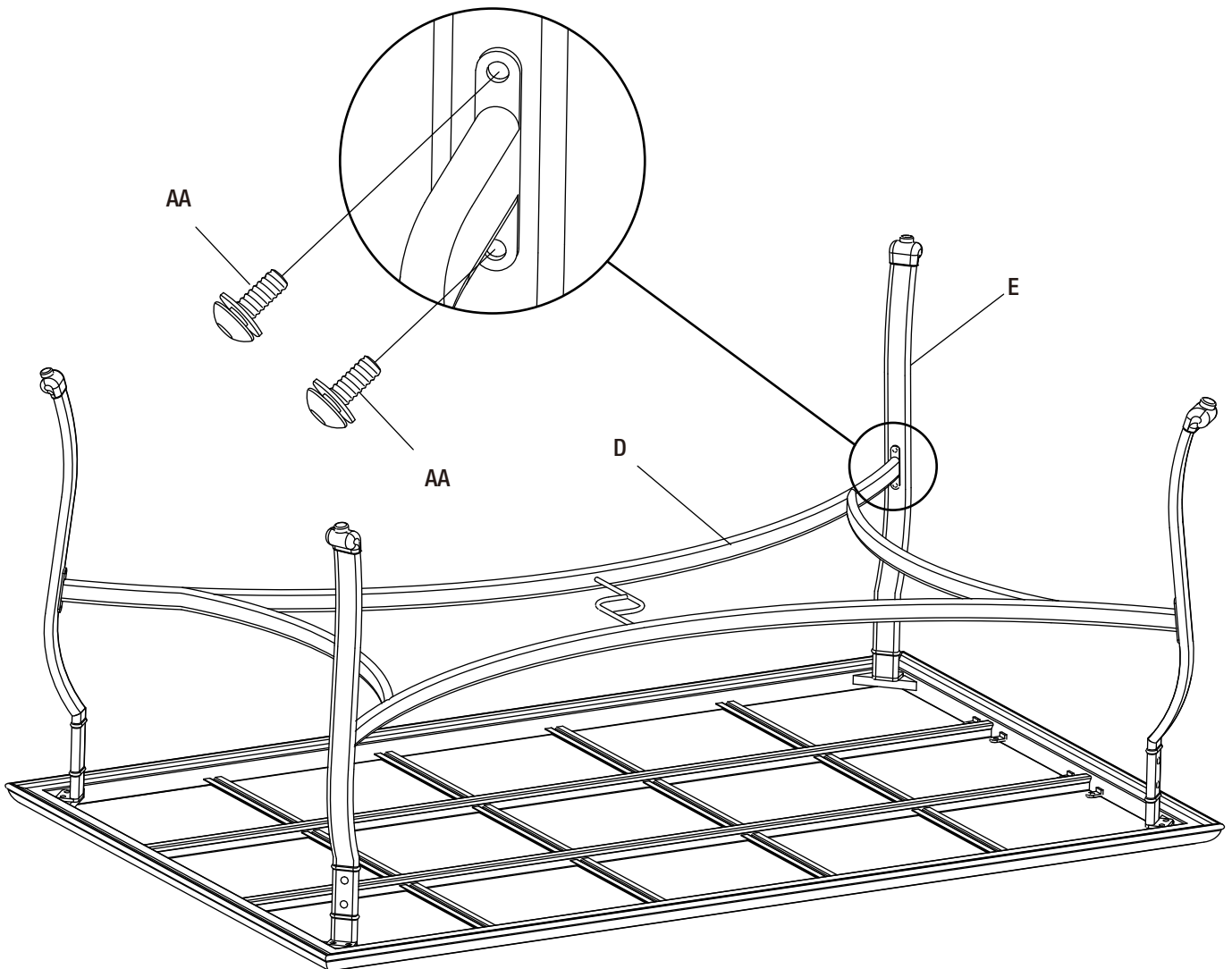

## Assembly (continued)

### 3 Adding the tiles

- Turn the table right side up.
- Ensure all connections are secure.
- Carefully place the tiles (A) and stamped metal (B) onto the table rim (C).



**NOTE:** The stamped metal (B) can be replaced by the tile (A) if desired.

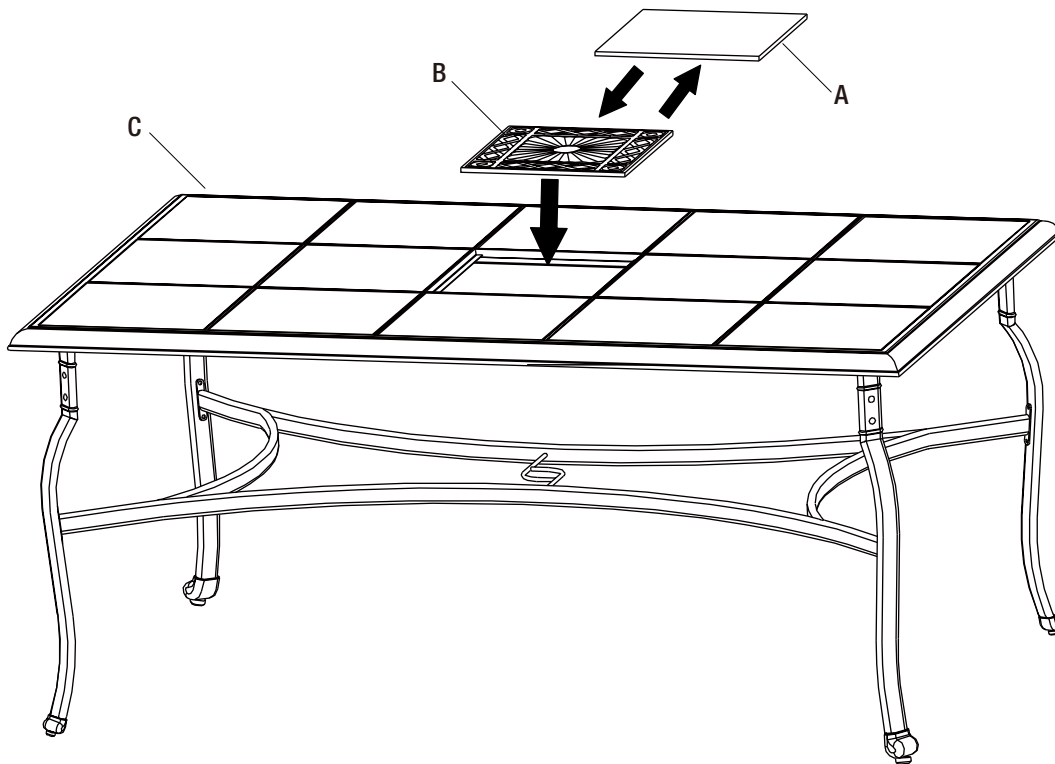

## Care and Cleaning

- For best results, clean the frame with damp cloth and dry thoroughly. This will help prevent mildew by removing dirt particles that may accumulate.
- Do not clean with abrasive materials, bleach, or solvents.
- Store the dining table in a dry sheltered place when not in use.
- Keep the dining table out of fire, extreme heat, freezing conditions, and inclement weather such as rain, hail, sleet, snow, or wind.



Questions, problems, missing parts? Before returning to the store,  
call Hampton Bay Customer Service  
8 a.m. - 7 p.m., EST, Monday - Friday, 9 a.m. - 6 p.m., EST, Saturday

**1-855-HD-HAMPTON**

**HAMPTONBAY.COM**

Retain this manual for future use.