

# NEOPERL®

flow, stop and go®

## Product Instructions

**Description: 1.5 GPM Water Saving Faucet Aerators**

**Model#: 37.0098.98**

**SKU#: 706347**

- 15/16" x 55/64"-27 Thread (Qty. 6)
- 1.5 gallon per minute
- Easy Installation

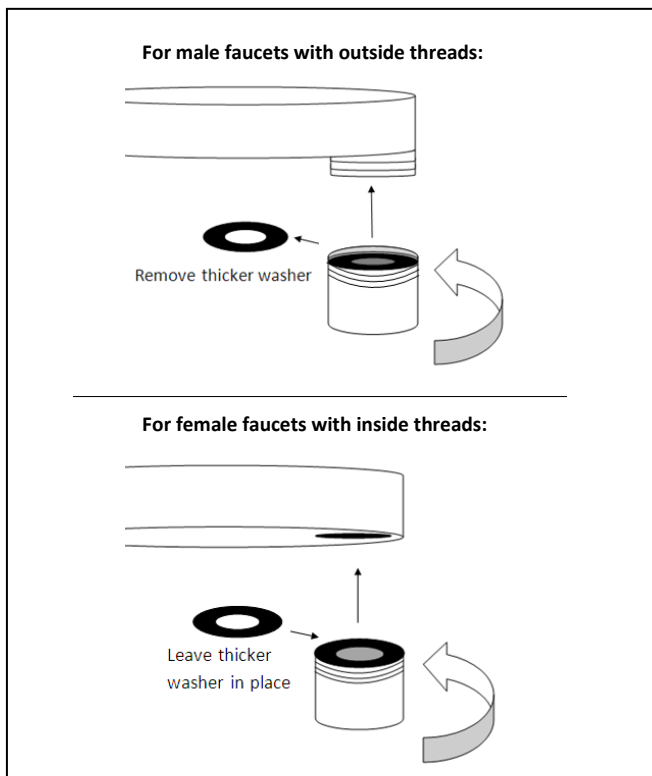

### INSTRUCTIONS:

1. Remove old aerator from faucet. Use wrench if necessary.
2. For faucets with outside threads, remove thicker washer. For faucets with inside threads, leave thicker washer in place. Install onto spout by hand.
3. Turn on faucet. If leak occurs, tighten more firmly.

### INSTRUCCIONES:

1. Quite el viejo aireador del grifo. Utilice una llave inglesa de ser necesario.
2. Para grifos con roscas externas, quite las arandelas más gruesa. Para grifos con roscas internas, deje la arandela más gruesa en su lugar. Instale en el surtidor de agua en forma manual.
3. Abrir el grifo. Si ocurre un escape, ajuste más firmemente.

Visit us at [www.neoperl.com/consumer](http://www.neoperl.com/consumer) and make changing your aerator part of your yearly faucet maintenance.