

Twist & Shout™ Rod Instructions

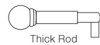

Two people are recommended for the installation of this product. For safety, please use a step ladder.

1. Apply Drapery



Thick Rod



Thin Rod

*See styling tip for grommet panels.

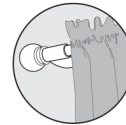

REATTACH

2. Unlock Rod

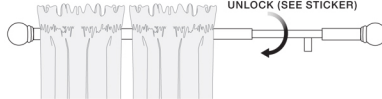

UNLOCK (SEE STICKER)

3. Extend + Lock Rod

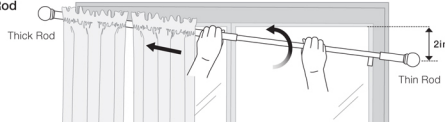

Thick Rod

2in

Thin Rod

EXTEND AND
APPLY PRESSURE



TURN TO LOCK TIGHTLY
(SEE STICKER)

4. Push Up

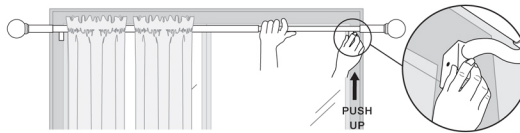

PUSH
UP

5. Tighten

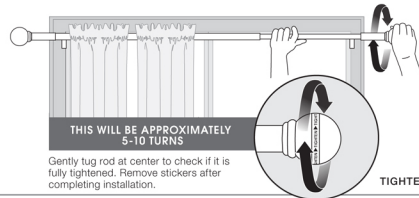

THIS WILL BE APPROXIMATELY
5-10 TURNS

Gently tug rod at center to check if it is fully tightened. Remove stickers after completing installation.

TIGHTEN

STYLE TIP FOR GROMMET PANELS:

If using grommet panels, apply panels as shown below during step 2:



Once rod installation is finished, apply end grommets over finial as shown.

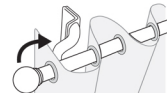

Optional: For heavier drapery, you may choose to use the provided screws in the bracket ends. Sizes 48" - 84" may require use of provided rod support.

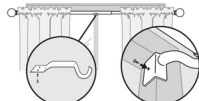

ROD SUPPORT
48" - 84" ROD

OPTIONAL SMALL
BRACKET SCREWS

MOVING & RE-ADJUSTING:

If you used the optional screws provided, remove them before re-adjusting. While one person holds the left side, loosen the right bracket finial by twisting it towards you until it cannot rotate any further. Unlock the rod by twisting towards you. Repeat installation steps starting at step 2.

RELEASE
TENSION

