

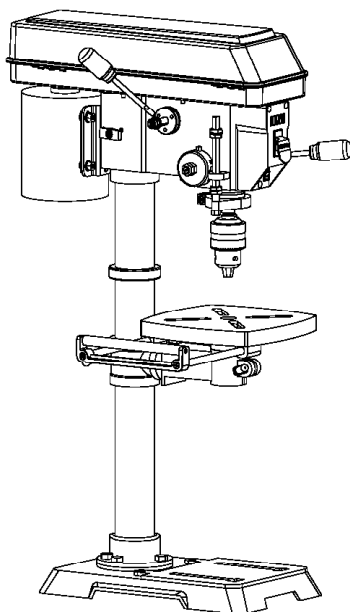

12" VARIABLE SPEED DRILL PRESS



2015
Model # 4214
bit.ly/wenvideo

IMPORTANT:

Your new tool has been engineered and manufactured to WEN's highest standards for dependability, ease of operation, and operator safety. When properly cared for, this product will supply you years of rugged, trouble-free performance. Pay close attention to the rules for safe operation, warnings, and cautions. If you use your tool properly and for intended purpose, you will enjoy years of safe, reliable service.



NEED HELP? CONTACT US!

Have product questions? Need technical support?
Please feel free to contact us at:

 **800-232-1195** (M-F 8AM-5PM CST)

 **techsupport@wenproducts.com**

 **WENPRODUCTS.COM**

TABLE OF CONTENTS

Technical Data	2
General Safety Rules	3
Specific Safety Rules For Drill Press	4
Electrical Information	5
Know Your Drill Press	7
Assembly and Adjustments	8
Operation	16
Maintenance	19
Troubleshooting	20
Exploded View and Parts List	21
Warranty	24

TECHNICAL DATA

Model Number:	4214
Motor:	120 V, 60 Hz, 5 A
Speed:	580-3200 RPM (no load)
Chuck Capacity:	1/8--5/8"
Stroke:	3-1/8"
Capacity:	6" (chuck to column) 20" (chuck to base)
Table tilt:	0 to 45° left and right
Laser:	Class III, transformer powered
Weight:	85 lb

GENERAL SAFETY RULES

Safety is a combination of common sense, staying alert and knowing how your item works. **SAVE THESE SAFETY INSTRUCTIONS.**



WARNING: To avoid mistakes and serious injury, do not plug in your tool until the following steps have been read and understood.

1. **READ** and become familiar with this entire instruction manual. **LEARN** the tool's applications, limitations, and possible hazards.
2. **AVOID DANGEROUS CONDITIONS.** Do not use power tools in wet/damp areas or expose them to rain. Keep work areas well lit.
3. **DO NOT** use power tools in the presence of flammable liquids or gases.
4. **ALWAYS** keep your work area clean, uncluttered, and well lit. **DO NOT** work on floor surfaces that are slippery with sawdust or wax.
5. **KEEP BYSTANDERS AT A SAFE DISTANCE** from the work area, especially when the tool is operating. **NEVER** allow children or pets near the tool.
6. **DO NOT FORCE THE TOOL** to do a job for which it was not designed.
7. **DRESS FOR SAFETY.** Do not wear loose clothing, gloves, neckties, or jewelry (rings, watches, etc.) when operating the tool. Inappropriate clothing and items can get caught in moving parts and draw you in. **ALWAYS** wear non-slip footwear and tie back long hair.
8. **WEAR A FACE MASK OR DUST MASK** to fight the dust produced by sawing operations.



WARNING: Dust generated from certain materials can be hazardous to your health. Always operate the tool in a well-ventilated area and provide for proper dust removal. Use dust collection systems whenever possible.

9. **ALWAYS** remove the power cord plug from the electrical outlet when making adjustments, changing parts, cleaning, or working on the tool.
10. **KEEP GUARDS IN PLACE AND IN WORKING ORDER.**
11. **AVOID ACCIDENTAL START-UPS.** Make sure the power switch is in the OFF position before plugging in the power cord.
12. **REMOVE ADJUSTMENT TOOLS.** Always make sure all adjustment tools are removed from the saw before turning it on.
13. **NEVER LEAVE A RUNNING TOOL UNATTENDED.** Turn the power switch to OFF. Do not leave the tool until it has come to a complete stop.

GENERAL SAFETY RULES

14. **NEVER STAND ON A TOOL.** Serious injury could result if the tool tips or is accidentally hit. **DO NOT** store anything above or near the tool.
15. **DO NOT OVERREACH.** Keep proper footing and balance at all times. Wear oil-resistant rubber-soled footwear. Keep the floor clear of oil, scrap, and other debris.
16. **MAINTAIN TOOLS PROPERLY.** **ALWAYS** keep tools clean and in good working order. Follow instructions for lubricating and changing accessories.
17. **CHECK FOR DAMAGED PARTS.** Check for alignment of moving parts, jamming, breakage, improper mounting, or any other conditions that may affect the tool's operation. Any part that is damaged should be properly repaired or replaced before use.
18. **MAKE THE WORKSHOP CHILDPROOF.** Use padlocks and master switches and **ALWAYS** remove starter keys.
19. **DO NOT** operate the tool if you are under the influence of drugs, alcohol, or medication that may affect your ability to properly use the tool.
20. **USE SAFETY GOGGLES AT ALL TIMES** that comply with ANSI Z87.1. Normal safety glasses only have impact resistant lenses and are not designed for safety. Wear a face or dust mask when working in a dusty environment. Use ear protection such as plugs or muffs during extended periods of operation.

SPECIFIC RULES FOR DRILL PRESS



WARNING: Do not operate this tool until it is completely assembled and installed according to the instructions.

1. Never turn the drill press on until the table is clear of all foreign objects (tools, scraps, etc.).
2. Always keep hands and fingers away from the drill bit.
3. Do not drill materials without a flat surface unless a suitable support is used (clamp or vice).
4. Never start the drill press with the drill bit pressed against the workpiece.
5. Make sure the table lock is tightened before starting the drill press.
6. Never layout, assemble, or set-up any work on the table while the drill is on.
7. Make sure the drill bit is securely locked in the chuck.
8. Make sure the chuck key is removed from the chuck before turning power on.
9. Adjust the table or depth stop to avoid drilling into the table.

SPECIFIC RULES FOR DRILL PRESS

10. Always stop the drill before removing scrap pieces from the table.
11. Use clamps or a vise to secure a workpiece to the table. This will prevent the workpiece from rotating with the drill bit.
12. Do not wear gloves when operating a drill press.
13. Set the drill press to the speed that is appropriate for the material being drilled.
14. If any part of the drill press is missing/damaged or if the electrical components fail to perform properly, shut the power OFF and unplug the drill press. Replace missing, damaged or failed parts before resuming operation.
15. Before leaving the machine, shut the power off, remove the drill bit and clean the table.

ELECTRICAL INFORMATION

GROUNDING INSTRUCTIONS

IN THE EVENT OF A MALFUNCTION OR BREAKDOWN, grounding provides the path of least resistance for an electric current and reduces the risk of electric shock. This tool is equipped with an electric cord that has an equipment grounding conductor and a grounding plug. The plug **MUST** be plugged into a matching outlet that is properly installed and grounded in accordance with **ALL** local codes and ordinances.

DO NOT MODIFY THE PLUG PROVIDED. If it will not fit the outlet, have the proper outlet installed by a licensed electrician.

IMPROPER CONNECTION of the equipment grounding conductor can result in electric shock. The conductor with the green insulation (with or without yellow stripes) is the equipment grounding conductor. If repair or replacement of the electric cord or plug is necessary, **DO NOT** connect the equipment grounding conductor to a live terminal.

CHECK with a licensed electrician or service personnel if you do not completely understand the grounding instructions or whether the tool is properly grounded.

USE ONLY THREE-WIRE EXTENSION CORDS that have three-pronged plugs and outlets that accept the tool's plug as shown in Fig. A. Repair or replace a damaged or worn cord immediately.

CAUTION: In all cases, make certain the outlet in question is properly grounded. If you are not sure, have a licensed electrician check the outlet.

WARNING: This tool is for indoor use only. Do not expose to rain or use in damp locations.

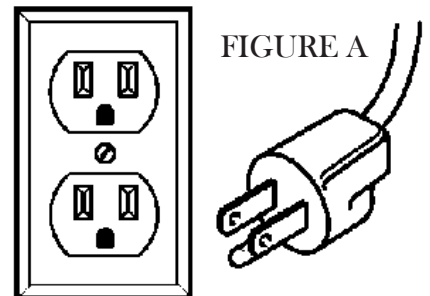

ELECTRICAL INFORMATION

GUIDELINES FOR USING EXTENSION CORDS

Make sure your extension cord is in good condition. When using an extension cord, be sure to use one heavy enough to carry the current your product will draw. An undersized cord will cause a drop in line voltage resulting in loss of power and overheating. The table below shows the correct size to be used according to cord length and nameplate ampere rating. When in doubt, use a heavier cord. The smaller the gauge number, the heavier the cord.

AMPERAGE	REQUIRED GAUGE FOR EXTENSION CORDS			
	25 ft.	50 ft.	100 ft.	150 ft.
5 A	18 gauge	16 gauge	16 gauge	14 gauge

Make sure your extension cord is properly wired and in good condition. Always replace a damaged extension cord or have it repaired by a qualified person before using it.

Protect your extension cords from sharp objects, excessive heat and damp/wet areas.



Use a separate electrical circuit for your tools. This circuit must not be less than a #12 wire and should be protected with a 15 A time-delayed fuse. Before connecting the motor to the power line, make sure the switch is in the OFF position and the electric current is rated the same as the current stamped on the motor nameplate. Running at a lower voltage will damage the motor.

WARNING: This tool must be grounded while in use to protect the operator from electric shock.

KNOW YOUR DRILL PRESS

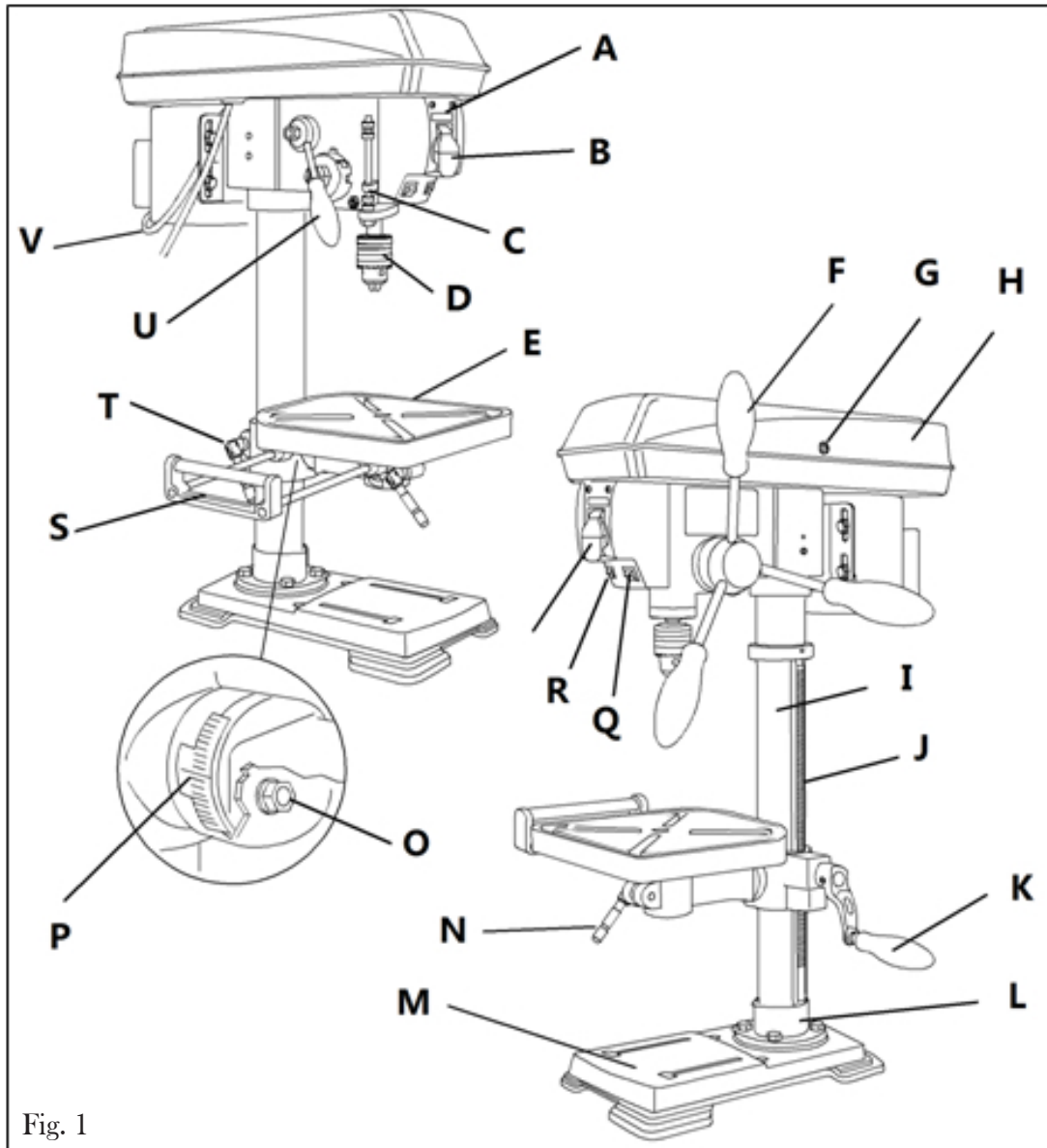

Fig. 1

A	Digital Speed Readout	I	Column	Q	Laser ON/OFF Switch
B	ON/OFF Switch	J	Rack	R	LED Worklight Switch
C	Depth Scale	K	Crank Handle	S	Extension Wing with Integrated Rollers
D	Chuck	L	Column Support	T	Support Lock Handle
E	Table	M	Base	U	Speed Control Handle
F	Feed Handles	N	Table Lock Handle	V	Power Cord
G	Housing Cover Screw	O	Bevel Lock Bolt		
H	Housing Cover	P	Bevel Scale		

ASSEMBLY AND ADJUSTMENTS

UNPACKING (Fig. 2)

Unpack the drill press and all of its parts. Compare against the list below. Do not discard the carton or any packaging until the drill press is completely assembled.

To protect the drill press from moisture, a protective coating has been applied to the machine's surfaces. Remove this coating with a soft cloth moistened with kerosene or WD-40®. Do not use acetone, gasoline, or lacquer thinner to clean. Apply a coat of good paste wax to the table and column. Wipe all parts with a clean dry cloth.

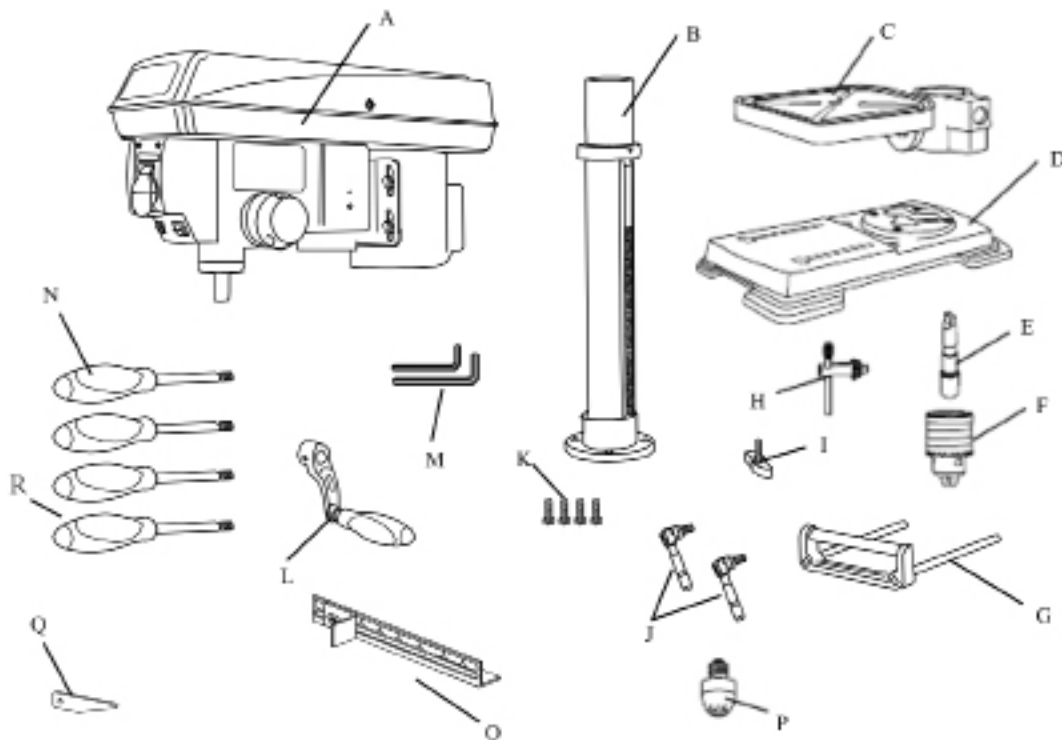

Fig. 2

- | | | | |
|---|--|---|------------------------|
| A | Head/Motor Assembly | J | Table Lock Handles (2) |
| B | Column Assembly | K | Hex Head Bolts (4) |
| C | Table | L | Table Crank Handle |
| D | Base | M | Hex Keys |
| E | Chuck Arbor | N | Feed Handles (3) |
| F | Chuck | O | Clamo Assembly Pack |
| G | Extension Wing with Integrated rollers | P | LED Bulb |
| H | Chuck Key | Q | Wedge |
| I | Wing Knobs (2) | R | Speed Handles |

ASSEMBLY AND ADJUSTMENTS



WARNING: If any part is missing or damaged, do not plug the drill press in until the missing or damaged part is repaired or replaced.

The column assembly (column, column support, rack, rack collar, and table support bracket) must be attached to the base. The table and table support handles must be attached to the table support bracket. The motor housing must be attached to the column.

Tools needed for assembly

- Adjustable wrench
- screwdriver
- Hammer and block of wood

COLUMN ASSEMBLY TO BASE (Fig. 3)

1. Place the column tube (1) on the base (2), aligning the column support holes to the base holes.
2. Install a hex head bolt (3) in each column support hole and tighten bolts using the adjustable wrench.

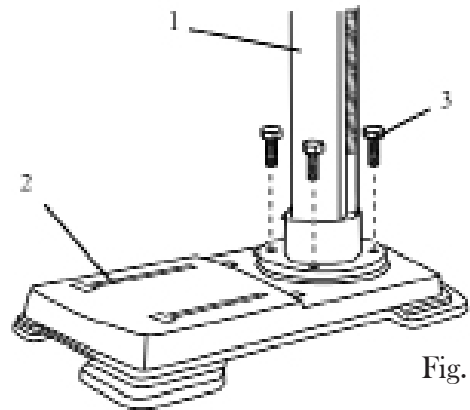

Fig. 3

TABLE TO TABLE SUPPORT BRACKET (Fig. 4)

1. Place the crank handle (1) onto the shaft (2) of the table bracket so the flat of the shaft is under the set screw (3). Tighten the set screw.
2. Thread the table lock handle (4) into the front of the table support bracket.
3. Thread the table support lock handle into the rear of the table support bracket (not shown).
4. Position the table (5) in the same direction as the base. Install the table and tighten the table lock handle (4) and support lock handle.

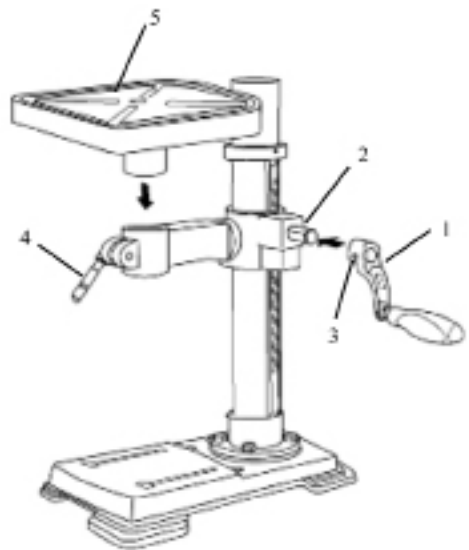

Fig. 4

ASSEMBLY AND ADJUSTMENTS

DRILL PRESS HEAD TO COLUMN (Fig. 5)

CAUTION: The drill press head is heavy. To avoid injury, two people should lift it into position.

1. Carefully lift the drill press head assembly (1) and position it over the column (2).
2. Place the mounting opening (3) on the drill press head over the top of the column. Make sure the drill press head is seated properly on the column.
3. Align the direction of the drill press head with the direction of the base and the table.
4. Tighten the set screw (4) using a hex key.

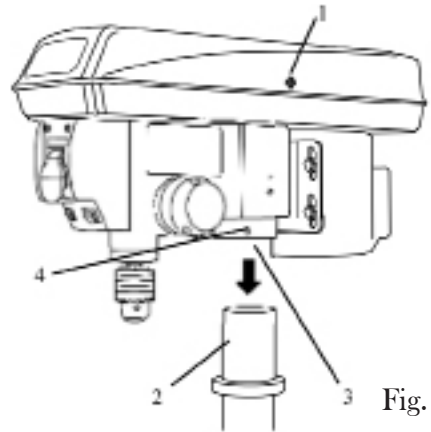

Fig. 5

FEED HANDLES (Fig. 6)

1. Insert the three speed handles (1) into the threaded openings on the feed hub (2).
2. Manually tighten the handles into the openings.

Note: When using the drill press, one or two of the feed handles may be removed if an unusually-shaped workpiece interferes with handle rotation.

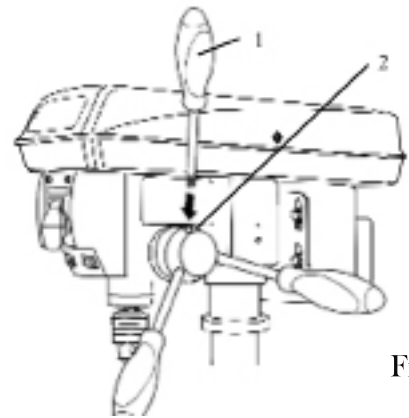

Fig. 6

SPEED HANDLE (Fig. 7)

1. Insert the feed handle (1) into the threaded opening on the speed hub (2).
2. Manually tighten handle into opening.

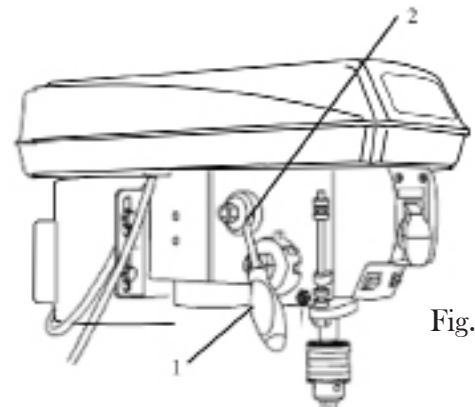

Fig. 7

ASSEMBLY AND ADJUSTMENTS

MOUNT THE DRILL PRESS (Fig. 8)

The drill press must be securely fastened through the mounting holes to a stand or workbench with heavy-duty fasteners. This will prevent the drill press from tipping over, sliding, or walking during operation.

IMPORTANT: If the stand or workbench has a tendency to move during operation, fasten the workbench securely to the floor.

LED BULB

An LED bulb has been assembled in the socket of the head.

Warning: To reduce risk of fire, **DO NOT** use a light bulb greater than 40 watts. When changing the light bulb, always check that the power switch is in the OFF position and the plug is disconnected from its power source.

INSTALL THE CHUCK (Fig. 9)

1. Inspect and clean the taper hole in the chuck and the spindle. Remove all grease, coatings, and particles from the chuck and spindle surfaces with a clean cloth.
2. Open the chuck jaws by manually turning the chuck barrel clockwise. Make sure the jaws are completely recessed inside the chuck.
3. Insert the chuck arbor into the opening at the top of the chuck.
4. Seat the chuck and chuck arbor on the spindle by placing a block of wood (not included) under the chuck and tapping the wood with a hammer (not included). Alternatively, tap the chuck with a rubber mallet (not included).

CAUTION: To avoid damaging the chuck, make sure the jaws are completely recessed into the chuck. Do not use a metal hammer to drive the chuck into the spindle.

REMOVE THE CHUCK (Fig. 10)

1. Turn the feed handles (1) to lower the chuck to the lowest position.
2. Slide the wedge into the opening in the quill. Tap on the wedge using a hammer (not included). The chuck and arbor will drop out.

Note: To avoid possible damage to the drill or chuck, be prepared to catch the chuck as it falls.

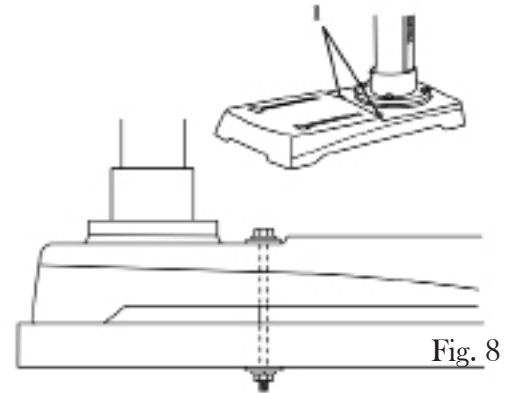

Fig. 8

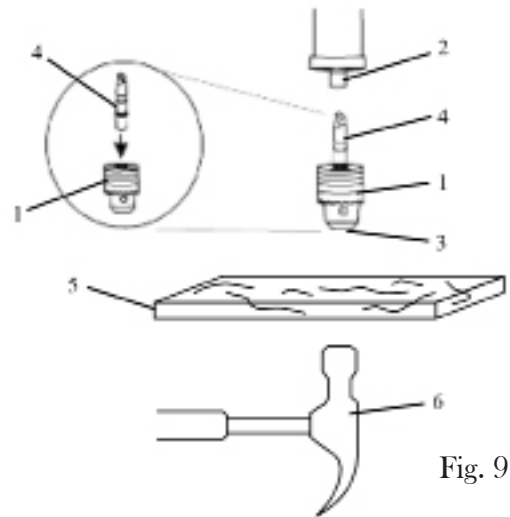

Fig. 9

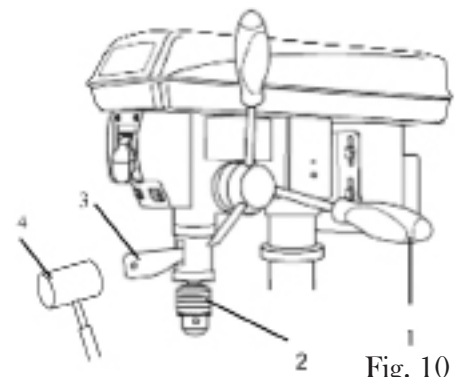

Fig. 10

ASSEMBLY AND ADJUSTMENTS

RAISE OR LOWER THE TABLE (Fig. 11)

1. Loosen the support lock handle (1) and turn the crank handle (2) until the table is at the desired height.
2. Tighten the support lock handle before drilling.

ROTATE THE TABLE (Fig. 11)

1. Loosen the support lock handle (1) and turn the table around the column to the desired position.

Note: The rack should rotate around the column with the table support bracket. If the rack binds and does not rotate, slightly loosen the set screw in the rack collar.

2. Tighten the support lock before drilling.

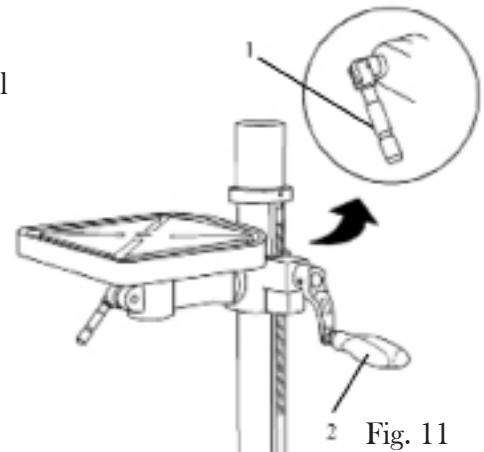

Fig. 11

TILT THE TABLE (Fig. 12)

1. Rotate the table clockwise with the fork wrench. Pull out the location pin. Put the location pin and nut in a suitable area.
2. Rotate the bolt (1) counterclockwise with a wrench to loosen it.
3. Adjust the angle of the table.
4. Tighten the bolt with fork wrench.

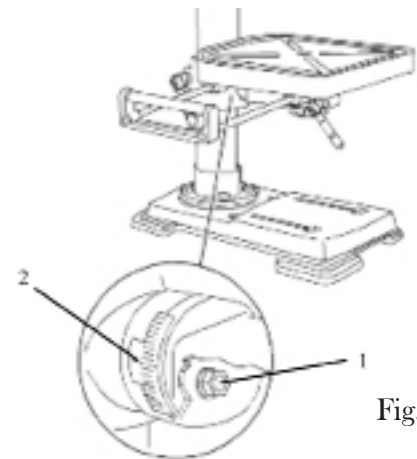

Fig. 12

ADJUST THE TABLE TO BE HORIZONTAL

1. Rotate the bolt (1) counterclockwise with a wrench to loosen it.
2. Rotate the table to 0°.
3. Hit the location pin (2) into the location hole in the table support with a hammer.
4. Tighten the nut of the location pin (2) slightly.
5. Lock the bolt (1) with a wrench.

ASSEMBLY AND ADJUSTMENTS

WARNING: To avoid injury, make sure the chuck key is removed from the chuck before starting any drilling operation.

INSTALLING A DRILL BIT (Fig. 13)

1. Place the chuck key (1) into the side keyhole of the chuck (2), meshing the key with the gear teeth.
2. Turn the chuck key counterclockwise to open the chuck jaws (3).
3. Insert a drill bit (4) into the chuck far enough to obtain the maximum grip of the chuck jaws.
4. Center the drill bit in the chuck jaws before the final tightening of the chuck.
5. Tighten the chuck jaws using the chuck key to ensure that the drill bit will not slip while drilling.
6. Remove the chuck key.

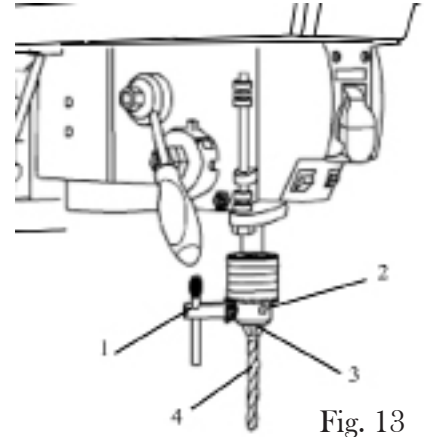

SQUARING THE TABLE TO THE DRILL BIT (Fig. 14)

1. Insert a 3" long drill bit (1) into the chuck (2) and tighten the jaws with the chuck key.
2. Raise the table with the crank handle (3). Lock the table (4) approximately 1" below the drill bit.
3. Place a combination square (5; not included) on the table as shown, placing the long straight edge of the combination square against the drill bit. Make sure the drill bit is parallel/aligned exactly to the straight edge of the square.
4. If an adjustment is needed, loosen the bevel lock bolt (6) with a wrench.
5. Tilt the table slightly, until the combination straight edge is aligned perfectly with the drill bit.
6. Tighten the bevel lock when square.

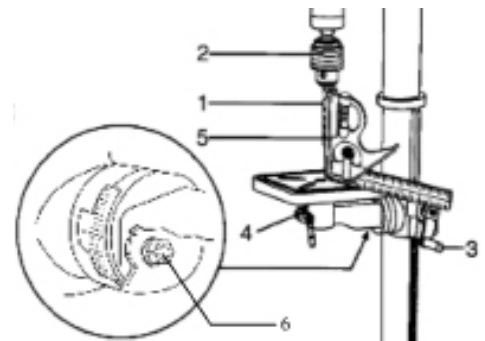

Note: Adjustments for the correct function of your drill press return spring have been done by the factory. Please do not modify them. However, prolonged use of the drill press may make some readjustments necessary.

ASSEMBLY AND ADJUSTMENTS

ADJUSTING THE LASER (Fig. 15 and 16)

WARNING: Do not stare directly at the laser beam. Please observe all safety rules.

- Never aim the beam at a person or an object other than the workpiece.
- Do not project the laser beam into the eyes of others.
- Always make sure the laser beam is aimed at a workpiece that does not possess reflective surfaces, as the laser beam could project into your eyes or the eyes of others.

1. Place a workpiece on the table.
2. Turn the laser switch (1) to the ON position.
3. Lower the drill bit to meet the workpiece (2). The two laser lines should cross where the drill meets the workpiece.
4. If the laser needs to be adjusted:
 - a. Using a 3 mm hex key, turn the laser adjustment set screws (3) counter-clockwise.
 - b. Rotate the laser light housing (4) until the two laser lines intersect where the drill meets the workpiece. **DO NOT** stare directly at the laser lines.
5. Re-tighten the adjustment set screws (3).

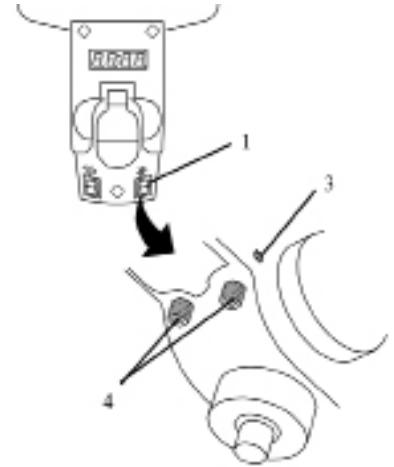

Fig. 15

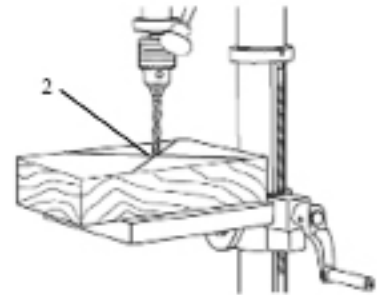

Fig. 16

SPINDLE RETURN SPRING (Fig. 17)

The spindle is equipped with an auto-return mechanism. The main components are a spring and a notched housing. The spring was properly adjusted at the factory and should not be readjusted unless absolutely necessary.

1. Unplug the drill press.
2. Place a screwdriver into the loop (1) to hold the spring in place.
3. Loosen the two housing nuts (2) approximately 1/4" (6 mm). Do not remove the nuts from the threaded shaft. Do not allow the spring or spring housing to slip out of control.
4. While firmly holding the spring housing (3), carefully pull the spring housing out until it clears the raised notch (4).
5. Turn the housing so that the next notch (5) is engaged with the raised notch (4).
 - To increase the spindle return tension, turn the spring housing counter-clockwise.
 - To decrease the tension, turn the spring housing clockwise.
6. Tighten the two housing nuts. Do not overtighten the two nuts. If the nuts are tightened too much, the movement of the spindle and feed handles will become sluggish.

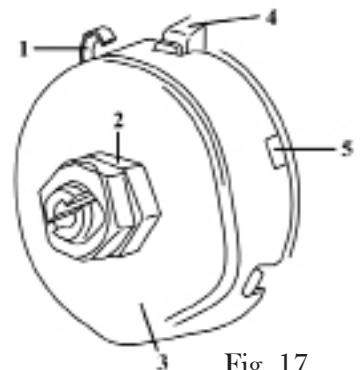

Fig. 17

ASSEMBLY AND ADJUSTMENTS

ANGULAR “PLAY” OF THE SPINDLE (Fig. 18)

Move the spindle to the lowest downward position and hold in place. Try to make the spindle revolve around its axis while also moving it with a side motion. If there is too much “play”, proceed as follows:

1. Loosen the lock nut (1).
2. Without obstructing the upward and downward motion of the spindle, turn the screw (2) clockwise to eliminate the “play.” Note: A little bit of “play” is normal.
3. Tighten the lock nut (1).

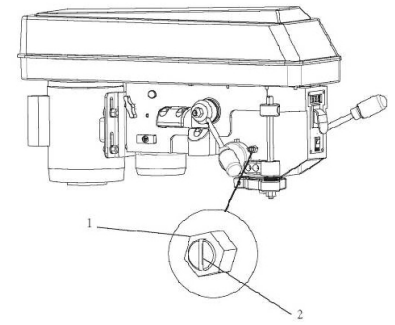

Fig. 18

REPLACING THE BELT (Fig. 19)

WARNING: Disconnect the drill press from the power source before replacing the belt.

Belt tension and drill press speed is controlled by automatic adjustments made to the diameter of the front spindle when the drive handle is moved.

Note: See page 19 for information on the variable speed function of this drill press.

1. Remove the screw that secures the housing cover (1). Open the housing cover.
2. Remove the belt (2) from the housing cover if it is broken. If it is not broken, but is too stretched to operate correctly, work the belt off the drive (motor) spindle (3). Then remove the belt from the front spindle (4).
3. Replace the belt by putting a new belt over the front spindle (4) and carefully sliding the belt over the drive (motor) spindle (3).

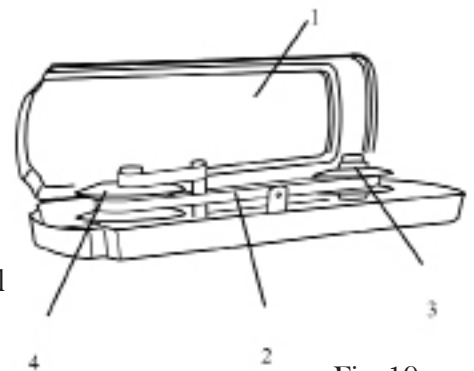

Fig. 19

WARNING: Do not change the drive speed when the drill press is turned off.

OPERATION

DRILL PRESS ON/OFF SWITCH (Fig. 20)

1. To turn the drill press ON, insert the yellow safety key (1) into the switch housing (2). As a safety feature, the switch cannot be turned ON without the safety key.
2. Flip the switch upward to the ON position.
3. To turn the drill press OFF, flip the switch downward.
4. To lock the switch in the OFF position, remove the safety key (1) from the switch. Store the safety key in a safe place.

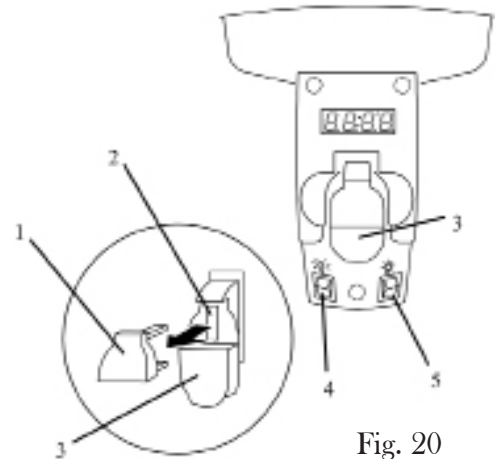

Fig. 20

LIGHT AND LASER LINE ON/OFF SWITCHES (Fig. 20)

The light switch (3) is located on the lamp cover.

The laser switch (4) is located below the ON/OFF switch on the right.

POSITION THE TABLE AND WORKPIECE (Fig. 21)

Always place a piece of backup material (1) (wood, plywood, etc.) on the table underneath the workpiece (2). This will prevent splintering on the underside of the workpiece as the drill bit breaks through. To keep the material from spinning out of control, it must contact the left side (3) of the column as illustrated, or be clamped (4; not included) to the table.

Note: For small workpieces that cannot be clamped to the table, use a drill press vise (not included). The vise must be clamped or bolted to the table to avoid injury.

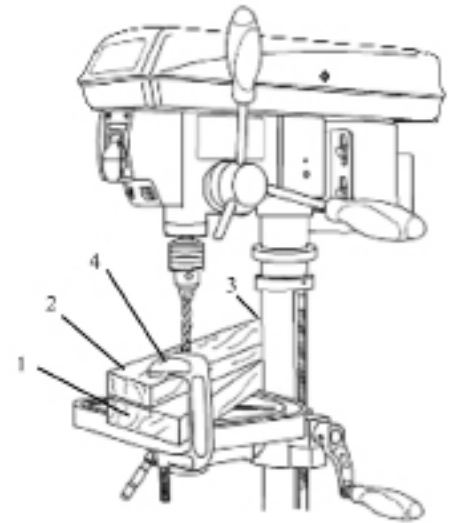

Fig. 21

GENERAL DRILLING GUIDELINES - DRILLING A HOLE

WARNING: To prevent the workpiece and the backup material from slipping from your hand while drilling, position the workpiece and backup material to the left side of the column. If the workpiece and the backup material are not long enough to reach the column, clamp the workpiece and backup material to the table. Failure to do this could result in personal injury.

1. Mark where you want to drill in workpiece by using a center punch or a sharp nail or turn ON the laser to mark your drilling point.
2. Before turning the drill press ON, turn the feed handles to bring the drill bit down. Line the drill bit tip up with the mark. Clamp the workpiece in place.
3. Turn ON the drill press and pull down on the feed handles with the appropriate force needed to allow the drill bit to drill the material.

Note: Feeding too slowly might cause the drill bit to turn in the chuck. Feeding too rapidly might stop the motor, cause the belt to slip, force the workpiece loose, or break the drill bit. Practice with scrap material to get the feel of the machine before attempting to do any drilling operation.

OPERATION

ADJUST THE DRILLING DEPTH (Fig. 22)

The depth gauge controls the maximum distance the drill bit will move up or down.

To stop the drill bit at a pre-measured depth, loosen the depth scale knob (1) by push button (2) until the bottom of the knob is aligned with the desired depth mark (3) on the gauge scale.

Drilling an unmeasured blind hole (not all the way through the workpiece) to a given depth can be done using either the depth scale method or the workpiece method.

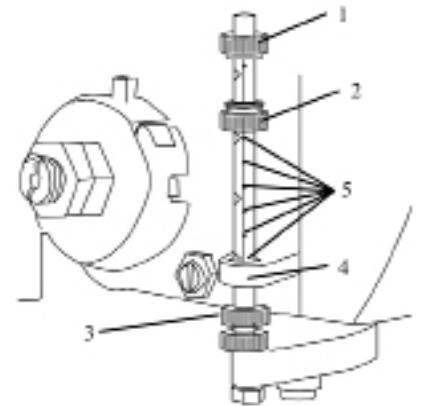

Fig. 22

DEPTH SCALE METHOD (Fig. 22)

1. Make sure the 0 (" or mm) mark on the depth gauge rests at the top edge of the metal support (4) when the quill is fully retracted.
2. Put the workpiece on the table and raise the table until the tip of the drill bit just touches the top of the workpiece. Lock the table in place.
3. Determine the drill depth for this workpiece.
4. Rotate the depth knob (2) until it is aligned with the desired depth mark (3) (for example, 1") on the gauge scale.
5. The chuck will be stopped at the distance selected on the depth scale.

WORKPIECE METHOD (Fig. 22 and 23)

1. Mark the desired depth (5) of the drill hole on the side of the workpiece.
2. With the drill press in the OFF position, bring the drill bit (6) down until the tip is even with the mark.
3. Holding the feed handles at this position, rotate the depth knob (2) until it meets the metal support.
4. The chuck and the drill bit will now be stopped at the distance selected on the depth scale.

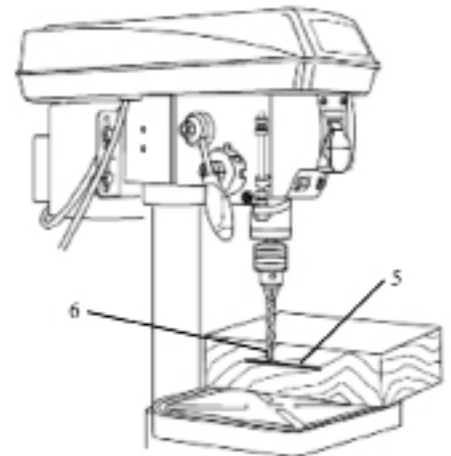

Fig. 23

OPERATION

DRILLING SPEEDS

There are a few important factors to keep in mind when determining the best drilling speed:

- Material type
- Hole size
- Drill bit or cutter type
- Quality desired

Smaller drill bits require greater speed than larger drill bits. Softer materials require greater speed than harder materials. See page 19 for recommended speeds for particular materials.

DRILLING METAL

- Use metal-piercing twist drill bits.
- It is always necessary to lubricate the tip of the drill with oil to prevent overheating of the drill bit.
- All metal workpieces should be clamped down securely. Any tilting, twisting, or shifting causes a rough drill hole, and increases the potential of drill bit breakage.
- Never hold a metal workpiece with your bare hands. The cutting edge of the drill bit may seize the workpiece and throw it, causing serious injury. The drill bit will break if the metal piece suddenly hits the column.
- If the metal is flat, clamp a piece of wood under it to prevent turning. If it cannot be laid flat on the table, then it should be blocked and clamped.

DRILLING WOOD

- Brad point bits are preferred. Metal piercing twist bits may be used on wood.
- Do not use auger bits. Auger bits turn so rapidly that they can lift the workpiece off of the table and whirl it around.
- Always protect the drill bit by positioning the table so that the drill bit will enter the center hole when drilling through the workpiece.
- To prevent splintering, feed the drill bit slowly right as the bit is about to cut through to the backside of the workpiece.
- To reduce splintering and protect the point of the bit, use scrap wood as a backing or a base block under the workpiece.

FEEDING THE DRILL BIT

- Pull down on the feed handles with only enough force to allow the drill bit to cut.
- Feeding too rapidly might stall the motor, cause the belt to slip, damage the workpiece, or break the drill bit.
- Feeding too slowly will cause the drill bit to heat up and burn the workpiece.

MECHANICAL VARIABLE SPEED (Fig. 24)

This is a mechanical variable speed drill press. To increase or decrease the speed when operating, raise or lower the speed handle (1).

Use the following table to determine the recommended speed for the drill size you are using and the type of material you are to drill. While drilling, check the speed on the digital speed readout (2) located at the front of the drill press.

Warning: Do not change speeds using the variable speed handle without turning on the machine.

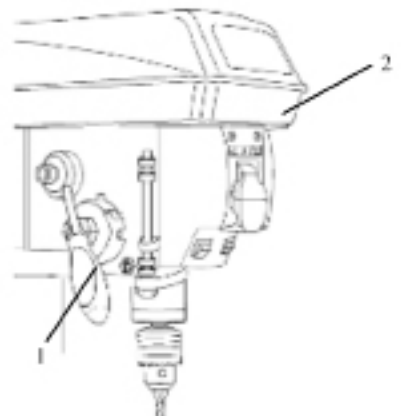

OPERATION

SPEED RANGE (RPM)	WOOD Drill bit size		ALUMINUM / ZINC / BRASS Drill bit size		IRON / STEEL Drill bit size	
	inches	mm	inches	mm	inches	mm
2000 -3200	3/8	9.5	7/32	5.6	3/32	2.4
1400 -2000	5/8	16.0	11/32	8.75	5/32	4.0
1000 -1400	7/8	22.0	15/32	12.0	1/4	6.4
800 -1000	1 1/4	31.75	11/16	17.5	3/8	9.5
580 -800	1 5/8	41.4	3/4	19.0	5/8	16.0

Recommended speed for drill bit size and materials

MAINTENANCE

WARNING: For your safety, turn the switch off and remove the plug from the power supply before maintaining or lubricating the drill press.

Vacuum sawdust or metal shavings that accumulate in and on the motor, pulley housing, table, and work surface.

Apply a light coat of paste wax to the column and table to help keep these surfaces clean and rust-free.

The ball bearings in the spindle and the V-belt pulley assembly are greased and permanently sealed. Pull the spindle down and oil the spindle sleeve moderately every three months.

Lubricate the table bracket and locking knobs if they become difficult to use.

CAUTION: All servicing of the drill press should be performed by a qualified service technician.

TROUBLESHOOTING

PROBLEM	CAUSES	SOLUTIONS
Noisy operation	1) Incorrect belt tension 2) Dry spindle 3) Loosed spindle pulley 4) Loosed motor pulley	1) Adjust the belt tension (See REPLACE THE BELT section) 2) Lubricate the spindle 3) Tighten the retaining nut on the pulley insert 4) Tighten the set screw on the side of the motor pulley
The drill bit burns or smokes	1) Drilling at the incorrect speed 2) The wood chips are not coming out of the hole 3) Dull drill bit 4) Feeding the workpiece too slowly 5) Not lubricated	1) Change the speed 2) Retract the drill bit frequently to clear the chips 3) Resharpen or replace the drill bit 4) Feed fast enough to cut the workpiece 5) Lubricate the drill bit with cutting oil or motor oil
Excessive drill run out or wobble; drilled hole is not round	1) Bent drill bit 2) Bit improperly installed in the chuck 3) Worn spindle bearings 4) Lengths of cutting flutes or angles not appropriate for the hardness of the wood grain 5) Chuck not properly installed	1) Replace the drill bit 2) Reinstall the bit. 3) Replace the bearing. Take the press to a qualified service technician 4) Resharpen the drill bit correctly or replace with the appropriate type. 5) Reinstall the chuck.
Drill bit binds in the workpiece	1) The workpiece is pinching the bit 2) Excessive feed pressure	1) Support or clamp the workpiece. 2) Feed more slowly.
Spindle returns too slowly or too quickly	Coil spring has improper tension	Adjust the coil spring tension
Chuck falls off spindle	Dirt, grease, or oil on the tapered surface on the spindle or in the chuck	Clean the tapered surface of both the chuck and spindle with a household detergent.
Motor will not run	1) Defective or broken switch 2) Defective or damaged power cord 3) Open circuit, loose connections, or burned out motor 4) Low voltage	1) Take to a qualified service technician 2) Take to a qualified service technician 3) Take to a qualified service technician 4) Check the power line for the proper voltage. Use another circuit or have a qualified electrician upgrade the service.
Motor stalls	1) Short circuit in motor 2) Incorrect fuses or circuit breakers 3) Overloaded circuit 4) Low Voltage	1) Take to a qualified service technician 2) Replace with correct fuse or circuit breaker for the circuit 3) Turn off other machines and retry 4) Check the power line for the proper voltage. Use another circuit or have a qualified electrician upgrade the service.

EXPLODED VIEW & PARTS LIST

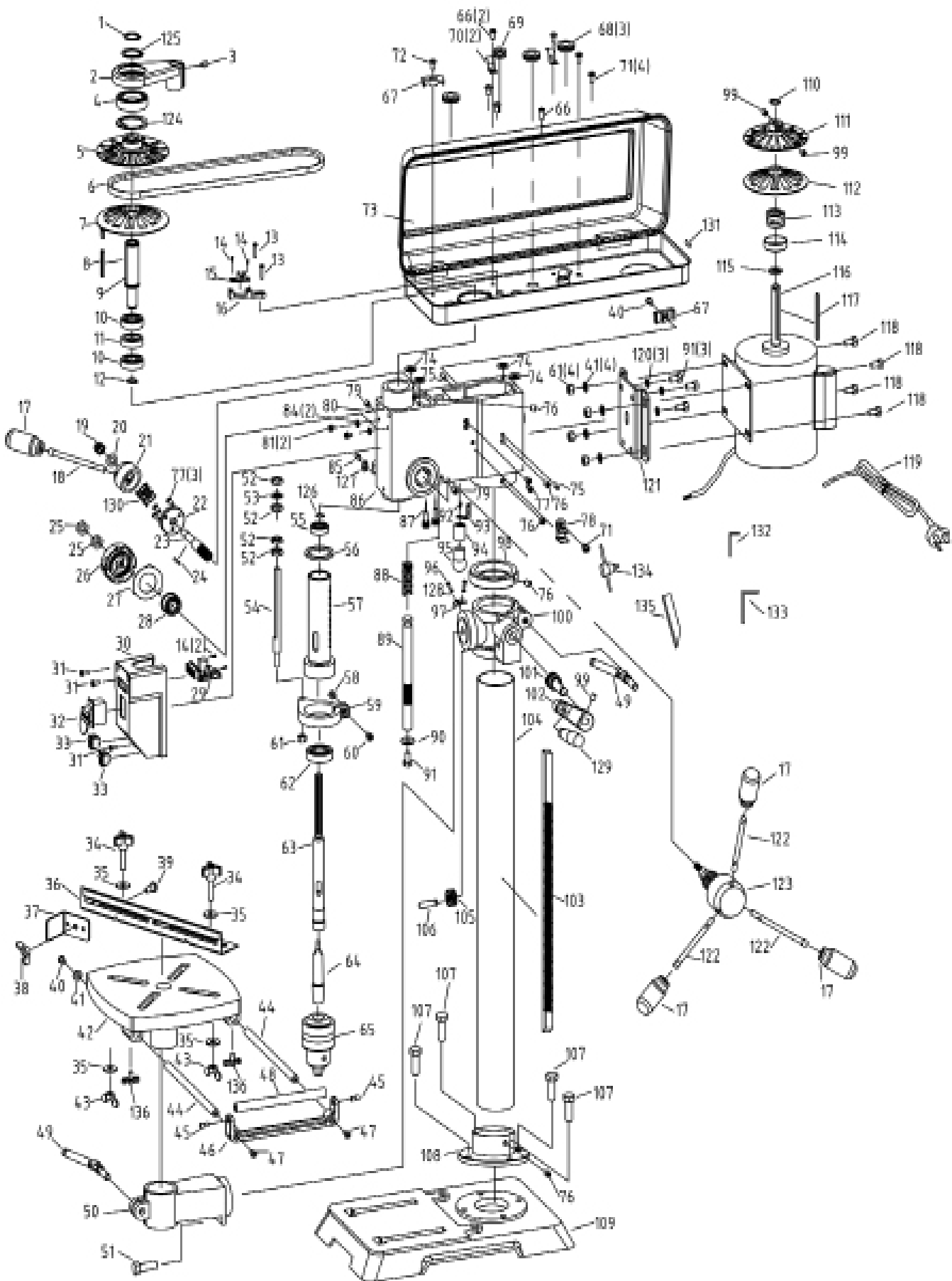

EXPLODED VIEW & PARTS LIST

Item #	Stock #	Description	Qty
1	4214B-001	Circlip	1
2	4214B-002	Cam	1
3	4214B-003	Screws M8x12	1
4	4214B-004	Bearing 61907	1
5	4214B-005	Spindel moveable pulley	1
6	4214B-006	V-belt M-36	1
7	4214B-007	Spindle fixed pulley	1
8	4214B-008	Key A type 4x4x64	1
9	4214B-009	Shaft sleeve	1
10	4214B-010	Bearing 6203RZ	2
11	4214B-011	Retainer	1
12	4214B-012	Circlip	1
13	4214B-013	Screw	2
14	4214B-014	Screw ST2.9x6.5	4
15	4214B-015	Counter	1
16	4214B-016	Counter base	1
17	4214B-017	Handle knob	4
18	4214B-018	Variable speed handle	1
19	4214B-019	Lock nut M10	1
20	4214B-020	Flat washer 10	1
21	4214B-021	Handle seat	1
22	4214B-022	Gear base	1
23	4214B-023	Gear shaft	1
24	4214B-024	Key A type 3x3x25	1
25	4214B-025	Nut M12	2
26	4214B-026	Coil spring assembly	1
27	4214B-027	Spring baffle	1
28	4214B-028	Busing	1
29	4214B-029	Speed digital display	1
30	4214B-030	Switch box	1
31	4214B-031	Screw M5x14	3
32	4214B-032	Switch	1
33	4214B-033	Lamp/Laser switch	2
34	4214B-034	Lock knob	2
35	4214B-035	Big washer	4
36	4214B-036	Fence	1
37	4214B-037	Baffle	1
38	4214B-038	Butterfly nut M6	1
39	4214B-039	Bolt M6x16	1
40	4214B-040	Screw M6x12	2
41	4214B-041	Flat washer	5
42	4214B-042	Work table	1
43	4214B-043	Wing nut M8	2

Item #	Stock #	Description	Qty
44	4214B-044	Guide rod	2
45	4214B-045	Roller screw	2
46	4214B-046	Roller support	1
47	4214B-047	Screw M6x12	2
48	4214B-048	Roller	1
49	4214B-049	Column clamp	2
50	4214B-050	Table arm	1
51	4214B-051	Bolt M12x35	1
52	4214B-052	Adjusting nut	4
53	4214B-053	Special washer	1
54	4214B-054	Scale	1
55	4214B-055	Bearing 6201RZ	1
56	4214B-056	Rubber washer	1
57	4214B-057	Quil	1
58	4214B-058	Nut M6	1
59	4214B-059	Scale collar	1
60	4214B-060	Screw M6x16	1
61	4214B-061	Nut M8	5
62	4214B-062	Bearing 6204RZ	1
63	4214B-063	Spindle	1
64	4214B-064	Chuck connection rod	1
65	4214B-065	Chuck	1
66	4214B-066	Screw M5x12	3
67	4214B-067	Cord plate	2
68	4214B-068	Rubber bush	3
69	4214B-069	Cord bush	1
70	4214B-070	Cord fixed plate	2
71	4214B-071	Screw M6x12	5
72	4214B-072	Screw M5x16	1
73	4214B-073	Pulley cover assembly	1
74	4214B-074	Sponge pad	4
75	4214B-075	Pin 6x15	2
76	4214B-076	Screw M8x8	5
77	4214B-077	Screw M5x10	5
78	4214B-078	Wrench clip	1
79	4214B-079	Screw M6x8	2
80	4214B-080	Pin	1
81	4214B-081	fastener set	2
84	4214B-084	Star washer 5	2
85	4214B-085	Quil set screw	1
86	4214B-086	Head	1
87	4214B-087	Lasser	2
88	4214B-088	Spring	1

EXPLODED VIEW & PARTS LIST

Item #	Stock #	Description	Qty
89	4214B-089	Rack shaft	1
90	4214B-090	Big washer 8	1
91	4214B-091	Bolt M8x12	4
92	4214B-092	Screw M3x10	1
93	4214B-093	Lamp socket bracket	1
94	4214B-094	Lamp socket	1
95	4214B-095	LED light	1
96	4214B-096	Screw M4x8	2
97	4214B-097	Indicator	1
98	4214B-098	Rack collar	1
99	4214B-099	Screw M6x10	3
100	4214B-100	Table support	1
101	4214B-101	Worm	1
102	4214B-102	Crank	1
103	4214B-103	Rack	1
104	4214B-104	Column	1
105	4214B-105	Inner gear	1
106	4214B-106	Inner gear shaft	1
107	4214B-107	Bolt M10x30	4
108	4214B-108	Column base	1
109	4214B-109	Base	1
110	4214B-110	Circlip	1
111	4214B-111	Motor fixed pulley	1
112	4214B-112	Motor moveable pulley	1

Item #	Stock #	Description	Qty
113	4214B-113	Spring	1
114	4214B-114	Spring base	1
115	4214B-115	Spring washer	1
116	4214B-116	Motor assembly	1
117	4214B-117	Key A type 4x4x80	1
118	4214B-118	Screw 8x16	4
119	4214B-119	Power cord	1
120	4214B-120	Spring washer 8	3
121	4214B-121	Motor plate	1
122	4214B-122	Handle	3
123	4214B-123	Handle hub	1
124	4214B-124	Elastic ring Type A 55	1
125	4214B-125	Circlip 35	1
126	4214B-126	Circlip 11	1
127	4214B-127	Nut M8	1
128	4214B-128	Spring washer 4	2
129	4214B-129	Handle bar	1
130	4214B-130	Spring	1
131	4214B-131	Sealing rubber strip	1
132	4214B-132	Hex wrench S3	1
133	4214B-133	Hex wrench S4	1
134	4214B-134	Chuck key	1
135	4214B-135	Wedge block	1
136	4214B-136	Wing nut	2

LIMITED TWO YEAR WARRANTY

WEN Products is committed to building tools that are dependable for years. Our warranties are consistent with this commitment and our dedication to quality.

LIMITED WARRANTY OF WEN CONSUMER POWER TOOLS PRODUCTS FOR HOME USE

GREAT LAKES TECHNOLOGIES, LLC (“Seller”) warrants to the original purchaser only, that all WEN consumer power tools will be free from defects in material or workmanship for a period of two (2) years from date of purchase. Ninety days for all WEN products, if the tool is used for professional use.

SELLER’S SOLE OBLIGATION AND YOUR EXCLUSIVE REMEDY under this Limited Warranty and, to the extent permitted by law, any warranty or condition implied by law, shall be the repair or replacement of parts, without charge, which are defective in material or workmanship and which have not been misused, carelessly handled, or misrepaired by persons other than Seller or Authorized Service Center. To make a claim under this Limited Warranty, you must return the complete power tool product; transportation prepaid, to Great Lakes Technologies, LLC – 1675 Holmes Road – Elgin, IL. 60123 with a copy of the original receipt which is legible and clearly defines Date of Purchase including month and year and Place of Purchase.

THIS LIMITED WARRANTY DOES NOT APPLY TO ACCESSORY ITEMS SUCH AS CIRCULAR SAW BLADES, DRILL BITS, ROUTER BITS, JIGSAW BLADES, SANDING BELTS, GRINDING WHEELS AND OTHER RELATED ITEMS.

ANY IMPLIED WARRANTIES SHALL BE LIMITED IN DURATION TO TWO (2) YEARS FROM DATE OF PURCHASE. SOME STATES IN THE U.S., SOME CANADIAN PROVINCES DO NOT ALLOW LIMITATIONS ON HOW LONG AN IMPLIED WARRANTY LASTS, SO THE ABOVE LIMITATION MAY NOT APPLY TO YOU.

IN NO EVENT SHALL SELLER BE LIABLE FOR ANY INCIDENTAL OR CONSEQUENTIAL DAMAGES (INCLUDING BUT NOT LIMITED TO LIABILITY FOR LOSS OF PROFITS) ARISING FROM THE SALE OR USE OF THIS PRODUCT. SOME STATES IN THE U.S. AND SOME CANADIAN PROVINCES DO NOT ALLOW THE EXCLUSION OR LIMITATION OF INCIDENTAL OR CONSEQUENTIAL DAMAGES, SO THE ABOVE LIMITATION OR EXCLUSION MAY NOT APPLY TO YOU.

THIS LIMITED WARRANTY GIVES YOU SPECIFIC LEGAL RIGHTS, AND YOU MAY ALSO HAVE OTHER RIGHTS WHICH VARY FROM STATE TO STATE IN THE U.S., PROVINCE TO PROVINCE IN CANADA AND FROM COUNTRY TO COUNTRY.

THIS LIMITED WARRANTY APPLIES ONLY TO PORTABLE ELECTRIC TOOLS, BENCH POWER TOOLS, OUTDOOR POWER EQUIPMENT AND PNEUMATIC TOOLS SOLD WITHIN THE UNITED STATES OF AMERICA, CANADA AND THE COMMONWEALTH OF PUERTO RICO. FOR WARRANTY COVERAGE WITHIN OTHER COUNTRIES, CONTACT THE WEN CUSTOMER SUPPORT LINE.