

### Rod Holder (Open End / Close End)

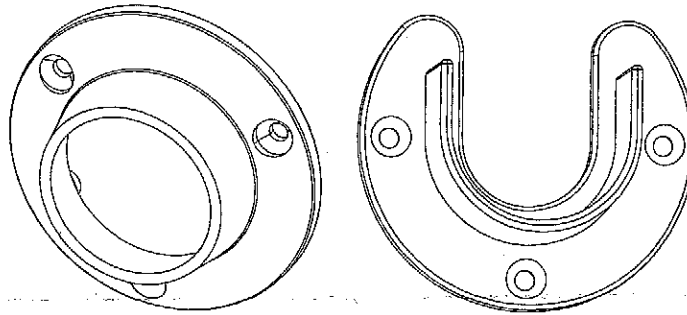

1. Locate ideal placement for each holder and mark the holes.
2. For drywall installs use a 1/4" drill bit, and for stud installs use a 3/32" bit to cut holes.
3. Ensure the closed holder is mounted with the 2 adjustment screws aligned at the rod's top at 10 o' clock and 2 o' clock. Gently hammer in anchors (if needed) and use the supplied screws to attach holders to the wall.
4. Insert the pole first into the closed holder, then into the open holder. Use the holder's adjustment screws to further secure the rods.

### Rod Holder (Close Ends)

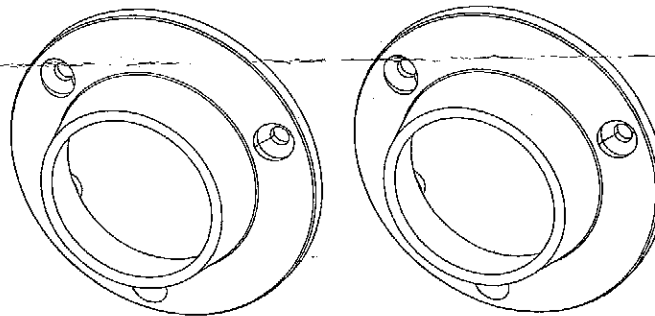

1. Locate ideal placement for each holder and mark the holes.
2. For drywall installs use a 1/4" drill bit, and for stud installs use a 3/32" bit to cut holes.
3. Ensure the holders are mounted symmetrically with the 2 adjustment screws aligned at the rod's top at 10 o' clock and 2 o' clock. Both side's holder should be mounted this way. Gently hammer in anchors (if needed) and use the supplied screws to attach holders to the wall.
4. Slide one end of the rod into a holder, and then expand the rod to fit into the opposite holder. Use the holder's adjustment screws to further secure the rods.