

FUELING YOUR HEATER

NOTE : See section 3, page 3 on **KEROSENE** for instructions on the proper grade of kerosene to use with this heater.

CAUTION : NEVER REMOVE THE CARTRIDGE TANK FROM THIS HEATER WHILE THE HEATER IS OPERATING OR WHILE THE HEATER IS STILL HOT. EXTINGUISH THE HEATER AND VERIFY THAT THE HEATER IS COOL TO THE TOUCH BEFORE REFUELING THE HEATER. NEVER REFILL THE CARTRIDGE FUEL TANK WHEN THE HEATER IS OPERATING OR STILL HOT.

NEVER FILL THE HEATER'S CARTRIDGE FUEL TANK IN THE LIVING SPACE; FILL THE CARTRIDGE FUEL TANK OUTDOORS.

Before fueling the heater, take the removable cartridge fuel tank, the kerosene, and the manual siphon pump outdoors. To use the manual siphon pump, tighten the cap on the top of the siphon, place the straight tube into the kerosene container, and insert the flexible tube into the opening of the cartridge tank (see Fig. 5A/5B). By squeezing the bulb of the siphon pump, fuel will be transferred from the kerosene container into the heater. Carefully watch the fuel gauge on the cartridge tank so that you will know when the tank is getting full. When you approach the full mark, loosen the cap on top of the siphon pump. This will stop the flow of kerosene. **DO NOT OVERFILL THE CARTRIDGE TANK.** Allow the siphon pump to drain thoroughly before you remove it from the cartridge tank and the kerosene container.

Make sure that you securely replace the fuel tank cap on the cartridge tank and on the kerosene container. Thoroughly clean up any spilled kerosene.

Insert the cartridge tank back into the kerosene heater with the fuel gauge facing toward the front of the heater. (If the cartridge tank is not inserted properly into the heater, the door on the cartridge tank will not close.)

NOTE: Refill the cartridge fuel tank before the tank is completely empty (see Fig. 6). **DO NOT** refill when the heater is operating or still hot.

IMPORTANT NOTICE REGARDING FIRST FUELING OF HEATER;

When first using your heater, make sure that you allow a **minimum of 60 minutes** (carefully check the time) after filling the tank before you attempt to light the heater. This allows time for the wick to become saturated.

IMPORTANT NOTICE REGARDING FIRST IGNITION OF HEATER;

The first time you light the heater, it should be done **outdoors**. This allows the oils, etc. used in manufacturing the heater to burn off outside, rather than in your home.

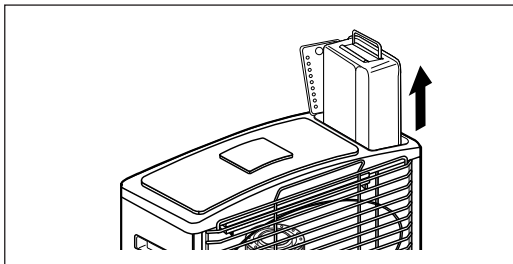

Fig. 5A

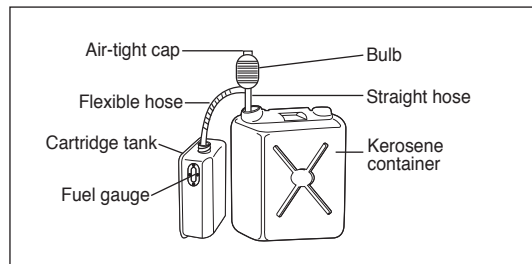
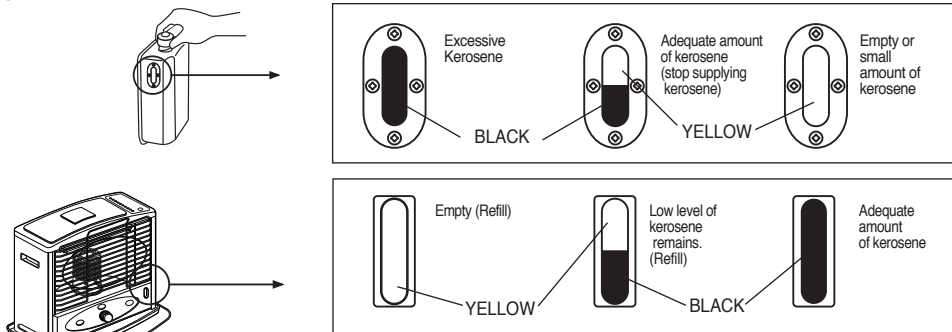

Fig. 5B

NOTE: Extinguish the kerosene heater and refill the tank before the fuel reaches the bottom of the cartridge tank. (Fig 6.)



AUTOMATIC IGNITION SYSTEM

For safety and convenience, this heater features an automatic ignition system.

2 “D” cell batteries, included with the heater, provide the power for the igniter which lights the wick once it has been raised to its maximum height.

When the heater is fueled for the first time, allow a **minimum of 60 minutes** after filling the heater for the wick to absorb kerosene before you attempt to light the heater. Also, the first time you light the heater, it should be done **outdoors** to allow the oils, etc, used in manufacturing the heater to burn off outside, rather than in your home.

To use the automatic ignition system:

- Make sure the batteries have been installed properly.
- Turn the wick adjuster knob clockwise until the wick has been raised to its maximum height.
- Push the ignition button to bring the glowing igniter into contact with the wick. This will cause ignition to occur.
- As soon as you see that the wick has been lit, release the ignition button. This will automatically lower the burn chamber back down over the wick.
- Rotate the burner knob from side to side a few times to make sure that the burner is positioned properly on the wick adjuster.
- Then begin following the steps outlined in "Adjusting the wick" (page 7)

IGNITION VIA MATCH

If you encounter a problem with the ignition mechanism, or if you have dead batteries, it is possible to light the heater with a match (Fig. 7).

The procedure is as follows:

- Turn the wick adjuster knob clockwise until the wick has been raised to its maximum height.
- Lift the burn chamber by using the burner knob.
- Touch a lighted match to the exposed top edge of the wick.
- Once you see that the wick has been lit, lower the burn chamber back down over the wick.
- Rotate the burner knob from side to side a few times to make sure that the burner is positioned properly on the wick adjuster.
- Then begin following the steps outlined in "Adjusting the wick" (page 7)

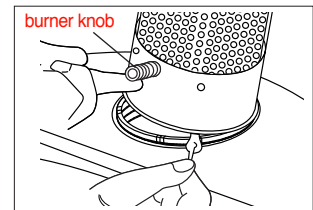

Fig. 7

CAUTION : Make sure that you do not leave the match, or any portion of it (match head, etc.) in the burner area. Debris left from the match can cause an uneven alignment of the burner and may result in smoke, incomplete combustion, odor, or fire.

NOTE : Once you have extinguished the heater, wait at least 10 minutes before reigniting the wick. Failure to do this will result in a very strong odor and / or smoke being produced.

NOTE : Do not use excessive force when pushing the ignition button. This can cause the igniter to catch the wick and may prevent ignition from occurring. Pushing too lightly on the Ignition button can prevent ignition from occurring by keeping the igniter too far **from** the wick. As Fig. 10 (Page 9) shows, the optimal distance between the igniter and the wick is 1/64- 1/32 inch (0.5 to 1mm). If it is difficult to ignite the heater, the filament on the igniter might be bent, broken or misshaped.



WICK REPLACEMENT

Wick replacement should be performed on a completely cool heater after the cartridge tank has been removed and the remainder of the kerosene in the heater has been burned off.

Use only genuine replacement wick.

Replacement wick number : Glowick 200-B, Kero-World 20401U, Dura Heat DH-200, Pick-A-Wick-PW27.

Call customer service at 814-643-1775, to order a wick.

Visit our website at www.worldmkting.com for a link to detailed wick replacing directions.

Open the tank cover and remove the cartridge tank. Remove the batteries to prevent possible burns. Open the front grille and remove the chimney. Remove the wick adjusting knob by pulling straight out.

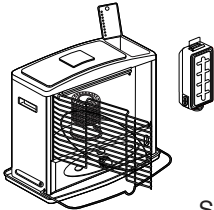

Step 1

Unscrew 5 screws, two from the back and one from the right side and two from the left side of the cabinet.

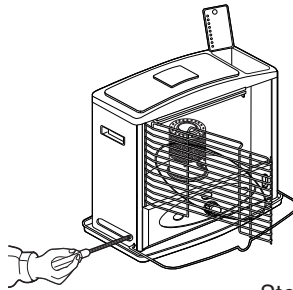

Step 2

Remove the cabinet. By pulling it straight up.

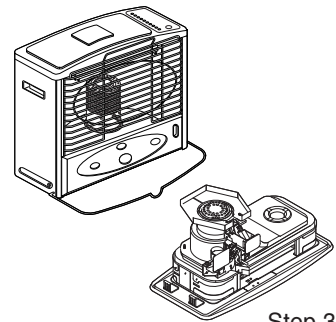

Step 3

Remove the screw on the wind cover.

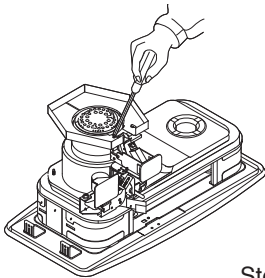

Step 4

Remove the wind cover.

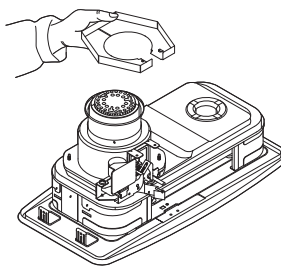

Step 5

Remove the automatic ignition Assembly by unscrewing 2 screws.

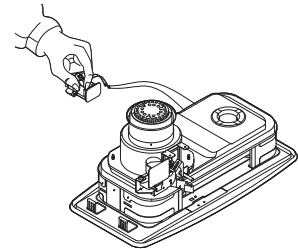

Step 6

Unscrew 4 wing nuts.

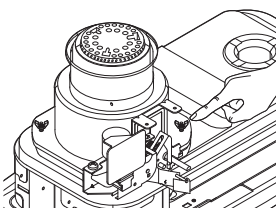

Step 7

Remove the wick adjuster assembly.

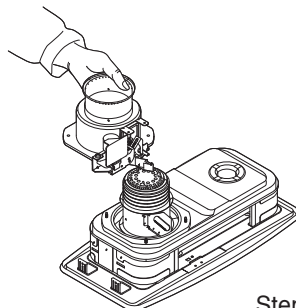

Step 8

Remove the wick from the holder by folding it toward the center loosening it from the sharp metal teeth on the inner surface of the holder, and slide it out.

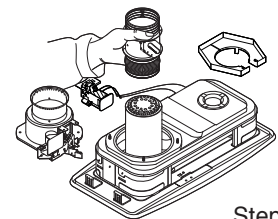

Step 9

Replacement wick has a black line. Fold the new wick and slide it into the holder.

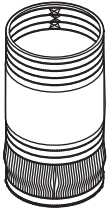

Step 10

The black line on the outside of the wick should match the top edge of the holder. Then press it against the teeth inside the holder to obtain a firm grip.

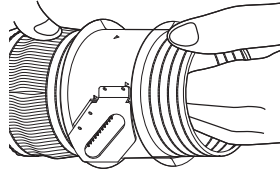

Step 11

Replace the wick and holder in the burner tank. Rotate 90 degrees left and right as well as up and down until the wick slides freely. Check to see that gasket is still in place on the burner tank.

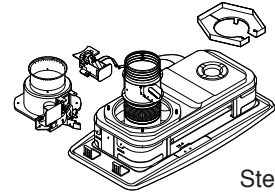

Step 12

It is recommended to reinstall the wick adjusting knob for easier assembling.

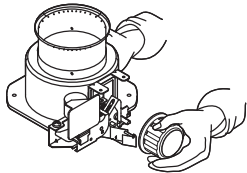

Step 13

Insert the pinion at the other end of the wick control shaft into top portion of the rack of the wick holder. This step can be easily carried out if the wick holder is raised.

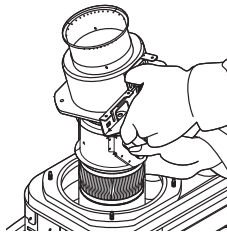

Step 14

Slide the wick **adjuster** assembly down the draft tube. Position the adjuster shaft to the front of the heater.

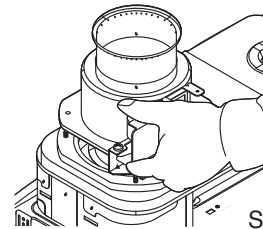

Step 15

Snug 4 wing nuts on the mounting stud, but do not tighten.

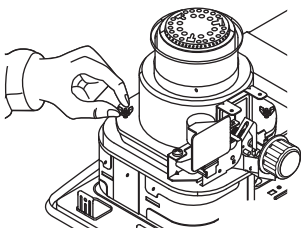

Step 16

Raise the wick to the full "up" position, and evenly tighten wing nuts in several steps.

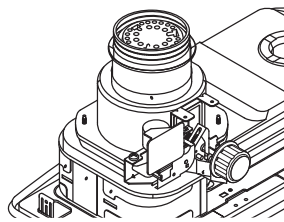

Step 17

Check height of wick. It should be 5/16" above collar.

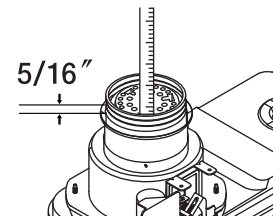

Step 18

Check for correct clearance between wick holder and draft tube. It should be the same all around.

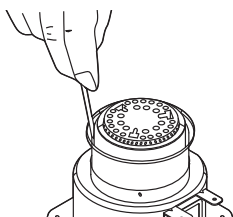

Step 19

Check the function of safety shut-off mechanism by pushing the extinguish button to upset the pendulum.

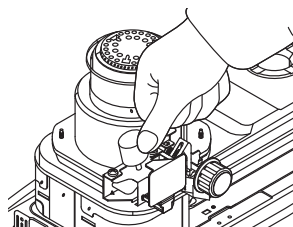

Step 20

Reinstall the automatic ignition assembly.

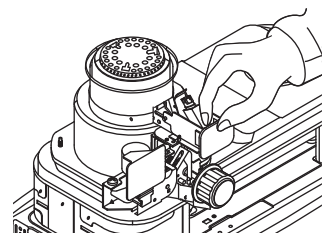

Step 21

Reinstall the wind cover.

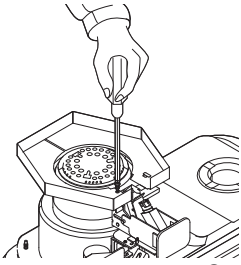

Step 22

Remove the wick adjusting knob once again, if it was reinstalled before.

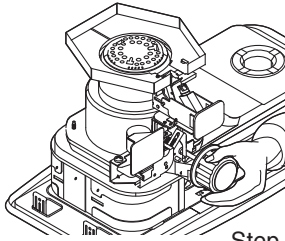

Step 23

Reinstall the cabinet.

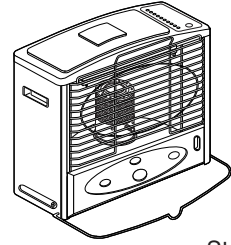

Step 24

Tighten 5 screws on the cabinet

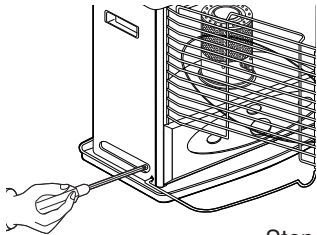

Step 25

Reinstall the chimney and the cartridge tank.

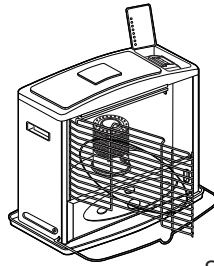

Step 26

Reinstall the wick adjusting knob. Close the front grille.

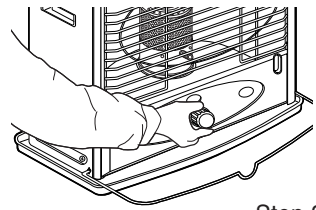

Step 27

Install the batteries in the battery case, and fill the Cartridge tank with clean, pure kerosene. Set the tank into the heater and wait at least 60 minutes for the new wick to fully saturate with kerosene.



REEMPLAZO DE LA MECHA

El reemplazo de la mecha debe ser hecho sólo en un calentador que este completamente frío después de haber sacado el cartucho de tanque, y después que el querosén restante en el calentador ha sido quemado.

Use sólo una mecha de reemplazo auténtica.

Mecha de reemplazo número: Kero-World 20401U, DuraHeat DH-200, Pick-A-Wick PW27.

Llame a servicio al cliente al 814-643-1775, para pedir una mecha.

Visite nuestro sitio web en www.worldmktng.com para un enlace a mecha detallada reemplazando las direcciones.

Abra la cubierta del tanque y saque el cartucho de tanque. Saque las baterías para prevenir la posibilidad de quemaduras. Abra la verja delantera y saque la chimenea. Saque la agarradura de ajustador de mecha alándola directamente hacía afuera.

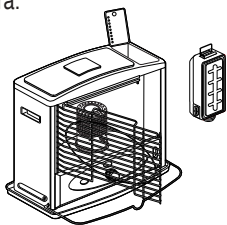

Paso 1

Destornille 3 tornillos, uno de la parte trasera y uno de cada uno de los lados del gabinete.

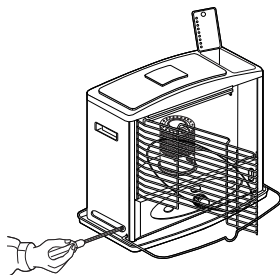

Paso 2

Saque el gabinete.

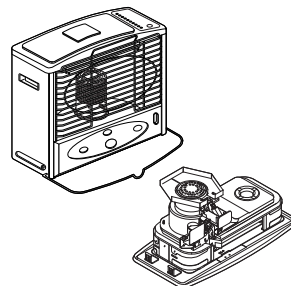

Paso 3

Destornille el tornillo en la cubierta de aire.

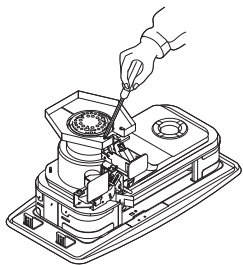

Paso 4

Saque la cubierta de aire.

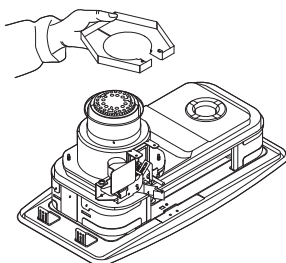

Paso 5

Saque el montaje de ignición automática destornillando 2 tornillos.

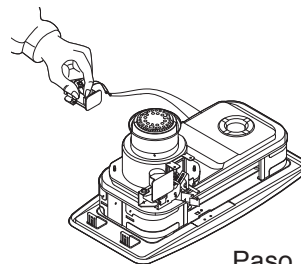

Paso 6

Destornille 4 tuercas de ala.

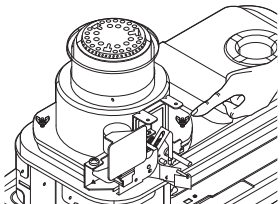

Paso 7

Saque el montaje del ajustador de mecha.

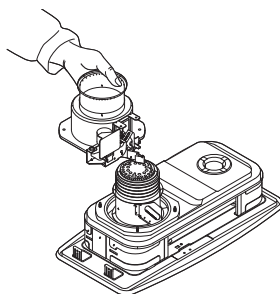

Paso 8

Saque la mecha del receptáculo doblandola. Tiene que soltarla del diente de metal agudo en la superficie dentro del receptáculo, y alarla hacia afuera.

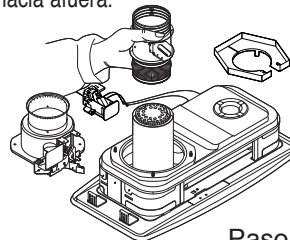

Paso 9

La mecha de recambio tiene una línea negra. Doble la mecha nueva y métala en el receptáculo.

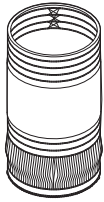

Paso 10

La línea negra en la parte de afuera de la mecha debe encontrar el borde superior del receptáculo. Entonces, apriétela contra el diente dentro del receptáculo para obtener un agarre firme.

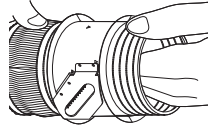

Paso 11

Reemplazo la mecha y el receptáculo en el tanque del quemador. Gire 90 grados hacia la izquierda, la derecha, y hacia arriba, y abajo hasta que la mecha entre fácilmente. Verifique que la junta se haya mantenido en el mismo lugar en el tanque del quemador.

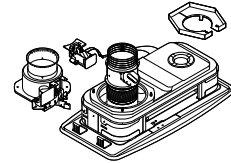

Paso 12

Se recomienda que se reinstale la agarradura de ajustador de mecha para montar mas fácilmente.

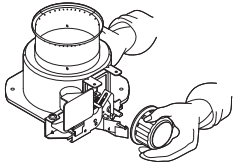

Paso 13

Meta el piñon en la otra esquina de control de mecha dentro de la parte de encima del estante del receptáculo de mecha. Este paso se puede llevar a cabo mas fácilmente si el receptáculo de mecha se levanta.

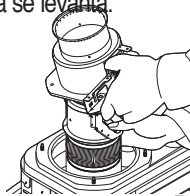

Paso 14

Deslice el montaje de ajustador de mecha hacia abajo en el tubo de corriente de aire. Ponga el mango del ajustador frente al calentador.

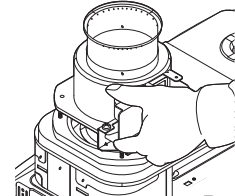

Paso 15

Acomode 4 tuercas de ala en el poste de montaje, pero no las apriete.

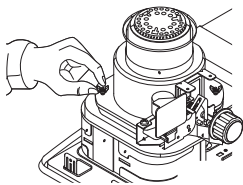

Paso 16

Levante la mecha en la posición mas "alta", y apriete uniformemente las tuercas de ala en varios pasos.

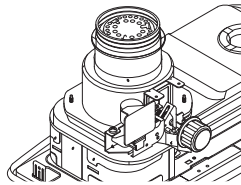

Paso 17

Verifique la altura de la mecha.

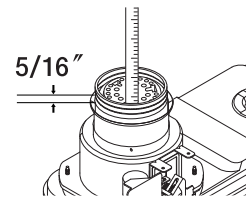

Paso 18

Verifique que haya una separación clara entre el receptáculo de mecha y el tubo de corriente de aire (completamente alrededor)

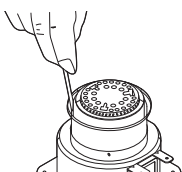

Paso 19

Verifique el funcionamiento del interruptor automático de seguridad, apretando el botón de apague inclinar el péndulo.

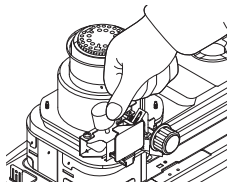

Paso 20

Vuelva a instalar el montaje de ignición automática.

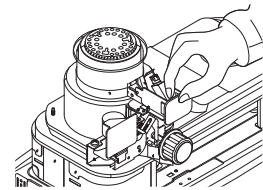

Paso 21

Vuelva a montar la cubierta de aire.

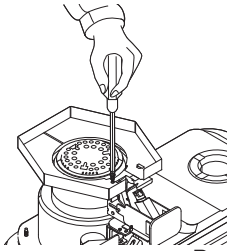

Paso 22

Quite la agarradura del ajustador de mecha nuevamente, si la había vuelto a instalar anteriormente.

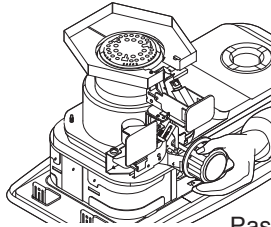

Paso 23

Vuelva a instalar el gabinete.

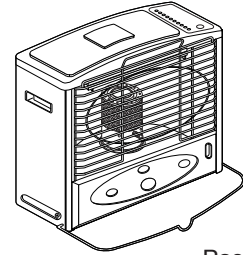

Paso 24

Apriete 3 tornillos en el gabinete.

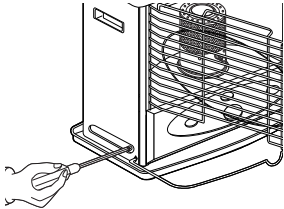

Paso 25

Vuelva a instalar la chimenea y el cartucho del tanque.

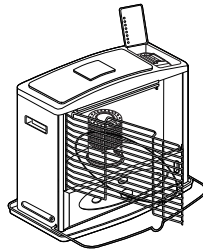

Paso 26

Vuelva a instalar la agarradura del ajustador de mecha. Cierre la verja delantera.

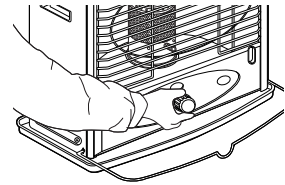

Paso 27

Instale el alojamiento de la pila, Llene el depósito del cartucho con keroseno limpio. Ponga el depósito en la calefacción y espere aproximadamente 60 minutos antes de que la nueva mecha esté saturada con keroseno.