



Find your niche



VERSATILE AND MODERN



ASSEMBLY INSTRUCTIONS

PEDESTAL NPBF19/NPFF1527

BEFORE YOU ASSEMBLE:

- Place all parts on a clean, smooth surface to avoid scratching the parts
- Check to be sure you have all parts and hardware
- Remove all wrapping materials, including any staples & packing straps
- Keep all hardware, small parts and packaging out of reach of children

Note: Drawers and Pedestal assemble separately. Separate Drawer pieces from Pedestal pieces before starting.

featuring



IN THE BOX:

A: Pedestal Back



B: Pedestal Sides (2)



C: Pedestal Bottom



D: Pedestal Top

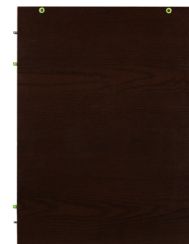

E: Box Drawer (or 2nd File Drawer for NPFF1527) Front



F: Box Drawer (or 2nd File Drawer for NPFF1527) Back



G: File Drawer Front



H: Drawer Bottom (2)



I: Box Drawer (or 2nd File Drawer for NPFF1527) Sides(2)



J: File Drawer Back



K: File Drawer Sides (2)

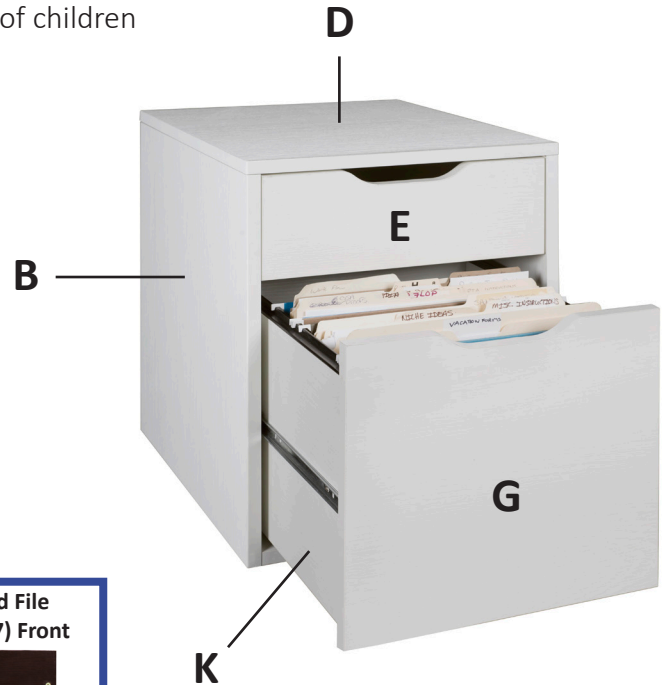



Find your niche



VERSATILE AND MODERN



ASSEMBLY INSTRUCTIONS

PEDESTAL NPBFF19/NPFF1527

STEP 1 BOX DRAWER ASSEMBLY (SKIP FOR NPFF1527)

STEP 2

Snap both **Box Drawer Sides (I)** onto the **Box Drawer Front (E)** by lining up lockdowels and pins with their coordinating holes and pressing into place (See *figure 1*.) Make sure drawer glides are on outside and facing front.

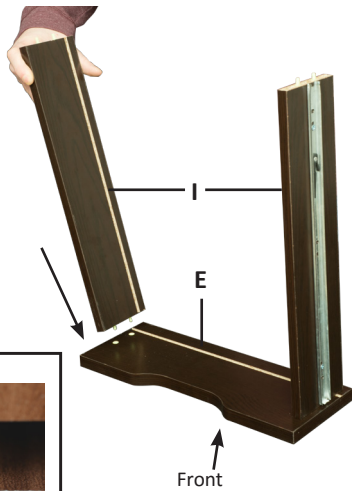

STEP 2A: Insert **Drawer Bottom (H)** into assembled box drawer by lining up with slots and sliding into place.

STEP 2B: Attach **Box Drawer Back (F)** to the **Box Drawer Sides (I)** by lining up lockdowels with their coordinating hole and pressing into place.

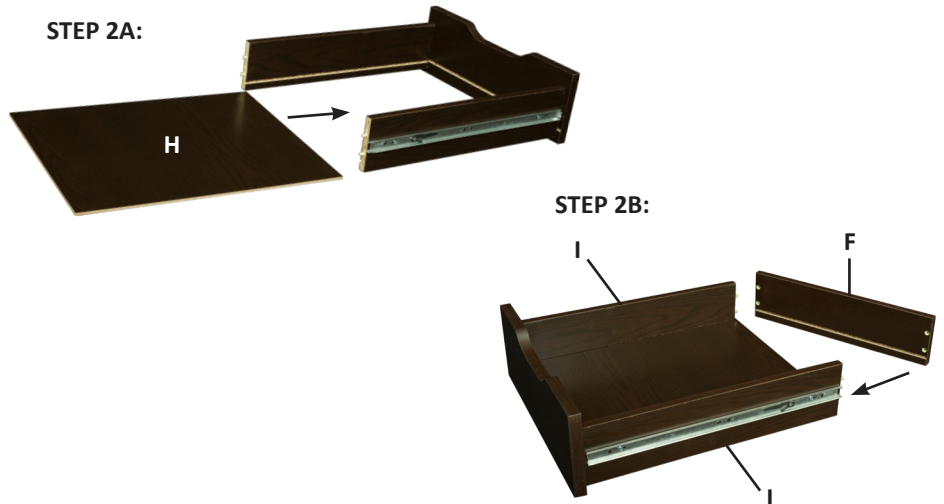

STEP 3 FILE DRAWER ASSEMBLY (REPEAT FOR NPFF1527)

STEP 4

Place components upright. Snap **File Drawer Sides (K)** onto **File Drawer Front (G)**. Line up E-clips with coordinating holes, and press forward into place (See *figure 2*.) Make sure drawer glides are on the outside and facing front.

Repeat this step for the remaining **File Drawer Side (K)**.



Step 4A: Insert **Drawer Bottom (H)** into assembled box drawer by lining up with slots and sliding into place.

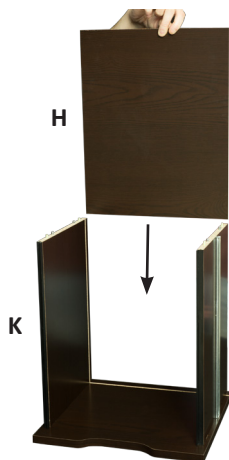

STEP 4B: Attach **File Drawer Back (J)** to the **File Drawer Sides (K)** by lining up lockdowels with their coordinating hole and pressing into place.

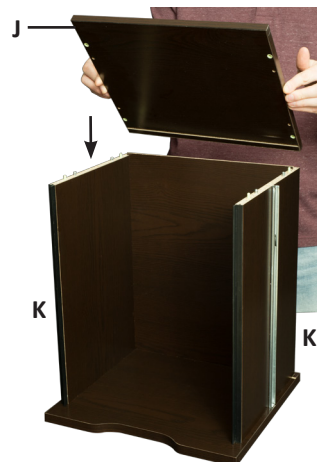



Find your niche



VERSATILE AND MODERN



ASSEMBLY INSTRUCTIONS

PEDESTAL NPBF19/NPFF1527

STEP 5 PEDESTAL ASSEMBLY

STEP 6

Snap **Pedestal Back (A)** to **Pedestal Bottom (C)**. Line up pins with coordinating holes and press down into place.

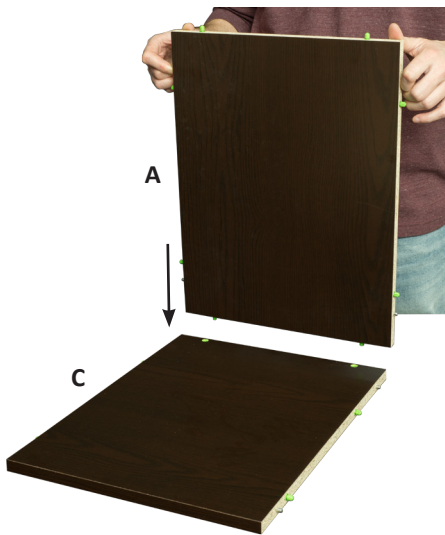

Attach both **Pedestal Sides (B)** to **Pedestal Back (A)** and **Pedestal Bottom (C)** by lining up pins with coordinating holes and pressing into place.

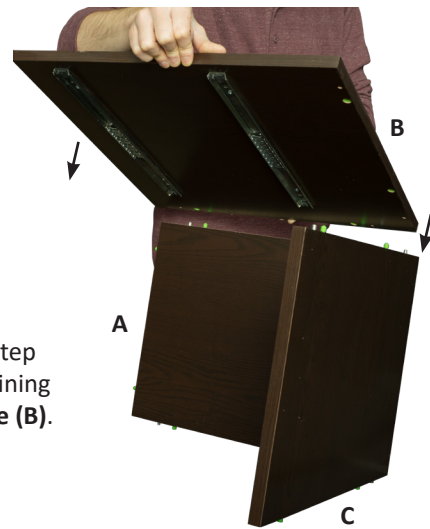

Repeat this step for the remaining **Pedestal Side (B)**.

STEP 7

STEP 8

Snap **Pedestal Top (D)** to assembled pedestal, by lining up holes with coordinating pins and pressing into place.



Insert both drawers into pedestal base by lining up bracket glides and sliding into place.



File Drawer