



The store where you made your purchase does not stock parts for this item. If you have assembly questions or you are missing or have damaged parts, please call

**1-800-856-4445**

or visit [www.backyarddiscovery.com](http://www.backyarddiscovery.com)

**Please have the following information ready when you make your call:**

- Model Number of the product located on the front of the assembly manual
  - Description of the part from the parts list
- 
- Read entire assembly manual, paying special attention to the important tips and safety information.
  - Ensure there are no missing pieces by first separating and identifying all parts.
  - Make sure to check packing material for small parts that may have fallen out during shipment.
  - Structures are not intended for public use. The Company does not warranty any of its residential structures subjected to commercial use.
  - This manual contains helpful information concerning assembly preparation, installation procedure and required maintenance.
  - Always keep safety in mind as your structure is being built.
  - Keep these instructions for future reference.



**Please read entire booklet completely before beginning the assembly process**

**Please retain these instructions and your receipt for future reference. Keep them in a safe place where you can refer to them as needed. In order to provide you with the most efficient service, it is required that you provide us with the part numbers when ordering parts.**

### For Your Records:

Please take time and fill out the information below. This information will be needed for warranty issues.

Where Purchased: \_\_\_\_\_  
 Date of Purchase: \_\_\_\_\_  
 Installation Date: \_\_\_\_\_  
 Installed by: \_\_\_\_\_  
 Tracking Number: \_\_\_\_\_

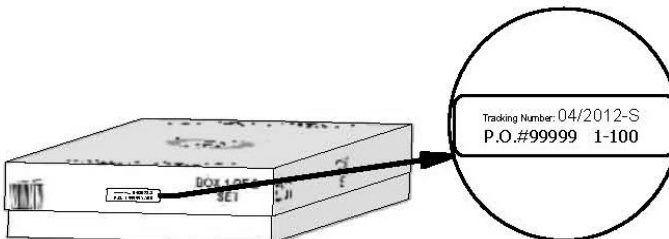

### Tracking Number Reference Label

Tracking ID number on the carton and on the bottom of the vertical ID plate are included for tracking purposes associated with warranty claims.

This Limited Warranty by Backyard Discovery applies to products manufactured under the Backyard Discovery brand or its other brands including but not limited to Backyard Botanical, Adventure Playsets, and Leisure Time Products.

Backyard Discovery warrants that this product is free from defect in materials and workmanship for a period of one (1) year from the original date of purchase. This one (1) year warranty covers all parts including wood, hardware, and accessories. All wood carries a five (5) year pro-rated warranty against rot and decay. Refer to the schedule below for charges associated with replacement of parts under this Limited Warranty. In addition, Backyard Discovery will replace any parts within the first 30 days from date of purchase found to be missing from or damaged in the original packaging.

This warranty applies to the original owner and registrant and is non-transferable. Regular maintenance is required to assure maximum life and performance of this product. Failure by the owner to maintain the product according to the maintenance requirements may void this warranty. Maintenance guidelines are provided in the Owner's Manual.

This Limited Warranty does not cover:

- Labor for any inspection
- Labor for replacement of any defective item(s)
- Incidental or consequential damages
- Cosmetic defects which do not affect performance or integrity of a part or the entire product
- Vandalism, improper use, failure due to loading or use beyond the capacities stated in the applicable Assembly Manual.
- Acts of nature including but not limited to wind, storms, hail, floods, excessive water exposure
- Improper installation including but not limited to installation on uneven, unlevel, or soft ground
- Minor twisting, warping, checking, or any other natural occurring properties of wood that do not affect performance or integrity

Backyard Discovery products have been designed for safety and quality. Any modifications made to the original product could damage the structural integrity of the unit leading to failure and possible injury. Modification voids any and all warranties and Backyard Discovery assumes no liability for any modified products or consequences resulting from failure of a modified product.

This product is warranted for RESIDENTIAL USE ONLY. Under no circumstance should a Backyard Discovery product be used in public settings. Such use may lead to product failure and potential injury. Any and all public use will void this warranty. Backyard Discovery disclaims all other representations and warranties of any kind, express or implied.

### **Pro Rated Part Replacement Schedule**

<b><u>Product Age</u></b>	<b><u>Customer Pays</u></b>
<b>All Parts</b>	
0-30 days from date of purchase	\$0 and free shipping
31 days to 1 year	\$0 + S&H
<b>Wood Rot and Decay Only</b>	
1 year	\$0 and free shipping
2 year	20% + S&H
3 year	40% + S&H
4 year	60% + S&H
5 year	80% + S&H
Over 5 years	100% + S&H



### ASSEMBLY TIP:

Keep an eye out for these boxes which will contain helpful pictures and information making the assembly process as quick and painless as possible.

## Sorting Wood

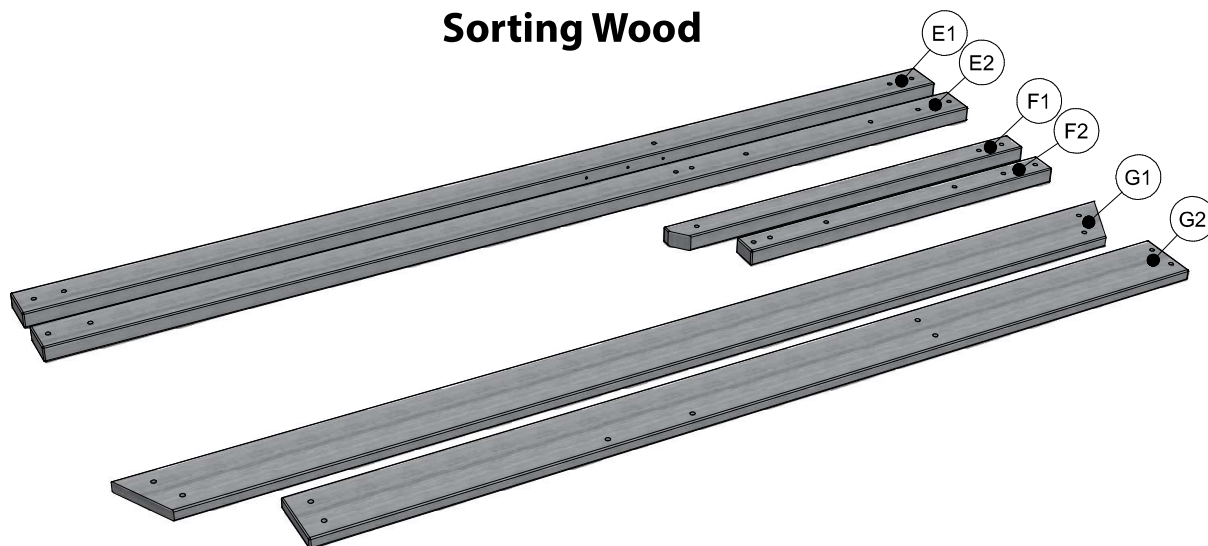

When removing the wood from the boxes we recommend arranging them by part number before you begin assembly. This will allow for faster assembly and easily identify any parts that may be missing or damaged.

## Sorting Hardware

**NUT BARREL**  
H100545

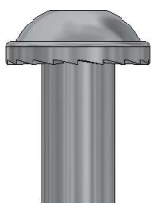

**SCREW**  
H100695



**T-NUT**  
H100699



**WASHER FLAT**  
H100706

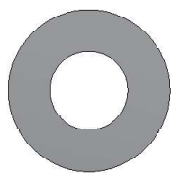

**BOLT HEX**  
H100716



**BOLT**  
H100718



**SCREW PWH**  
H100742

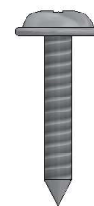

To help with assembly we recommend sorting your hardware bags with the seven digit alpha-numeric number printed on the bags or by hardware type (i.e. bolts, nuts, etc.). Organizing your hardware will make assembly easier.

## Hardware Identification

Hardware bags are printed with a seven digit alpha-numeric part number. During assembly you only need to reference the last three digits of the part number as noted in each step. This will make finding the correct hardware easier.

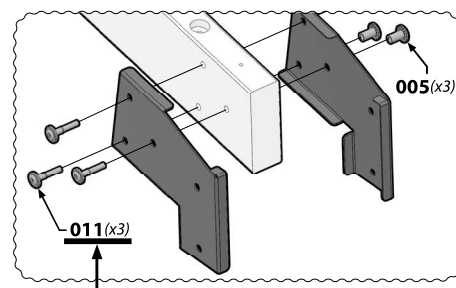
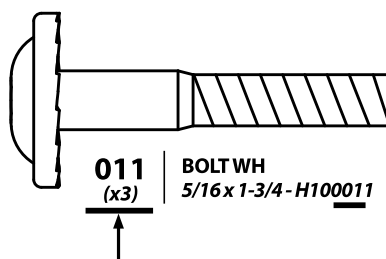

**Important Note:**

In the event the INK STAMP identifier is not easy to read or is missing from a wood component, match the unique geometric shape and dimensions of the wood component found in a specific assembly step to the PARTS IDENTIFICATION section when required. This will aid in identifying the part for assembly and (or) customer service issues.

**Parts Identification**  
**Wood Components**  
**(NOT TO SCALE)**



(10) **D1 - JOIST - W4L11729**  
1 3/8"x5 1/4"x114" (36x134x2895)



(2) **D2 - JOIST - W4L11724**  
1 3/8"x5 1/4"x87 3/4" (36x134x2228)



(4) **D3 - JOIST - W4L11723**  
1 3/8"x5 1/4"x27 1/2" (36x134x700)



(2) **D4 - JOIST - W4L11722**  
1 3/8"x5 1/4"x96" (36x134x2438)



(4) **D5 - SHORT ANGLE BRACE - W4L11727**  
1 7/16"x5 1/4"x33 5/8" (36x134x854)



(4) **D6 - LONG ANGLE BRACE - W4L11726**  
1 3/8"x5 1/4"x36 3/4" (36x134x933)

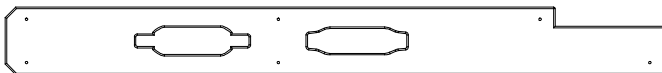

(1) **D7 - CORD COVER - W4L12268**  
1"x5 1/4"x51 5/8" (24x134x1310)



(2) **F3 - TABLE BRACE - W4L12249**  
1 3/8"x2 3/8"x12 13/16" (36x60x325)



(4) **F1 - SPACER - W4L11730**  
1 3/8"x2"x5 1/2" (36x50x140)

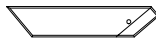

(1) **F2 - TABLE BRACE - W4L12246**  
1 3/8"x2 3/8"x11 7/8" (36x60x303)



(1) **F4 - TABLE BRACE - W4L12325**  
1 3/8"x2 3/8"x11 7/8" (36x60x303)



(3) **G1 - TABLE BRACE - W4L12247**  
1"x5 1/4"x16 5/8" (24x134x423)

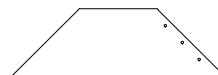

(3) **G2 - TABLE BRACE - W4L12248**  
1"x5 1/4"x16 5/8" (24x134x423)



(4) **Z1 - JOIST - W4L11725**  
1 3/8"x6 1/4"x96 1/8" (36x157x2443)

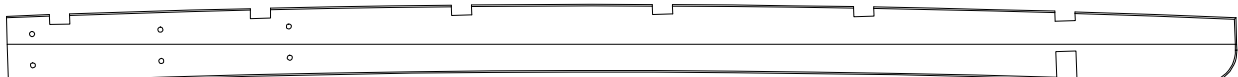

(6) **Z2 - JOIST - W4L11728**  
1 3/8"x6 1/4"x96 1/8" (36x157x2443)

**Important Note:**

In the event the INK STAMP identifier is not easy to read or is missing from a wood component, match the unique geometric shape and dimensions of the wood component found in a specific assembly step to the PARTS IDENTIFICATION section when required. This will aid in identifying the part for assembly and (or) customer service issues.

---

## **Parts Identification**

### *Wood Components*

(NOT TO SCALE)

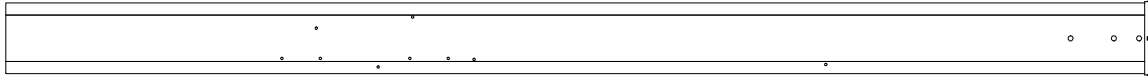

(1) **PT1 - PERGOLA POST - W2A02730**  
5 1/2"x5 1/2"x89 9/16"(140x140x2275)

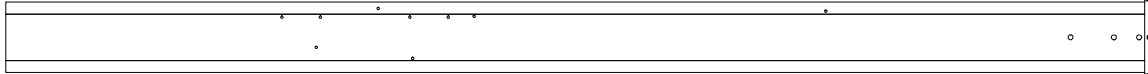

(1) **PT2 - PERGOLA POST - W2A02561**  
5 1/2"x5 1/2"x89 9/16"(140x140x2275)

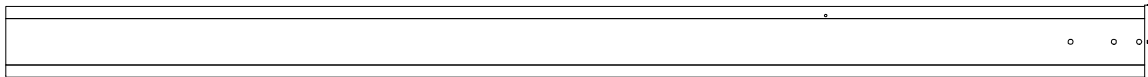

(1) **PT3 - PERGOLA POST - W2A02731**  
5 1/2"x5 1/2"x89 9/16"(140x140x2275)

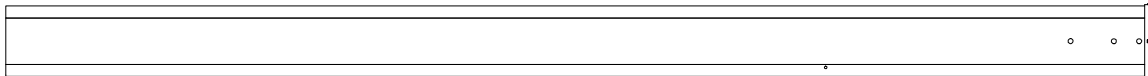

(1) **PT4 - PERGOLA POST - W2A02562**  
5 1/2"x5 1/2"x89 9/16"(140x140x2275)

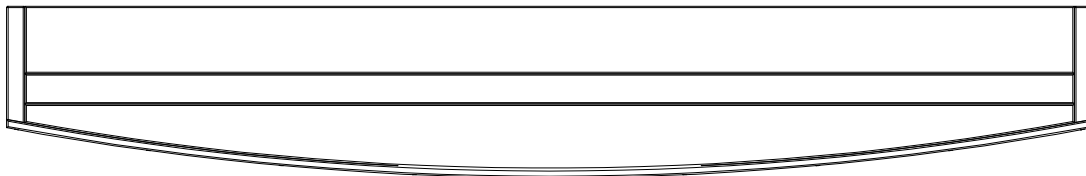

(1) **TT1 - INSIDE TABLE TOP ASSEMBLY - W2A02564**  
2 3/8"x13 3/8"x84 7/8" (60x340x2156)

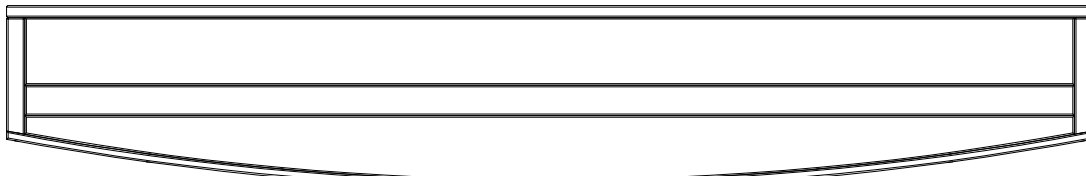

(1) **TT2 - OUTER TABLE TOP ASSEMBLY - W2A02563**  
2 3/8"x14 5/16"x84 7/8" (60x364x2156)

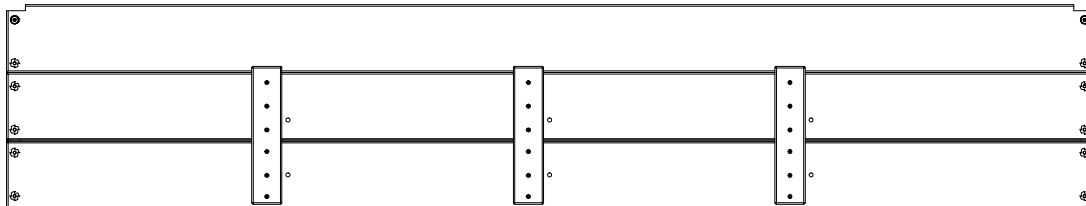

(1) **WP1 - WALL PANEL - W2A02565**  
2 1/2"x15 15/16"x84 7/8" (65x405x2156)

**Important Note:**

Backyard Discovery recommends taking all the hardware out of the box and arranging them by type before you begin assembly. This will allow for faster assembly and easy identification of any hardware that may be missing or damaged so they can be replaced before assembly.

# Parts Identification

## Hardware



(17) - CONCRETE ANCHOR 1/4"x2" - H100120

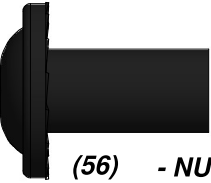

(56) - NUT BARREL WH 5/16x7/8 BLK - H100192

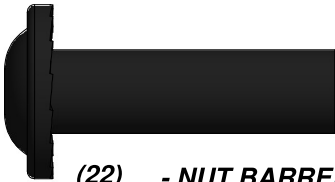

(22) - NUT BARREL WH 5/16x1-1/2 BLK - H100193



(9) - SCREW PFH 8X2-1/2 BLK - H100201



(46) - SCREW PFH 8X1-1/2 BLK - H100200



(44) - SCREW PWH 8x1-1/4 BLK - H100536



(9) - SCREW PWH 8x3/4 BLK - H100392

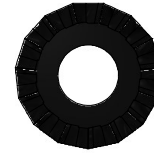

(136) - WASHER LOCK EXT 8x19 BLK - H100198

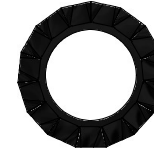

(78) - WASHER LOCK EXT 12x19 BLK - H100199

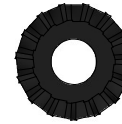

(19) - WASHER LOCK EXT 6x15 BLK - H100405



(7) - T-NUT 1/4 BLK - H100398



(7) - BOLT WH 1/4x2-1/4 BLK - H100567



(9) - BOLT WH 5/16x7-1/4 BLK - H100196

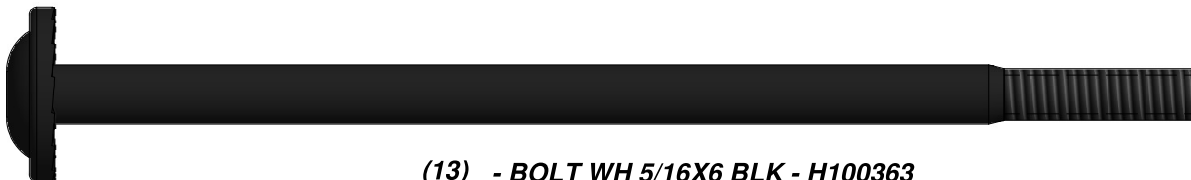

(13) - BOLT WH 5/16X6 BLK - H100363

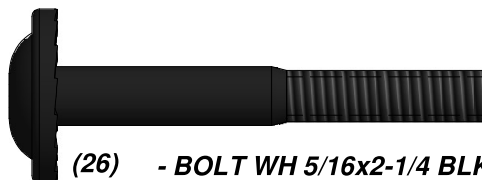

(26) - BOLT WH 5/16x2-1/4 BLK - H100205

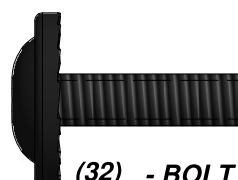

(32) - BOLT WH 5/16x1 BLK - H100468

**Important Note:**

Backyard Discovery recommends taking all the hardware out of the box and arranging them by type before you begin assembly. This will allow for faster assembly and easy identification of any hardware that may be missing or damaged so they can be replaced before assembly.

**Parts Identification**  
*Hardware*

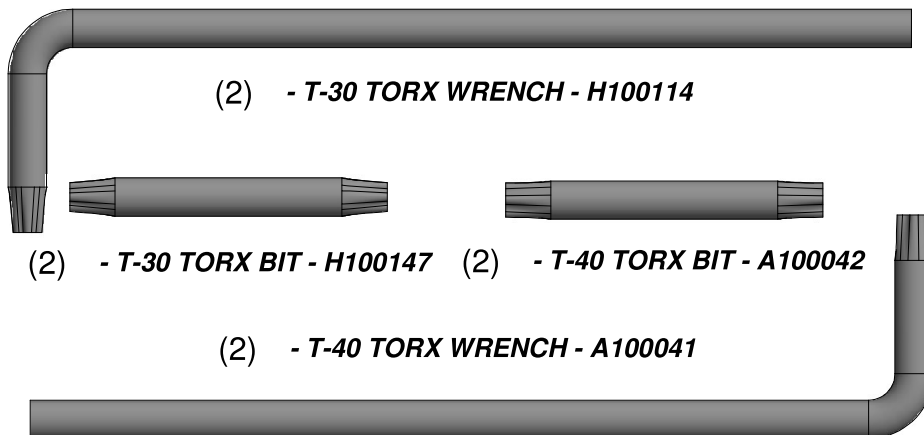
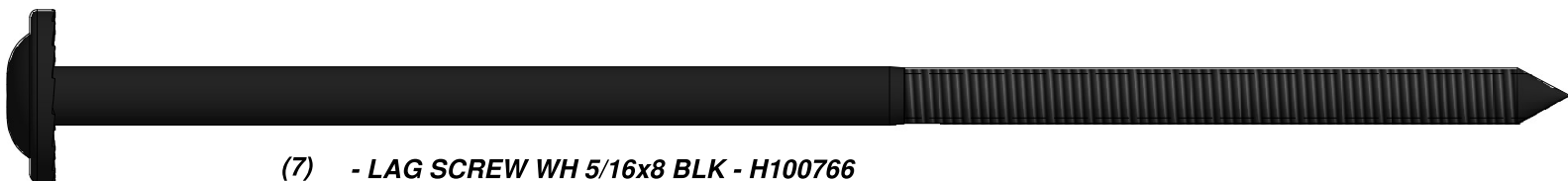

# Parts Identification

Accessories  
(NOT TO SCALE)

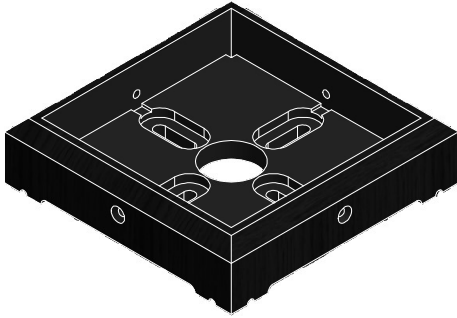

(4) HT - FOOT 142 SQUARE POST - A100029



(1) - BYD ID TAG (SMALL) WITHOUT AGES - A100241

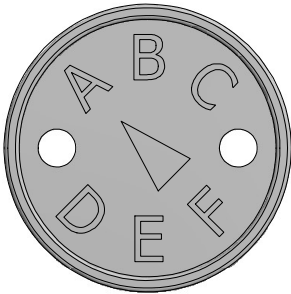

(1) - "A" REVISION TAG - A100314



(1) STAIN MARKER - BW-2UV - A6P00173



(1) PERGOLA ELECTRICAL KIT - A6P00265

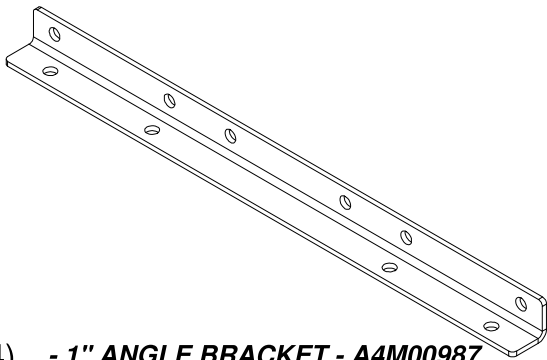

(4) - 1" ANGLE BRACKET - A4M00987

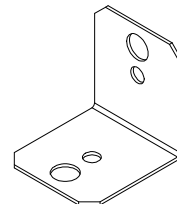

(2) - 90° L-BRACKET - BLK - A4M00555