

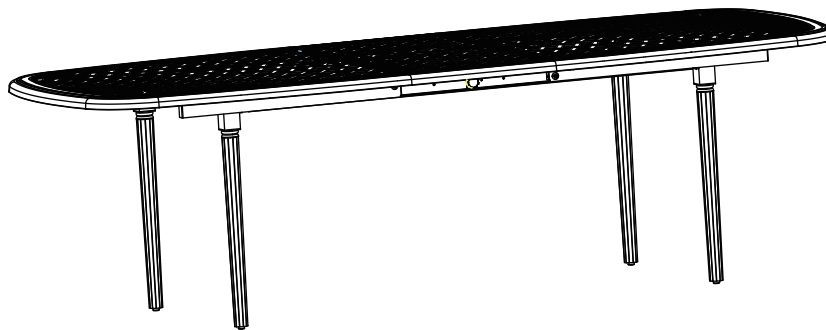

Item #000-000
Model #131-012-9642-EXT

USE AND CARE GUIDE

EDINGTON 96"X42" CAST EXTENSION DINING TABLE



Questions, problems, missing parts? Before returning to the store,
call Hampton Bay Customer Service
8.00 a.m. - 6.00 p.m., EST, Monday - Friday

1-877-527-0313

HOMEDEPOT.COM





THANK YOU

We appreciate the trust and confidence you have placed in Hampton Bay through the purchase of this cast extension table. We strive to continually create quality products designed to enhance your home. Visit us online to see our full line of products available for your home improvement needs. Thank you for choosing Hampton Bay!

Table of Contents

Table of Contents.....	2	Pre-installation.....	3
Safety Information.....	2	Planning Installation	3
Warranty.....	2	Tools required	3
5 Year Frame Limited Warranty, 1 Year Finish		Hardware Included.....	3
Limited Warranty	2	Package Contents	4
What Is Covered .. .	2	Assembly	5
What Is Not Covered	2	Operation	6

Safety Information

-  **DANGER:** Please keep children out of the assembly area during assembly.
-  **WARNING:** Do not put heavy objects on the table.
-  **CAUTION:** Use the table on flat ground only.
-  **IMPORTANT:** Please check the tightness of bolts at least every 90 days .
-  **NOTE:** Level the table with glides at the bottom of table legs.

Warranty

5 YEAR FRAME LIMITED WARRANTY/ 1 YEAR FINISH LIMITED WARRANTY

WHAT IS COVERED

We warrant the frame to be free of manufacturing defects to the original purchaser for five years. Finish is warranted against peeling, cracking, or blistering for a period of one year.

WHAT IS NOT COVERED

It remains the customer's responsibility for freight and packaging charges to and from our service center. This warranty does not cover commercial use, acts of nature, fire, freezing, and abusive use. Discoloration or fading of the finish or fabrics is not covered. Correction or rusting of hardware are not covered. In addition, purchased parts are not covered under this warranty. Proof of purchase (dated register receipt) is required for warranty claims. We reserve the right to make substitutions with similar merchandise, if the model in question is no in production. Warranty is to the original purchaser and is non-transferable. As some states do not allow exclusions or limitations on an warranty, the above exclusions and limitations may not apply. This warranty gives you specific rights, and you may also have other rights, and you may also have other rights, which vary from state to state.

Contact the Customer Service Team at 1-877-527-0313 or visit www.HomeDepot.com.

Pre-installation

PLANNING INSTALLATION

It will take 2 people about 20 minutes to complete the installation process.

TOOLS REQUIRED

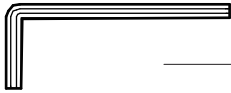

_____ Wrench (Included)

HARDWARE INCLUDED



NOTE: Hardware not shown to actual size.

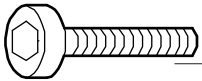

_____ AA

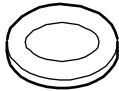

_____ BB

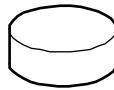

_____ CC

Part	Description	Quantity
AA	Bolt (M8x35)	8
BB	Washer	8
CC	Bolt cap	8

Pre-installation (continued)

PACKAGE CONTENTS

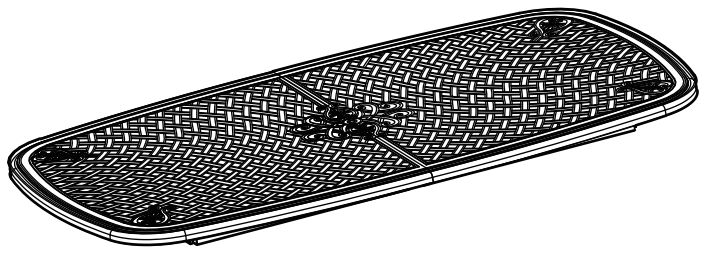

_____ A

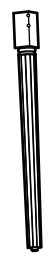

_____ B

Part	Description	Quantity
A	Table top	1
B	Table leg	4

Assembly

1 Attaching the table legs

- Place table top (A) upside down on a clean smooth surface.
- Attach table legs (B) to table tops (A) with washers (BB) and bolts (AA).
- Completely tighten all bolts (AA) and cover all bolts with bolt caps (CC).

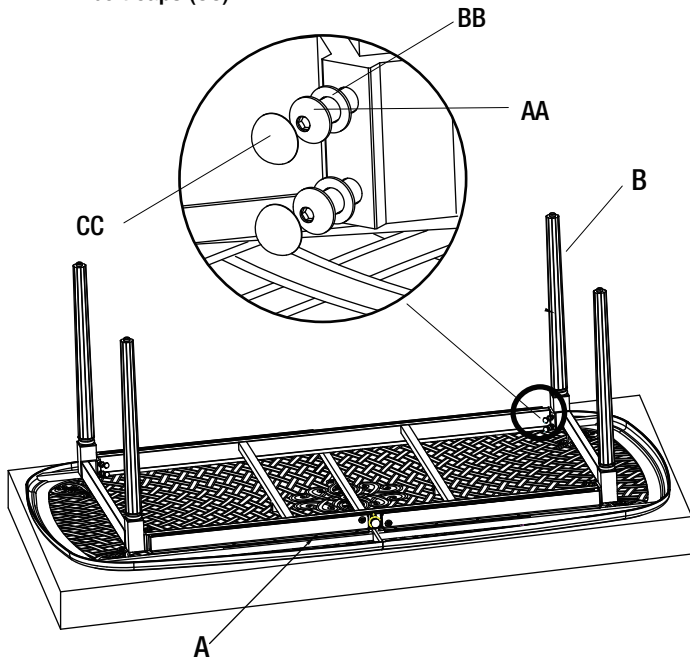

2 Leveling the table

- Turn over the table.
- Level the table with glides at the bottom of table legs.

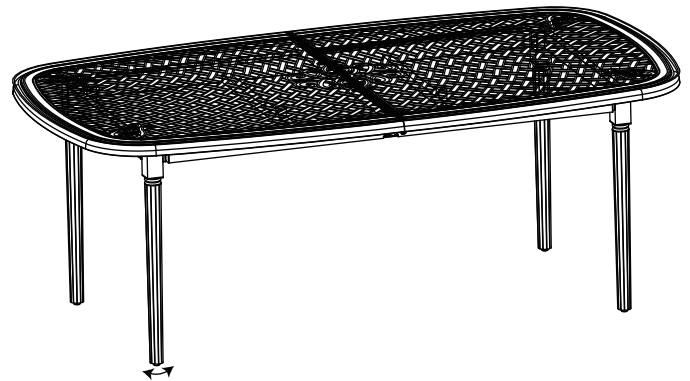

Operation

1 Checking the stability

- Always use the table on flat ground only.
- When necessary level the table with the glides at the bottom of table legs.

2 Extending the table top

- Loosen the knob at the middle of the table. **(Step 1)**

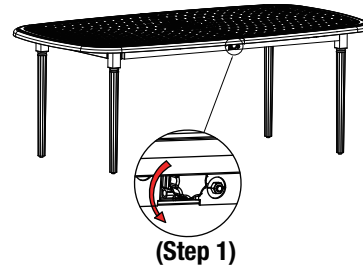

- Slide the 2-pc big table tops apart. **(Step 2)**

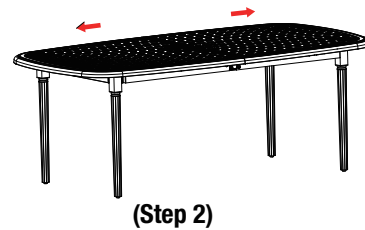

- Manually raise the 2-pc small extension section until it makes a flat surface. **(Step 3)**

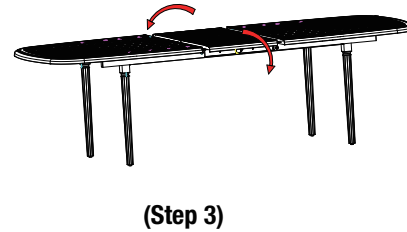

(to be continued on page 7)

Operation

2 Extending the table top (continued)

- Push the 2-pc table tops inward until all 3 sections lock into place forming a smooth surface lining up pins with the small table tops. (Step 4)



IMPORTANT: Please insure there is no noticeable gap between big table tops and small table tops.

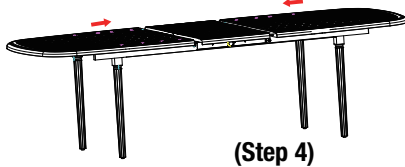

- Tighten the knob completely to secure in place. (Step 5)

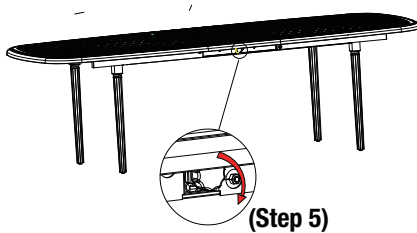

CAUTION: Keep fingers clean when operating extension when operating extension leaf mechanism.

3 Retracting the table top

- Follow the oppsite procedure in 2. *Extending the table top* to return table to smaller size.



Questions, problems, missing parts? Before returning to the store,
call Hampton Bay Customer Service
8.00 a.m. – 6.00 p.m., EST, Monday-Friday

1-877-527-0313

HOMEDEPOT.COM

Retain this manual for future use.