

IN41331

INSTALLATION INSTRUCTIONS

1500 Cherokee Parkway, Suite 100, Acworth, GA 30102
Phone: (866) 845-5451 • Fax: (866) 816-6165
E: service@acclaim-lighting.com • www.acclaim-lighting.com

ACCLAIM
LIGHTING
INTERIOR • OUTDOOR

Please read carefully and save these instructions, as you may need them at a later date.

CAUTION

WARNING: Risk of Fire. Consult a qualified electrician to ensure correct branch circuit conductor.

Turn off the main power at the circuit breaker before installing the fixture in order to prevent possible shock.

GENERAL

All electrical connections must be in accordance with local and National Electrical Code (N.E.C.) standards. If you are unfamiliar with proper electrical wiring connections obtain the services of a qualified electrician.

Remove the fixture and the mounting package from the box and make sure that no parts are missing by referencing the illustration.

ASSEMBLY AND INSTALLATION

1. Insert plastic anchors (9) into wall.
2. Secure the back plate (6) to the outlet box (1) with mounting screw (8). Secure the back plate (6) to the plastic anchors (9) using two anchors screws (10).
3. Pull out the outlet wire and ground wire from the outlet box (1). Make wire connections.
 - Ribbed wire (w/o marking) or white wire from light to White wire (2) from power source.
 - Smooth wire (w/o marking) or black wire from light to Black wire (3) from power source.
 - Attach the ground wire (4) to back plate (6) with a ground screw (7).
4. Secure front plate (11) to back plate (6) with mounting screws (12).
5. Place the glass (15) on the glass holder (13).
6. Install bulbs (16) to socket (14)
(Don't exceed the maximum capacity recommended on the sockets).

INSTALLATION IS NOW COMPLETED

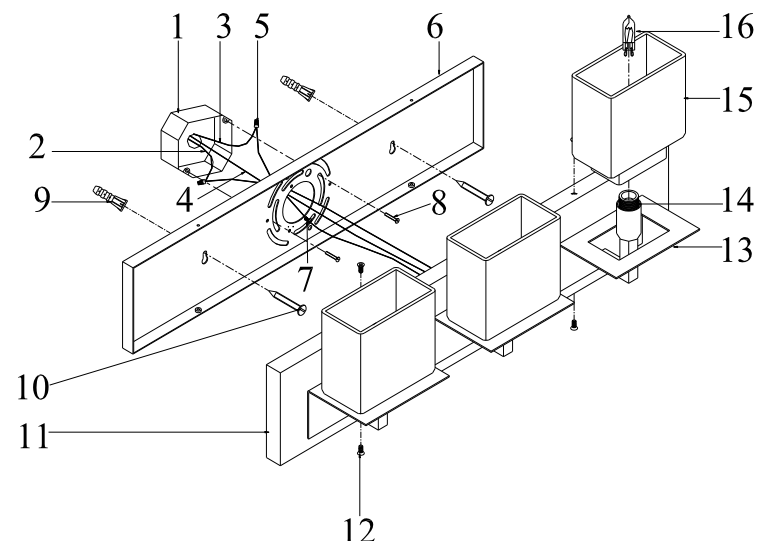

- | | |
|-------------------|--------------------|
| 1. OUTLET BOX | 9. PLASTIC ANCHOR |
| 2. WHITE WIRE | 10. ANCHOR SCREW |
| 3. BLACK WIRE | 11. FRONT PLATE |
| 4. GROUND WIRE | 12. MOUNTING SCREW |
| 5. WIRE CONNECTOR | 13. GLASS HOLDER |
| 6. BACK PLATE | 14. SOCKET |
| 7. GROUND SCREW | 15. GLASS |
| 8. MACHINE SCREW | 16. BULB |