

INFARED MOTION ACTIVATED SECURITY LIGHT INSTALLTION INSTURCTIONS

Model # L5999

10 Year Warranty on Fixture

(Does not apply to bulbs, which have no warranty)

Congratulations and Thank You! The fixture you have purchased should give you 10 years of trouble free service. We take pride in the design and construction of each of our products and work to maintain the quality of our materials and craftsmanship to assure your satisfaction.

This product is warranted to be free of defects in workmanship and materials for a period of 10 years from the original date of purchase. If any problems appear (other than burnt out bulbs, which carry no warranty) within 10 years, the purchaser may return the item, freight prepaid, together with a copy of your original purchase receipt to:

Upon receipt of the item prepaid with a letter describing the problem, and a check for \$7.50 to cover return postage and handling, the company will, at its option, either repair or replace the defective part or fixture at no charge to the purchaser. This warranty does not apply to fixtures that have been used for rental or commercial purposes. It does not cover fixtures that have been altered in any way or fixtures that have been subject to misuse, accidents or damage in transit.

IN NO CASE SHALL THE COMPANY BE LIABLE FOR ANY INCIDENTAL OR CONSEQUENTIAL DAMAGES. NO CHARGES WILL BE ACCEPTABLE FOR UNAUTHORIZED REPAIRS, PARTS OR SERVICE.

Some states do not allow limitations on how long an implied warranty lasts and do not allow exclusions or limitations of incidental damages, so parts or all of this warranty limitations or exclusions may not apply to you. Legal warranty rights will vary from state to state and you may have other rights.

IMPORTANT NOTICE:

Every attempt has been made to deliver a quality product that will give you years of trouble free service. In the event that you have problems with the fixture, please **DO NOT RETURN TO PLACE OF PURCHASE. PLEASE CALL THE NUMBER BELOW FOR BULB OR PARTS PROBLEMS:**

(847) 672-4017

8-5 pm (West Coast time). All warranty problems are handled directly through Southwire Co.

HOW IT WORKS

Congratulations on the purchase of your motion sensor light with infrared detection. The motion detector turns lights on and off after sensing moving heat sources in target area. Connected to light fixtures:

- Use as security light for any unprotected side or corner of house. Lights will be activated when intruder passed through target area of sensor.
- Install as a sensing device to turn lights on as people approach the entrance of your home.
- Functions as welcome light if installed to sense cars entering driveway.

PACKING INCLUDES

L5999 Motion Sensor Floodlight

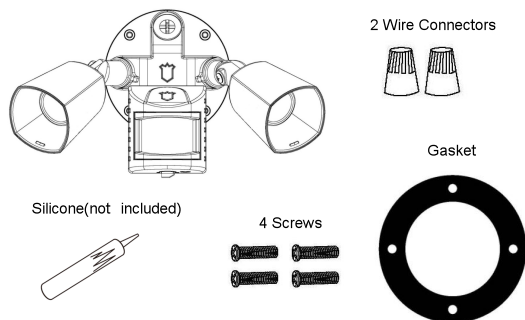

INSTALLATION

CHOICE OF LOCATION

Whenever possible, locate the unit so that its coverage area is away from heat sources or reflective surfaces, such as heating vents, air conditioners, large moving trees or pools of water. Whenever possible, locate the unit so that motion moves across the coverage area, not directly towards or away from the motion sensor. It is because the motion sensor is more sensitive to motion across it, not towards or away from it.



Note: The detection range specified above is based on the sensor's performance in conditions that represent average temperatures found in North America. The detection range of the sensor will vary with changing ambient temperatures.

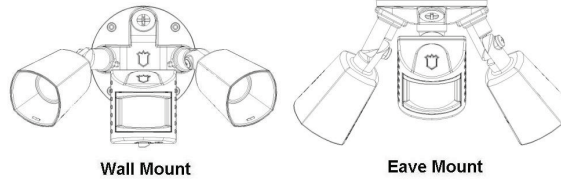

This fixture may be mounted on a wall or an eave. It may be mounted onto a standard recessed outlet box or a wet location / outdoor outlet box. For easy installation, replace an existing light fixture that is already connected to a wall switch.

Since the holes on the backplate are not pre-drilled, drill the holes by electric drill as needed to mount the backplate with junction box.

WARNING: Maintain minimum 1.5" (3.8cm) distance between lampholders and sensor head. Do not point lampholders directly at ceiling; possible fire hazard. Do not let lamps touch ceiling. Keep a minimum 2" distance from ceiling.

TIPS FOR PROPER OPERATION

1. For optimal operation and optimal coverage area mount unit 6 to 8ft. above ground on house overhang or wall.
2. Mount away from heat producing sources such as air conditioners & barbecue grills, other light fixtures or sources of light. Keep in mind areas with traffic, pets or other moving objects may cause nuisance triggering.
3. Do not aim at highly reflective surfaces such as smooth white walls, waterfalls, or windows.
4. Point sensor slightly downward. Do not mount up facing sun.
5. If you are unfamiliar with electrical wiring, it is recommended you secure the services of qualified electrician who can assure this installation meets national and local electrical codes.

ASSEMBLY

If you already have outdoor lights in the location you intend to mount the new fixture, you simply disconnect old fixture and remove. Follow steps for wiring the new units to existing electrical box. If you do not have power to that location, a new outlet box and wiring must be installed. **DO NOT ATTEMPT TO DISASSEMBLE THE MOTION SENSOR HEAD. THERE**

ARE NO USER SERVICEABLE PARTS INSIDE.

See electrical wiring instructions for installation.

Remark: Fill in the wall plates and mounting surface with silicone.

CAUTION: Before beginning installation disconnect power to the location where the light will be installed by shutting that controls the light is not sufficient to prevent electrical shock.

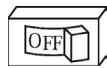

CAUTION: BEFORE BEGINNING INSTALLATION, FIRST DISCONNECT POWER TO WIRING LOCATION BY SHUTTING OFF CIRCUIT BREAKER OR REMOVING FUSE AT FUSE BOX. SHUTTING OFF A WALL SWITCH THAT CONTROLS THE LIGHT IS NOT SUFFICIENT TO PREVENT ELECTRIC SHOCK.

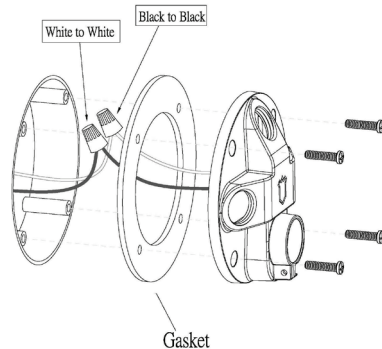

WIRING THE LIGHT CONTROL

Fixture is pre-wired for quick and easy installation for both professionals and do-it-yourself alike:

DO NOT REMOVE ANY CRIMP CONNECTORS PREINSTALLED!! ONLY WHITE, AND BLACK WIRES WILL NEED TO BE ATTACHED TO INCOMING LINES!!

1. Check local electrical codes before installation. Use only 120 Volt 60hz power supply.
2. Be sure power is turned off at breaker or fuse box. Turning switch off is not sufficient to prevent electrical shock!!
3. Remove old light fixture.
4. The new fixture mounts best on standard 4" octagonal electrical box. If your box is an odd size, you may need to purchase an additional base in a proper size from an electrical supplier. Check size carefully before attempting to mount fixture.

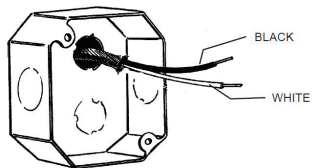

5. Slide the black foam gasket over the white and black wires. It seals the base to the wall when installed, helping keep moisture out.

6. See diagram above:
 A: Using wirenuts, connect white wire from fixture to white wire from house.
 B: Connect black wire from fixture to black wire from house.
 C: All wirenuts installed to connect wires should be taped in place with electrical tape to assure they cannot come off accidentally at a later time.
7. Install base of lamp to the 4" octagonal base using included screws. In the event your box is deep in the walls, too deep for included screws, you may obtain longer screws from local hardware store. Make sure you match threads correctly.
8. Wiring portion is now complete, so you can install bulbs. Again, double check wall switch is in off position and power is shut off at breaker.

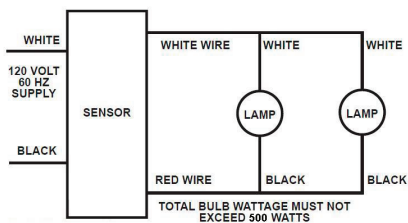

OPERATION

Auto Mode	Turn knob from 3 seconds to 10 minutes as needed.
------------------	---

SET-UP AND ADJUSTMENT

Follow these steps to set up your security light for best operation.

1. Turn power switch on and wait 60 seconds for the system's circuitry to stabilize.
2. Turn the "Time" knob to the fully counter clockwise direction.
3. Aim the control module to the desired target area. Have a person stand approximately in the center of the target area moving slightly. Moving arms up and down is usually sufficient.
4. Turn the **TIME** knob clockwise to adjust how long you want the lights to stay on after the unit is activated. The maximum (full clockwise) is about 10 minutes. The minimum (full counter clockwise) is about 3 seconds.
5. Remove CDS sticker after TIME adjustment.



SPECIFICATIONS

SIDE VIEW FOR AIMING UNIT

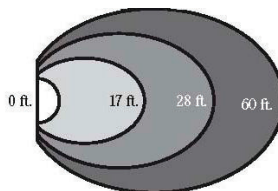
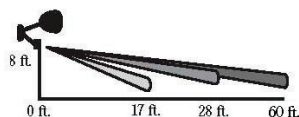

Sensing Angle	110 degree
Power Consumption	4 watts maximum (control module only)
Power Requirement	110/120 volts 60 Hz
Load Rating	500 watts maximum (Incandescent only)
Operating Modes	AUTO Mode
Delay Control	3 seconds to 10 minutes (approximately)

TROUBLESHOOTING

Lights do not come on at all:

1. Make sure the breaker for the fuse is in the on position.
2. Make sure the switch in the house is turned on.
3. Check to see there is power to the motion detector on the black and white wires from the house.
4. Make sure the lamps being used are working. Faulty bulbs, or fiber washer at bottom of screw-type bulbs will prevent proper contact.
5. Check all wiring and connections.
 - A: All white wires
 - B: Black house wire to black motion detector wire.

Lights stay on all night

1. The dusk-to-dawn photocell feature. Make sure daylight is normal (N) position for motion detection.
2. Check all wiring and connections.
 - A: All white wires
 - B: Black house wire to black motion detector wire.
3. Check to make sure each lamp is minimum 40 watts and total does not exceed total 500 Watts.

Motion Detector triggers on with motion, and stays on:

1. Move floodlights away from motion detector head, or use lower wattage lamps.
2. If mounted on slope, aim slightly upward if slope is upward. If on downward slope, aim motion detector head severely downward, and slowly raise if necessary.
3. Aim motion detector head lower, away from moving busy areas such as sidewalks and streets.

Motion Detector comes on randomly:

1. Move floodlights away from motion detector head, or use lower wattage lamps.
2. Aim motion detector head lower.
3. Make sure motion detector head is not aimed at heating/cooling ducts, metal sheds, pools of water, windows, or smooth walls.
4. Make sure motion detector is mounted on firm surface, as mechanical vibrations can cause false triggering.

NOTE: Occasionally, in severe frigid temperatures flows of warm air passing the motion detector may cause light to cycle on and off due to extreme temperature change. This is not a sign of a problem. This infrequent occurrence will not affect normal operation of unit.