

PARTS BREAKDOWN SHEET



ACCENT TWO HANDLE KITCHEN FAUCET



Model #: _____
Specific Features: _____
Project Name: _____
Submitted For: _____
Date: _____

- Lever Handles
- Gooseneck Style Spout
- 8-7/16" Reach, 8-1/8" From Deck to Aerator
- Washerless Cartridge Operation
- 3-Hole 8" Installation
- With 1.5 GPM Flow Rate

K-5340 SHOWN **ADA**

Model #	Features	Finish	
K-5340*		CP	
K-5340-BN*		PVD BN	
K-5340-ORB*		ORB	

* Aerator limited to 1.5 GPM Flow Rate

Olympia products are engineered and manufactured to meet the following standards and codes:

- ASME A112.18.1
- ANSI A117.1
- ANSI / NSF 61, SECTION 9
- IAPMO LISTED
- CONTAINS NO MORE THAN 0.25% WEIGHTED AVERAGE LEAD CONTENT

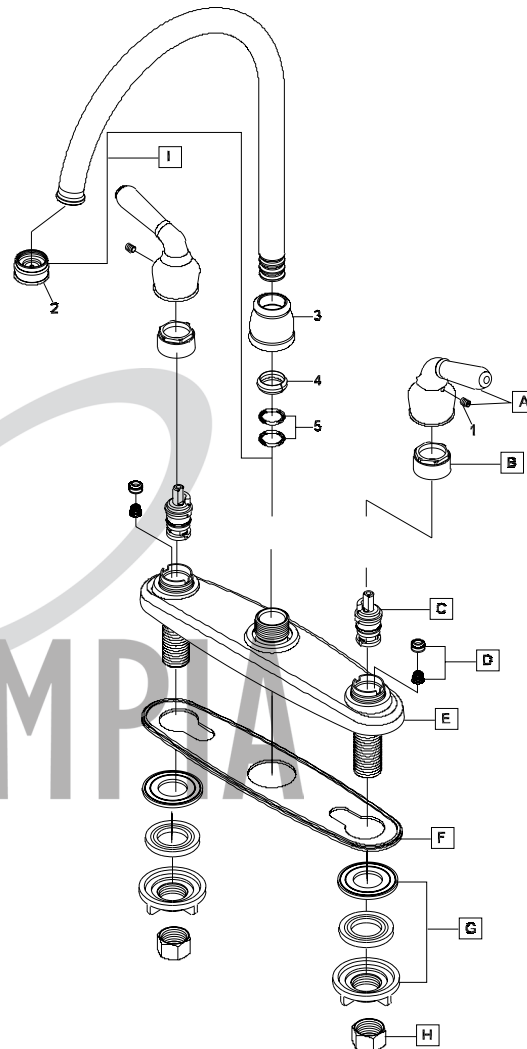

ITEM #	DESCRIPTION
A	OP-190010C,H* Lever Handle Cold, Hot
B	OP-490040 Bonnet Nut
C	OP-390004 Cartridge- Brass Post
D	OP-490041 Springs and Seats
E	OP-420025* Deck Plate
F	OP-420026 Base Gasket
G	OP-520009 Mounting Locknut & Washer
H	OP-590001 Supply Nut
I	OP-220004* Gooseneck Spout
1	OP-490029 Allen Screw
2	OP-490057* 1.5 GPM Aerator
3	OP-490028* Spout Bonnet Nut
4	OP-490038 Spout snap ring
5	OP-490039 Spout O-ring

* Note- Please Specify finish/color code while ordering.