

ANTIQUED LEATHER HOW-TO GUIDE



Surfaces assume the characteristic appearance of worn leather when this tinted, translucent glaze is applied over two basecoats of semi-gloss paint and then mottled with a Ralph Lauren Stippler Brush



WHAT YOU WILL NEED:



Ralph Lauren Semi-Gloss Paint
See Step One for space estimations.



Ralph Lauren Faux Technique Glaze
See Step One for space estimations.



Quality 9" Roller Frame with TWO 3/8" Nap Roller Covers



Ralph Lauren Stippler Brush



Ralph Lauren Fitch Edge Brush



Quality 3" Nylon/Poly Trim Brush

ADDITIONAL ITEMS: 2" Painter's tape · Drop cloth · Latex gloves · Paint tray · Lint-free rags · Water · Mixing container with measurements

STEP ONE: PREP

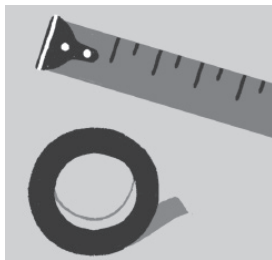

- Measure your room to estimate how much paint you'll need. In general, one gallon of Ralph Lauren Semi-Gloss Paint covers approximately 200 square feet with two coats. One gallon of Ralph Lauren Faux Technique Glaze covers approximately 400 to 800 square feet with one coat.
- Always start with clean, dry walls that have been primed with a latex primer.
- Tape off all areas to be painted with 2" painter's tape, including across the ceiling and any adjacent walls.

HELPFUL HINT *Because the glaze dries quickly, we recommend working with a partner. One person can roll and brush on the glaze while the other softens with the Stippler Brush. For the most consistent overall appearance, the same person should do each step throughout the room.*

STEP TWO: BASECOAT

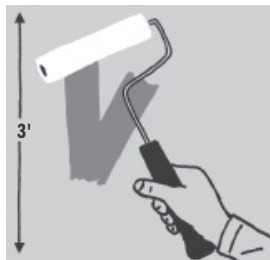

- Using Ralph Lauren Semi-Gloss Paint and the quality 3" trim brush, outline the ceiling and trim.
- Condition the first quality 9" roller frame with 3/8" nap roller cover by rolling it through the paint 20 to 30 times. Then, painting in a random V-pattern, cover small 3' x 3' sections. Each roller-full should cover one section. Finish each section with a smooth ceiling-to-floor stroke, and then continue working in sections until the wall is entirely painted.
- Allow four hours for the basecoat to dry, and then apply a second coat.
- Wait 24 hours for the second coat to dry, and then proceed to Step Three.

HELPFUL HINT *To perfect your glaze technique, prepare a practice board with one coat of the Ralph Lauren Semi-Gloss Paint.*

STEP THREE: GLAZE PREP

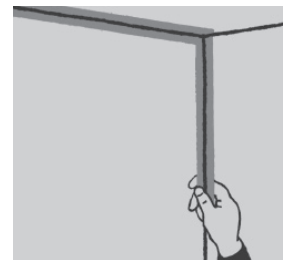

- Unlike the basecoat, which can be applied in a single day, the glaze is applied only to non-adjacent walls during the first day. This precaution will avoid getting glaze on the already leathered walls. The remaining walls are glazed the following day.
- Tape off any freshly painted adjacent walls with 2" painter's tape.
- Mix four ounces of water per one quart of glaze in a separate container, and then pour into the paint tray.

HELPFUL HINT *Once you start applying the glaze, do not stop application until the wall is complete.*

STEP FOUR: GLAZE & STIPPLE

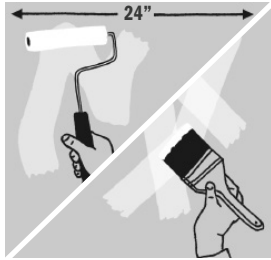

- With the 3" trim brush, paint glaze along the ceiling and down the wall's edge, approximately two to three feet.
- Condition the second quality 3/8" nap roller cover by rolling it through the glaze at least 20 times.
- Apply the glaze in a 24" x 24" randomly shaped section, leaving edges jagged and uneven. Immediately follow with the 3" trim brush, feathering the edges of the glaze to soften the lines and then brushing over the entire glazed area to blend and even it out.

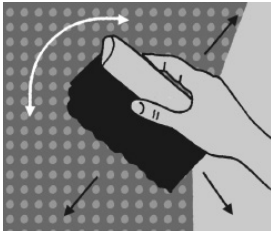

- Use the Ralph Lauren Fitch Edge Brush with a pouncing motion around the edges and trim.
- Working first on the outer edges of the section, use the Ralph Lauren Stippler Brush to pounce over the area, hitting the surface in a different direction each time. Wipe the excess glaze off the Ralph Lauren Stippler Brush after each section by blotting onto the lint-free rags.

HELPFUL HINT While the glaze is still wet, remove hairs on the wall with the Fitch Edge Brush.

STEP FIVE: COMPLETE COVERAGE

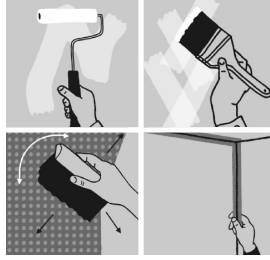

- Repeat Step Four on the remaining sections until the room is complete.
- Gently remove the tape from adjacent walls. If you're applying glaze to the entire room, wait 24 hours before taping freshly glazed walls.

HELPFUL HINTS Lines will naturally appear throughout your finish in the overlapping areas.

Ralph Lauren Faux Technique Glaze can be painted over without sanding the walls first. Apply a coat of a premium primer followed by your new Ralph Lauren Paint or Ralph Lauren Specialty Finish.