

Universal tubs

your doorway to independent bathing

Thank you for choosing Universal Tubs the nationwide manufacturer of walk-in tubs, bathtubs and bathroom fixtures exclusively made for the Home Depot.

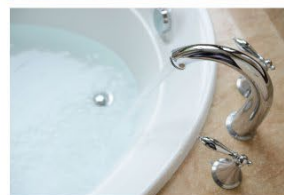

For toll-free information or to speak to a knowledgeable representative simply call **1-877-360-4454** or visit us online at **www.UniversalTubs.com** or email us at **info@UniversalTubs.com**.

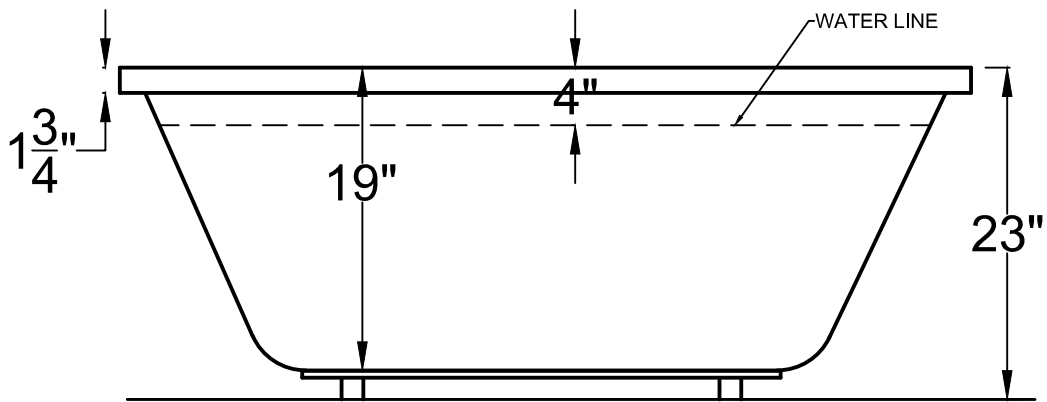
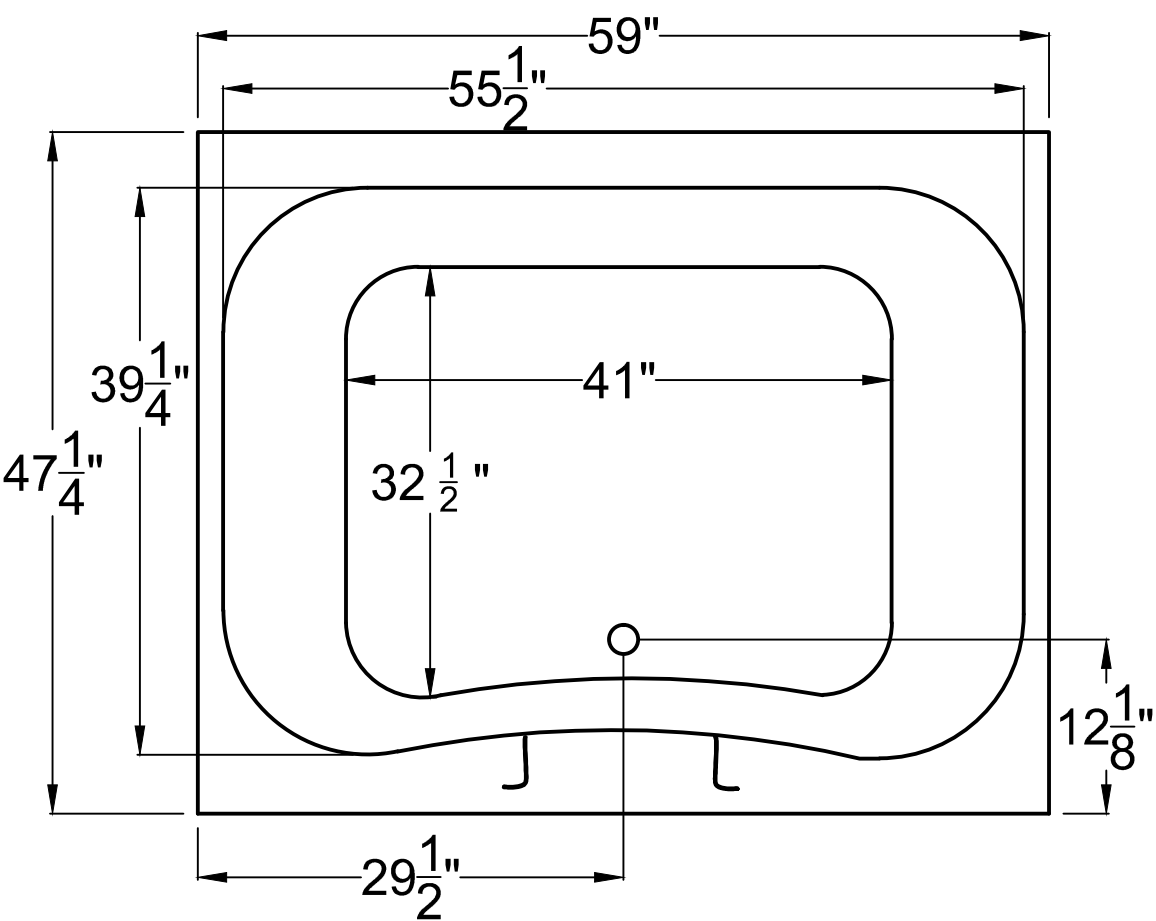

4860N

40¹/₂" x 59" x 23"

Installation: Drop-in
cannot be under mounted

GENERAL SPECIFICATIONS:

Material Acrylic

Plumbed Weight : 140lbs / 64kg

Soaker Weight :110 lbs / 50kg

Average Fill: 45 gal to above jet level

ELECTRICAL SPECIFICATIONS:

Required Electrical

Air Bath or Whirlpool

Whirlpool with Inline Heater

Dual Bath

Soaker

Service 110 Volt

1-15 amp GFCI

1-20 amp GFCI

1-20 amp GFCI

PACKAGES AND OPTIONS

Hydrotherapy Package	Package Contents	Part #
Soaker	soaking bath - no jets, textured bottom	4860NS
Whirlpool	8point-massage jets, 1-hp pump, textured bottom	4860NH
Air Bath	26 air jets, air blower, textured bottom	4860NA
Dual Bath	8 point-massage jets, 1-hp pump, 26 air jets, air blower, textured bottom	4860ND

OPTIONS
Colors Available - White Biscuit
Quick Ship - reduces lead time - call for availability
Inline Heater with Pump - Whirlpool or Dual Bath
Lift & Turn Drain Kit -Chrome,Brushed Nickel, White

IMPORTANT INFORMATION

- Before ordering or installing, please consider future access to equipment.
 - Add bedding compound to fully level and support bottom of tub.
 - Tubs equipped with an air bath or a pre-leveled foam base are designed to rest on the floor without bedding compound, provided the floor is level.
 - Please measure tub on-site before building tub decking.
 - Jet, pump & blower locations are predetermined and cannot be changed.
- Suction and control locations may vary.
 - Specifications and configurations are subject to change without notice.
 - Measurements are +1/2" and are subject to change without notice.
 - Measurements herein supersede all others published prior to publication date shown below.