

APPLICATIONS FOR AQUABAR® "B" UNDERLAYMENT MEMBRANE

THE DETAILS SHOWN HERE REFER TO GENERALLY ACCEPTED
WOOD FLOOR INSTALLATION PRACTICES

Aquabar "B" is an extremely effective moisture vapor retarder for use under wood flooring. It is a cleaner and easier handling product than roofing felt and poly film. Aquabar "B" slows moisture migration and is a superior vapor retarder. **It is not a waterproof membrane.**

HARDWOOD FLOORS

Under wood floors, **Aquabar "B"** serves as a moisture and vapor retarder, reducing or preventing moisture migration from below the floor system, allowing the wood flooring to acclimate gradually. As a semi-permeable material, **Aquabar "B"** is also much less likely than poly film to trap moisture condensation between it and the sub-floor. Installed under wood floors as a "slip sheet", Aquabar "B" helps keep down dust and reduces squeaks.

This application guide provides examples of typical wood flooring installations using **Aquabar "B"**. The descriptions are brief and do not cover all circumstances that the installer may encounter during installation. It is the responsibility of the installer to read and follow the flooring manufacturer's complete instructions for proper installation of their flooring. Aquabar "B" may be used in applications over a wood or concrete sub-floor.

JOB SITE CONDITIONS

- Building must be completely enclosed
- Site drainage directs water away from foundation
- All other interior work should be completed
- Interior environmental conditions must be at occupied levels
- Basements and crawl spaces must be dry
- Acclimate flooring per manufacturer's recommendation

SUB-FLOOR PREPARATION

- All surface debris and protrusions must be removed
- Check sub-floor for squeaks and repair
- Sweep and vacuum prior to filling or repairing voids
- Fill voids and level high spots, sweep again

WOOD SUB-FLOORS – NAILED

Always read and follow the floor manufacturer's installation instructions. For installations over wood joist construction be sure, if above a crawl space, the ground is covered by a vapor retarder with a perm rating of ≤ 0.1 , such as Fortifiber's **Moistop Ultra**, and crawl space is properly ventilated. Cut **Aquabar "B"** to length and position over sub-floor as needed for proper

coverage. Overlap edge seams a minimum of 4 inches. Once **Aquabar "B"** is installed, snap chalk lines to desired layout.

CONCRETE SUB-FLOORS – FLOATED & NAILED

For on-grade slabs, the following conditions must be met:

- An underslab vapor retarder has been properly installed, such as Fortifiber's **Moistop Ultra** family of products.
- The slab is thoroughly dry before installation of wood flooring. Generally, slabs must be 60 days old. Test for moisture, following flooring manufacturer's recommendations.
- To be certain normal slab moisture does not reach the wood flooring, install a vapor retarder with a perm rating of ≤ 0.1 – such as Fortifiber's **Moistop Ultra** – over the slab.

Then follow wood floor manufacturer's recommendation for placement of plywood. Cut and install **Aquabar "B"** over plywood as above.

CONCRETE SUB-FLOORS – SCREED SYSTEM

Install flat, dry, preservative treated 2x4s, cut 18-24" long, laid flat at right angles to finished floor, spaced 12" o.c. and embed in adhesive. Then lay a vapor retarder with a perm rating of ≤ 0.1 over screeds, install plywood and cover with **Aquabar "B"** as above.

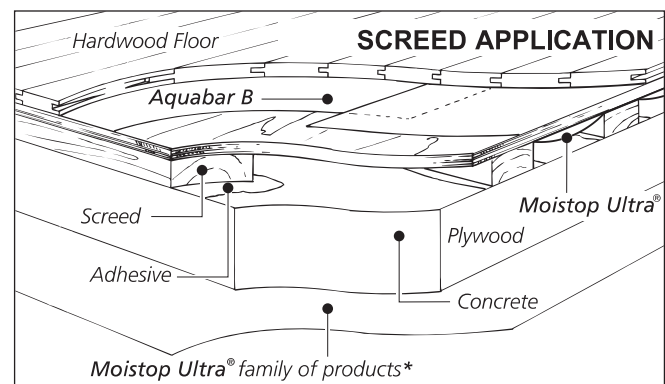
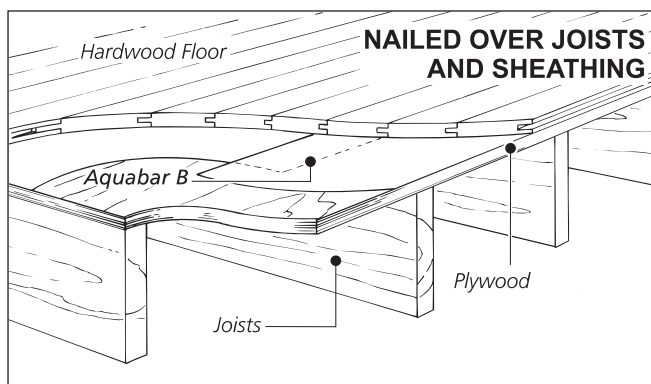
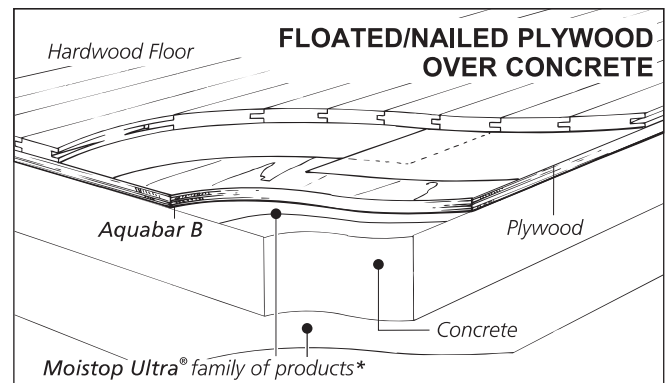

***The Moistop Ultra® family of underslab vapor retarders are critical for Wood and Tile floors placed on concrete slabs.**

APPLICATIONS FOR AQUABAR® "B" TILE & FLOORING UNDERLAYMENT

THE DETAILS SHOWN HERE REFER TO GENERALLY ACCEPTED
TILE INSTALLATION PRACTICES

Aquabar "B" is suitable for use in interior tile and stone applications as a moisture retardant membrane, or cleavage membrane on walls, countertops, or residential showers. It reduces the potential for damage caused by moisture vapor migration. **Aquabar "B" is not a waterproof membrane** and should not be used in waterproofing assemblies or where a waterproof membrane is specified.

TILE & STONE INSTALLATIONS

The following illustrations are examples of typical tile and stone installations using **Aquabar "B"**. The following illustrations are designed to show the positioning of **Aquabar "B"** within the assembly and do not attempt to give step-by-step installation details for the assembly. To obtain detailed installation instructions, please refer to the Handbook for Ceramic Tile Installation, "The Industry's Guide for Installation Practices", or ANSI Standards. Contact The Tile Council of North America, Inc., on-line at tileusa.com or call (864) 646-8453.

All tile applications should be installed in accordance with appropriate ANSI A108, A118 and A136 standards for installation of ceramic tile, the architect/specifier instructions and all local building codes. When installing behind a cementitious backer

units follow the CBU manufacturer's installation instructions for a moisture retardant barrier. In applications where a duplex type reinforced asphalt paper meeting ASTM C-171 is specified, use Fortifiber's **Orange Label Sisalkraft** paper.

INSTALLATION – Cut **Aquabar "B"** to length and position over substrate as needed for proper coverage. It may be applied to wall framing either horizontally (best method) or vertically. Overlap seams a minimum of 4 inches or more as required by CBU manufacturer or architect/specifier and local building codes. Be sure to overlap tub or shower lip and seal gap between the tile installation and tub/shower unit with a high quality elastomeric caulking after tile work and grout are dry.

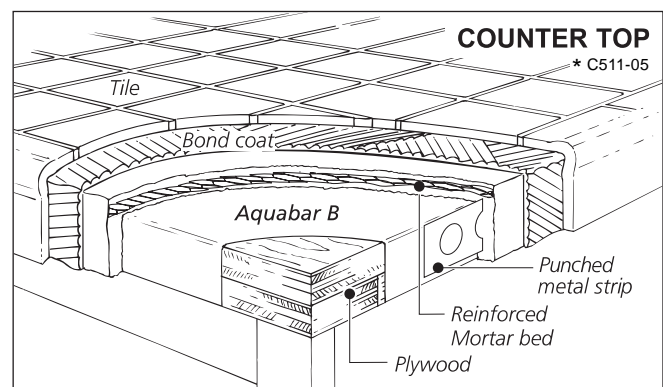
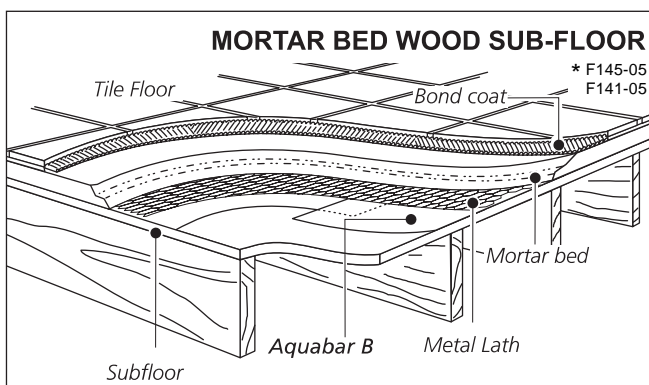
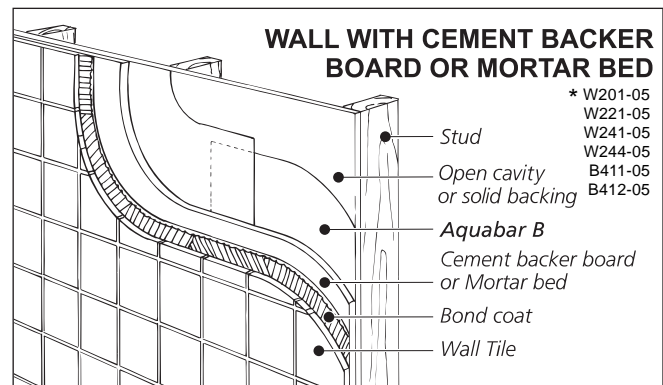
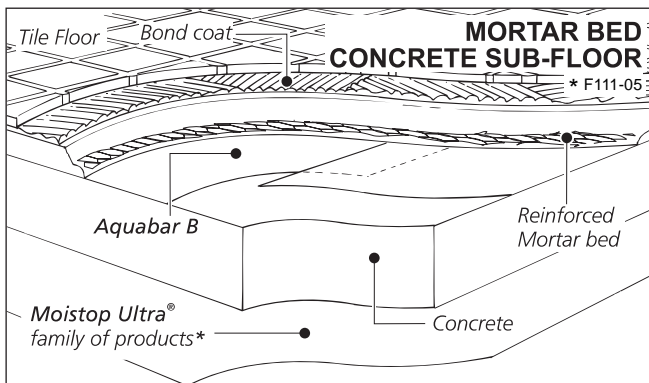

LIMITATIONS: **Aquabar "B"** tile and floor underlayment is not a waterproof membrane and should not be used in waterproofing assemblies where a waterproof membrane is specified. Do not leave exposed to direct moisture contact or use in areas that are soaked or saturated for extended periods of time, such as gang showers, saunas, steam rooms, pools, hot tubs and exterior areas. Not recommended over radiant heat systems, which may result in asphalt odor. Not recommended for use in exterior wall assemblies. Properly prepared walls, sub-floors or jobsite conditions and proper installation of flooring and tile are the responsibility of the installer. In applications where duplex type reinforced asphalt paper, meeting ASTM C-171, is specified use Fortifiber's **Orange Label Sisalkraft**.

*See current Handbook for Ceramic Tile for installation details.

Call 1-800-773-4777 Nationwide for
Technical Assistance or visit our website
at www.fortifiber.com



**Fortifiber Building
Systems Group®**

Protecting Your World from the Elements®

NATIONAL SALES OFFICE – Fernley, NV

(577/10)