

Acurio Panel Stand Mounting Instructions

1

Low orientation

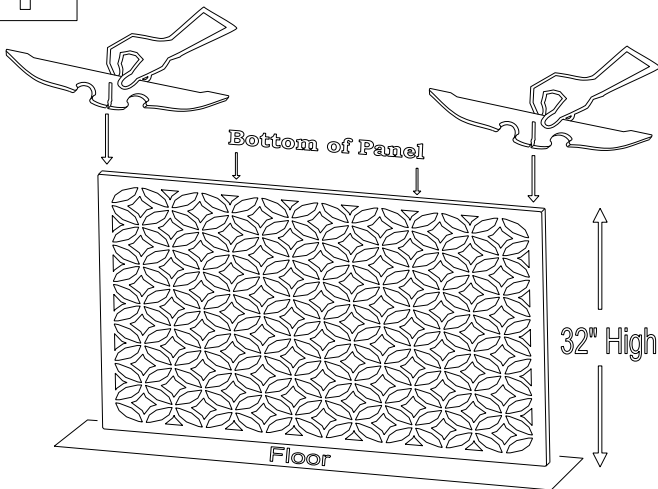

For easy installation you must stand the panel upside down and press the panel stands into position near the bottom edges and the stands will bind in place.

Tip 1:

(do not try placing the stands on the floor and inserting the panel into the stand slot because due to the patented design this will cause premature binding)

2

Flip the panels over!

The stands will stay in place for easy panel placement and mobility.

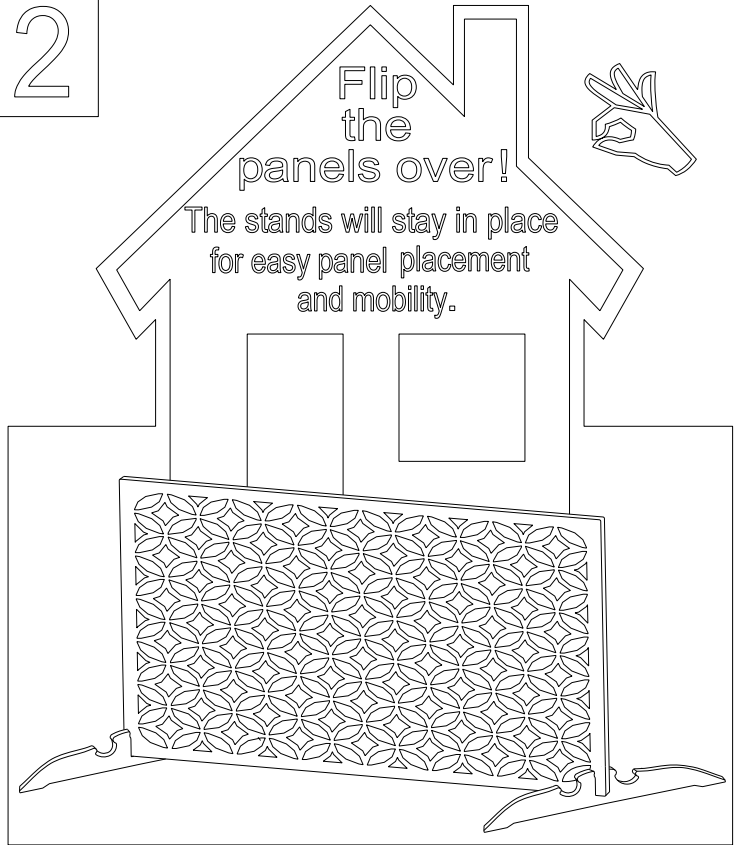

3

For extra panel steadiness install the vertical panel stabilizers.

Tip 2:

Under normal circumstances the vertical stabilizers are not necessary, but for high traffic area's or high wind environments installing the stabilizers are recommended.

Tip 3:

Screws can be added for extra reinforcement after the panel is inserted.
Use: #6 x 1-1/2"

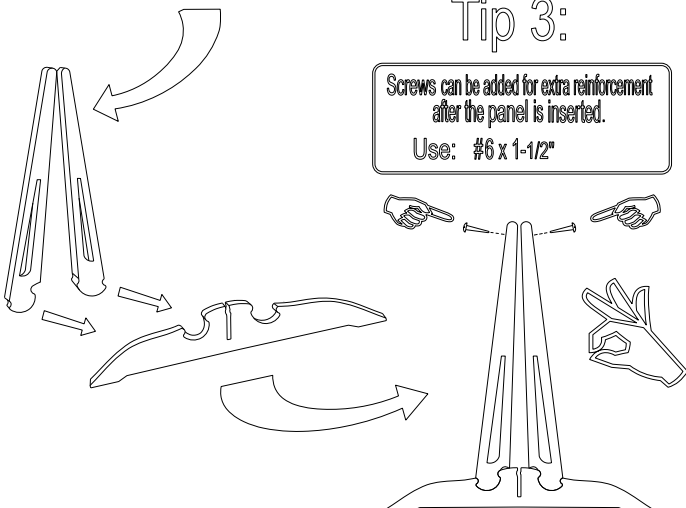

4

Tall orientation

The panel stand stabilizers must be installed.

