

BT1855, BT1855-E

OIL-FREE BRAD NAILER
 CLAVADORA DE CLAVITOS SIN ACEITE
 CLOUSEUSE À SEMENCES SANS HUILE

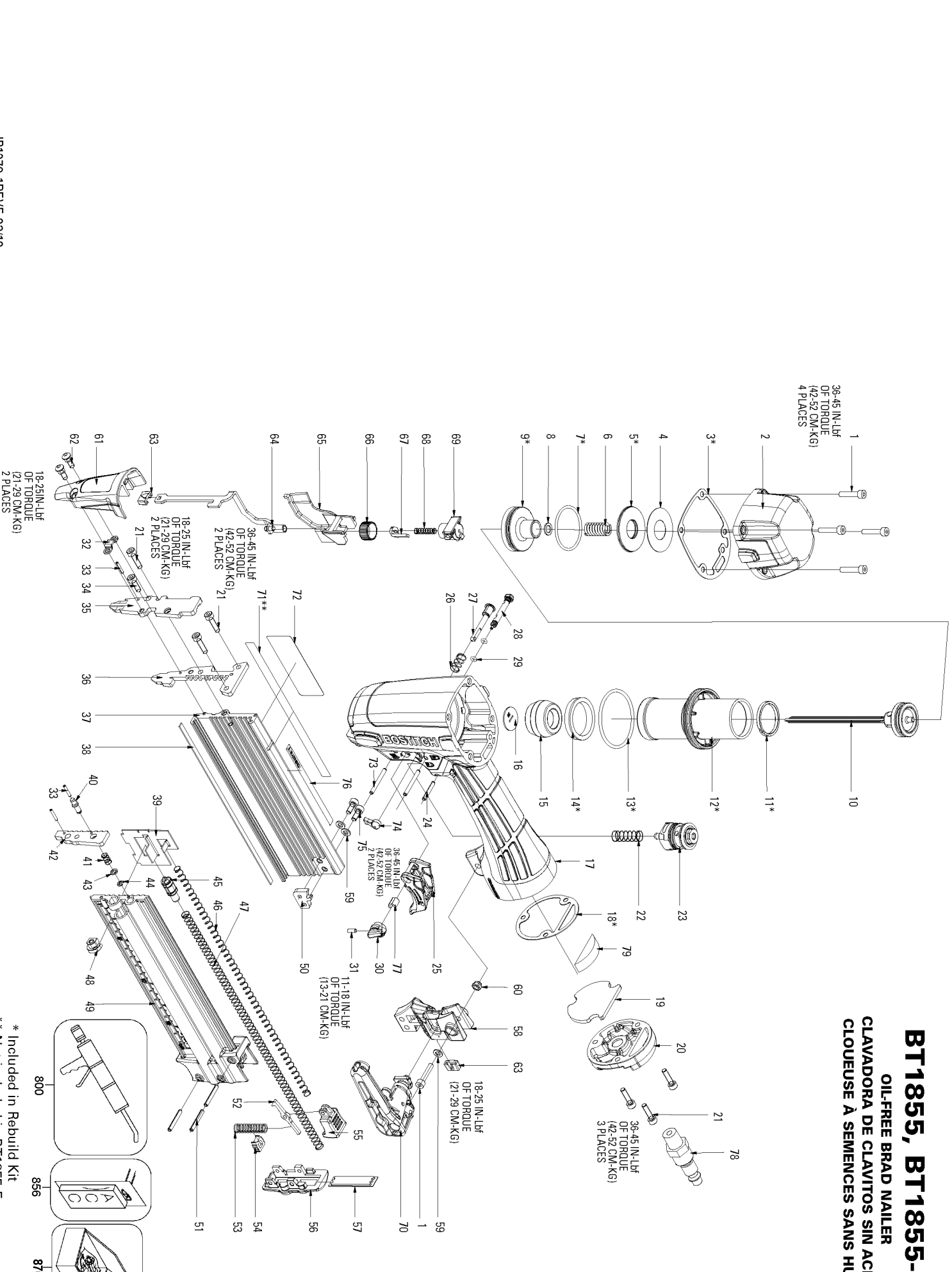

IP1279-1REVE 03/10
 TO BE USED WITH PARTS LIST IP1279-2 AND OPERATION AND MAINTENANCE MANUAL 180585.

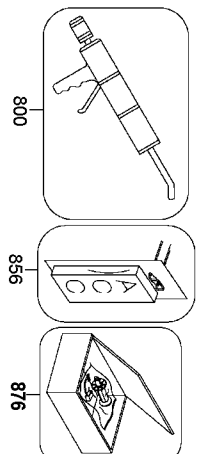

* Included in Rebuild Kit
 ** Not included in BT1855-E

Parts List for BT1855K Type 0

Item Number	Part Number	Description	Qty Required
1	100260	SCREW- SOC. HD. CAP	5
2	181917	ASSEMBLY-CAP	1
3	175682	GASKET-FRAME/CAP	1
4	180445	PLATE-HEAD VALVE	1
5	180446	SEAL-HEAD VALVE	1
6	180447	SPRING-HEAD VALVE	1
7	1FS0034	O-RING	1
8	180449	WASHER-FLAT-D6X10X1	1
9	180450-S	HEAD VALVE BODY	1
10	180451	ASSEMBLY-PISTON/DRIV	1
11	180457	RING-PISTON	1
12	180458	SLEEVE-CYLINDER	1
13	180459	O-RING-44.7MMX2.4MM	1
14	180460	CHECK SEAL	1
15	180461	BUMPER	1
16	180462	DRIVER GUIDE	1
17	175656	FRAME-OVERMOLD	1
18	180463	GASKET-END CAP	1
19	182235	AIR FILTER	1
20	180465	END CAP	1
21	MSC4070-16	SCREW-SHCS-M4X0.7X16	1
22	180476	SPRING-TRIGGER	1
23	TVA15	TRIGGER VALVE	1
24	180475	PIN-SPRING-M3X20MM	1
25	184513	ASSEMBLY-TRIGGER	1
26	180481	SPRING-MODE SWITCH	1
27	184507	PIN-MODE SWITCH	1

COPYRIGHT© 2005. All Rights Reserved.

Parts list, pricing, and availability subject to change. Please visit www.dewaltservicenet.com for current parts information.

Parts List for BT1855K Type 0

Item Number	Part Number	Description	Qty Required
28	184519	PIN-TRIGGER LOCK	1
29	MRG002514	O-RING-.098X.055	2
30	184506	BUTTON-MODE SWITCH	1
31	180484	SCREW-SET-M3X8MM	1
32	180207	BRACKET-TRIP	1
33	180490	PIN-SPRING-M2X12MM	3
34	MSC4070-12	SCREW-SHCS-M4X0.70X1	1
35	180489	NOSE	1
36	175661	CORE TIP-FIXED	1
37	180488	MAGAZINE-FIXED	1
38	180497	GUIDE-NAIL	1
39	180498	PUSHER	1
40	180491	PLUNGER-LOCK OUT	1
41	180492	SPRING-LOCK OUT	1
42	175662	PLATE-CORE	1
43	180493	SPACER	1
44	180494	E-RING-2.5MM	1
45	180499	ROLLER-PUSHER	1
46	180496	PUSHER SPRING B	1
47	180495	PUSHER SPRING A	1
48	180238	SET NUT	1
49	181915	MAGAZINE-SLIDING	1
50	180500	REAR PLATE	1
51	180503	PIN-SPRING-M3X23MM	3
52	180501	LATCH	1
53	180502	SPRING-LATCH	1
54	180319	SUPPORT-LATCH SPRING	1

COPYRIGHT© 2005. All Rights Reserved.

Parts list, pricing, and availability subject to change. Please visit www.dewaltservicenet.com for current parts information.

Parts List for BT1855K Type 0

Item Number	Part Number	Description	Qty Required
55	175666	COVER-LATCH	1
56	175665	END CAP-MAGAZINE	1
57	120927	LABEL-SENSOR SMALL (1
58	175664	BRACKET-MAGAZINE	1
59	180504	WASHER-FLAT-D4X8X1	3
60	MHE4070-100	ELASTIC STOP NUT-M4	1
61	175663	COVER-NOSE	1
62	180505	SHOULDER SCREW	2
63	179760	FOOT-CONTACT (NO MAR	1
64	180314	ASSEMBLY-TRIP	1
65	180508	GUIDE-LOWER CONTACT	1
66	180509	ADJUSTING KNOB	1
67	180510	ASSEMBLY-UPPER CONTA	1
68	180513	SPRING-CONTACT ARM	1
69	180514	GUIDE-UPPER TRIP	1
70	180515	ASSEMBLY-BELT HOOK	1
71	180301	LABEL-PRODUCT/FASTEN	1
72	180296	LABEL-WARNING	1
73	174345	PIN-SPRING-M3X28	2
74	184518	BUTTON-TRIGGER LOCK	1
75	MSC4070-10	SCREW-SHCS-M4X0.70X1	2
76	181919	LABEL-WARNING	1
77	184508	BUSHING	1
78	ISWIVEL-14M	AIR CONNECTION	1
79	180577	MUFFLER	1
800	100679	LUBE (1LB.CAN)	1
800	100653	LUBE (2CC)	1

COPYRIGHT© 2005. All Rights Reserved.

Parts list, pricing, and availability subject to change. Please visit www.dewaltservicenet.com for current parts information.

Parts List for BT1855K Type 0

Item Number	Part Number	Description	Qty Required
876	BT55/SX38-RK	REBUILD KIT	1

COPYRIGHT© 2005. All Rights Reserved.

Parts list, pricing, and availability subject to change. Please visit www.dewaltservicenet.com for current parts information.