

#1804- 1-3/4 in. White Inswing Latch Set for Screen Door

bartonkramer.com/1804-1-34-in-white-inswing-latch-set-for-screen-door/

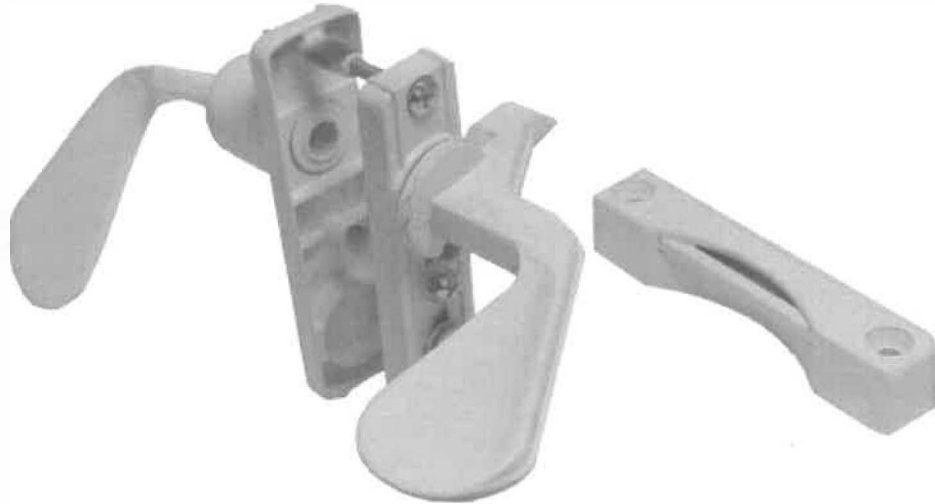

This inswing latch set is used on screen and storm doors. It is constructed of aluminum for long lasting life. Allows doors to be lock from the inside.

- 1-3/4 in. spacing between mounting holes
- Includes resilient striker and mounting hardware
- Lockable feature

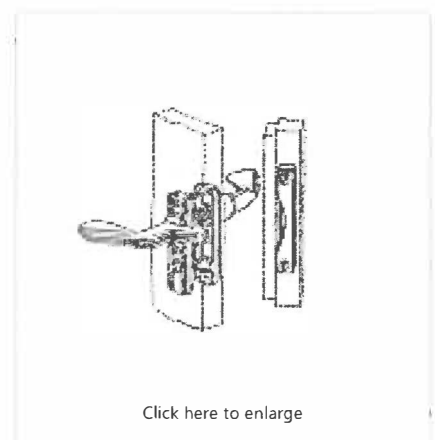

Installation Instruction

Inswinging Latch

For Inswinging Doors Only

DRILL TEMPLATE

1. Fold template on scored line. (This leaf on door).
2. With door in closed position place fold of template on outside of door against wood stop or metal Z bar, whichever projects farther, and spot for holes.
3. Drill 3 — $\frac{1}{4}$ " holes straight thru door.
4. Apply latch to door. If spindle binds, due to misalignment, enlarge center hole.
5. Attach strike to wood jamb with $1\frac{1}{4}$ " screws.

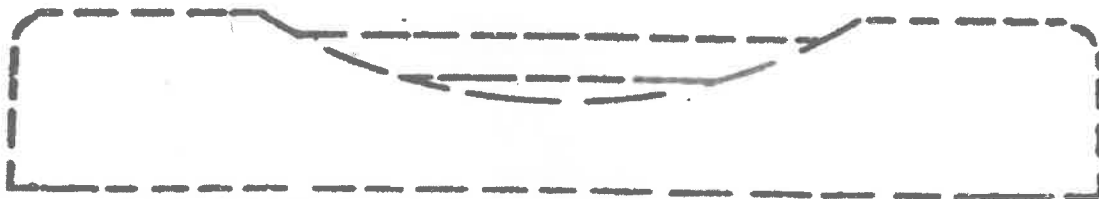
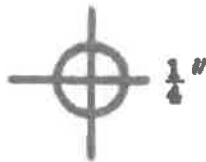
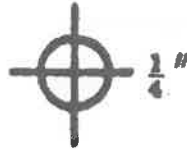
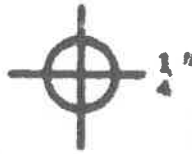

TO INSTALL LOCKING UNIT IF INCLUDED

1. Drill $\frac{3}{4}$ hole straight thru door and remove knock-out in outside plate.
2. Pull keys from cylinder and insert from inside of door. Position end boss to engage recess in lock bolt (in inside plate).
3. Place inside plate over flats on cylinder. Set outside plate over cylinder projection, and tighten screws (2) firmly on inside plate.