



TABLE OF CONTENTS

Product Information

General Information.....2
Unit Sizing and Configurations.....3

Options

Lite Cut Information.....4
Divided Lite Options.....5

Section Details

Vertical Section.....6
Jamb - Horizontal Section.....7
Panel to Panel - Horizontal Section.....8
Astragal - Horizontal Section.....9



GENERAL INFORMATION

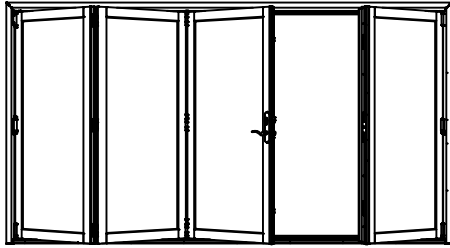

Dimensional Doors

Clad folding patio doors may be specified as "dimensional", by adjusting the desired rough opening width or height in 1/4" increments from standard.

The standard size range includes sizes specifically designed for replacement of older patio door models in existing structures, as well as a full range of "true size" products for architectural consistency.

Operation

The W4500 Clad Folding Patio Door is available in eleven 2-panel, 3-panel and 4-panel operating configurations. Each Folding configuration maximizes the wall opening by folding all panels to one or both side jambs. This Folding Door System is a beautiful way to create a window wall with open indoor / outdoor living spaces.

Standard Panel

Size Options:

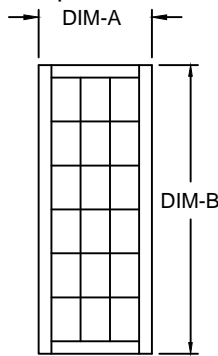

PANEL SIZES	
WIDTHS	HEIGHTS
30 1/8	77
36 1/8	80
	93

Operating Configurations:

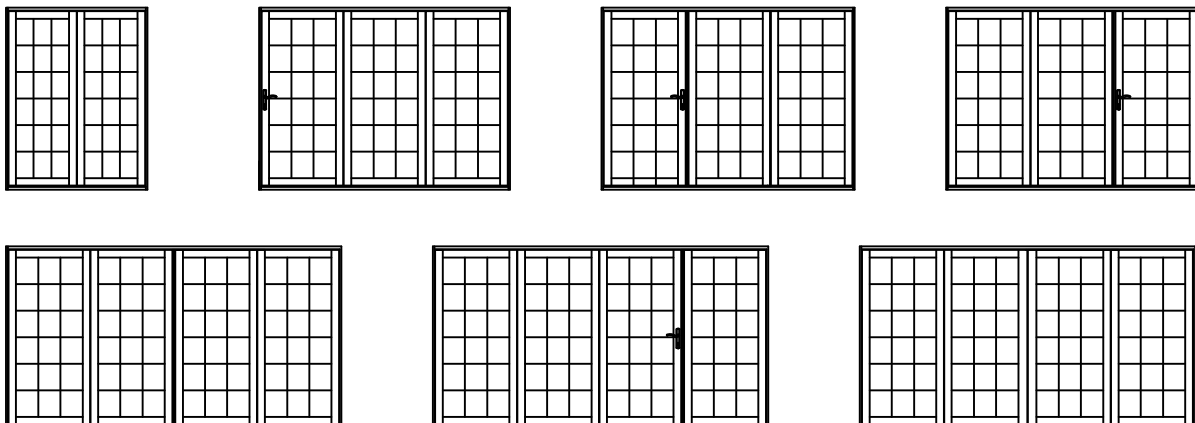
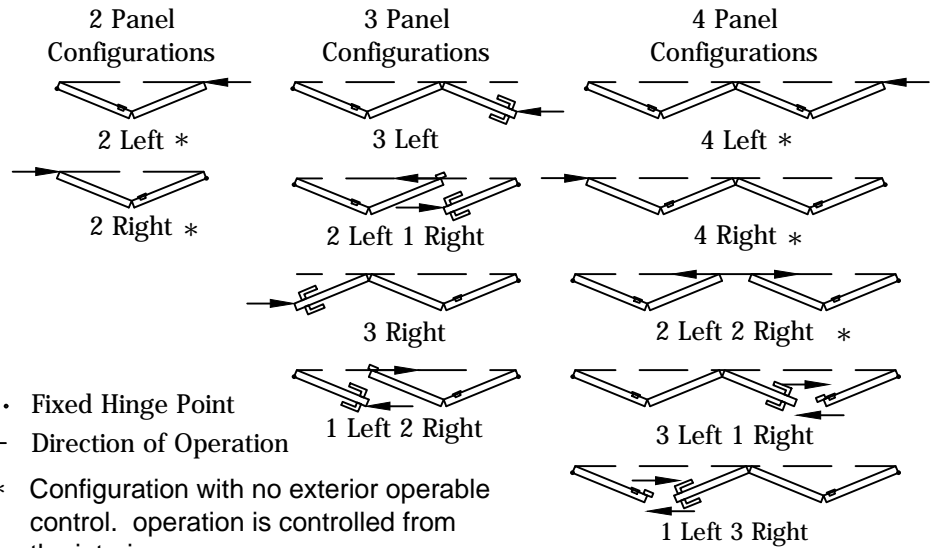



UNIT SIZING AND CONFIGURATIONS

Elevation drawings utilize a limited number of projected lines to produce a rudimentary drawing intended to be used in a small graphical scale. Elevations are viewed perpendicular from the exterior of the structure. If more dimensions are needed, use the section drawings for more complete depictions.

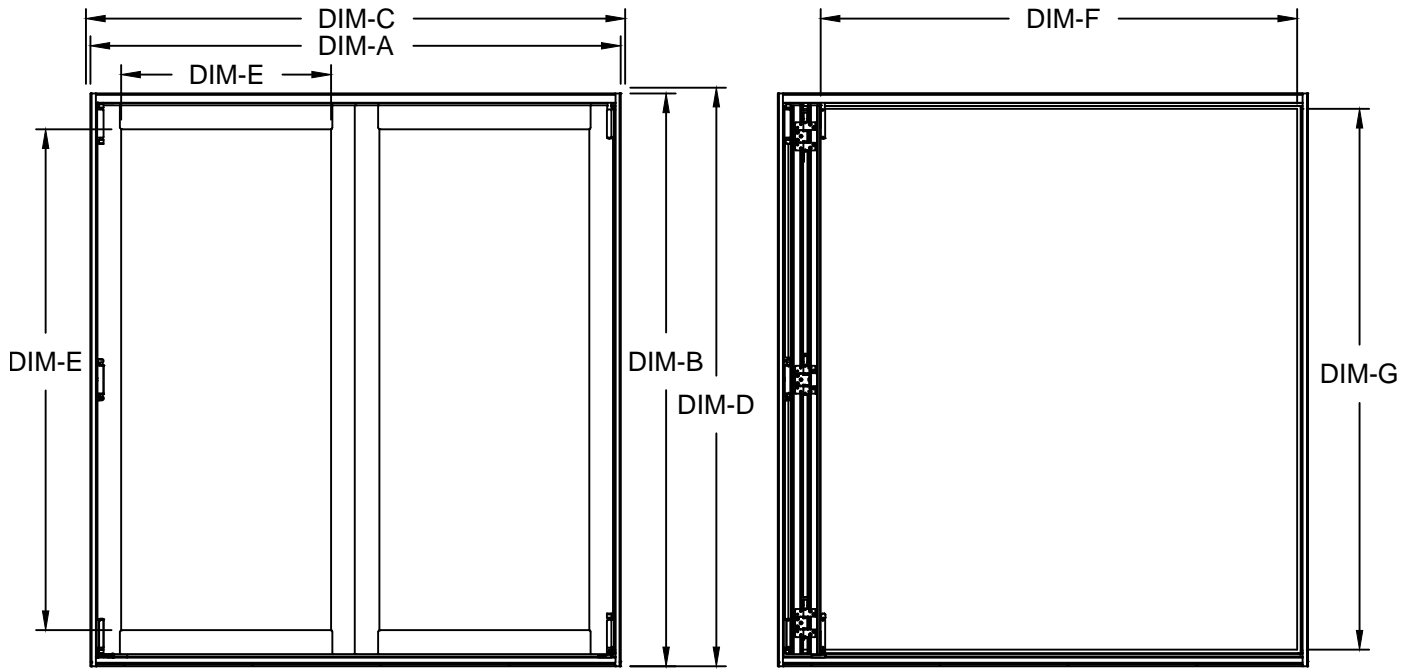

W4500 BI-FOLD PATIO DOOR SIZING AND CONFIGURATION MATRIX - 2'-6" PANEL WIDTH								
Operating Code	Panel Height (in.)	Frame Width (in.)	Frame Height (in.)	Rough Opening Width (in.)	Rough Opening Height (in.)	Total Daylight Opening (sq./ft.)	Clear Opening Width (in.)	Clear Opening Height (in.)
2'-6" Panels		DIM-A	DIM-B	DIM-C	DIM-D	DIM-E	DIM-F	DIM-G
2L, 2R (4)	77	62 1/2	80 3/8	63 1/4	80 7/8	23	54 11/32	75 29/32
	80	62 1/2	83 3/8	63 1/4	83 7/8	23	54 11/32	78 29/32
	93	62 1/2	96 3/8	63 1/4	96 7/8	23	54 11/32	91 29/32
3L, 3R	77	92 3/4	80 3/8	93 1/2	80 7/8	34	78 17/32	75 29/32
	80	92 3/4	83 3/8	93 1/2	83 7/8	34	78 17/32	78 29/32
	93	92 3/4	96 3/8	93 1/2	96 7/8	34	78 17/32	91 29/32
2L1R, 2R1L	77	93 15/16	80 3/8	94 11/16	80 7/8	34	81 5/32	75 29/32
	80	93 15/16	83 3/8	94 11/16	83 7/8	34	81 5/32	78 29/32
	93	93 15/16	96 3/8	94 11/16	96 7/8	34	81 5/32	91 29/32
2L2R (4)	77	123 3/16	80 3/8	123 15/16	80 7/8	46	109 7/8	75 29/32
	80	123 3/16	83 3/8	123 15/16	83 7/8	46	109 7/8	78 29/32
	93	123 3/16	96 3/8	123 15/16	96 7/8	46	109 7/8	91 29/32
4L, 4R (4)	77	123 1/16	80 3/8	123 13/16	80 7/8	46	111 9/16	75 29/32
	80	123 1/16	83 3/8	123 13/16	83 7/8	46	111 9/16	78 29/32
	93	123 1/16	96 3/8	123 13/16	96 7/8	46	111 9/16	91 29/32
3L1R, 3R1L	77	124 3/16	80 3/8	124 15/16	80 7/8	46	107 1/16	75 29/32
	80	124 3/16	83 3/8	124 15/16	83 7/8	46	107 1/16	78 29/32
	93	124 3/16	96 3/8	124 15/16	96 7/8	46	107 1/16	91 29/32

W4500 BI-FOLD PATIO DOOR SIZING AND CONFIGURATION MATRIX - 3'-0" PANEL WIDTH								
Operating Code	Panel Height (in.)	Frame Width (in.)	Frame Height (in.)	Rough Opening Width (in.)	Rough Opening Height (in.)	Total Daylight Opening (sq./ft.)	Clear Opening Width (in.)	Clear Opening Height (in.)
3'-0" Panels		DIM-A	DIM-B	DIM-C	DIM-D	DIM-E	DIM-F	DIM-G
2L, 2R (4)	77	74 1/2	80 3/8	75 1/4	80 7/8	29	69 11/32	75 29/32
	80	74 1/2	83 3/8	75 1/4	83 7/8	29	69 11/32	78 29/32
	93	74 1/2	96 3/8	75 1/4	96 7/8	29	69 11/32	91 29/32
3L, 3R	77	110 3/4	80 3/8	111 1/2	80 7/8	43	96 17/32	75 29/32
	80	110 3/4	83 3/8	111 1/2	83 7/8	43	96 17/32	78 29/32
	93	110 3/4	96 3/8	111 1/2	96 7/8	43	96 17/32	91 29/32
2L1R, 2R1L	77	111 15/16	80 3/8	112 11/16	80 7/8	43	99 5/32	75 29/32
	80	111 15/16	83 3/8	112 11/16	83 7/8	43	99 5/32	78 29/32
	93	111 15/16	96 3/8	112 11/16	96 7/8	43	99 5/32	91 29/32
2L2R (4)	77	147 3/16	80 3/8	147 15/16	80 7/8	58	133 7/8	75 29/32
	80	147 3/16	83 3/8	147 15/16	83 7/8	58	133 7/8	78 29/32
	93	147 3/16	96 3/8	147 15/16	96 7/8	58	133 7/8	91 29/32
4L, 4R (4)	77	147 1/16	80 3/8	147 13/16	80 7/8	58	135 9/16	75 29/32
	80	147 1/16	83 3/8	147 13/16	83 7/8	58	135 9/16	78 29/32
	93	147 1/16	96 3/8	147 13/16	96 7/8	58	135 9/16	91 29/32
3L1R, 3R1L	77	148 3/16	80 3/8	148 15/16	80 7/8	58	131 1/16	75 29/32
	80	148 3/16	83 3/8	148 15/16	83 7/8	58	131 1/16	78 29/32
	93	148 3/16	96 3/8	148 15/16	96 7/8	58	131 1/16	91 29/32

General Folding Door Notes

- W-4500 Clad Folding Patio Doors are available as operating units
- Unit elevations are shown without exterior trim. Unit sizes & masonry opening dimensions will change with the addition of exterior trim. See the 'unit sizing, rough openings & masonry openings' page for exterior trim effects.
- Operating units are available as left or right hand operation. four panel, two panel left, two panel right are not handed.
- Configurations with no exterior operable control. Operation is controlled from the interior.



LITE CUT INFORMATION

W-4500 Clad Folding Patio Doors are available with removable grilles in 7/8", 1-1/8" and 1-3/8" widths, with grilles between the glass (GBG), or with Simulated Divided Lites. Standard lite cuts are rectangular, and conform to the layouts noted in the charts on the next page. To use the chart, refer to the appropriate table by the type of patio door and type of bars or grilles the section drawings illustrate. Then simply cross reference the frame height and width to determine the standard lite cut.

Lite Cut Options

Special lite cut patterns can include a wide variety of straight line and radius patterns. The illustrations shown here represent just a few of the possibilities. Rectangular, horizontal, vertical and Prairie lite patterns are available in all standard size clad sliding patio doors. Uneven, diamond, radius and Gothic lite cuts are available, subject to approval. Approvals are based on the ability to fulfill the design requirement while maintaining the construction integrity of the finished product.

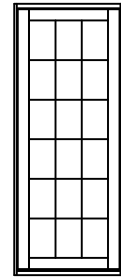

Rectangular

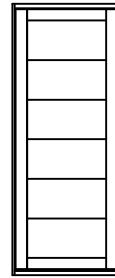

Horizontal

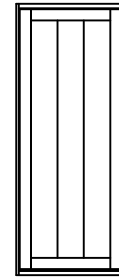

Vertical

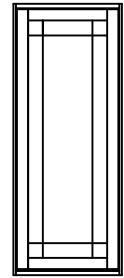

Prairie

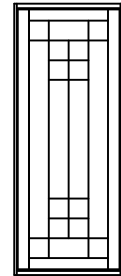

Uneven

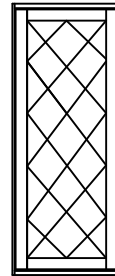

Diamond

Bar Alignment

Alignment of divided lite muntin bars from one product to the next is often required by fine architectural design. Wood grilles, GBG's, and Simulated Divided Lites may be specified with muntin bars aligned.

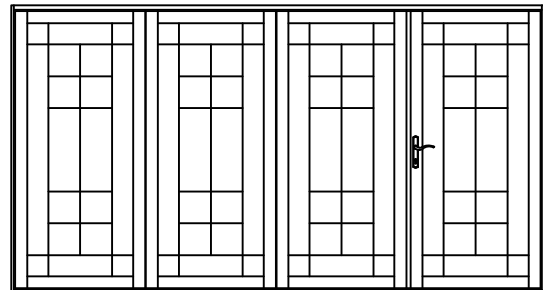
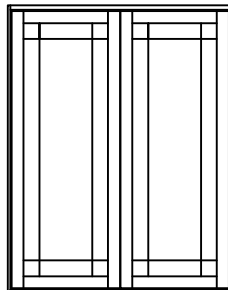
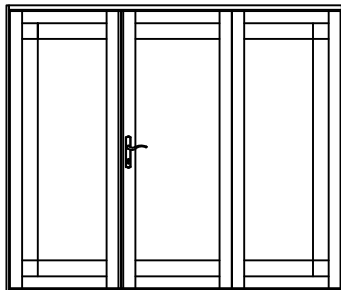



DIVIDED LITE OPTIONS

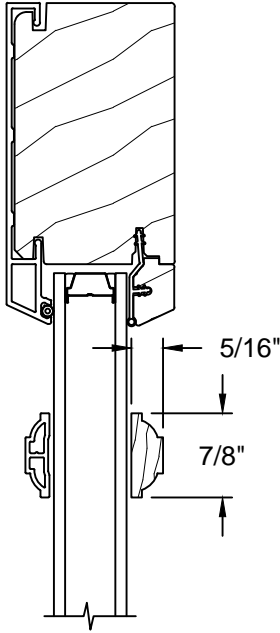

7/8" Grille Bar

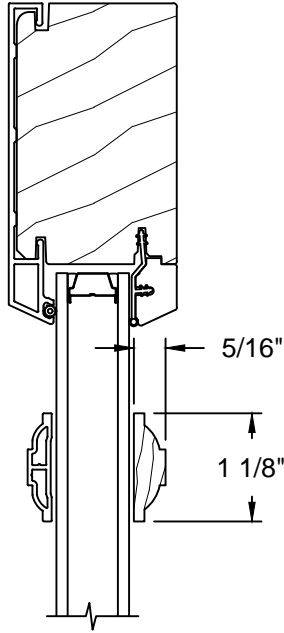

1 1/8" Grille Bar

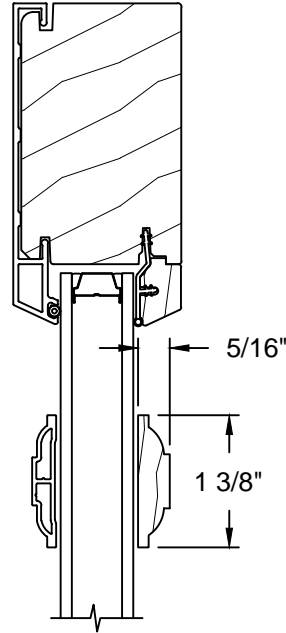

1 3/8" Grille Bar

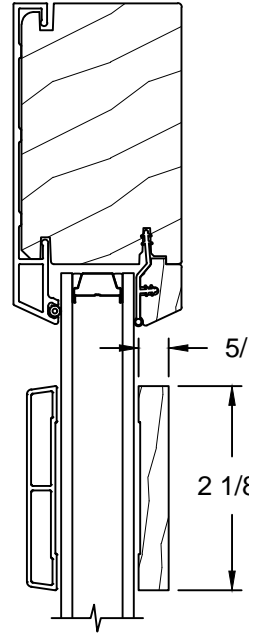

2 1/8" Grille Bar

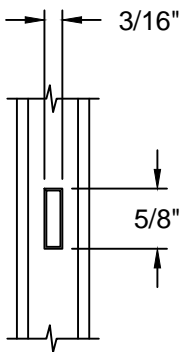

5/8" Grille

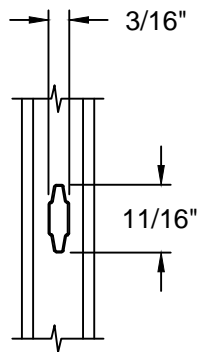

23/32" Grille

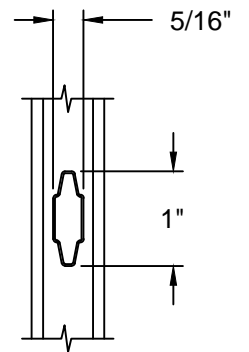

1" Grille



VERTICAL SECTION

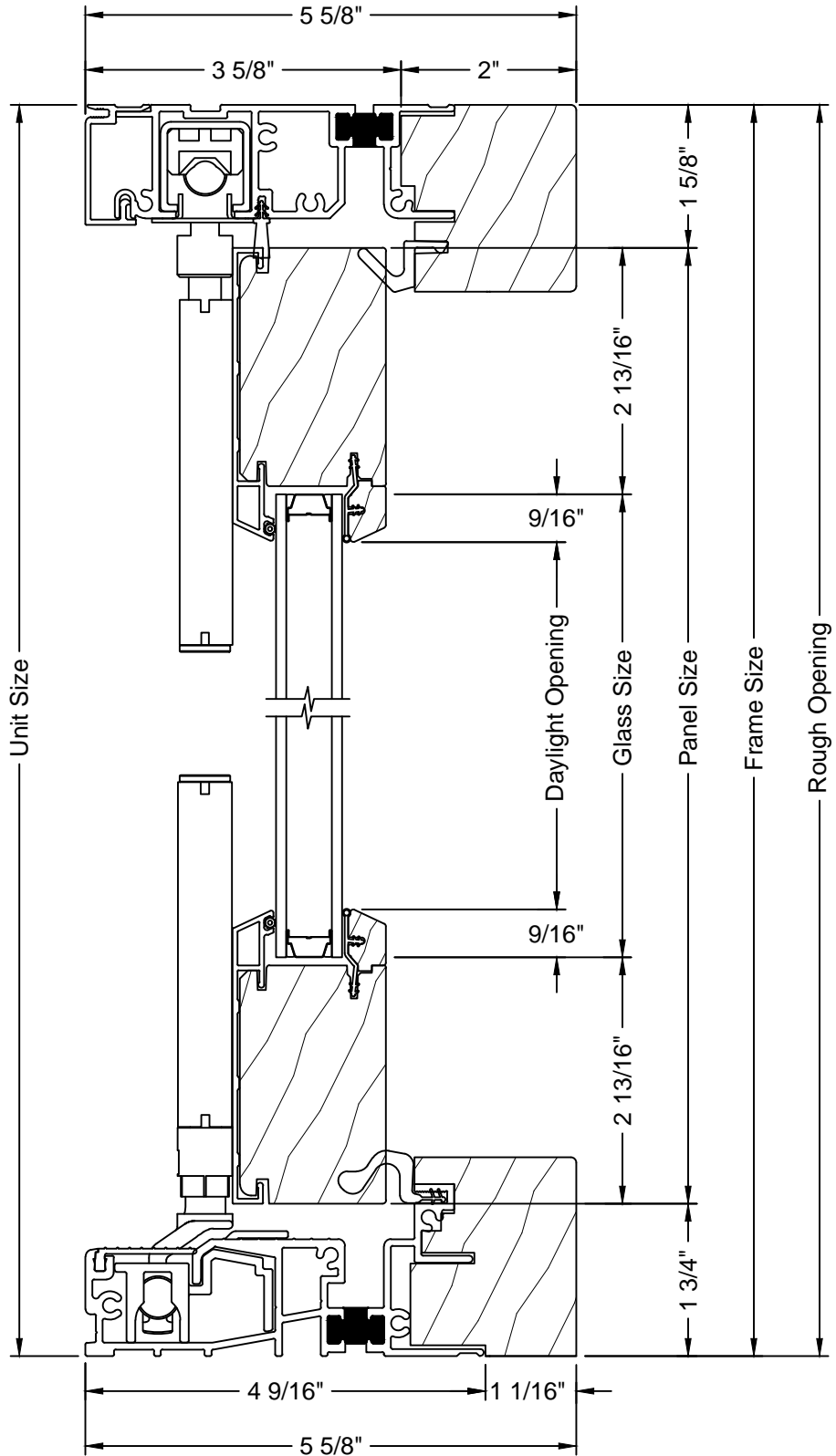



JAMB - HORIZONTAL SECTION

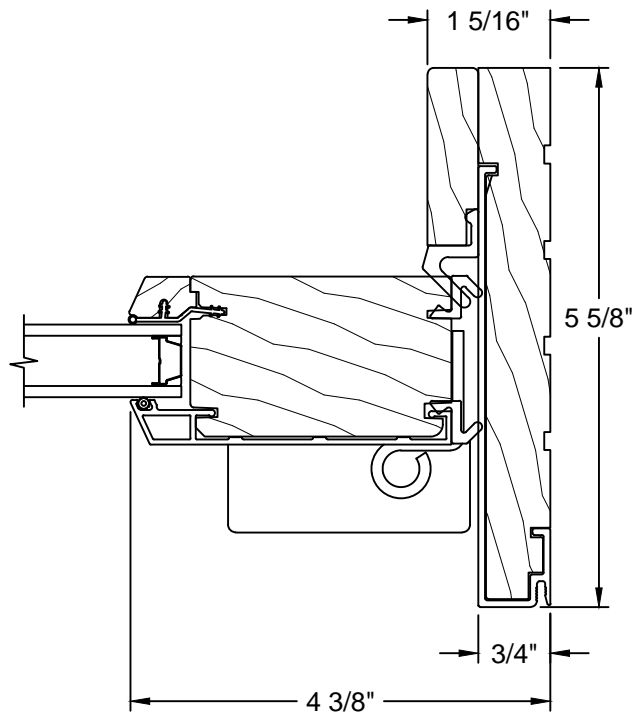



PANEL TO PANEL - HORIZONTAL SECTION

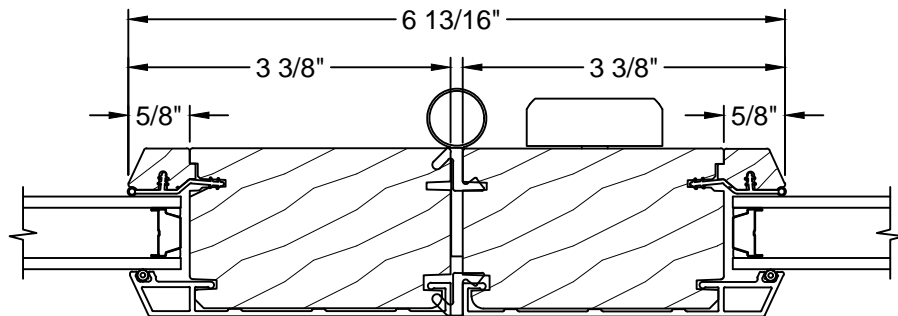



ASTRAGAL - HORIZONTAL SECTION

