

## PREPARATION

Tools Required for Assembly: (Not included)

- Pencil
- Electrical drill
- 1/4" Masonry drill bit (for tile anchor)
- Phillips head screwdriver
- Tape measure
- Level
- Safety glasses



## INSTALLATION INSTRUCTIONS

### Tiles

**CAUTION:** Tile anchors are for tile, granite, marble, cement surfaces only. Use drywall anchors for drywalls only.

1. Unscrew cap to reveal screw holes shown in **Fig.1**.
2. Hold the item up against desired position on wall, and mark the screw holes.  
Use a measuring tape and a level for accuracy.
3. Remove the item and drill pilot holes into the tiles where the tile anchors will be inserted using 1/4" Masonry drill bit.
4. Insert tile anchors into the hole.
5. Place the item over the tile anchors and place mounting kits in the order shown in **Fig.2**. Tighten screw, then tighten cap over the screw.

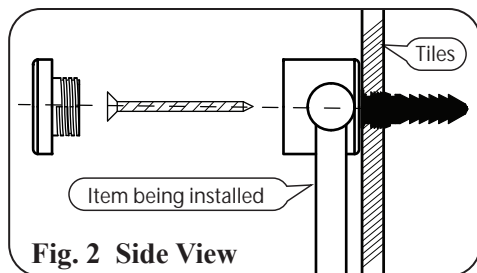
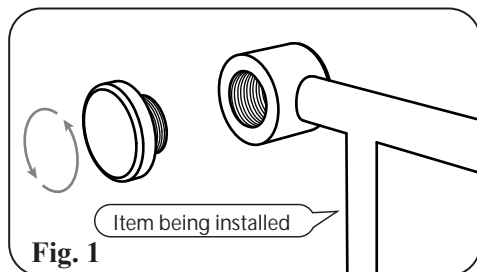

## Care and Maintenance

To maintain the beautiful luster finish, please use soft damp cloths when cleaning and never use any cleaning solvents.