



STEEL CORE

PARTS RACK WITH 24 REMOVABLE BINS

42797



**Actual product may vary slightly*

Please carefully read and save these instructions before attempting to assemble, maintain, install, or operate this product. Observe all safety information to protect yourself and others. Failure to observe the instructions may result in property damage and/or personal injury. Please keep instructions for future reference.

For warranty purchases, please keep your dated proof of purchase. File or attach to the manual for safe keeping.

SPECIFICATIONS

Weight Capacity	Per shelf	44 lb.
	Total	132 lb.

IMPORTANT SAFETY INFORMATION

ASSEMBLY PRECAUTIONS

1. Assemble only according to these instructions. Improper assembly can create hazards.
2. Wear ANSI-approved safety goggles and heavy-duty work gloves during assembly.
3. Keep assembly area clean and well lit.
4. Keep bystanders out of the area during assembly.
5. Do not assemble when tired or when under the influence of drugs or medication.
6. Weight capacity and other product capabilities apply to properly and completely assembled product only.
7. Place on stable, sturdy bench capable of supporting product's fully loaded weight.
Do not place near the bench's edge.

USE PRECAUTIONS

1. This product is not a toy. Do not allow children to play with or near this item.
2. Use as intended only.
3. Inspect before every use; do not use if parts are loose or damaged.
4. Maintain product labels and nameplates. These carry important safety information.
If unreadable or missing, contact FOT Tools for a replacement.

ASSEMBLY INSTRUCTIONS

Note: All parts are secured using Bolts, Nuts, and Washers (8), with the Bolts inserted from outside the rack. Only finger tighten Bolts and Nuts (8) until assembly is complete.

1. Using two bolts from the side and one bolt from the back, attach the Left Panel (1) to the Top (3) with the lip facing inside.
2. Repeat step 1 to attach the Right Panel (2) to the Top (3).
3. Attach a Back Brace (7) to the lowest hole on the back of each Panel (1,2).
4. Cross the Back Braces (7) and attach to the upper holes on the opposing Panels.
5. Place a Bracket (4) on each end of a Shelf (5). Align the Shelf and Brackets in place between the Panels, and secure two bolts each end.
6. Repeat step 5 for the other two Shelves.
7. Make sure the assembly rests level, then wrench tighten all Nuts and Bolts (8).
8. Place the Bins (6) onto the Shelves.

PARTS LIST AND DIAGRAM

Part	Description	Qty
1	Left Panel	1
2	Right Panel	1
3	Top	1
4	Bracket	6
5	Shelf	3
6	Bin	24
7	Back Brace	2
8	M6 x 12 Bolt-Nut-Washer Set	22

View from rear

View from front

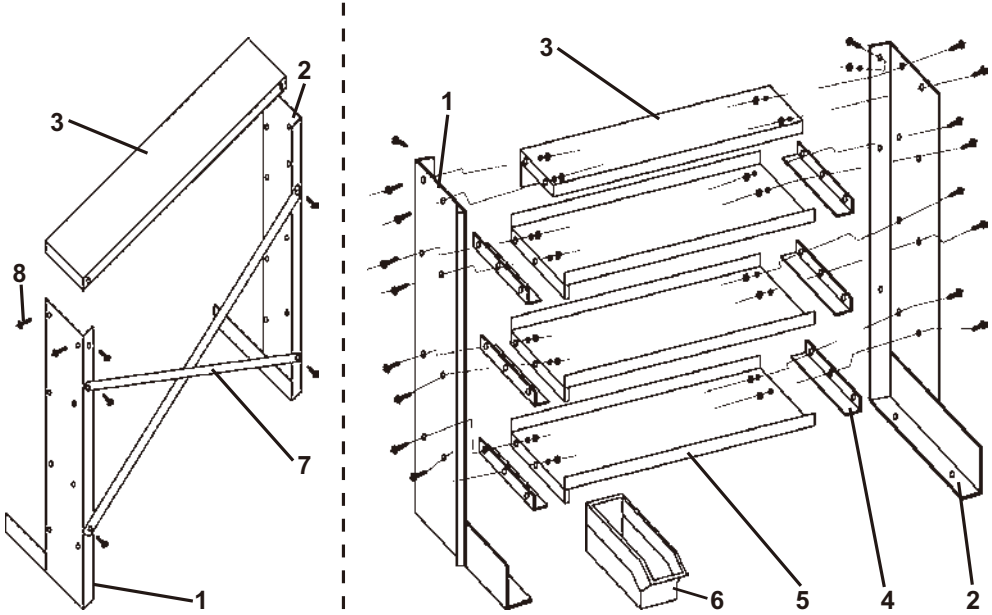

Limited Manufacturer Warranty

FOT makes every effort to ensure that this product meets high quality and durability standards. FOT warrants to the original retail consumer a 1-year limited warranty from the date the product was purchased at retail and each product is free from defects in materials. Warranty does not apply to defects due directly or indirectly to misuse, abuse, negligence or accidents, repairs or alterations, or a lack of maintenance. FOT shall in no event be liable for death, injuries to persons or property, or for incidental, special or consequential damages arising from the use of our products. To receive service under warranty, the original manufacturer part must be returned for examination by an authorized service center. Shipping and handling charges may apply. If a defect is found, FOT will either repair or replace the product at its discretion.

DO NOT RETURN TO STORE

For Customer Service:

Email: customerservice@focus-ontools.com or Call 1-800-348-5004