

SINCE 1839

**BRINLY**

SINCE 1839

**BRINLY**

# OWNER'S MANUAL

## ***PUSH/TOW POLY CART***

**MODEL:**

***PC-10 BH***

***PCT-10 BH***

- Assembly
- Installation
- Operation
- Repair Parts

For use with Riders  
and Lawn/Garden Tractors

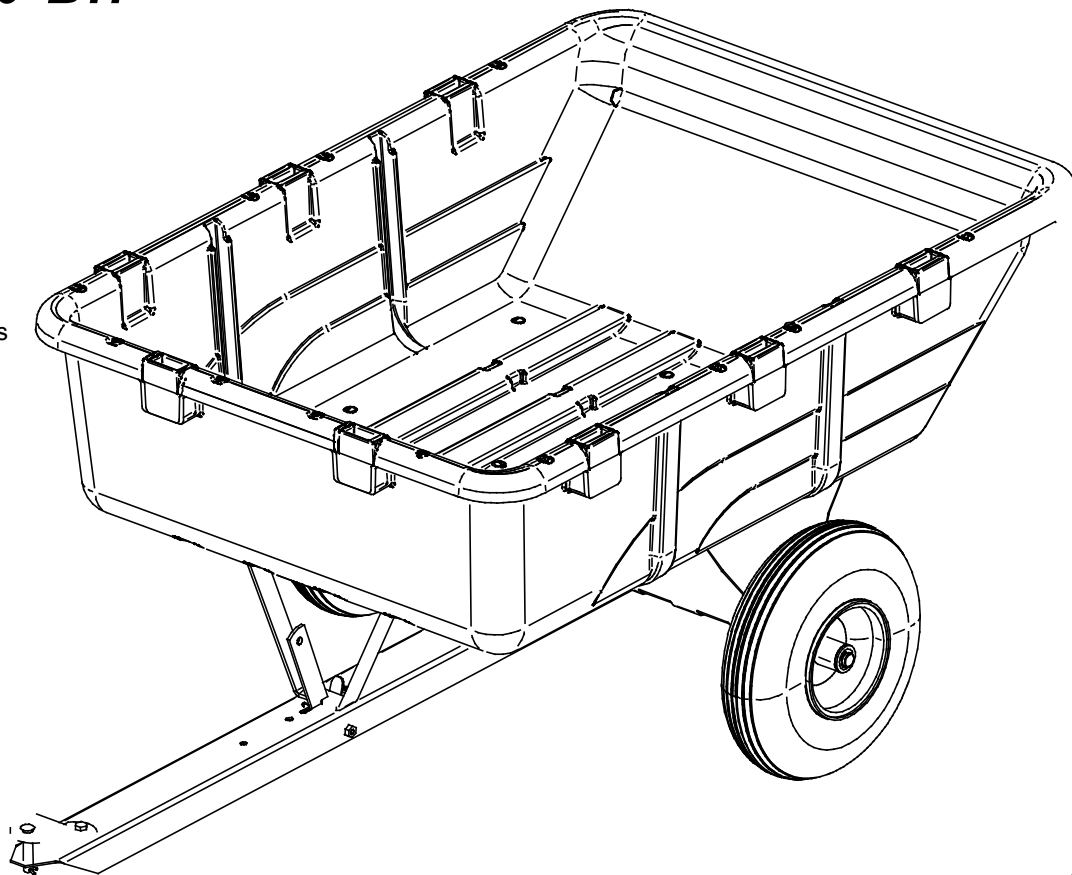

For the latest product updates and setup tips:

Visit us on the web!  
[www.brinly.com](http://www.brinly.com)

Important: This manual contains information for the safety of persons and property. Read it carefully before assembly and operation of the equipment!

L-1767-BH-01

CONGRATULATIONS on your new Brinly-Hardy Cart! Your Cart has been designed, engineered and manufactured to give you the best possible dependability and performance.

Should you experience any problem you can not easily remedy, please do not hesitate to contact our knowledgeable customer service department toll-free at 1-877-728-8224. We have competent, well trained technicians.

Please read and retain this manual. The instructions will enable you to assemble and maintain your cart properly. And please, always observe the "Safety Rules".

## CUSTOMER RESPONSIBILITIES \_\_\_\_\_

Read and Observe the "Safety Rules".

Follow a regular schedule in maintaining, caring-for and using your Brinly-Hardy Cart.

## TABLE OF CONTENTS \_\_\_\_\_

SAFETY RULES .....	2
PARTS REFERENCE .....	4
EXPLODED REFERENCE.....	5
ASSEMBLY .....	6-8
MAINTENANCE.....	3
OPERATION.....	3
WARRANTY.....	3

## RULES FOR SAFE OPERATION \_\_\_\_\_

- Know controls and how to stop quickly, READ THE OWNER'S MANUAL.
- Do not allow children to operate the vehicle, do not allow adults to operate without proper instruction or without having read the owner's manual.
- Do not carry passengers. Keep children and pets a safe distance away.
- Always wear substantial footwear. Do not wear loose fitting clothing that can get caught in moving parts.
- Keep your eyes and mind on your tractor/attachment and area being covered. Do not let other interests distract you.
- Stay alert for holes in the terrain and other hidden hazards.
- Do not drive close to creeks, ditches and public highways.
- Watch out for traffic when crossing or near roadways.
- When using any attachment, don't allow anyone near the vehicle while in operation.

- Keep the vehicle and attachment in good operating condition and keep safety devices in place.
- Keep all nuts, bolts and screws tight to be sure the equipment is in safe working condition.
- The vehicle and attachment should be stopped and inspected for damage after striking a foreign object. The damage should be repaired before restarting and operating the equipment.
- See tractor equipment owner's manual for safe operation of the equipment.
- Use correct number of weights on tractor. The weight of the tractor and operator **MUST BE MORE** than the weight of the cart and load.
- When backing - carefully back straight to avoid jack knifing, which could result in damage to equipment.
- Maximum load is 650 lbs.
- **DO NOT** tow this cart behind a motor vehicle.(Car, Truck, ATV) Max speed 5 mph.
- Maintain cart tires inflated to 30 psi.



## OPERATING HINTS \_\_\_\_\_

To Dump load:

1. Stop the tractor, lock the parking brake and stop the engine.
2. Release the lock bar and raise the handle carefully to tilt the bed to the full dump position.



This symbol will help to point out important safety precautions throughout this manual. It means - ATTENTION! BECOME ALERT! Your safety is involved.

## MAINTENANCE

The key to years of trouble-free service is to keep your Cart clean and dry.

Unauthorized modifications to the cart may impair its function and safety.

Occasionally check all moving parts for free movement and, if necessary, lubricate with oil.

Should rust develop, sand lightly and then paint area with enamel.

Periodically check all fasteners for tightness.

## SAFETY TIPS:

Avoid tipping and skidding.

Weight of tractor and operator **MUST BE MORE** than weight of cart and load.

Use correct number of weights on tractor. If additional weight is required, add this weight at or forward of the rear wheels. Additional weight rearward of rear wheels causes a negative affect on vehicle steering.

A unsafe load on dry, level ground may cause the tractor to lose traction and skid on slippery or sloped ground.

**DO NOT** use cart near edges of ditch or bank or other steep angle.

Avoid holes, rocks and roots.

Slow down before you turn.

**DO NOT** make a sharp turns that cause tractor tires to rub cart drawbar.

**DO NOT** tow cart with box raised.

## OPERATION:

Avoid over filling Cart, it can cause tractor to lose traction and skid. The tractor and operator combined weight **MUST BE** more than loaded cart weight for **PROPER** towing and braking.

Extremely heavy loads will be difficult to dump. Fill to capacity that is comfortable for you to dump.

When backing up, carefully back **STRAIGHT** to avoid "jack-knifing", which can cause damage to your equipment.

## KEEP RIDERS OFF CART

Keep riders out of cart.

Riders in cart are subject to injury, such as being struck by objects and being thrown off the cart during sudden starts, stops and turns.

Riders obstruct the operator's view, resulting in the cart being used in an unsafe manner.

## IMPORTANT:

Check tire pressure. Inflate to 30 P.S.I.

### Limited Warranty

Brinly-Hardy Company warrants only to the original retail purchaser that this product will remain free of defects in workmanship and materials under normal use and service for a period of two (2) years (NOTE: ninety (90) days for commercial or rental use) commencing with the date of purchase.

Any parts found to be defective within the warranty period will be replaced, with proof of date of purchase, at Brinly-Hardy Company's expense. Our obligation under this warranty is expressly limited to replacement or repair, at our option of parts, which are defective in material or workmanship within thirty (30) days of receipt of the parts. This warranty does not apply to damage caused by unreasonable use, including failure to provide necessary maintenance, nor does it apply to any transportation or labor charges.

WE MAKE NO OTHER EXPRESS WARRANTY NOR IS ANYONE AUTHORIZED TO MAKE ANY ON OUR BEHALF. ANY IMPLIED OR STATUTORY WARRANTIES, INCLUDING ANY WARRANTY OF MERCHANTABILITY OR FITNESS FOR A PARTICULAR PURPOSE, ARE LIMITED TO THE DURATION OF THIS WRITTEN WARRANTY. WE SHALL NOT BE LIABLE FOR CONSEQUENTIAL OR INCIDENTAL DAMAGES OF ANY KIND.

MADE IN THE U.S.A.  
BRINLY-HARDY COMPANY TOLL-FREE 1-877-728-8224

### Tools Required for Assembly:

- \*  $\frac{1}{2}$ " wrench (2)
- \*  $\frac{9}{16}$ " wrench (2)
- \* Pliers
- \* Flat Head Screwdriver

**PCT-10 BH**

REF. NO.	QTY.	PART NO.	DESCRIPTION
1	1	B-3034-10	Clevis
2	1	B-3308-10	Axle Support
3	1	B-3520-10	Lock Bracket
4	1	B-4261	Axle
5	2	B-4600	Wheel Assembly
6	1	B-6603-BH	Poly Bed
7	1	B-6296-10	Towbar
11	1	B-6288-10	Lock Bar
13	12	20M1016P	5/16" x 1" RD HD Mach. Screw
16	12	30M1000P	5/16"-18 Reg Hex Nut
18	12	40M1000P	5/16" Med Lock Washer
20	10	45M1111P	5/16" SAE Flat Washer
21	1	B-1675P	3/8"-16 Hex Lock Nut
22	1	B-3861	Hitch Pin (1/2" Dia. x 2-1/2)
23	2	B-4305	Retaining Ring, 3/4" E-Type
25	4	B-5606	3/4" Mach. Bushing
27	1	B-6298	Hex Bolt, 3/8" x 3-3/4" Full Thr.
28	2	B-6299	3/8"-16 Keps Nut
29	1	B-6300	Latch Spring
31	1	D-146P	Hair Pin Cotter 1/8"
*32	2	B-4421	Spacers
33	1	B-5482	Decal-Caution

To Order Parts Call:  
877-728-8224

Visit us on the web:  
[www.brinly.com](http://www.brinly.com)

**PC-10 BH**

REF. NO.	QTY.	PART NO.	DESCRIPTION
1	1	B-3034-10	Clevis
2	1	B-3308-10	Axle Support
3	1	B-3520-10	Lock Bracket
4	1	B-4261	Axle
5	2	B-4600	Wheel Assembly
6	1	B-6218-BH	Poly Bed
7	1	B-6219-10	Towbar, Rear
8	1	B-6220-10	Towbar, Front
9	1	B-6221-10	Stand
10	1	B-6223-10	Handle, Cart
11	1	B-6288-10	Lock Bar
12	4	20M0832P	1/4" x 2" RD HD Mach. Screw
13	10	20M1016P	5/16" x 1" RD HD Mach. Screw
14	4	2M1012P	5/16"-18 x 3/4" Hex Bolt
15	4	30M0800P	1/4"-20 Reg Hex Nut
16	10	30M1000P	5/16"-18 Reg Hex Nut
17	4	40M0800P	1/4" Med Lock Washer
18	10	40M1000P	5/16" Med Lock Washer
19	4	45M0909P	1/4" SAE Flat Washer
20	10	45M1111P	5/16" SAE Flat Washer
21	1	B-1675P	3/8"-16 Hex Lock Nut
22	1	B-3861	Hitch Pin (1/2" Dia. x 2-1/2)
23	2	B-4305	Retaining Ring, 3/4" E-Type
24	4	B-4786	5/16"-18 Nylon Lock Nut
25	4	B-5606	3/4" Mach. Bushing
26	1	B-5931	Clevis Pin, 5/16" Dia. x 3-1/2"
27	1	B-6298	Hex Bolt, 3/8" x 3-3/4" Full Thr.
28	2	B-6299	3/8"-16 Keps Nut
29	1	B-6300	Latch Spring
30	1	B-983	Hairpin Cotter, .08
31	1	D-146P	Hair Pin Cotter 1/8"
32	2	B-4421	Spacers
33	1	B-5482	Decal-Caution



**EXPLODED REFERENCE**

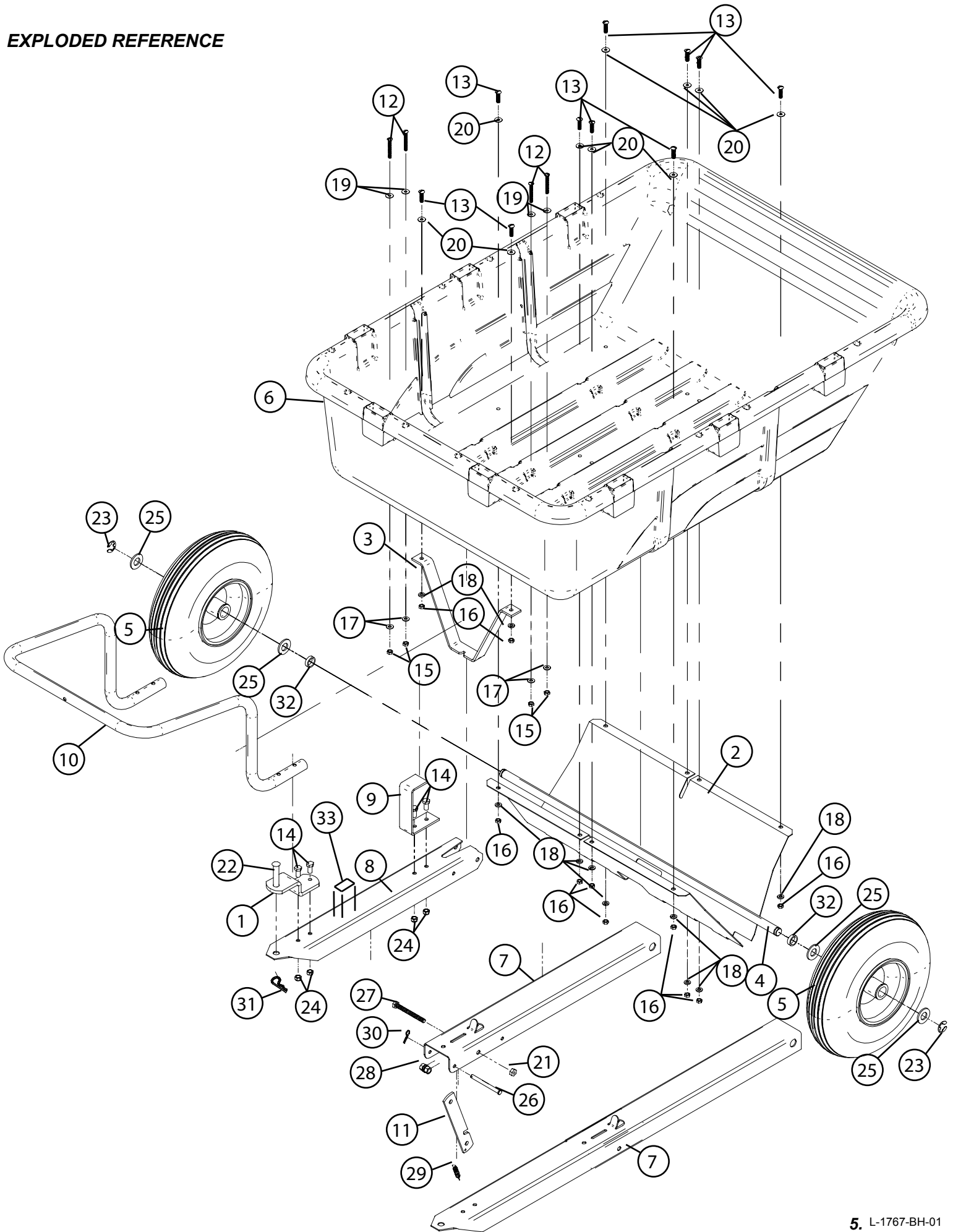

**Step 1.**

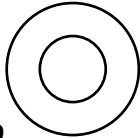
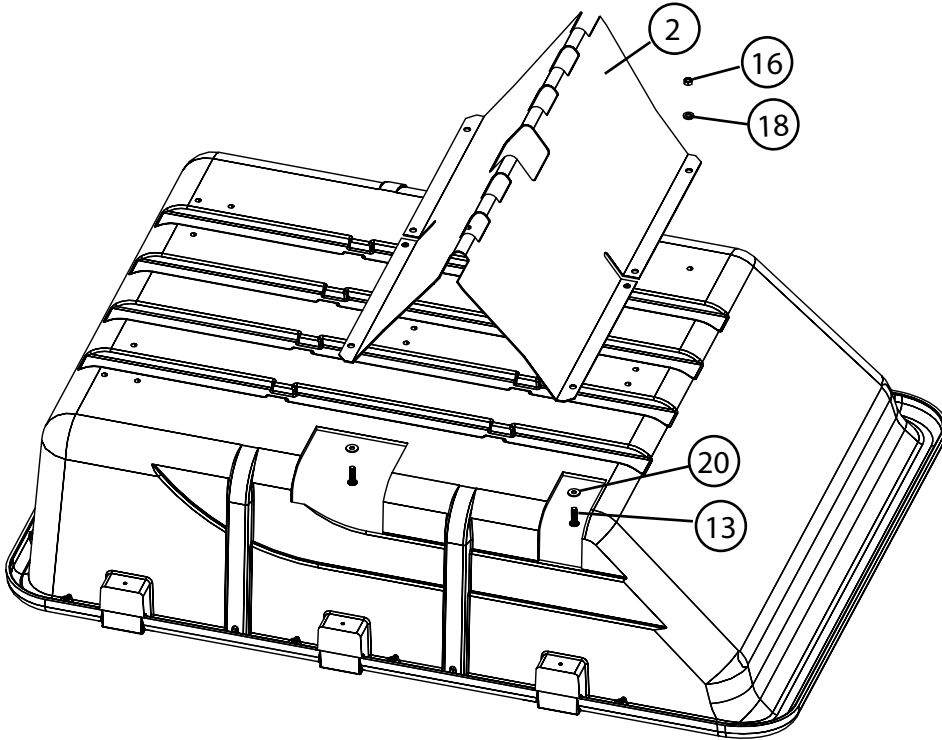

**20**  
Flat Washer, 5/16"  
Qty. 8

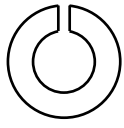

**18**  
Lock Washer, 5/16"  
Qty. 8



**16**  
Hex Nut, 5/16"  
Qty. 8

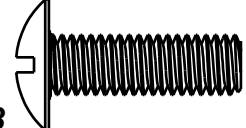

**13**  
Round Head Screw, 5/16" x 1"  
Qty. 8

**Step 2.**

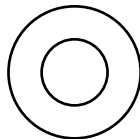
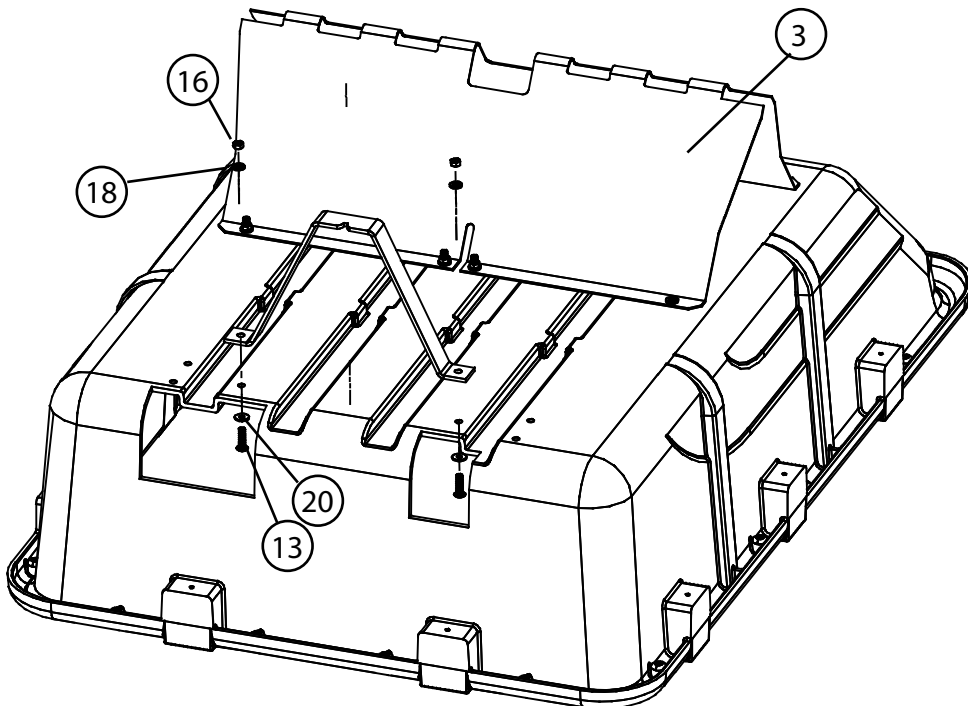

**20**  
Flat Washer, 5/16"  
Qty. 2

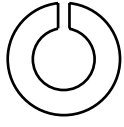

**18**  
Lock Washer, 5/16"  
Qty. 2

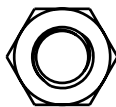

**16**  
Hex Nut, 5/16"  
Qty. 2

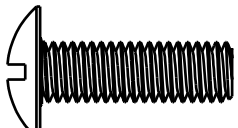

**13**  
Round Head Screw, 5/16" x 1"  
Qty. 2

**Step 3A. For the PC-10 Cart Only!**

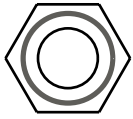

**21**  
Lock Nut, 3/8"  
Qty. 1

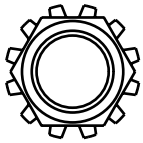

**28**  
Keps Nut, 3/8"  
Qty. 2

**27**  
Hex Bolt, 3/8" x 3-3/4"  
Qty. 1

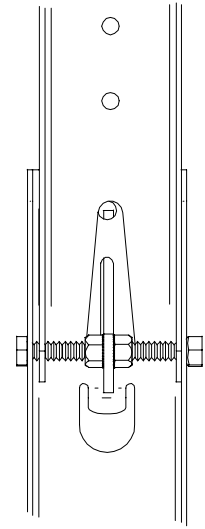
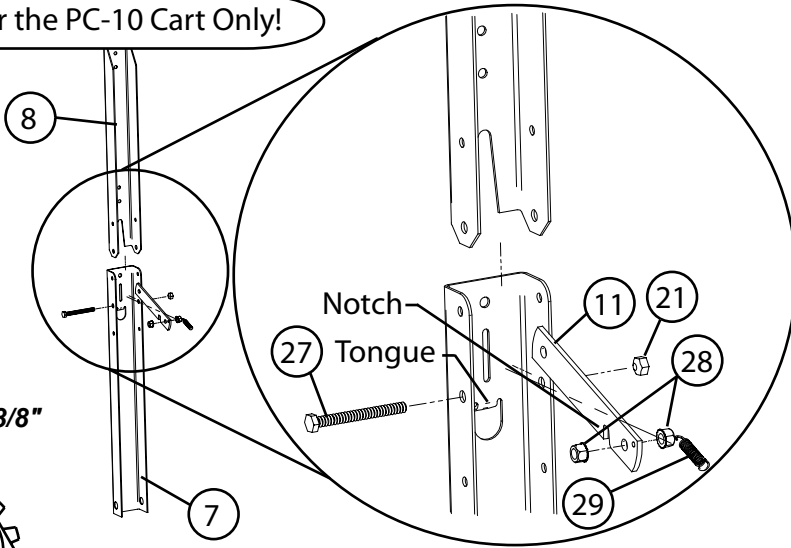
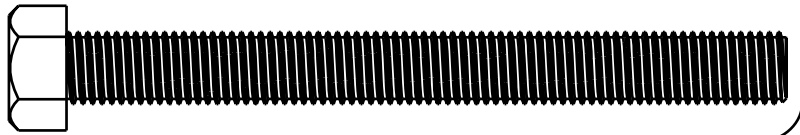

**Step 3B. For the PCT-10 Cart Only!**



**21**  
Lock Nut, 3/8"  
Qty. 1

**28**  
Keps Nut, 3/8"  
Qty. 2

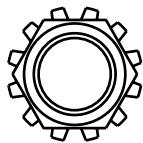

**27**  
Hex Bolt, 3/8" x 3-3/4"  
Qty. 1

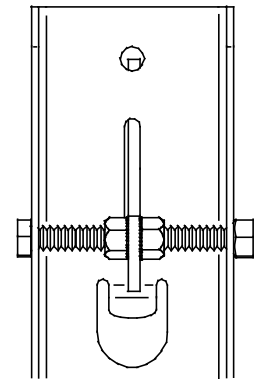
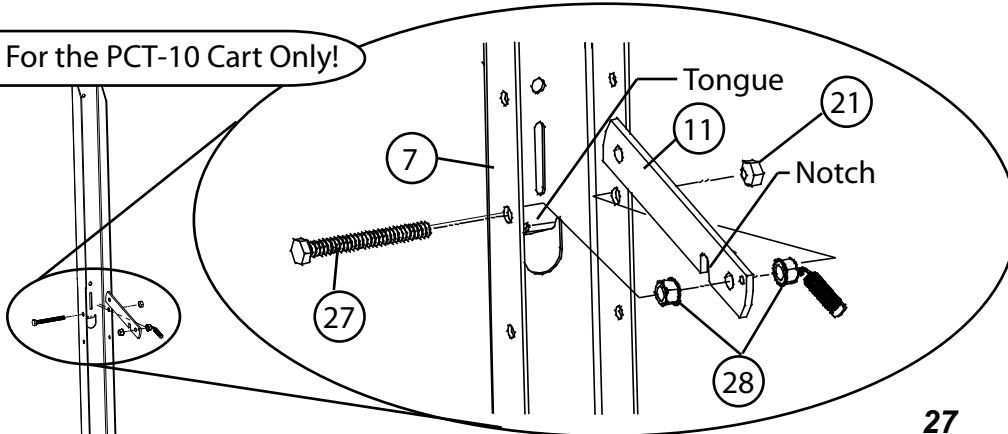
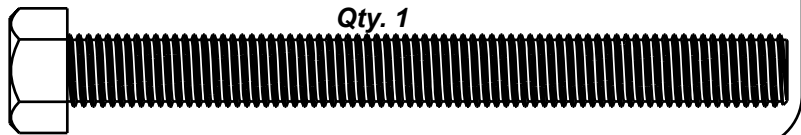

**Step 4.**

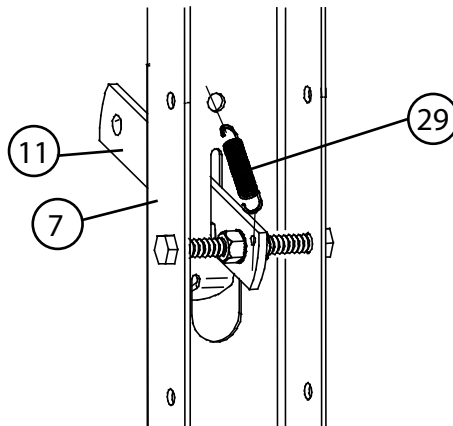

**29**  
Latch Spring  
Qty. 1

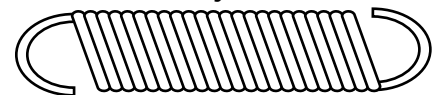

**Step 5.**

**NOTE:** For PC-10 only!

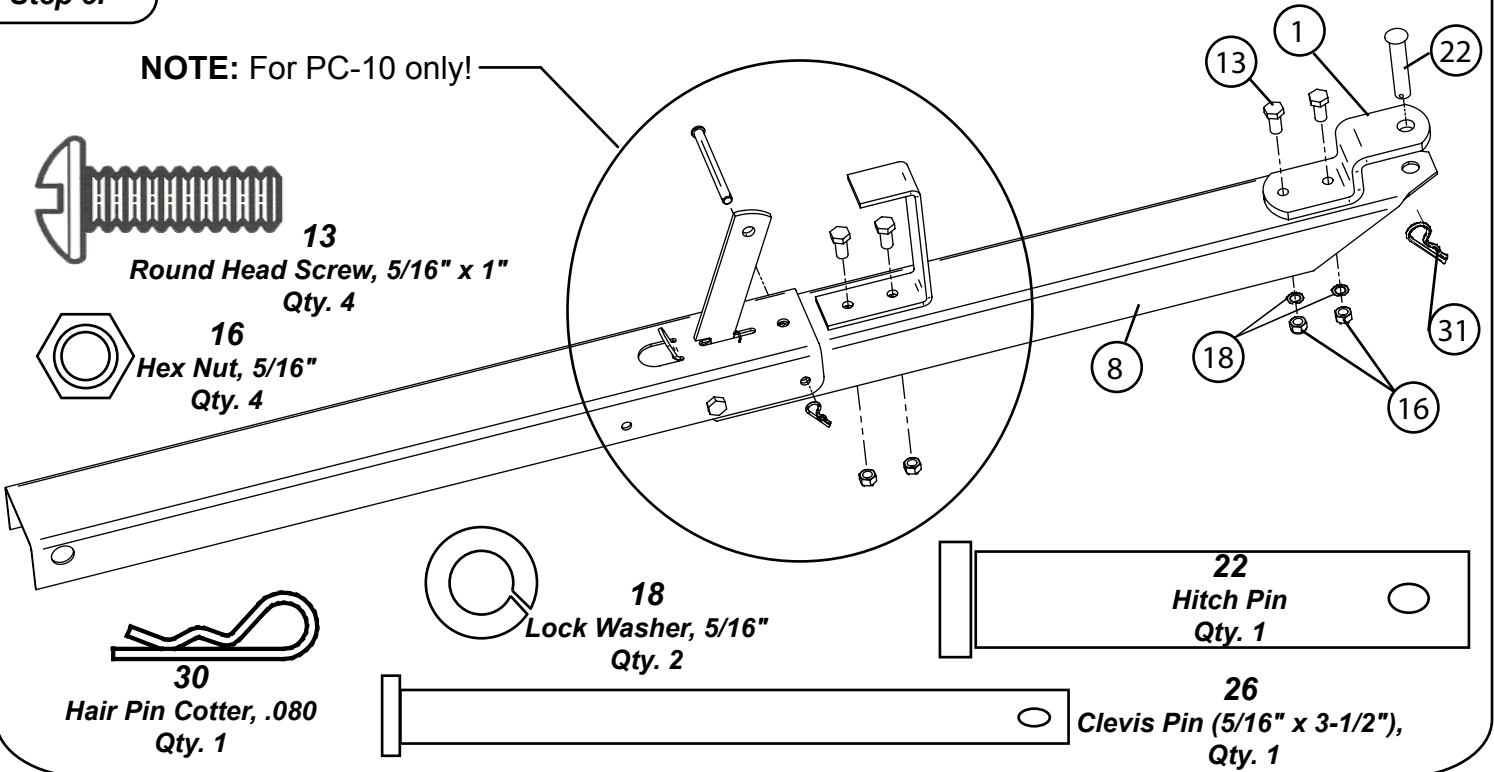

**Step 6.**

