

Before you begin, please read this manual completely so that you will have a good understanding of the sequence of events.

Please follow all the safety instructions for tools and procedures.

Got questions?

Customer Service:
1-866-373-9131

Monday - Saturday
9:00AM - 6:00PM EST

Email us at:
designservices@hdcclosets.com

wall prep

Note: Attachment to any other surface material such as metal studs, concrete block, brick, stucco or poured concrete require special fasteners. Consult with your local Home Depot store or installation specialist for recommended fasteners.

TOOLS & MATERIALS REQUIRED

Tape measure

Pencil

Level

Stud Finder

Hammer

Screw Driver #2 Flat Head and #2 Phillips

#10 x 3" Pan Head Screws

#8 x 1 1/4" Pan Head Screws

Cordless Drill – to pre-drill cabinets and mount to wall and to each other

3/16", 3/32" Drill bits

Hacksaw – to cut 48" Closet Rods to size (if needed)

Circular Saw – to cut 48" Furniture shelves to size (if needed)

Toggle bolts - if you are unable to hit a stud behind the drywall

INSTALLATION STEPS FOR WALLS WITH WOOD STUDS

1. Before you begin, make sure that your wall is smooth and plumb – remove any obstructions such as old closet organizers, cabinets or baseboards that may interfere with the installation.
2. By using your tape measure and level mark the locations of your base cabinets on the wall. Plan accordingly to make sure drawers will open fully without obstruction!
3. Use your stud finder to locate the studs in your wall – mark either side of the stud and the center point, to show where you need to hit with your installation screws. If necessary adjust the location of you cabinets slightly to enable you to hit the required studs easily.

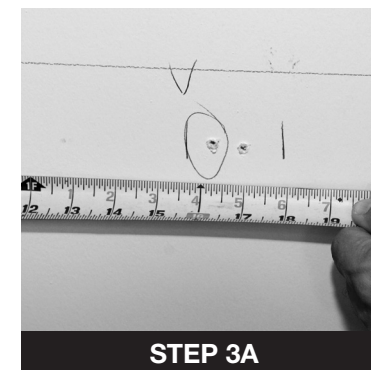
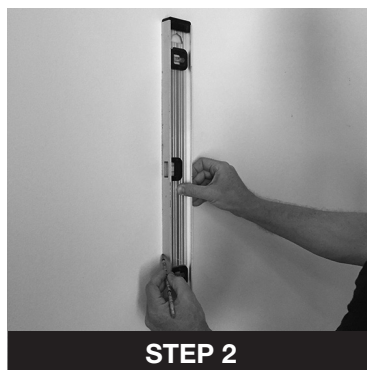

24 in. Base Cabinet installation



4. Before you start, make sure the cabinets are empty.
5. Measure the distance from the outer edge of the first base cabinet to the center of the studs you wish to attach to.
6. Transfer these measurements to the horizontal installation rail, along the back of the base cabinet.

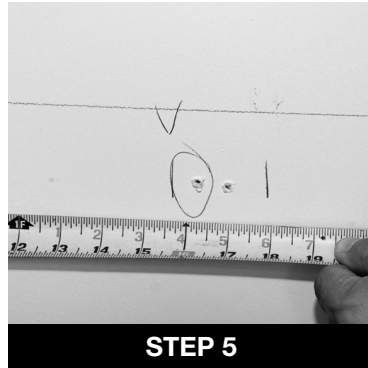

STEP 5



STEP 6



STEP 7

7. Drill pilot holes thru the horizontal installation rail with a 3/32" drill bit. NOTE: If you can only hit one stud, use a drywall toggle bolt to create a second attachment point (consult your local Home Depot store for the correct toggle for your wall construction).
**BASE CABINETS MUST HAVE TWO ATTACHMENT POINTS!



STEP 8A



STEP 8B



STEP 9

8. Attach base cabinet thru the drywall and into the studs using #10 x 3" pan head screws. Check that it's level and shim if necessary. (DO NOT FULLY TIGHTEN! Double check for shim and level and adjust if needed).
9. Using a 3/32" bit, drill (3) attachment pilot holes in the top of the Base Cabinet if you are placing a Wall Cabinet on top. Drill one hole on the left and right side, near the front edge. Drill one hole, centered near the back, .

24 in. Wall Cabinet installation

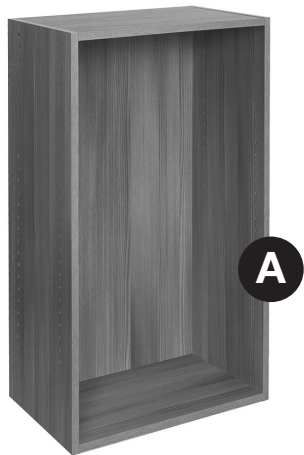

1. Place the Wall Cabinet on the Base Cabinet and mark the sides and top of the Wall Cabinet on the drywall, remove the Wall Cabinet.
2. Locate your stud markings on the wall and mark the center of each stud approximately 3" from the top and bottom of the Wall Cabinet placement.
3. Transfer these measurements to the two horizontal installation rails, along the back of the Wall Cabinet at top and bottom.
4. Drill (4) mounting holes thru the installation rails top and bottom of wall cabinet with a 3/32" drill bit.



NOTE: If you can only find one stud, use a drywall toggle bolt to create a second attachment point. (Consult your local Home Depot store for the correct toggle for your wall construction).

****WALL CABINET MUST HAVE
FOUR ATTACHMENT POINTS!**

5. Now place the wall cabinet on top of the base cabinet. Align and level – hold in place with “Quick Grips” or C-clamps.
6. Attach Base Cabinet to Wall Cabinet thru the pilot hole, using #8 x 1¼" pan head screws.
7. Attach the Wall Cabinet thru the drywall and into the wood studs using #10 x 3" pan head screws or install drywall toggle bolt if necessary - DO NOT FULLY TIGHTEN! Check the level and adjust as needed. Once you are happy with the alignment and level of the two cabinets, fully tighten all the attachment screws.

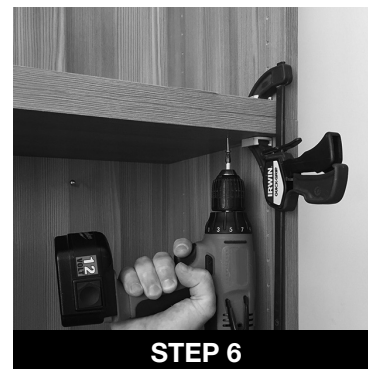

48 in. Closet Shelf and Rod installation

1. The two mounting rails with the 48 in. Shelf can be installed to the outside of the cabinets, or directly to the drywall of the closet space.

The mounting rails have two specific purposes:

 - a. They are pre-drilled to accept the Closet Rod Brackets which hold the closet rod in place
 - b. They also support the 48 in. Shelf above the Closet Rod
2. Decide on the location of your Closet Shelf. If you want it to align with the top of the wall cabinet, set the Mounting Rails $\frac{3}{4}$ " down from the top edge of the wall cabinet (as shown).
3. Use a level to mark a line where the top edge of the Mounting Rail will be located. Pre-drill two holes thru the side of the adjacent cabinet to attach the Mounting Rail.
4. With the pre-drilled holes through the cabinet, attach the Mounting Rails using (2) #8 x $1\frac{1}{4}$ " pan head screws provided.
5. Alternatively, mark the location of the second Mounting Rail on the side drywall of the closet space, and drill two attachment holes thru the Mounting Rail using $\frac{3}{32}$ " drill bit. Place the Mounting Rail on the drywall and mark the attachment points on the wall. If you are installing the second Mounting Rail into another cabinet, simply repeat Step 2-4.
6. Screw the Mounting Rail in place using a suitable drywall fastener (consult your local Home Depot store for the proper Screws and anchors for your wall construction)
7. Once the Mounting Rails are installed, you can set your Shelf and attach the Closet Rod Brackets (optional).
8. Cut the Closet Rod with a hacksaw, to fit the Closet Rod Brackets.



Attaching decorative hardware

Do not drill holes until you have determined the dimensions match the decorative hardware you have selected. Make sure any drawer front alignments are done prior to drilling them for pulls or knobs - once the decorative hardware is installed it will be difficult to adjust the drawer fronts.

1. Clamp a piece of wood to the front side of the drawer front, at handle location
2. From the inside of the drawer use a $\frac{3}{16}$ " drill bit and be sure to drill completely through the drawer front into the block this allow for a clear hole. Push the bolt through the hole and apply the hardware. Tighten with a screwdriver.

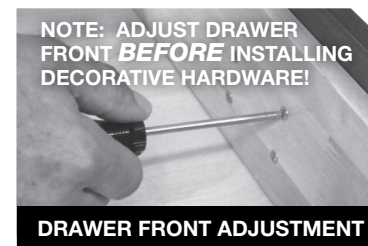

If additional adjustment is required, loosen screws and twist drawer front for proper alignment. Tighten screws securely.