

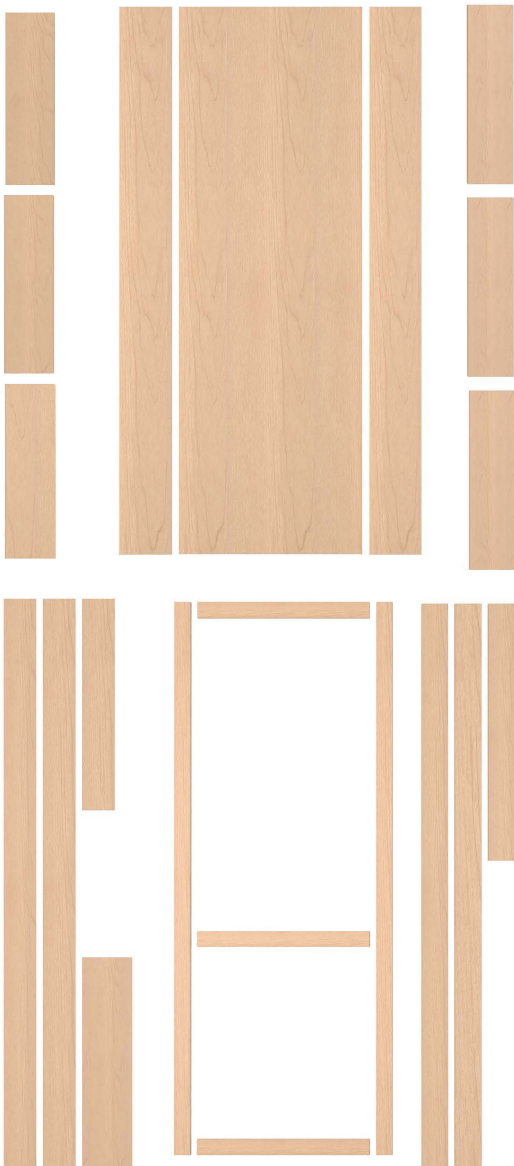

**MURPHY DOOR**<sup>™</sup>  
CREATIVE DOOR SOLUTIONS

# FLUSH MOUNT HARDWARE KIT DIY INSTRUCTIONS



## 36"x82" Murphy Door Material List

Quantity	Material
1	4' x 8' x 3/4" Sheet (use good material for bookcase)
1	4' x 8' x 1/2" Sheet (use good material for back)
	Edge Banding as desired
20'	3/4" x 4" Trim Materials
1	3/4" x 8" x Door Width
16.5	4 9/16" x 3/4" Stock for Jamb
24'	2 1/4" Stock for Face Frame
1 Box	Brad Nails for Face Frame and Trim
1 1/2" Screws (1 bag)	Screws for Back
1	Kreg Tool: Fasten sides of bookcase to top, middle, lower shelves if you do not want to see fasteners
1	Bottle Wood Glue

NOTE: ALL measurements are for building a bookcase with kreg screws and fastening the back to the back of rails. There are no calculations for doors with mortised or dadoed back set.

## 36" Flush Mount Bookcase Cut List

Name	Qty	Measurement	Material
<b>Face Frame</b>			
Sides	2	2 1/4" x 78 1/2"	
Top, Middle, Bottom	3	2 1/4" x 30 1/4"	
<b>Door Jamb (3/4" stock)</b>			
Sides	2	4 9/16" x 80 7/8"	
Top	1	4 9/16" x 36"	
Bottom	1	7" x 36"	
<b>Trim (3/4" stock)</b>			
Sides	2	3 3/4" x 80 1/8"	
Top	1	3 3/4" x 42 1/2"	
<b>Bookcase</b>			
Sides (3/4" stock)	2	7 1/2" x 77 3/4" x 3/4"	
Top, Middle, Bottom (3/4" stock)	5	7 1/2" x 31 1/4" x 3/4"	NOTE: Top and Bottom are double thick
Back (1/2" stock)	1	32 3/4" x 77 3/4" x 1/2"	NOTE: Back is 3 1/4" smaller than door jamb

NOTE: These measurements are for a standard Murphy Door bookcase with an 8" overall depth. Murphy Door does not offer any assistance on custom doors or changes to our measurements, including but not limited to hinge layout. All custom changes are the responsibility of the customer. Do not contact Murphy Door for assistance if these measurements have been changed or you are doing a custom build.

**DISCLAIMER:** These measurements are provided only as a guide and Murphy Door is not responsible for any issues arising from incorrect measurements or if the listed measurements do not work. It is the responsibility of the customer to verify all measurements before making any purchases, cuts or assembly. By purchasing and using the Murphy Door hardware the customer is agreeing to all listed terms & conditions.

**Terms & Conditions:** <https://www.themurphydoor.com/store/terms-and-conditions/>

## 34"x82" Murphy Door Material List

Quantity	Material
1	4' x 8' x 3/4" Sheet (use good material for bookcase)
1	4' x 8' x 1/2" Sheet (use good material for back)
	Edge Banding as desired
20'	3/4" x 4" Trim Materials
1	3/4" x 8" x Door Width
16.5	4 9/16" x 3/4" Stock for Jamb
24'	2 1/4" Stock for Face Frame
1 Box	Brad Nails for Face Frame and Trim
1 1/2" Screws (1 bag)	Screws for Back
1	Kreg Tool: Fasten sides of bookcase to top, middle, lower shelves if you do not want to see fasteners
1	Bottle Wood Glue

NOTE: ALL measurements are for building a bookcase with kreg screws and fastening the back to the back of rails. There are no calculations for doors with mortised or dadoed back set.

## 34" Flush Mount Bookcase Cut List

Name	Qty	Measurement	Material
<b>Face Frame</b>			
Sides	2	2 1/4" x 78 1/2"	
Top, Middle, Bottom	3	2 1/4" x 28 1/4"	
<b>Door Jamb (3/4" stock)</b>			
Sides	2	4 9/16" x 80 7/8"	
Top	1	4 9/16" x 34"	
Bottom	1	7" x 34"	
<b>Trim (3/4" stock)</b>			
Sides	2	3 3/4" x 80 1/8"	
Top	1	3 3/4" x 40 1/2"	
<b>Bookcase</b>			
Sides (3/4" stock)	2	7 1/2" x 77 3/4" x 3/4"	
Top, Middle, Bottom (3/4" stock)	5	7 1/2" x 29 1/4" x 3/4"	NOTE: Top and Bottom are double thick
Back (1/2" stock)	1	30 3/4" x 77 3/4" x 1/2"	NOTE: Back is 3 1/4" smaller than door jamb

NOTE: These measurements are for a standard Murphy Door bookcase with an 8" overall depth. Murphy Door does not offer any assistance on custom doors or changes to our measurements, including but not limited to hinge layout. All custom changes are the responsibility of the customer. Do not contact Murphy Door for assistance if these measurements have been changed or you are doing a custom build.

**DISCLAIMER:** These measurements are provided only as a guide and Murpy Door is not responsible for any issues arising from incorrect measurements or if the listed measurements do not work. It is the responsibility of the customer to verify all measurements before making any purchases, cuts or assembly. By purchasing and using the Murphy Door hardware the customer is agreeing too all listed terms & conditions.

**Terms & Conditions:** <https://www.themurphydoor.com/store/terms-and-conditions/>

## 32"x82" Murphy Door Material List

Quantity	Material
1	4' x 8' x 3/4" Sheet (use good material for bookcase)
1	4' x 8' x 1/2" Sheet (use good material for back)
	Edge Banding as desired
20'	3/4" x 4" Trim Materials
1	3/4" x 8" x Door Width
16.5	4 9/16" x 3/4" Stock for Jamb
24'	2 1/4" Stock for Face Frame
1 Box	Brad Nails for Face Frame and Trim
1 1/2" Screws (1 bag)	Screws for Back
1	Kreg Tool: Fasten sides of bookcase to top, middle, lower shelves if you do not want to see fasteners
1	Bottle Wood Glue

NOTE: ALL measurements are for building a bookcase with kreg screws and fastening the back to the back of rails. There are no calculations for doors with mortised or dadoed back set.

## 32" Flush Mount Bookcase Cut List

Name	Qty	Measurement	Material
<b>Face Frame</b>			
Sides	2	2 1/4" x 78 1/2"	
Top, Middle, Bottom	3	2 1/4" x 26 1/4"	
<b>Door Jamb (3/4" stock)</b>			
Sides	2	4 9/16" x 80 7/8"	
Top	1	4 9/16" x 32"	
Bottom	1	7" x 32"	
<b>Trim (3/4" stock)</b>			
Sides	2	3 3/4" x 80 1/8"	
Top	1	3 3/4" x 38 1/2"	
<b>Bookcase</b>			
Sides (3/4" stock)	2	7 1/2" x 77 3/4" x 3/4"	
Top, Middle, Bottom (3/4" stock)	5	7 1/2" x 27 1/4" x 3/4"	NOTE: Top and Bottom are double thick
Back (1/2" stock)	1	28 3/4" x 77 3/4" x 1/2"	NOTE: Back is 3 1/4" smaller than door jamb

NOTE: These measurements are for a standard Murphy Door bookcase with an 8" overall depth. Murphy Door does not offer any assistance on custom doors or changes to our measurements, including but not limited to hinge layout. All custom changes are the responsibility of the customer. Do not contact Murphy Door for assistance if these measurements have been changed or you are doing a custom build.

**DISCLAIMER:** These measurements are provided only as a guide and Murphy Door is not responsible for any issues arising from incorrect measurements or if the listed measurements do not work. It is the responsibility of the customer to verify all measurements before making any purchases, cuts or assembly. By purchasing and using the Murphy Door hardware the customer is agreeing to all listed terms & conditions.

**Terms & Conditions:** <https://www.themurphydoor.com/store/terms-and-conditions/>

## 30"x82" Murphy Door Material List

Quantity	Material
1	4' x 8' x ¾" Sheet (use good material for bookcase)
1	4' x 8' x ½" Sheet (use good material for back)
	Edge Banding as desired
20'	¾" x 4" Trim Materials
1	¾" x 8" x Door Width
16.5	4 ⅞" x ¾" Stock for Jamb
24'	2 1/4" Stock for Face Frame
1 Box	Brad Nails for Face Frame and Trim
1 ½" Screws (1 bag)	Screws for Back
1	Kreg Tool: Fasten sides of bookcase to top, middle, lower shelves if you do not want to see fasteners
1	Bottle Wood Glue

NOTE: ALL measurements are for building a bookcase with kreg screws and fastening the back to the back of rails. There are no calculations for doors with mortised or dadoed back set.

## 30" Flush Mount Bookcase Cut List

Name	Qty	Measurement	Material
<b>Face Frame</b>			
Sides	2	2 ¼" x 78 ½"	
Top, Middle, Bottom	3	2 ¼" x 24 ¼"	
<b>Door Jamb (¾" stock)</b>			
Sides	2	4 ⅞" x 80 ⅞"	
Top	1	4 ⅞" x 30"	
Bottom	1	7" x 30"	
<b>Trim (¾" stock)</b>			
Sides	2	3 ¾" x 80 ⅞"	
Top	1	3 ¾" x 36 ½"	
<b>Bookcase</b>			
Sides (¾" stock)	2	7 ½" x 77 ¾" x ¾"	
Top, Middle, Bottom (¾" stock)	5	7 ½" x 25 ¼" x ¾"	NOTE: Top and Bottom are double thick
Back (½" stock)	1	26 ¾" x 77 ¾" x ½"	NOTE: Back is 3 ¼" smaller than door jamb

NOTE: These measurements are for a standard Murphy Door bookcase with an 8" overall depth. Murphy Door does not offer any assistance on custom doors or changes to our measurements, including but not limited to hinge layout. All custom changes are the responsibility of the customer. Do not contact Murphy Door for assistance if these measurements have been changed or you are doing a custom build.

**DISCLAIMER:** These measurements are provided only as a guide and Murpy Door is not responsible for any issues arising from incorrect measurements or if the listed measurements do not work. It is the responsibility of the customer to verify all measurements before making any purchases, cuts or assembly. By purchasing and using the Murphy Door hardware the customer is agreeing too all listed terms & conditions.

**Terms & Conditions:** <https://www.themurphydoor.com/store/terms-and-conditions/>

## 28"x82" Murphy Door Material List

Quantity	Material
1	4' x 8' x ¾" Sheet (use good material for bookcase)
1	4' x 8' x ½" Sheet (use good material for back)
	Edge Banding as desired
20'	¾" x 4" Trim Materials
1	¾" x 8" x Door Width
16.5	4 ⅞" x ¾" Stock for Jamb
24'	2 1/4" Stock for Face Frame
1 Box	Brad Nails for Face Frame and Trim
1 ½" Screws (1 bag)	Screws for Back
1	Kreg Tool: Fasten sides of bookcase to top, middle, lower shelves if you do not want to see fasteners
1	Bottle Wood Glue

NOTE: ALL measurements are for building a bookcase with kreg screws and fastening the back to the back of rails. There are no calculations for doors with mortised or dadoed back set.

## 28" Flush Mount Bookcase Cut List

Name	Qty	Measurement	Material
<b>Face Frame</b>			
Sides	2	2 ¼" x 78 ½"	
Top, Middle, Bottom	3	2 ¼" x 22 ¼"	
<b>Door Jamb (¾" stock)</b>			
Sides	2	4 ⅞" x 80 ⅞"	
Top	1	4 ⅞" x 28"	
Bottom	1	7" x 28"	
<b>Trim (¾" stock)</b>			
Sides	2	3 ¾" x 80 ⅞"	
Top	1	3 ¾" x 34 ½"	
<b>Bookcase</b>			
Sides (¾" stock)	2	7 ½" x 77 ¾" x ¾"	
Top, Middle, Bottom (¾" stock)	5	7 ½" x 23 ¼" x ¾"	NOTE: Top and Bottom are double thick
Back (½" stock)	1	24 ¾" x 77 ¾" x ½"	NOTE: Back is 3 ¼" smaller than door jamb

NOTE: These measurements are for a standard Murphy Door bookcase with an 8" overall depth. Murphy Door does not offer any assistance on custom doors or changes to our measurements, including but not limited to hinge layout. All custom changes are the responsibility of the customer. Do not contact Murphy Door for assistance if these measurements have been changed or you are doing a custom build.

**DISCLAIMER:** These measurements are provided only as a guide and Murpy Door is not responsible for any issues arising from incorrect measurements or if the listed measurements do not work. It is the responsibility of the customer to verify all measurements before making any purchases, cuts or assembly. By purchasing and using the Murphy Door hardware the customer is agreeing too all listed terms & conditions.

**Terms & Conditions:** <https://www.themurphydoor.com/store/terms-and-conditions/>

## 26"x82" Murphy Door Material List

Quantity	Material
1	4' x 8' x ¾" Sheet (use good material for bookcase)
1	4' x 8' x ½" Sheet (use good material for back)
	Edge Banding as desired
20'	¾" x 4" Trim Materials
1	¾" x 8" x Door Width
16.5	4 ⅞" x ¾" Stock for Jamb
24'	2 1/4" Stock for Face Frame
1 Box	Brad Nails for Face Frame and Trim
1 ½" Screws (1 bag)	Screws for Back
1	Kreg Tool: Fasten sides of bookcase to top, middle, lower shelves if you do not want to see fasteners
1	Bottle Wood Glue

NOTE: ALL measurements are for building a bookcase with kreg screws and fastening the back to the back of rails. There are no calculations for doors with mortised or dadoed back set.

## 26" Flush Mount Bookcase Cut List

Name	Qty	Measurement	Material
<b>Face Frame</b>			
Sides	2	2 ¼" x 78 ½"	
Top, Middle, Bottom	3	2 ¼" x 20 ¼"	
<b>Door Jamb (¾" stock)</b>			
Sides	2	4 ⅞" x 80 ⅞"	
Top	1	4 ⅞" x 26"	
Bottom	1	7" x 26"	
<b>Trim (¾" stock)</b>			
Sides	2	3 ¾" x 80 ⅞"	
Top	1	3 ¾" x 32 ½"	
<b>Bookcase</b>			
Sides (¾" stock)	2	7 ½" x 77 ¾" x ¾"	
Top, Middle, Bottom (¾" stock)	5	7 ½" x 21 ¼" x ¾"	NOTE: Top and Bottom are double thick
Back (½" stock)	1	22 ¾" x 77 ¾" x ½"	NOTE: Back is 3 ¼" smaller than door jamb

NOTE: These measurements are for a standard Murphy Door bookcase with an 8" overall depth. Murphy Door does not offer any assistance on custom doors or changes to our measurements, including but not limited to hinge layout. All custom changes are the responsibility of the customer. Do not contact Murphy Door for assistance if these measurements have been changed or you are doing a custom build.

**DISCLAIMER:** These measurements are provided only as a guide and Murphy Door is not responsible for any issues arising from incorrect measurements or if the listed measurements do not work. It is the responsibility of the customer to verify all measurements before making any purchases, cuts or assembly. By purchasing and using the Murphy Door hardware the customer is agreeing to all listed terms & conditions.

**Terms & Conditions:** <https://www.themurphydoor.com/store/terms-and-conditions/>

# Hinge Kit & Materials

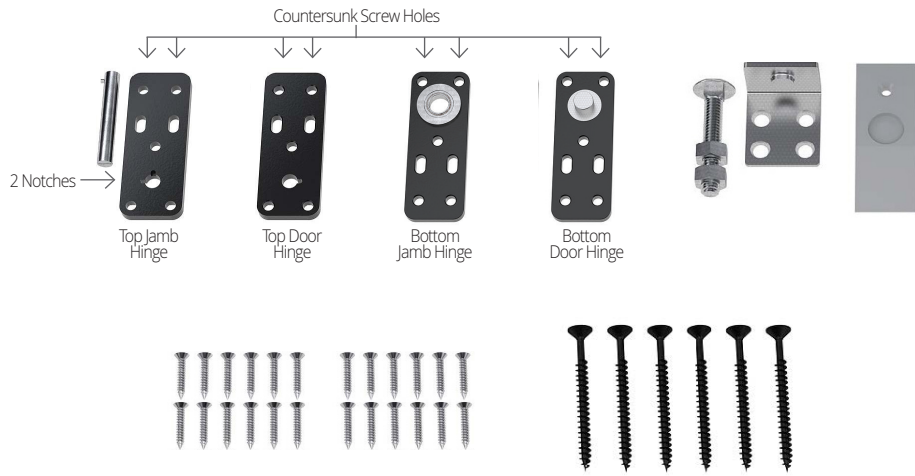

## BOOKCASE

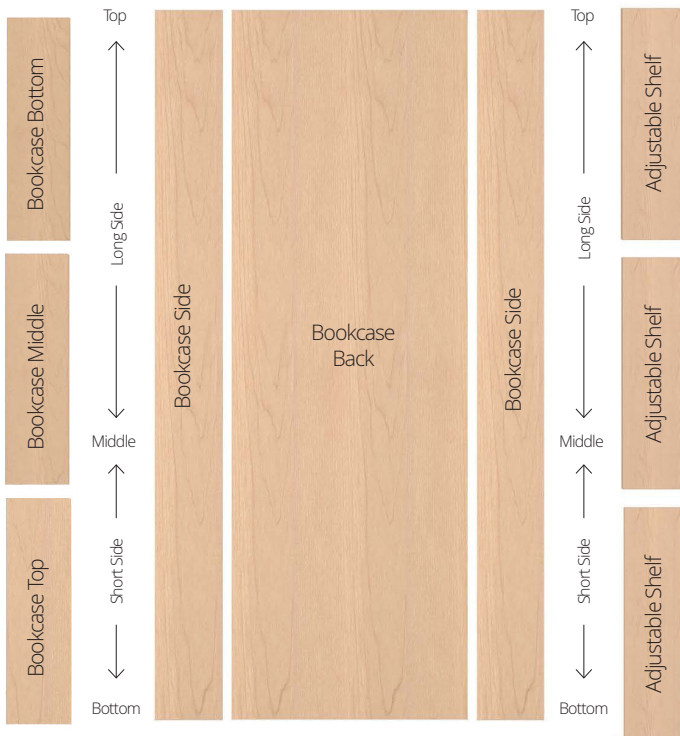

## JAMB



## FACE FRAME

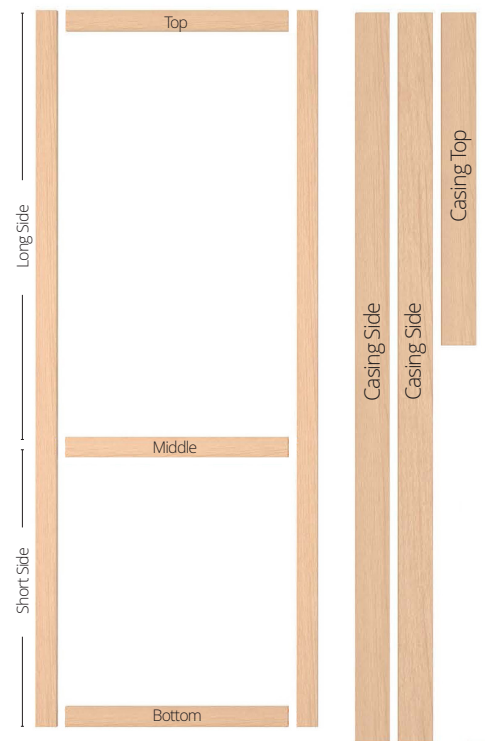



# 1 Assemble Face Frame

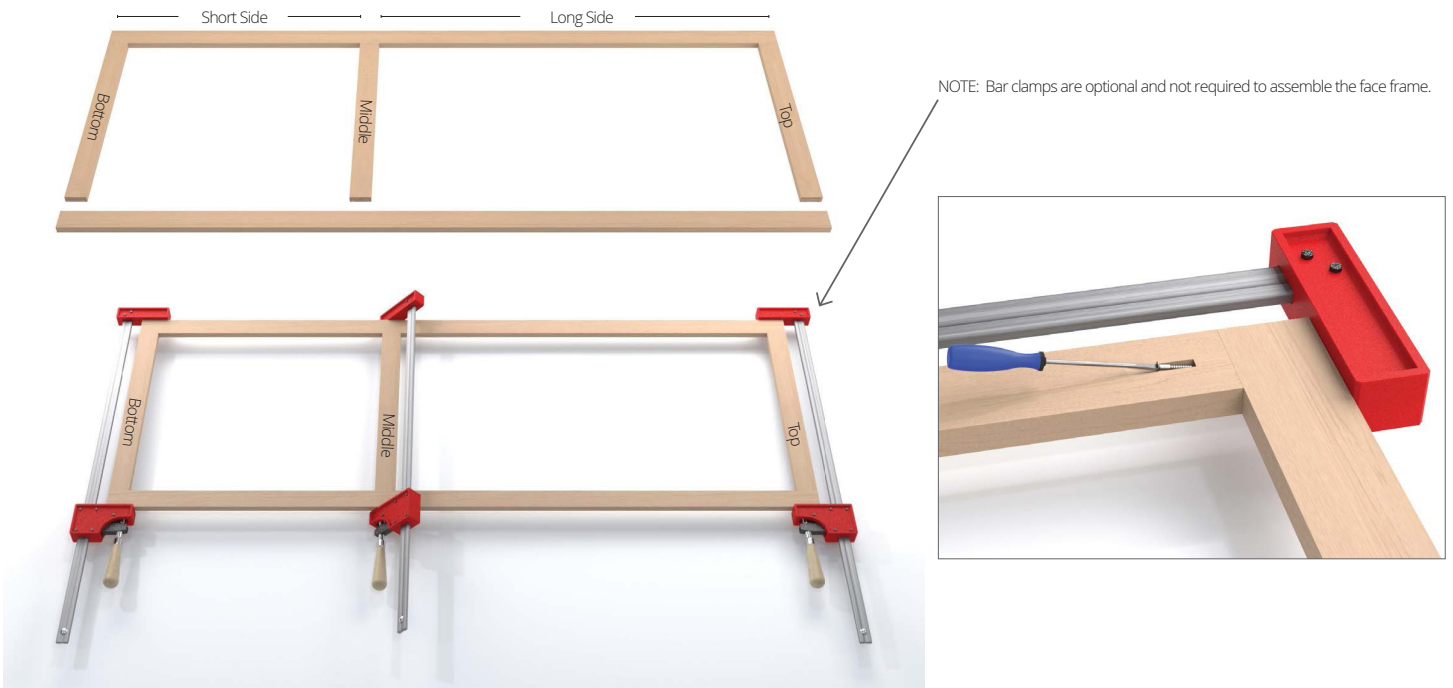

# 2 Assemble Bookcase

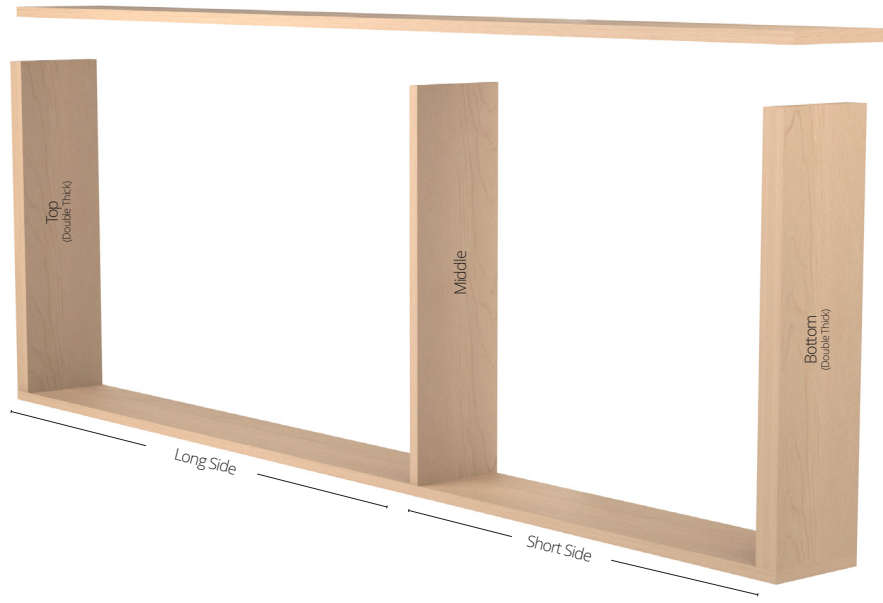
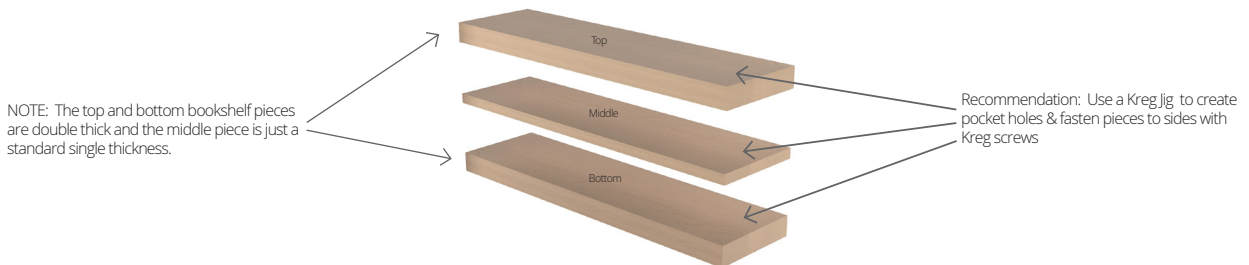

### 3 Place Back

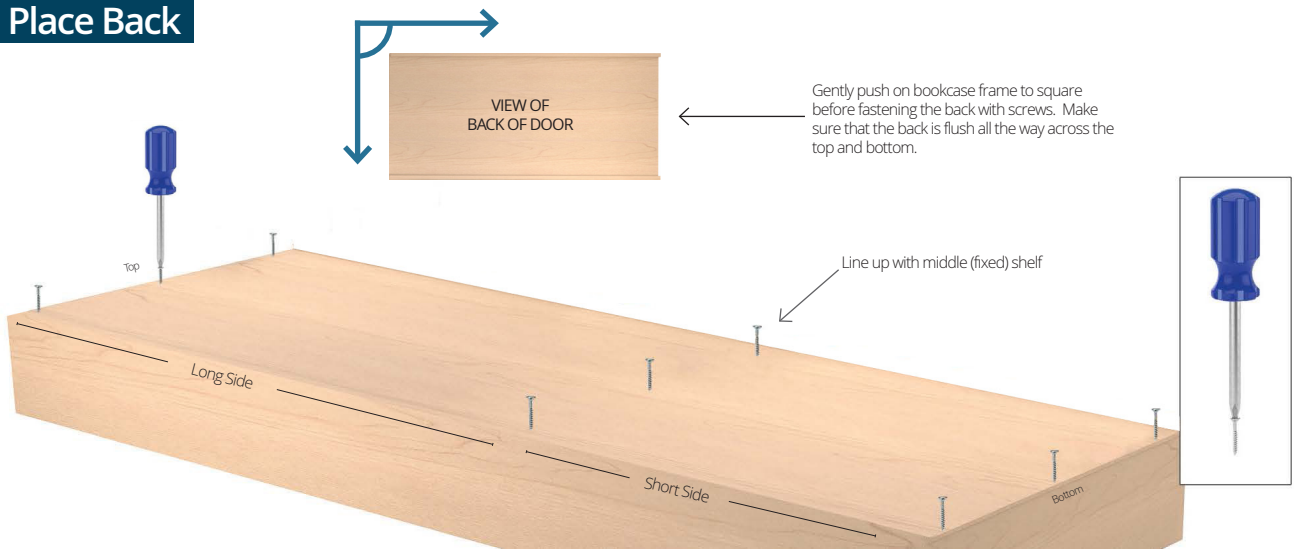

### 4 Fastening Face Frame

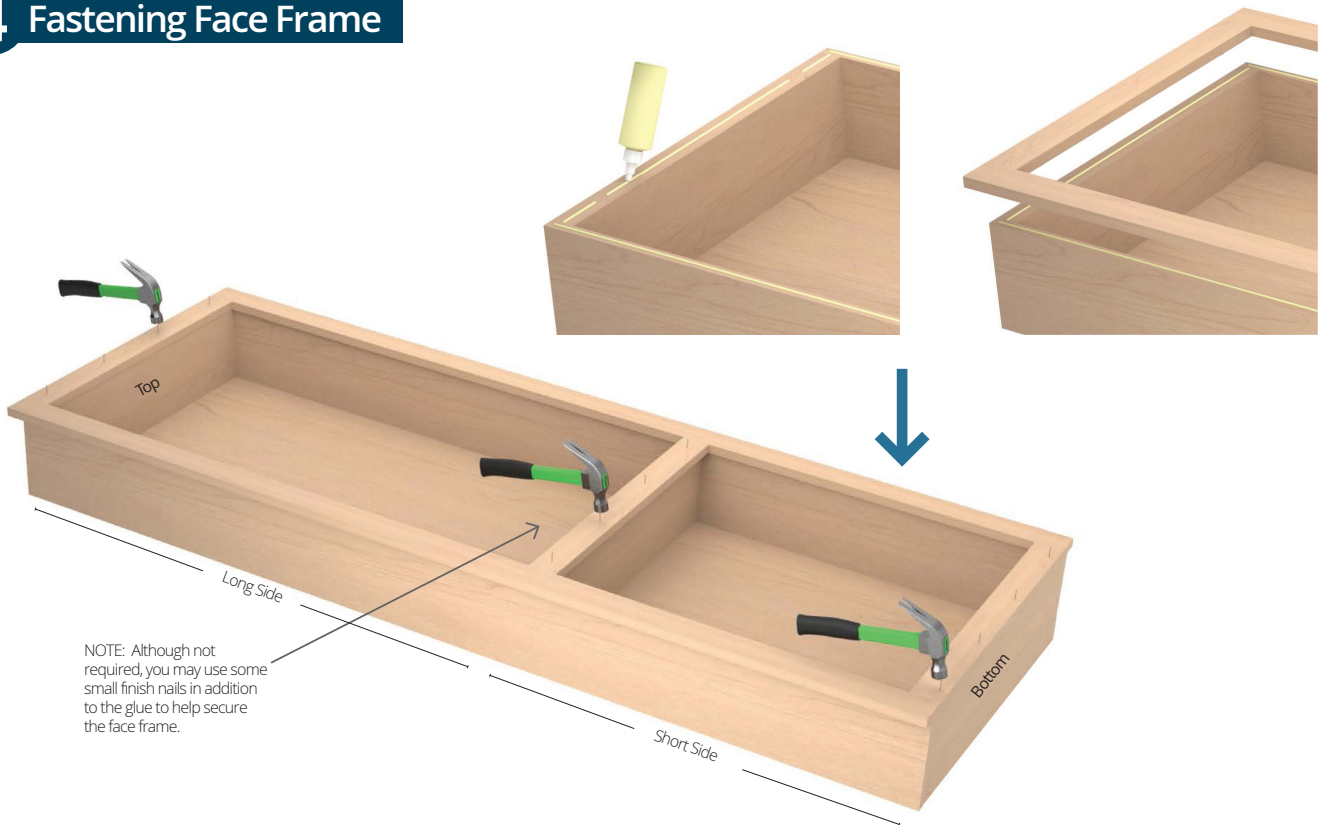

## 5 Hinge Templates

### Jamb Bottom (Threshold)

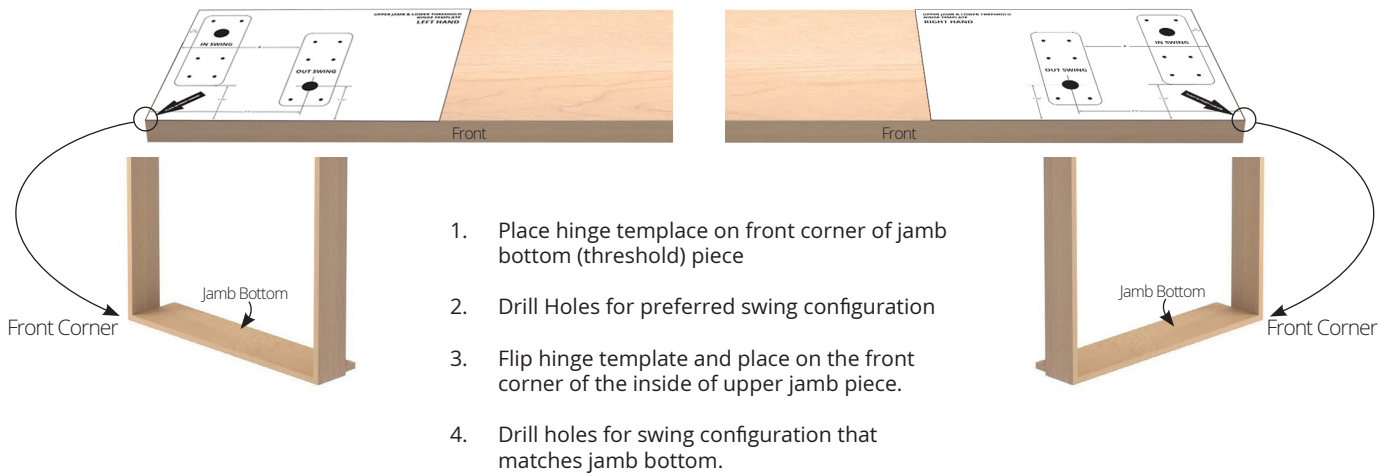

**NOTICE:** Due to variations in printer settings, your printed template may not be scaled properly. Please use included measurements to verify proper placement.

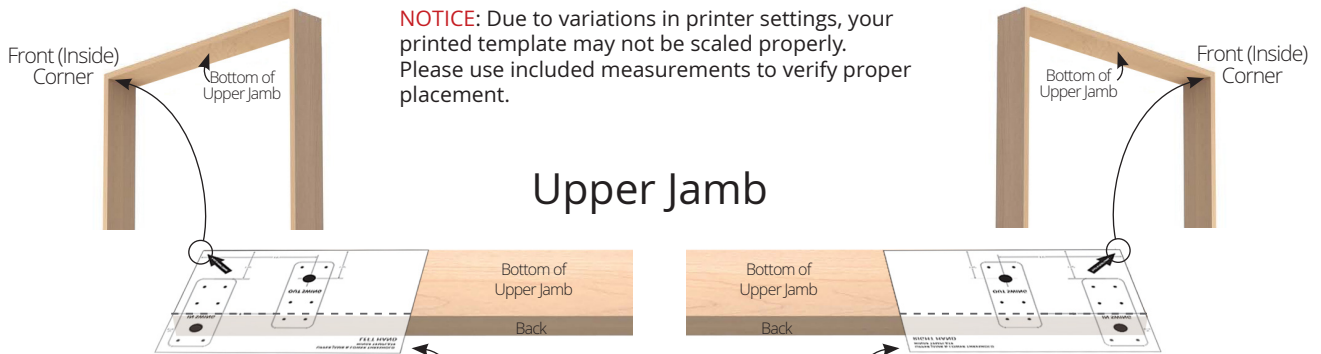

Upper jamb piece is not as wide the jamb bottom so the template will extend past the end of board. Please note that the holes that do not fit on the upper jamb will not be used.

## 6 Assemble Jamb

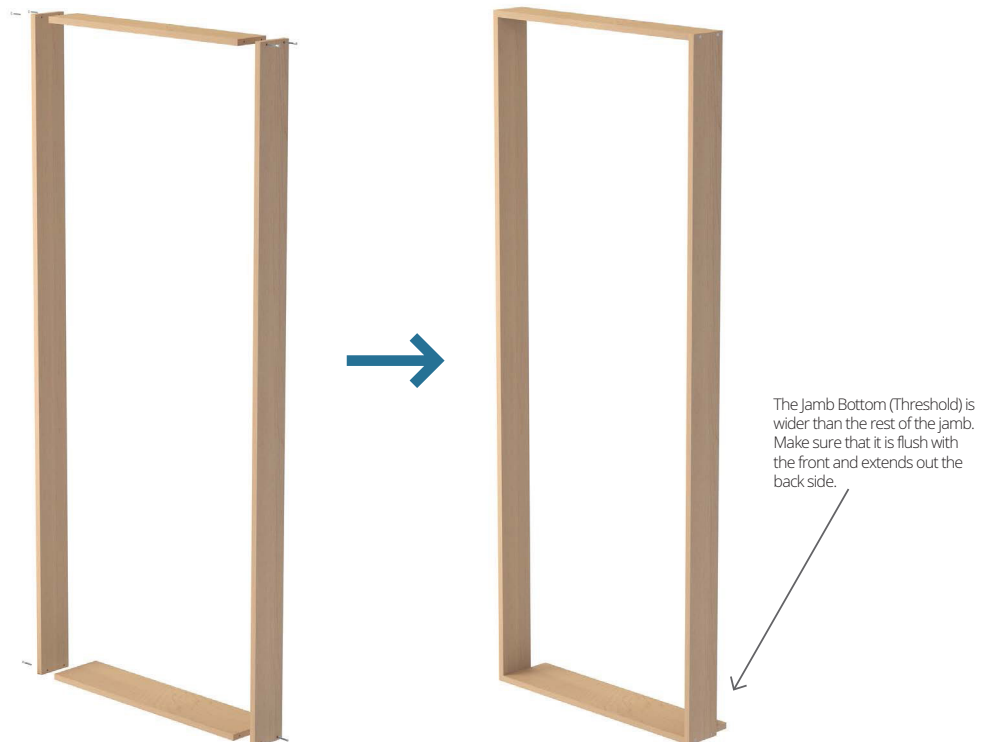

# 7 Install Hinges

## LEFT HINGE OUT-SWING

## RIGHT HINGE OUT-SWING

### Placing Pin in Upper Hinge

- 1) Insert pin through first hinge plate
- 2) Rotate 180°
- 3) Insert pin through second hinge plate
- 4) Rotate 90°
- 5) Pull pin down into notch to secure it in place.

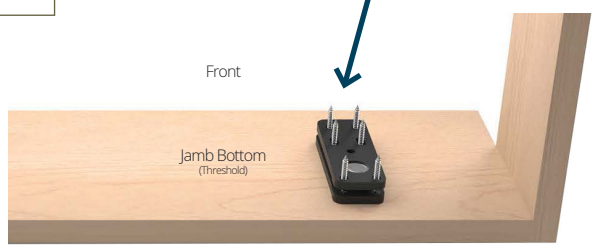
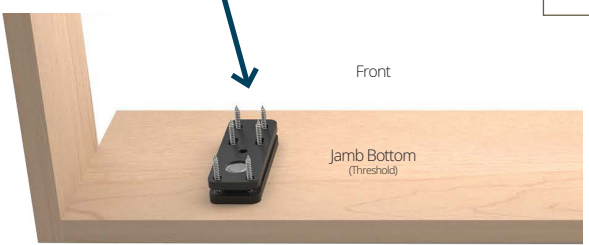
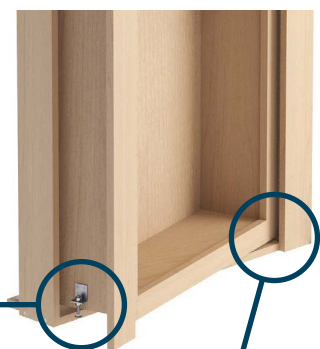
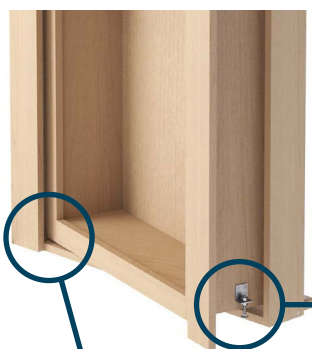
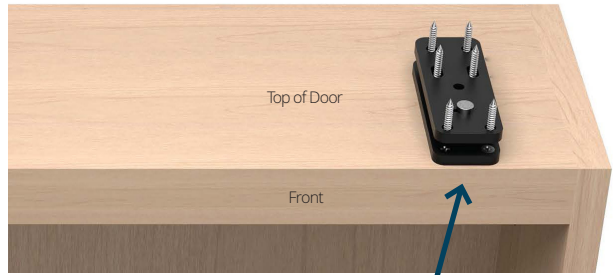

# 7 Install Hinges

## LEFT HINGE IN-SWING

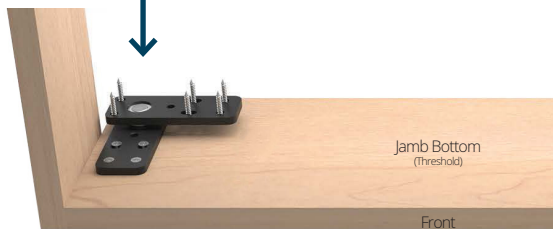
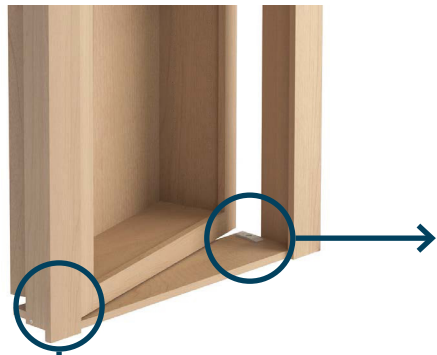
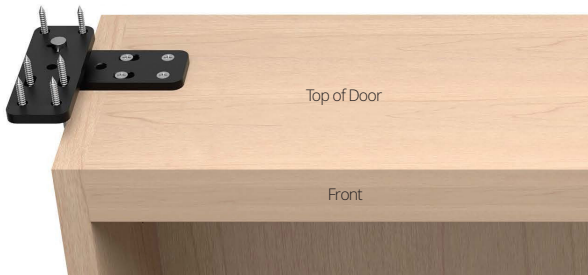

## RIGHT HINGE IN-SWING

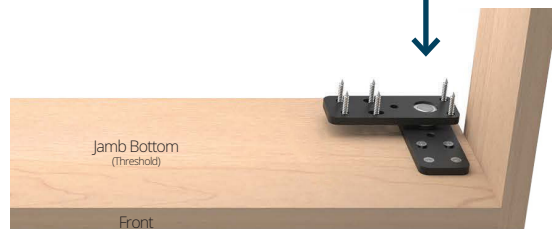
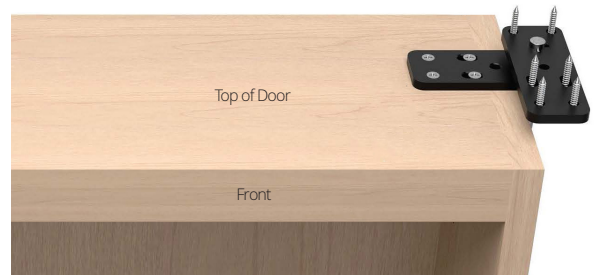

# DOOR BOTTOM LEFT HINGE

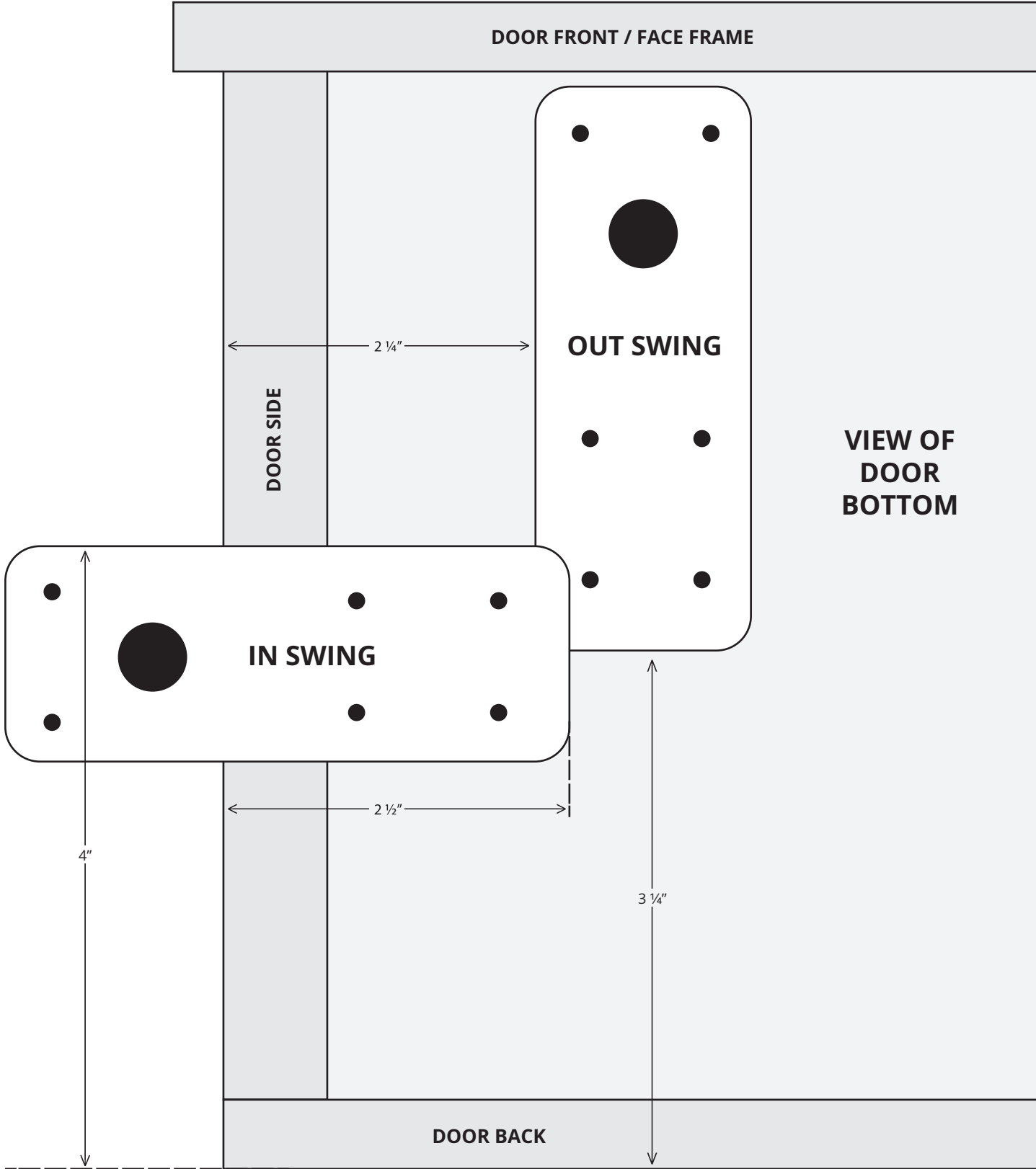

# DOOR BOTTOM RIGHT HINGE

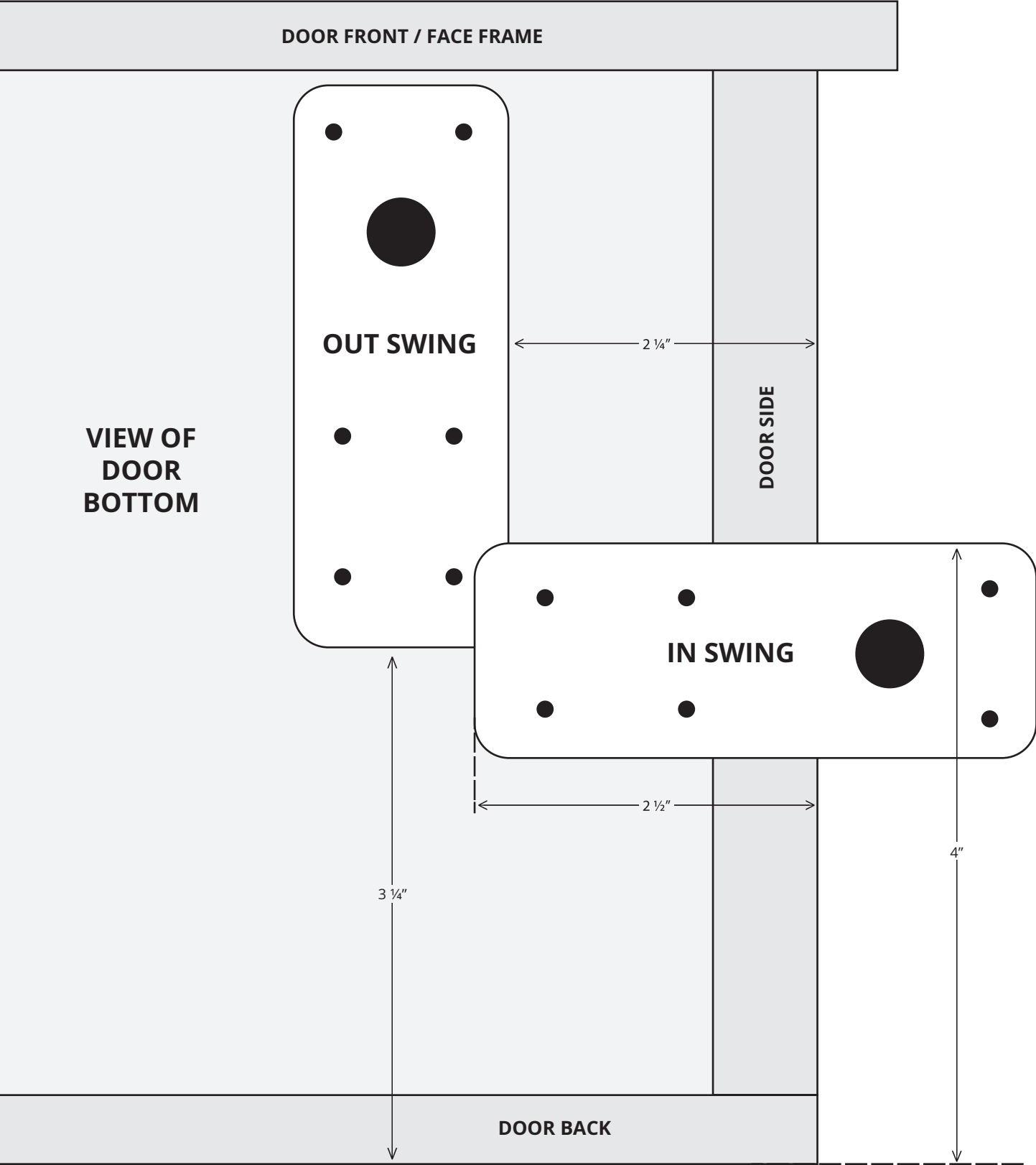



**NOTICE:** Due to variations in individual printer settings we cannot guarantee that the printed template will be scaled properly. Please use the included measurements to verify proper placement.



**UPPER JAMB & LOWER THRESHOLD  
HINGE TEMPLATE  
LEFT HAND**

NOTE: Some holes will extend over the edge when placing on the Upper Jamb.

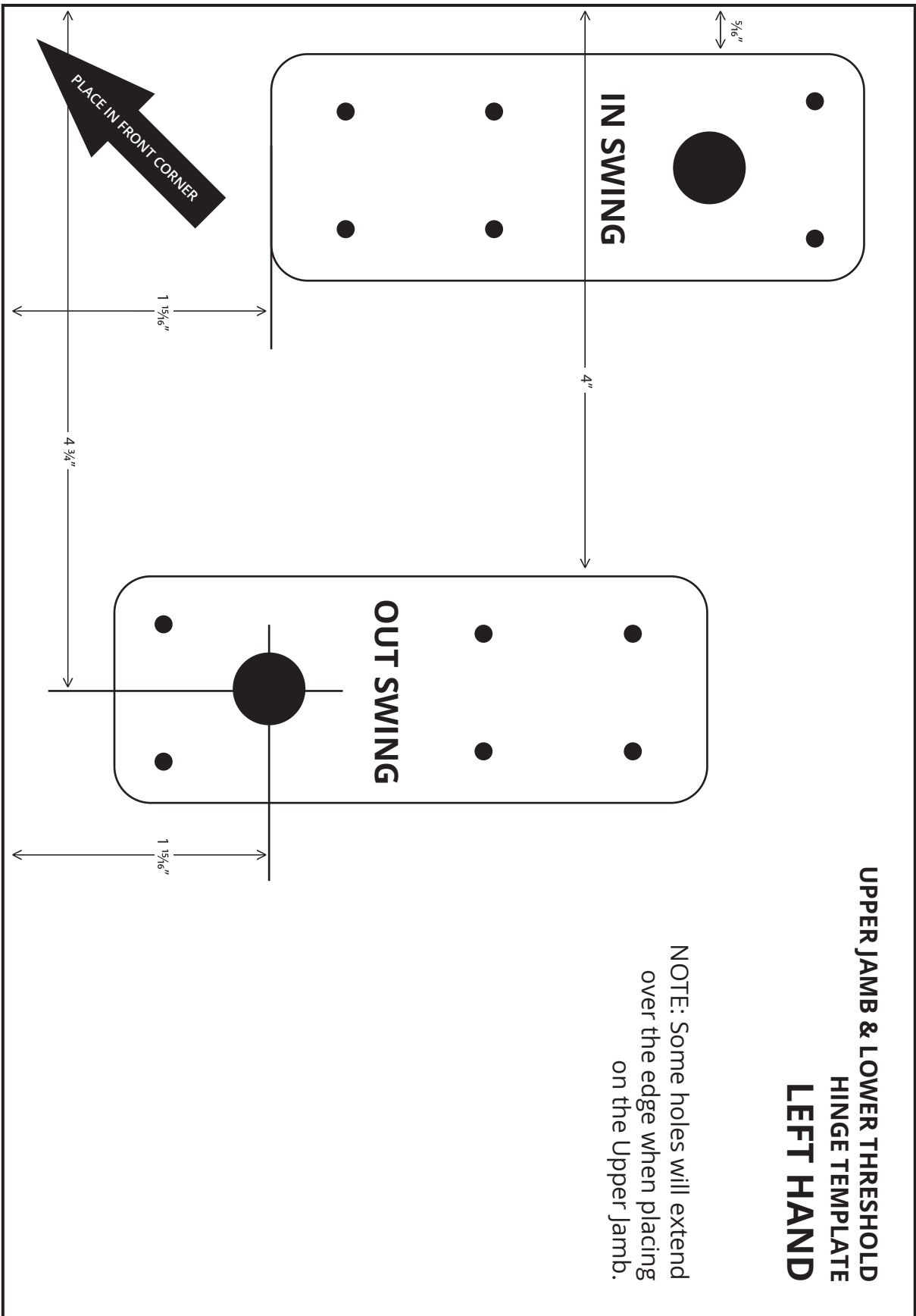

Please see Step 5 for instructions on how to use this templates.





**NOTICE:** Due to variations in individual printer settings we cannot guarantee that the printed template will be scaled properly. Please use the included measurements to verify proper placement.



# UPPER JAMB & LOWER THRESHOLD HINGE TEMPLATE RIGHT HAND

NOTE: Some holes will extend over the edge when placing on the Upper Jamb.

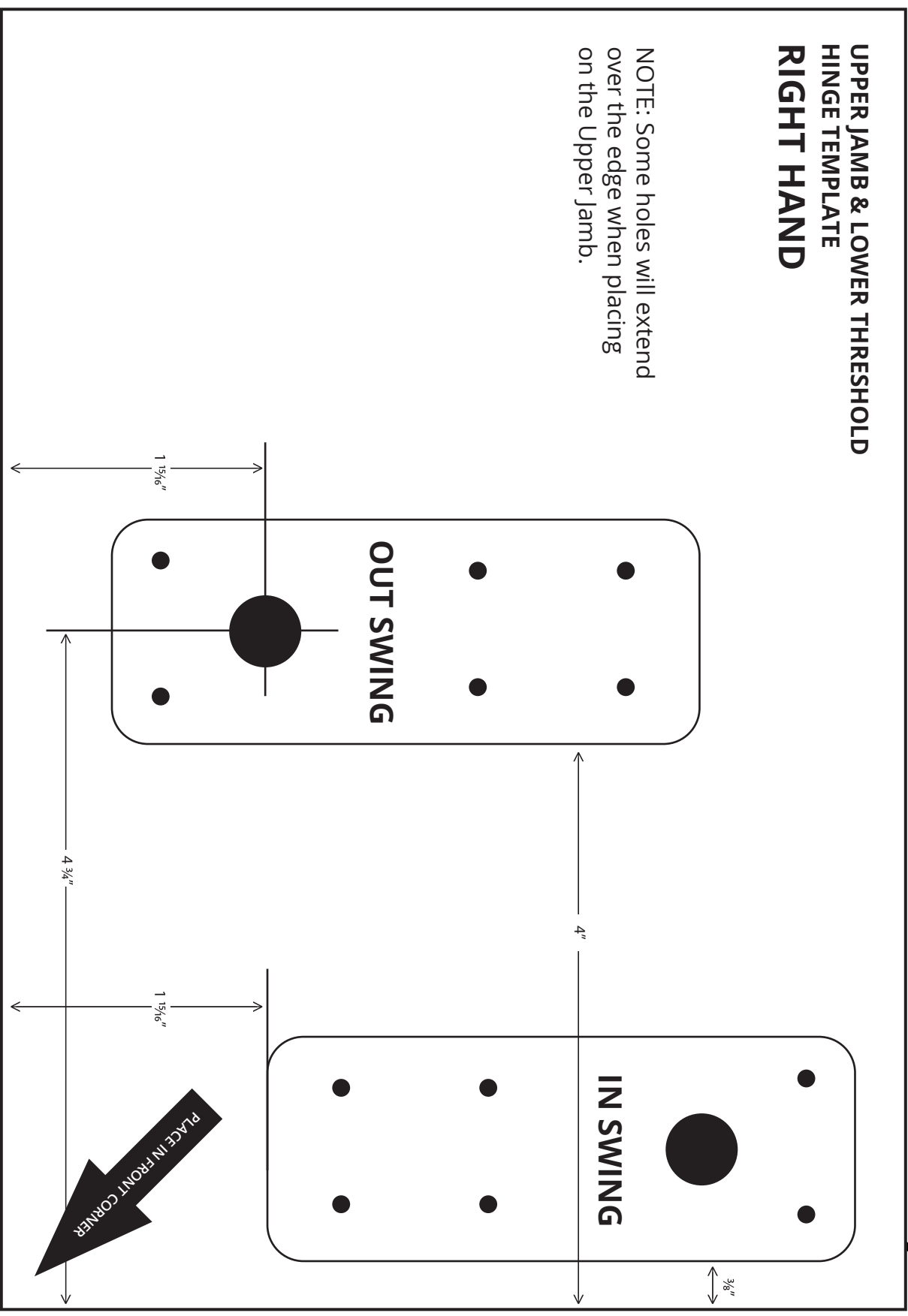

Please see Step 5 for instructions on how to use this templates.



# MURPHY DOOR™

CREATIVE DOOR SOLUTIONS



**Ogden Headquarters**  
2541 Rulon White Blvd  
Ogden, UT 84404



**Kentucky Distribution  
Center & Showroom**  
2320 Fortune Dr. #180  
Lexington, KY 40509