

Product & Packaging Specs

6x6 Column Cap (6X6-CAP-IW)

Item #: 51779

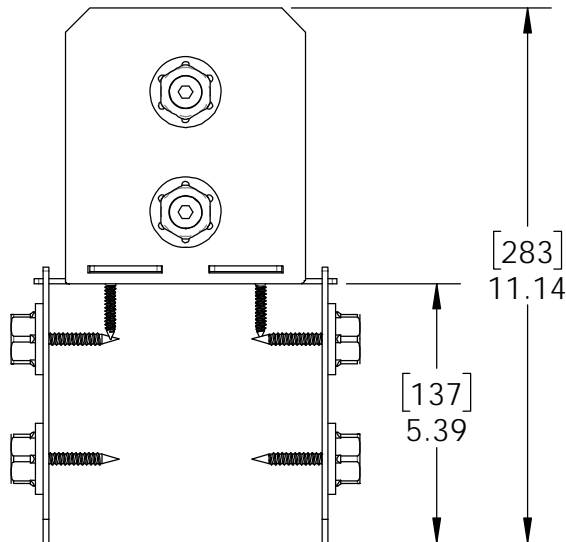
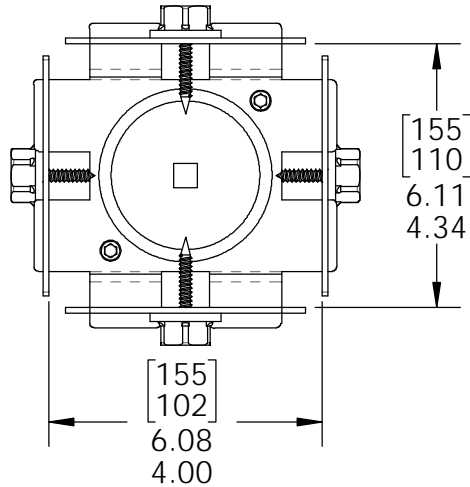

ITEM NO.	QTY.	PART NUMBER	DESCRIPTION
1	4	51779-12	Plate, 6x6 Column Cap Compression IW
2	1	51779-11	Plate, 6x6 Column Cap
3	2	80060	Screw, 1-1/2"x1/4" Black Hex-Head (1-1/2-HX-SCR)
4	0.8	56621	1 1/2" Hex Cap Nut (HCN)
5	0.32	56625	OWT Timber Screw 1-3/4"

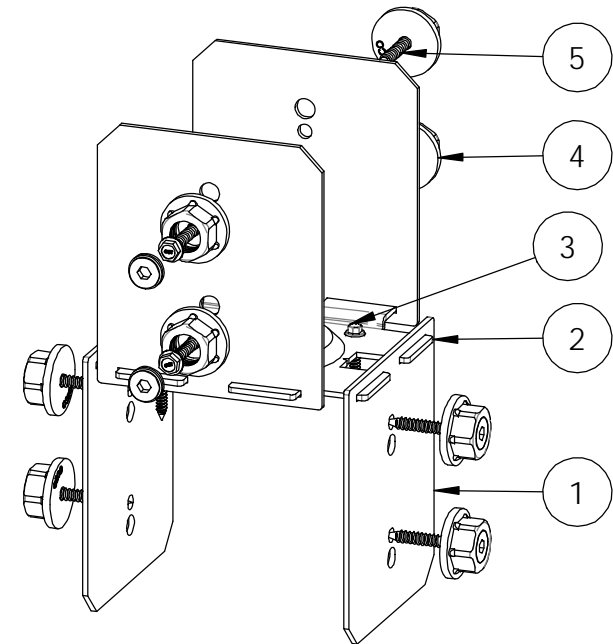

Weight: 5.26 LBS
Scale: 1:4
Last updated: 12/15/2017

51779

Product & Packaging Specs

6x6 Column Cap (6X6-CAP-IW)

Item #: 51779

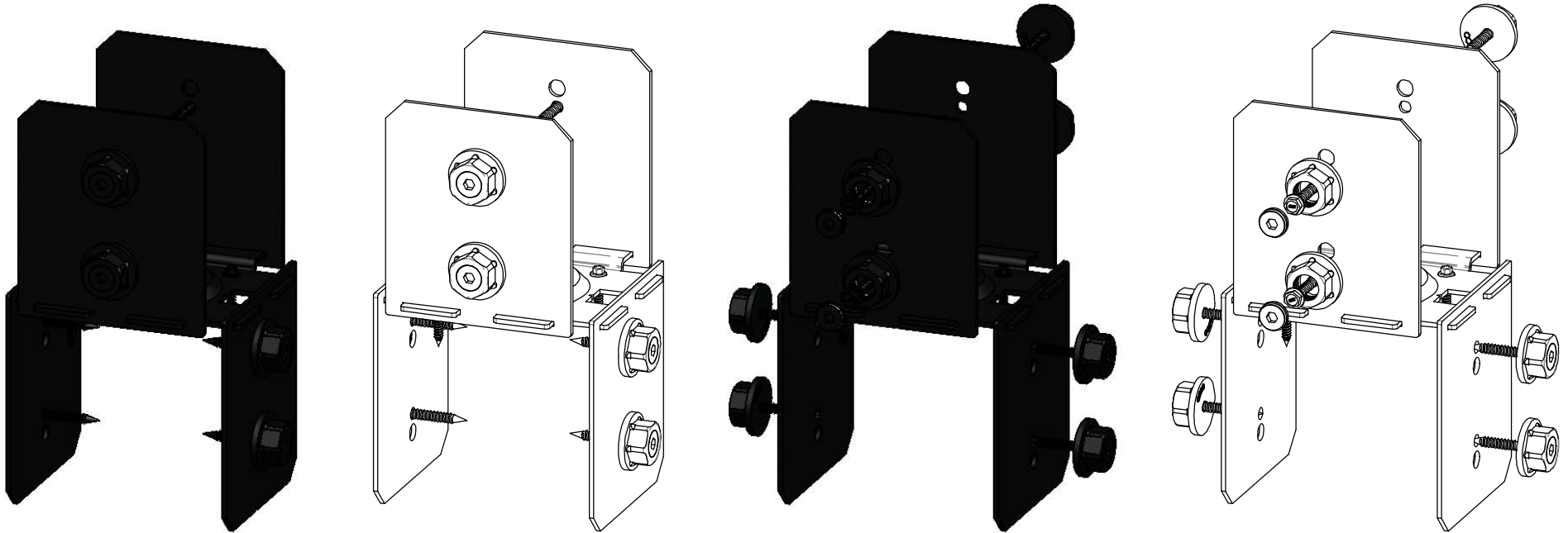

Weight: 5.26 LBS
Scale: 1:1
Last updated: 12/15/2017

51779

V2.00 - Installation Instructions, Specifications and Project Plans are effective 12/15/2017 . This information is updated periodically² and should not be relied upon after 2 years from 12/15/2017 . Please visit OZCOBP.com to get current information.

Product & Packaging Specs

6x6 Column Cap (6X6-CAP-IW)

Item #: Typical Installation 6x6/2x8's

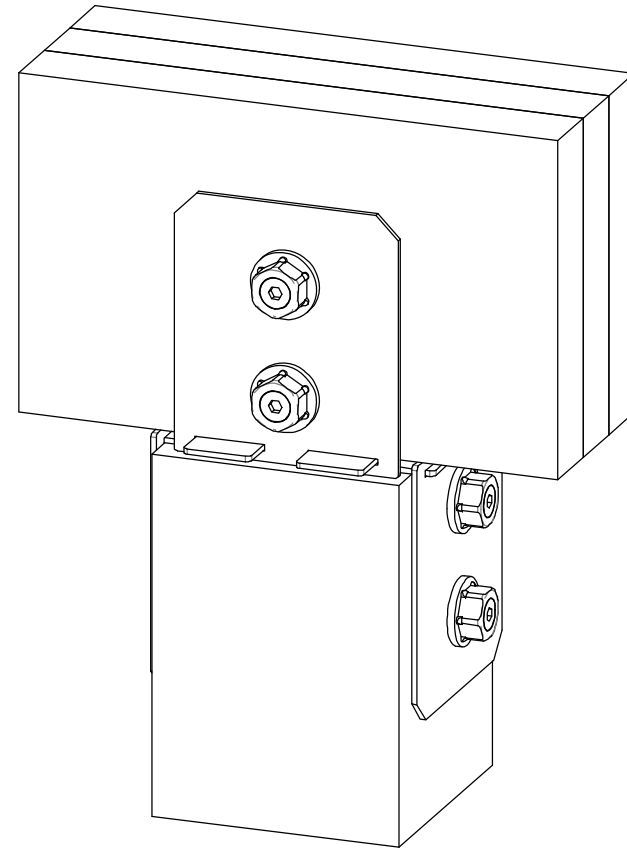
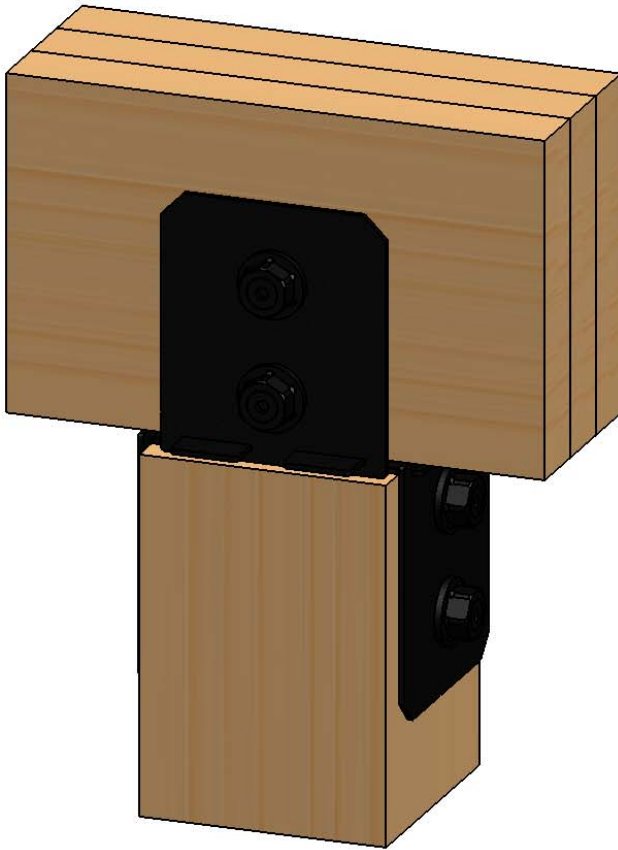

Weight: 28.63 LBS
Scale: 1:1
Last updated: 12/15/2017

51779

Product & Packaging Specs

6x6 Column Cap (6X6-CAP-IW)

Item #: Typical Installation 6x6/2x8's

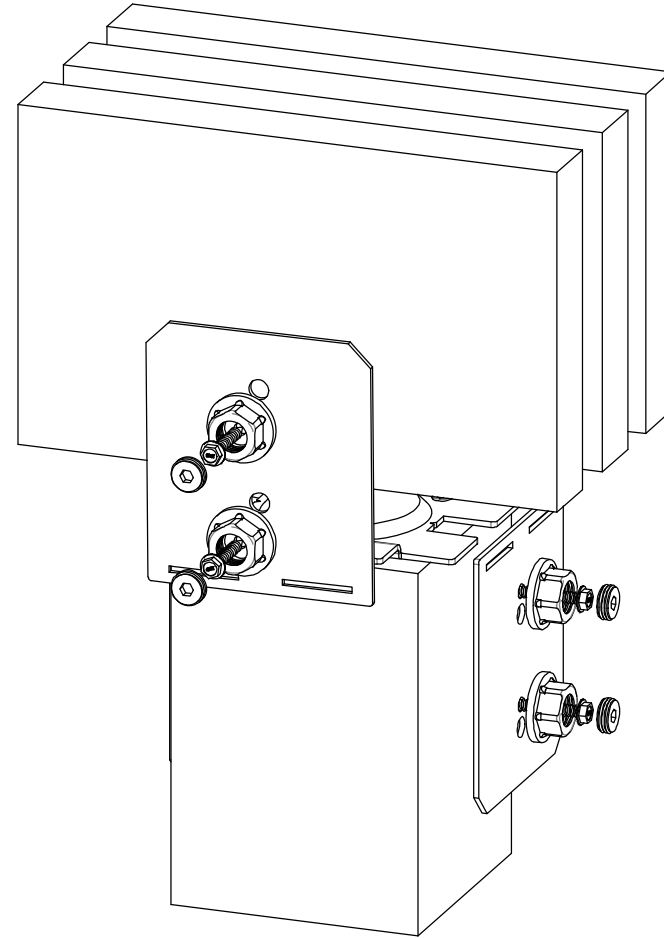
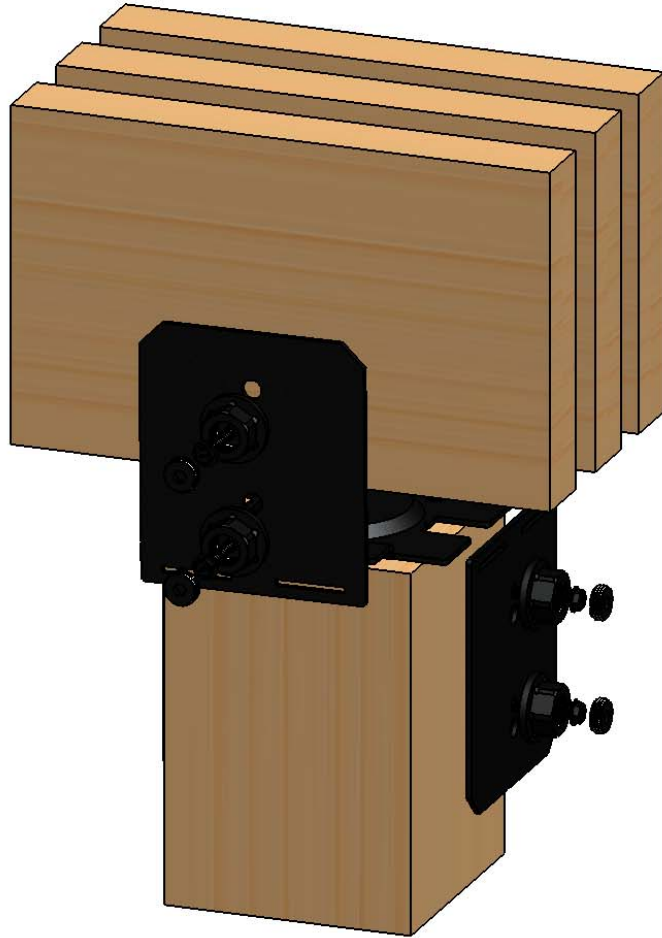

Weight: 28.63 LBS
Scale: 1:1
Last updated: 12/15/2017

51779



Product & Packaging Specs

6x6 Column Cap (6X6-CAP-IW)

Item #: Typical Installation 6x6/6x6

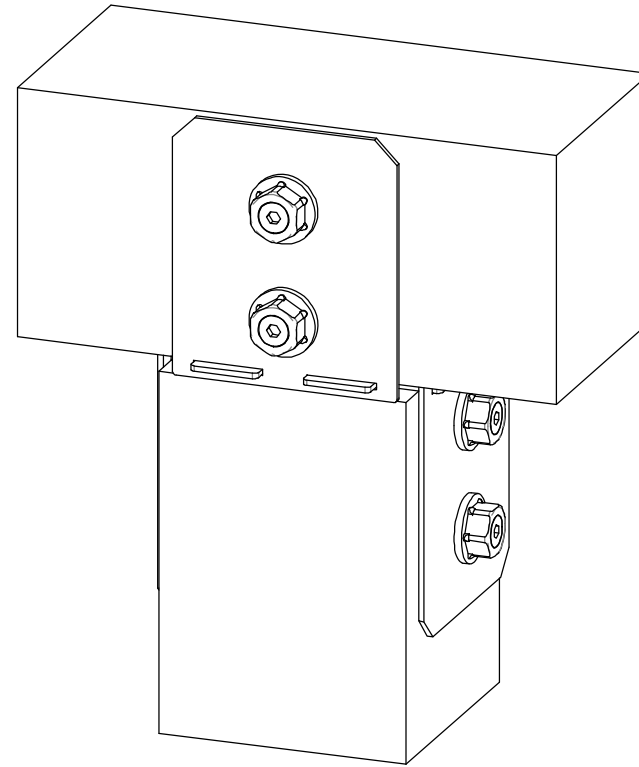

Weight: 5.26 LBS
Scale: 1:1
Last updated: 12/15/2017

51779

V2.00 - Installation Instructions, Specifications and Project Plans are effective 12/15/2017 . This information is updated periodically and should not be relied upon after 2 years from 12/15/2017 . Please visit OZCOBP.com to get current information.

Product & Packaging Specs

6x6 Column Cap (6X6-CAP-IW)

Item #: Typical Installation 6x6/6x6

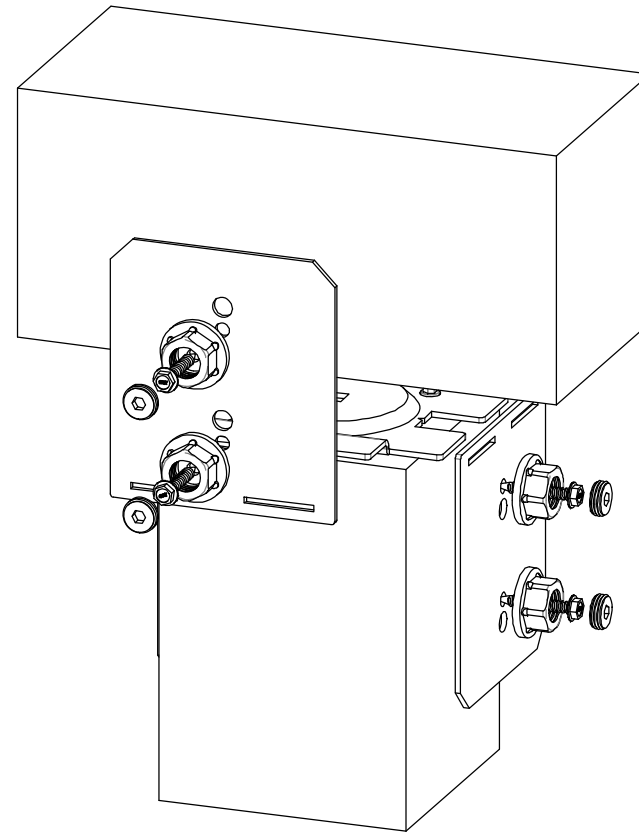
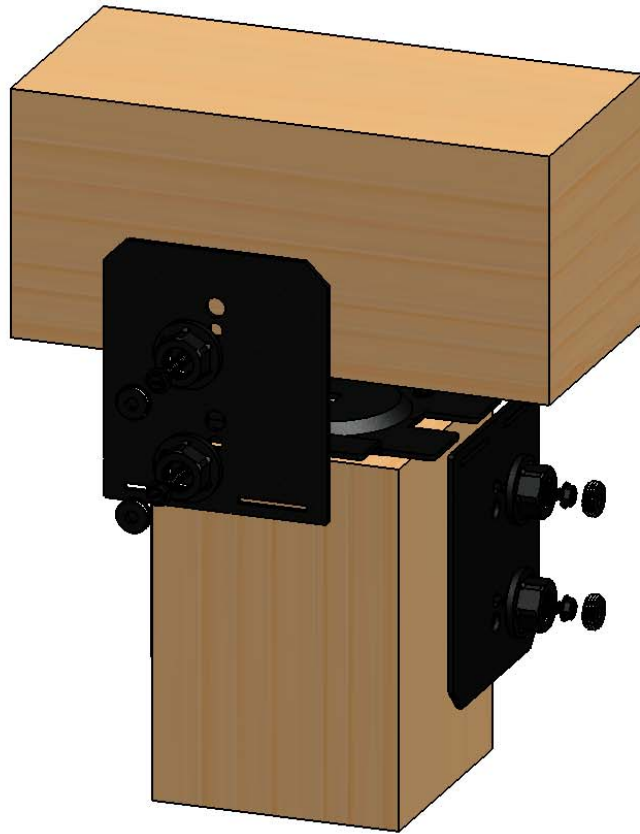

Weight: 5.26 LBS
Scale: 1:1
Last updated: 12/15/2017

51779

Product & Packaging Specs

6x6 Column Cap (6X6-CAP-IW)

Item #: Typical Installation 6x6/6x8

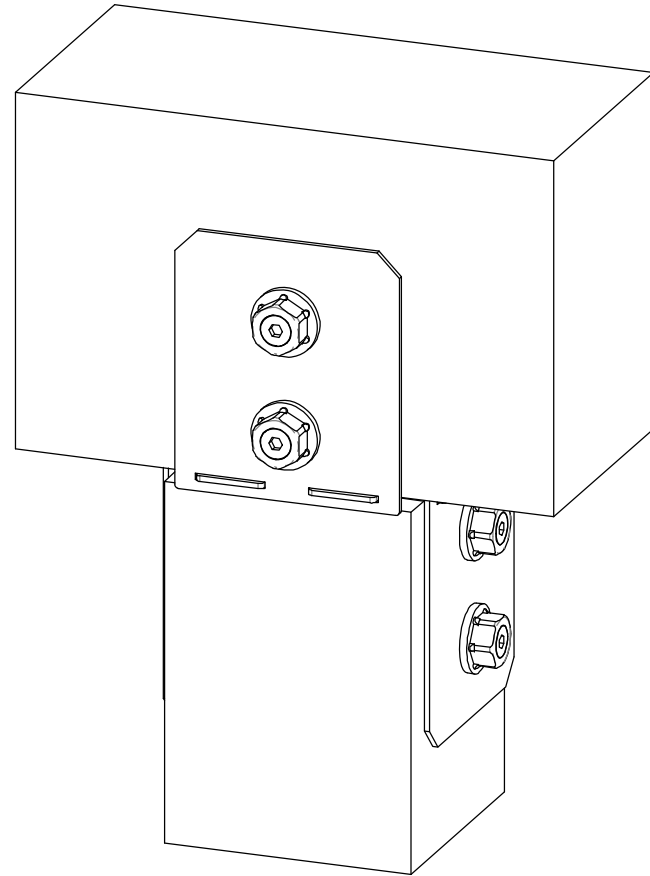
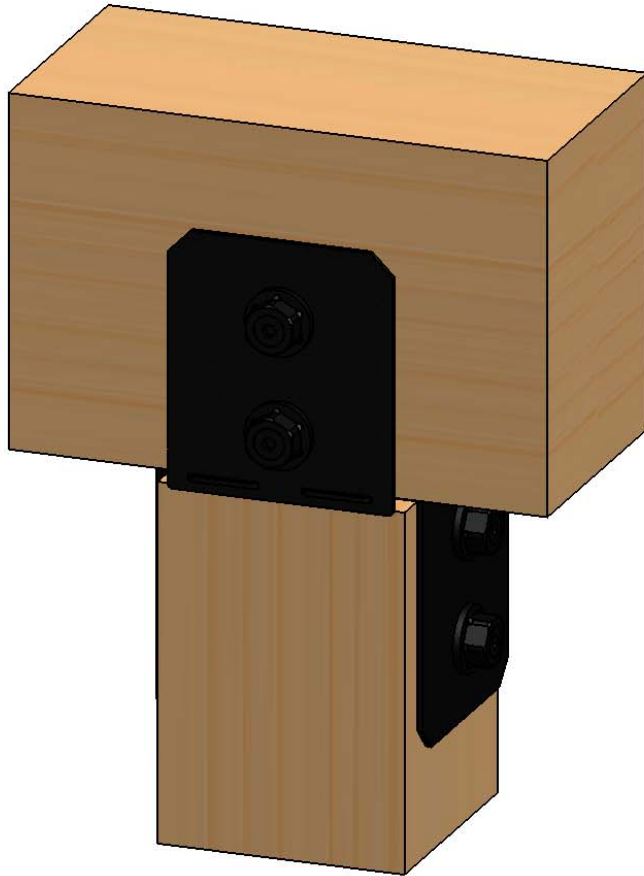

Weight: 34.06 LBS
Scale: 1:1
Last updated: 12/15/2017

51779

Product & Packaging Specs

6x6 Column Cap (6X6-CAP-IW)

Item #: Typical Installation 6x6/6x8

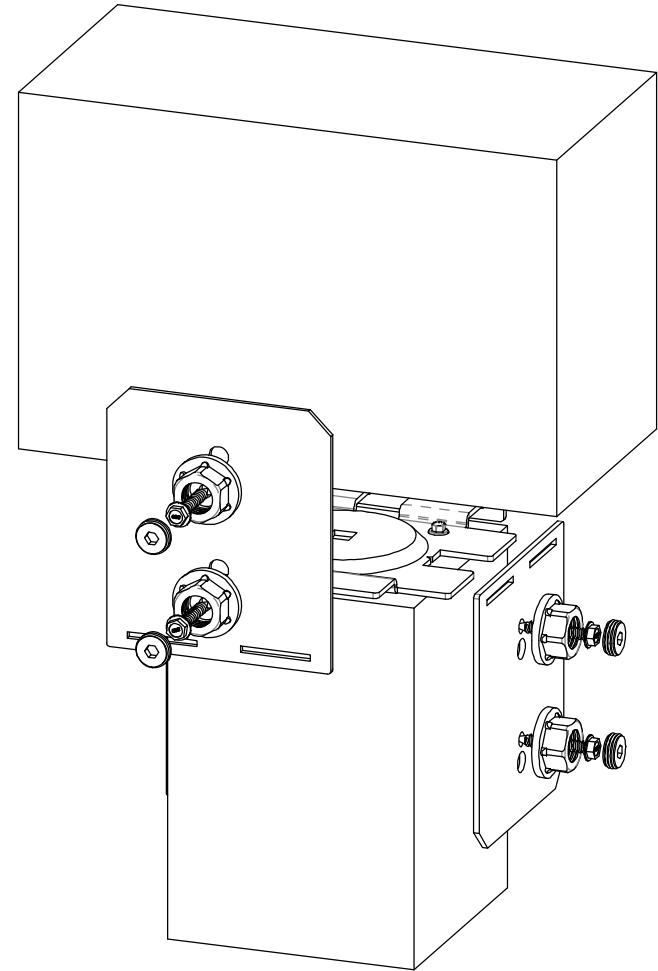

Weight: 34.06 LBS
Scale: 1:1
Last updated: 12/15/2017

51779

Product & Packaging Specs

Box, 51779

Item #: Box

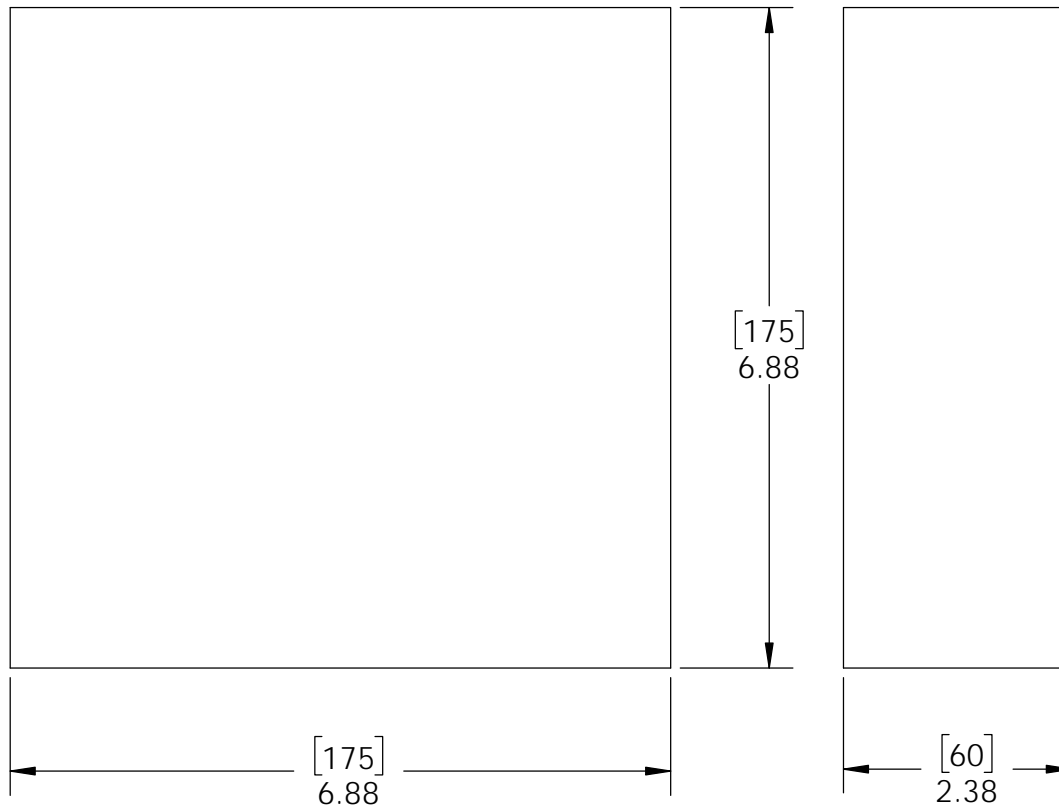

Material: Corrugated Paper
Finish: See Artwork
Weight: 0.07 LBS
Scale: 1:2
Last updated: 12/15/2017

51779

Product & Packaging Specs

Case, 51779

Item #: Case

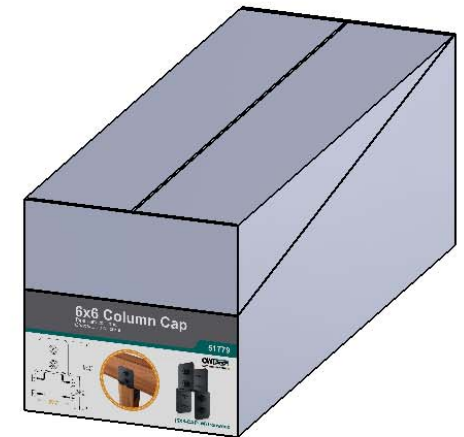
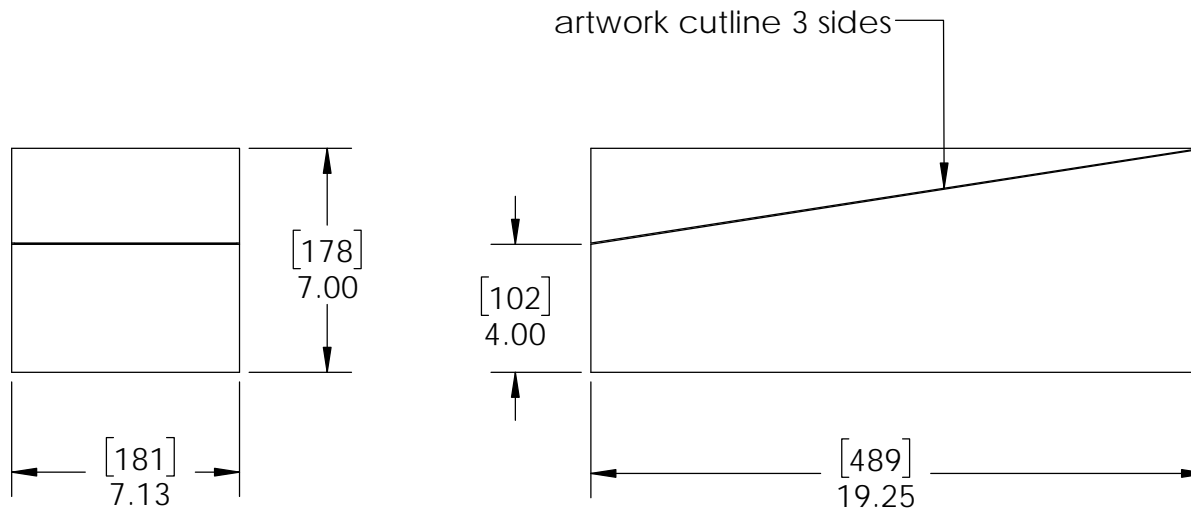

Material: Corrugated Paper
Finish: See artwork
Weight: 0.28 LBS
Scale: 1:6
Last updated: 12/15/2017

51779

Product & Packaging Specs

51779 Packing
Item #: Case packing



Weight: 44 LBS
Scale: 1:2.5
Last updated: 12/15/2017

51779

Product & Packaging Specs

51779 Packing

Item #: Pallet packing

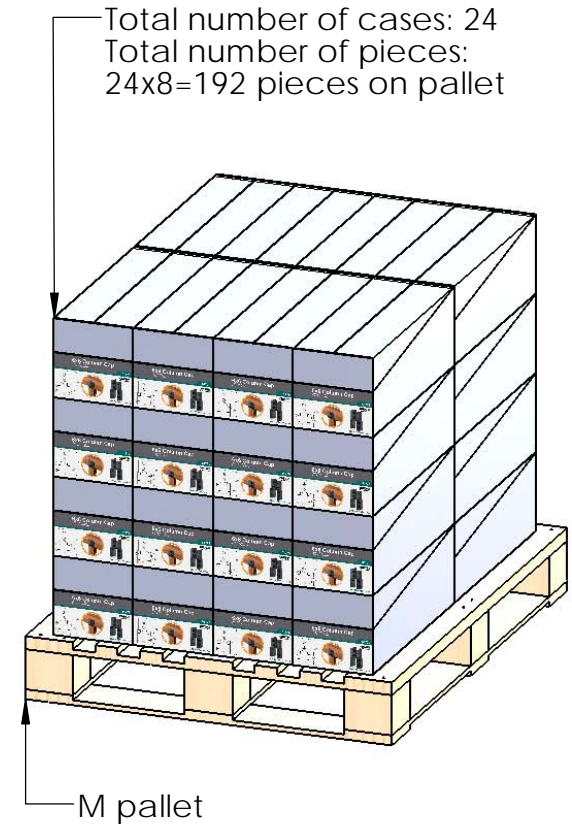
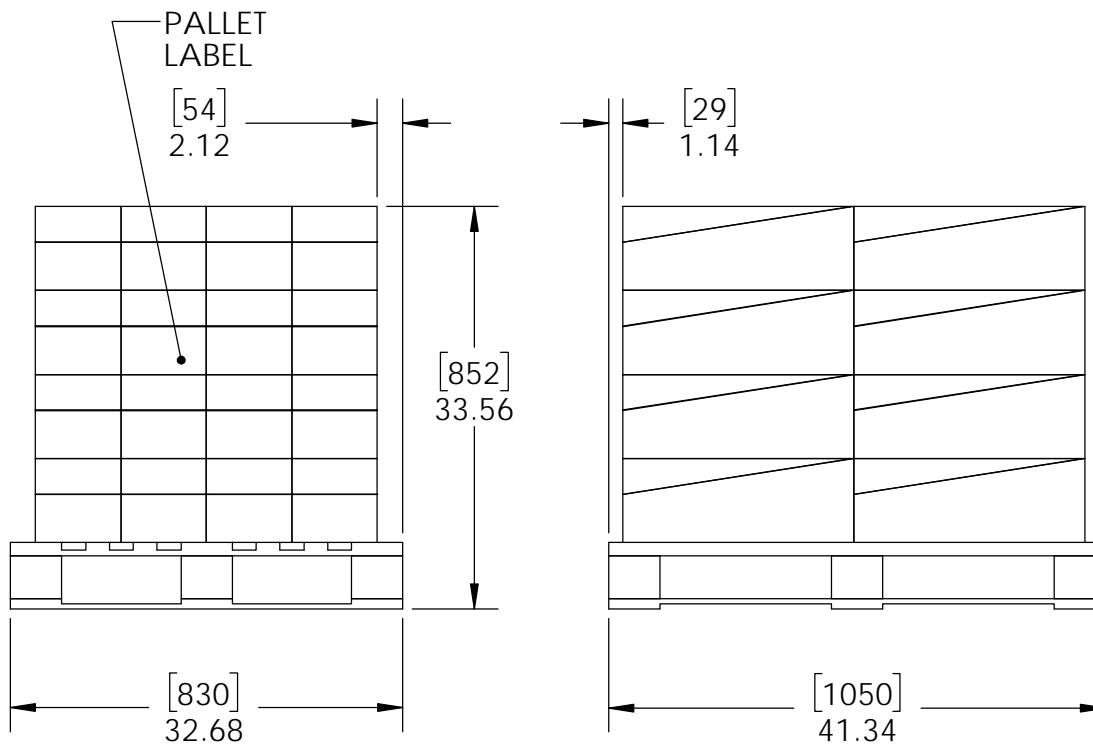

Weight: 1086 LBS
Scale: 1:16
Last updated: 12/15/2017

51779

additional pallet packing instructions

- plywood on top layer
- strap to pallet
- clear wrap around boxes

