



SETTING UP YOUR  
FIELD KING PROFESSIONAL SPRAYER  
190437, 190438



**1. Assemble Hose To Tank**

**IMPORTANT: Do not attempt to heat or alter hose, hose nut, or barb prior to assembly.**

1. Align hose barb tabs, push hose barb into tank until it stops (**See Figure A**).
2. Slide hose nut into place and turn clockwise to tighten. (**See Figure B**).

**NOTE: Do not use tools to tighten hose nut.**

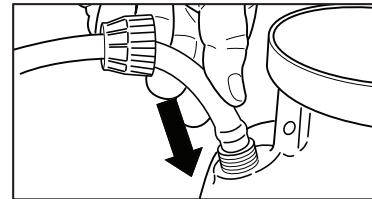

**Figure A**

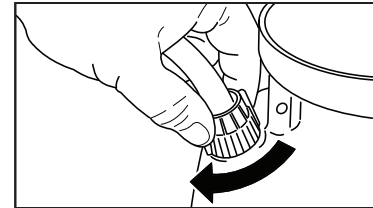

**Figure B**

**2. Assemble Wand & Nozzle**

Place nozzle onto the end of the wand assembly and tighten securely. (**See Figure C**)

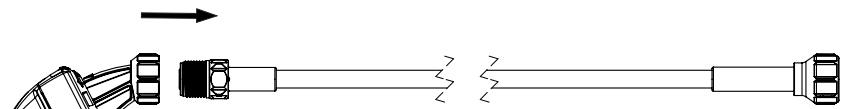

**Figure C**

**3. Assemble Shut-off to Wand**

Screw on Wand Assembly to end of Shut-off and tighten securely. (**See Figure D**)

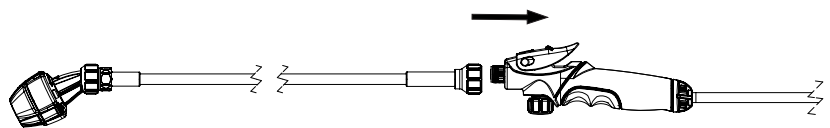
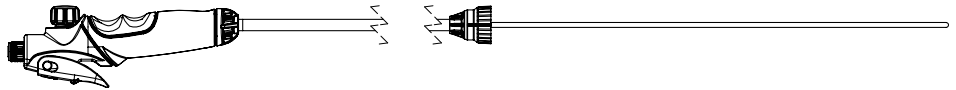

**Figure D**

PARTS INCLUDED WITH YOUR  
FIELD KING PROFESSIONAL SPRAYER  
190437, 190438



182397  
SHUT-OFF ASSEMBLY



182455  
15" ALUM EXTENSION

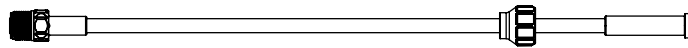

182395  
3-WAY NOZZLE

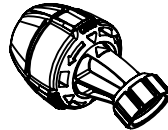

182618  
WARRANTY CARD



182617  
MANUAL