

# Product & Packaging Specs

## 4" Standard Rafter Clip (RC-IW-4)

Item #: 51718

ITEM NO.	QTY.	PART NUMBER	DESCRIPTION
1	0.2	56621	1 1/2" Hex Cap Nut
2	6	80014	Screw, FHP #12 X 1.25", Black
3	0.08	56625	OWT Timber Screw 1-3/4"
4	1	51718-11	Clip, 4" Rafter

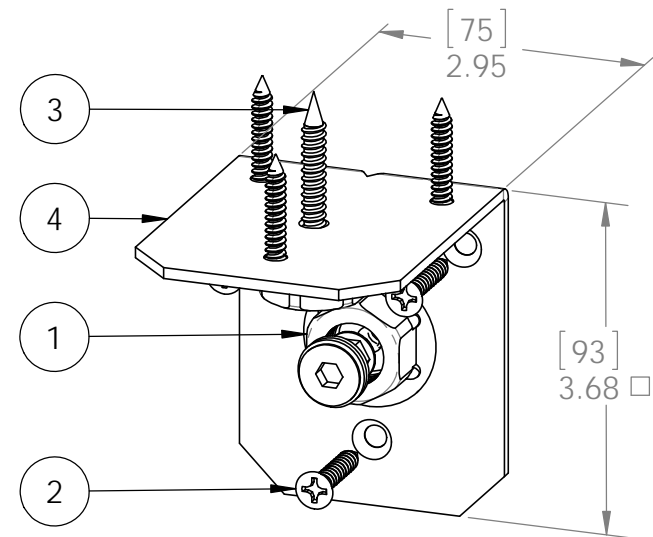
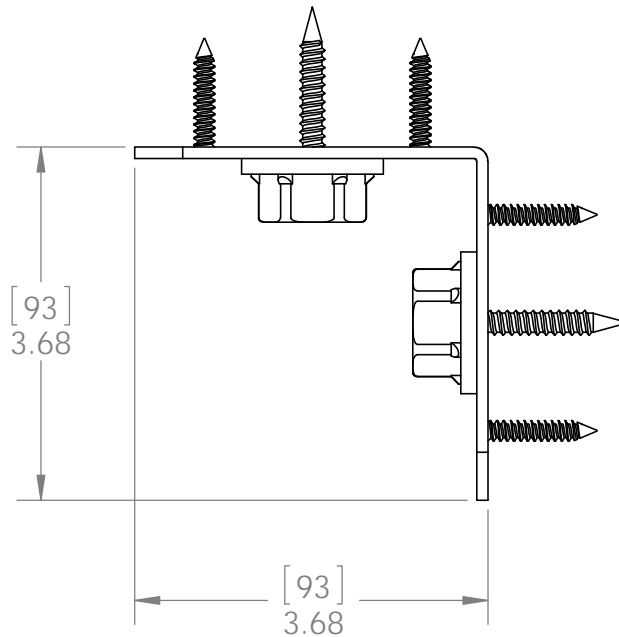
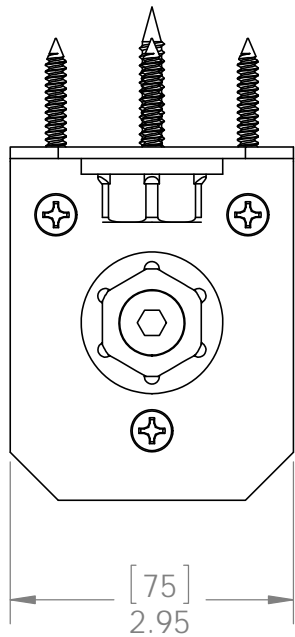

Weight: 9.98 LBS  
 Scale: 1:2  
 Last updated: 9/12/2015

51718

# Product & Packaging Specs

## 4" Standard Rafter Clip (RC-IW-4)

Item #: 51718

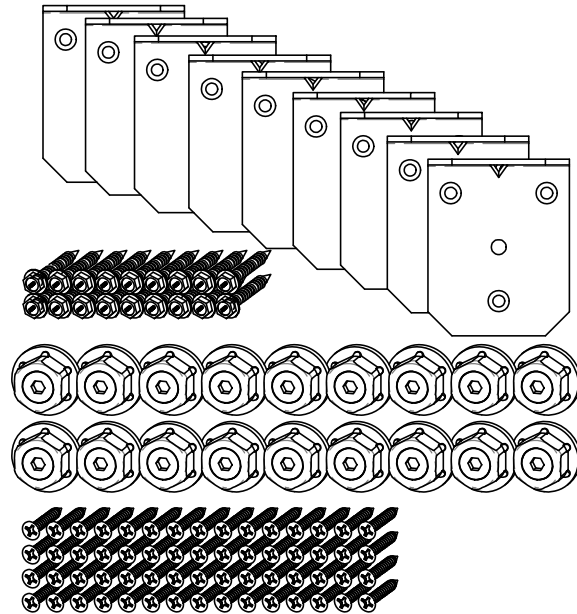
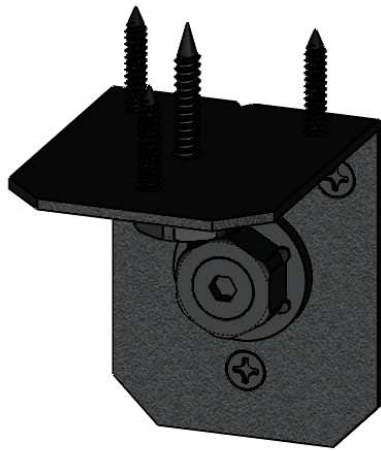
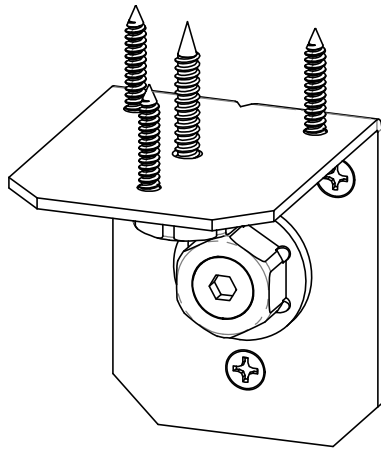

Weight: 9.98 LBS  
Scale: 1:2  
Last updated: 9/12/2015

51718

# Product & Packaging Specs

## 4" Standard Rafter Clip (RC-IW-4)

Item #: Typical Installation & Basic Assembly

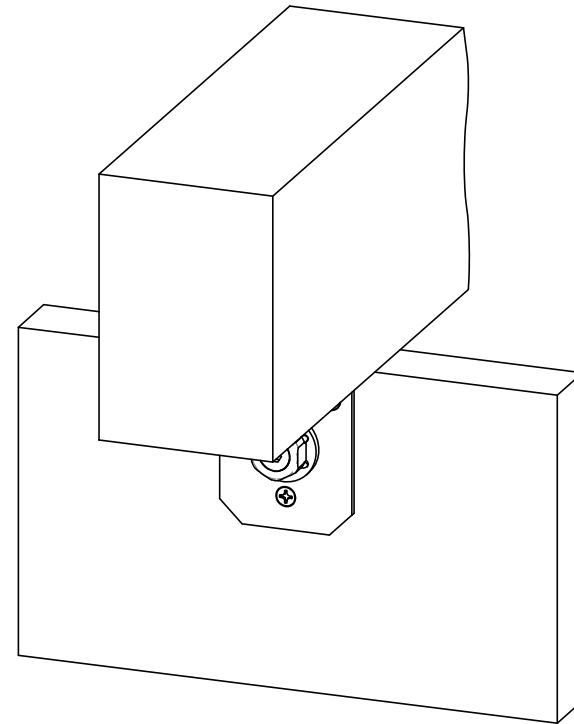
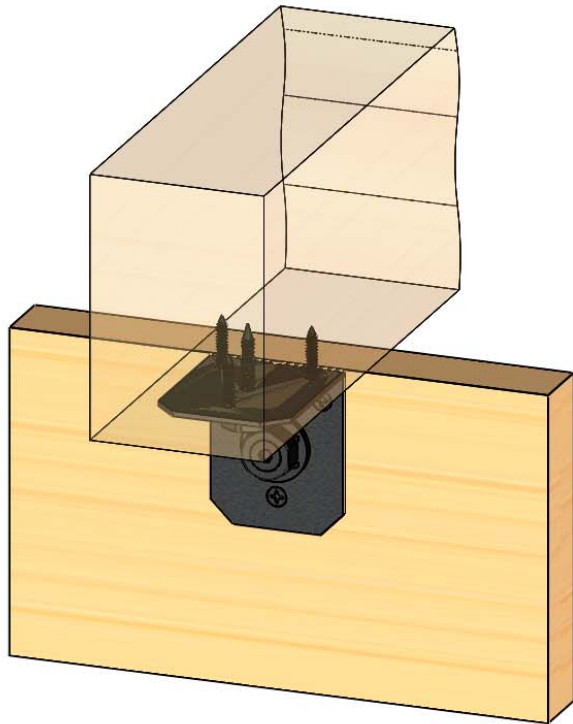

Scale: 1:4  
Last updated: 9/12/2015

51718

# Product & Packaging Specs

## 4" Standard Rafter Clip (RC-IW-4)

Item #: Typical Installation & Basic Assembly

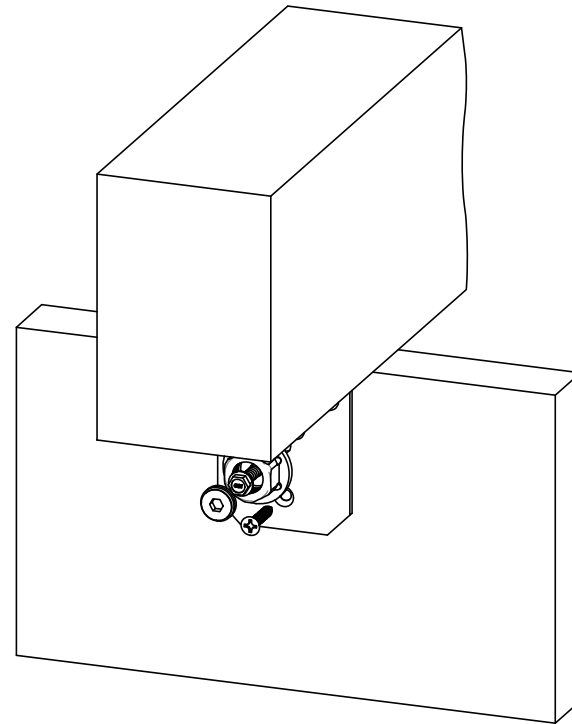
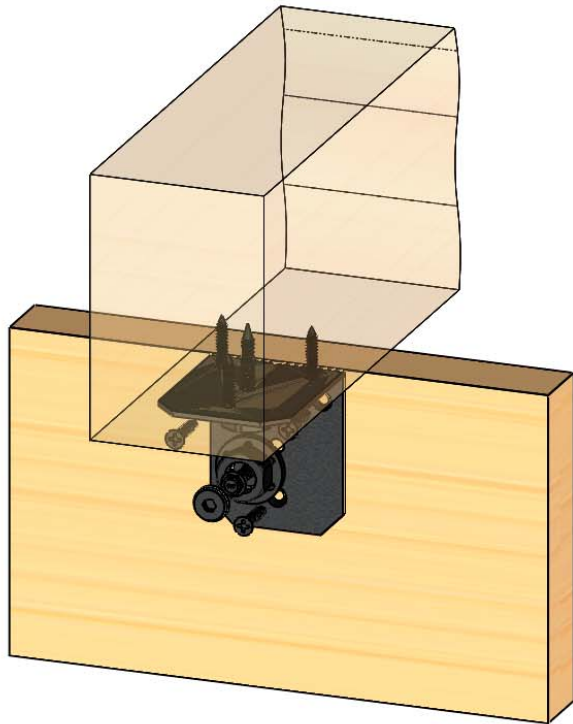

Scale: 1:4  
Last updated: 9/12/2015

51718

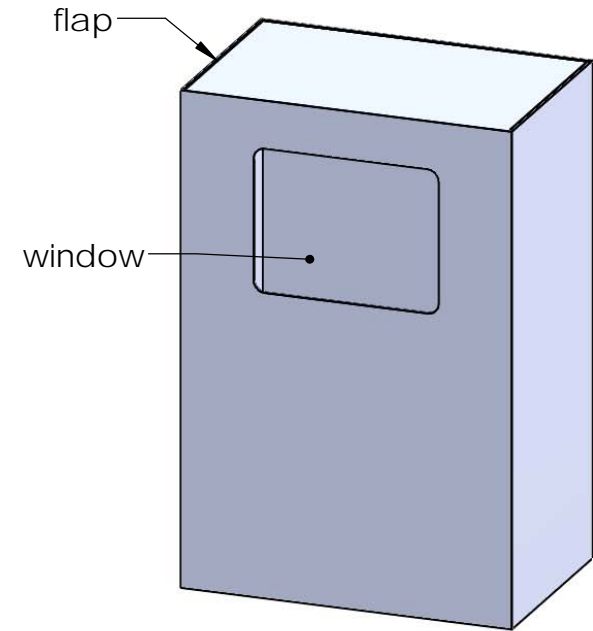
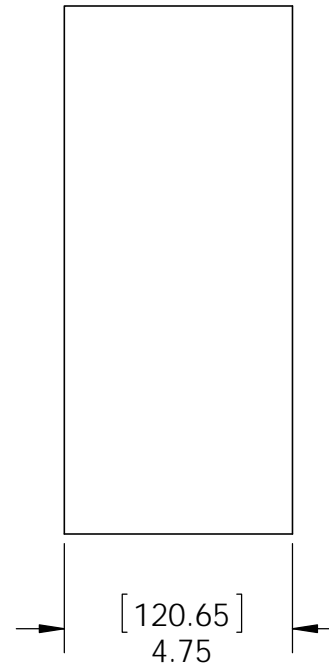
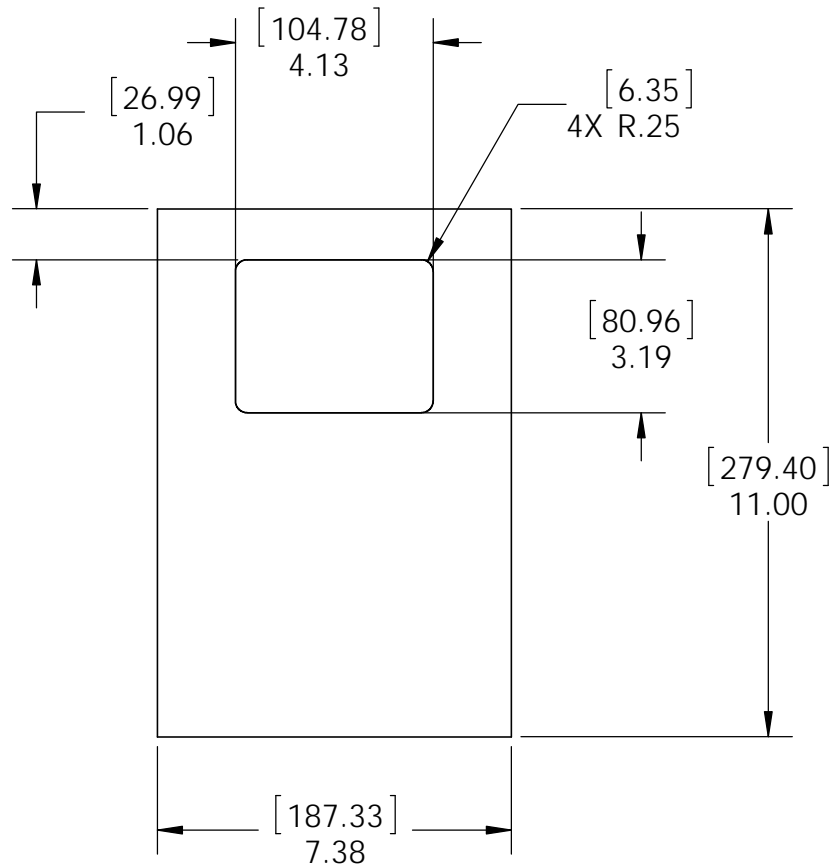

Material: Corrugated Paper  
 Finish: See Artwork  
 Weight: 0.07 LBS  
 Scale: 1:4  
 Last updated: 9/12/2015

51718

# Product & Packaging Specs

## 51718 Packing

Item #: Box packing

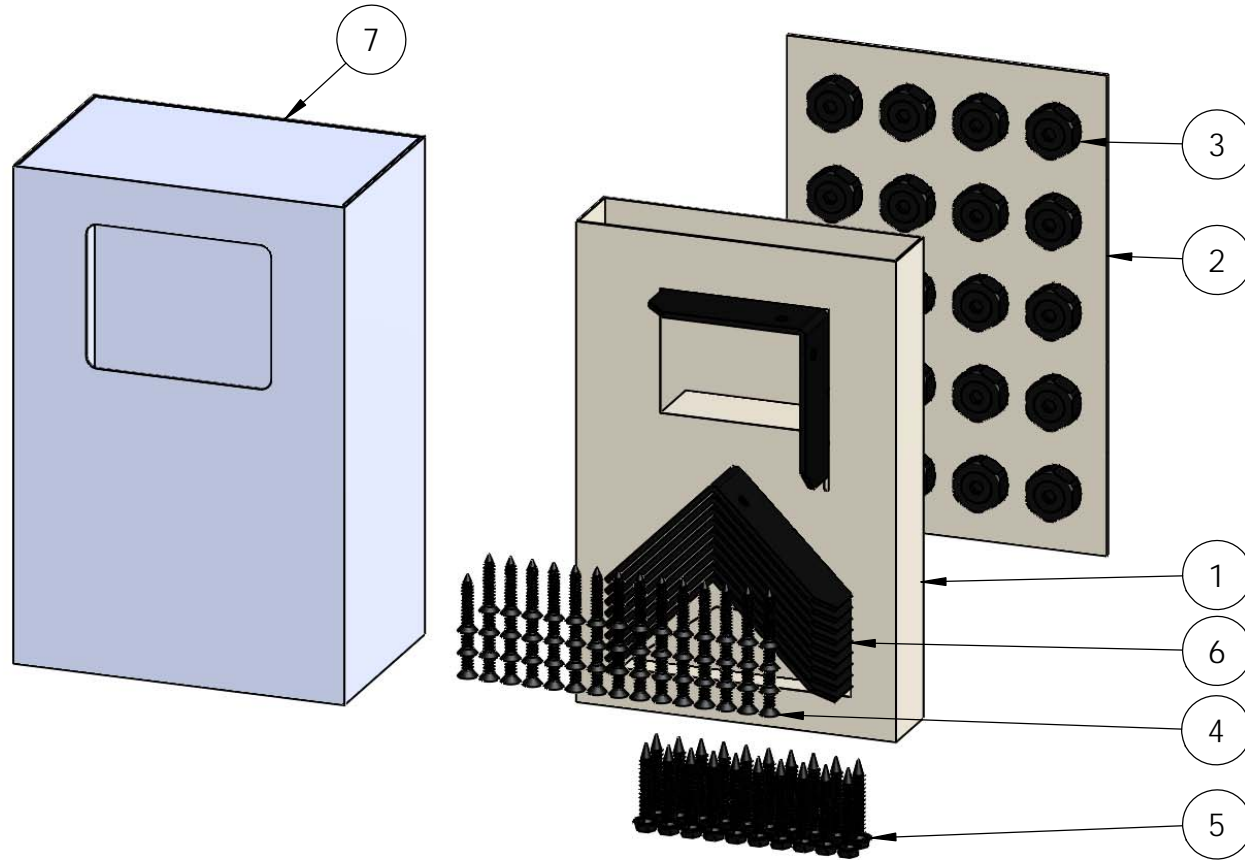

ITEM NO.	QTY.	PART NUMBER	DESCRIPTION
1	1	Insert, 56618	Insert, 56618
2	1	Insert, 56618	Insert, 56618
3	2	56621	1 1/2" Hex Cap Nut
4	60	80014	Screw, FHP #12 X 1.25", Black
5	0.8	56625	OWT Timber Screw 1-3/4"
6	10	51718-11	Clip, 4" Rafter
7	1	Box, 51718	Box, 51718

Weight: 8.63 LBS  
 Scale: 1:4  
 Last updated: 9/12/2015

51718

# Product & Packaging Specs

Case, 51718

Item #: Case

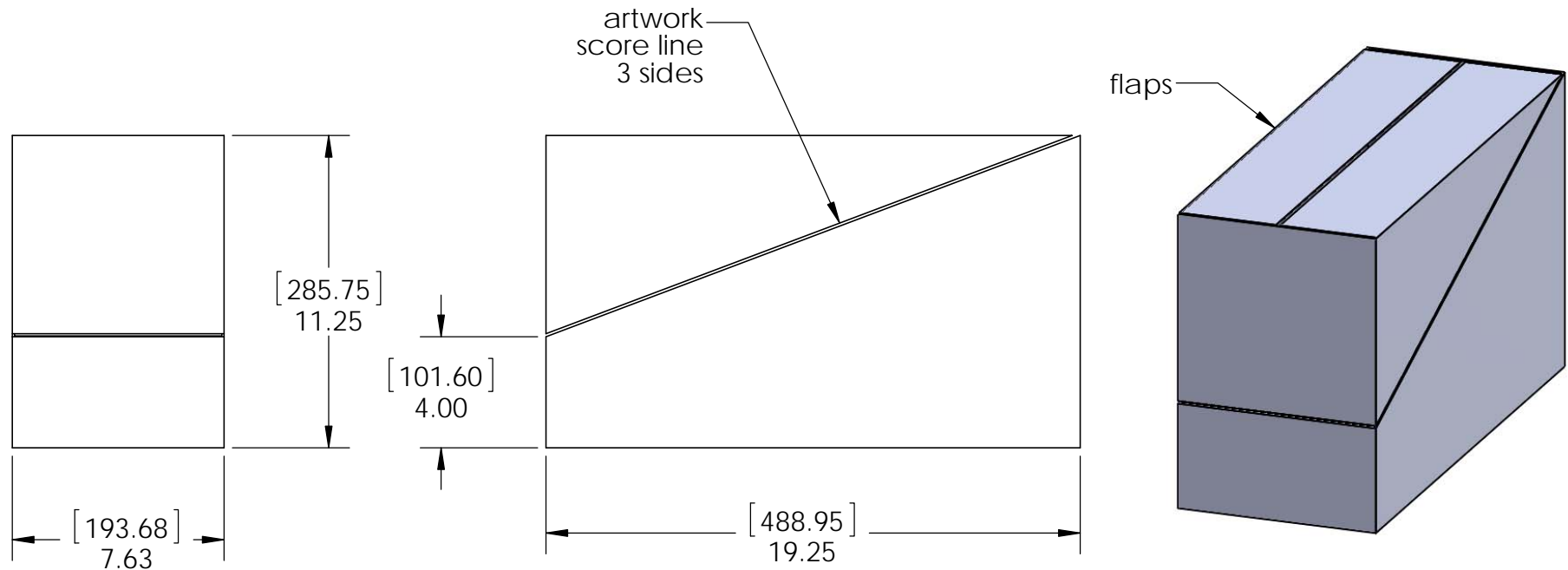

Material: Corrugated Paper  
 Finish: See Artwork  
 Weight: 0.36 LBS  
 Scale: 1:6  
 Last updated: 9/12/2015

51718

# Product & Packaging Specs

51718 Packing

Item #: Case packing

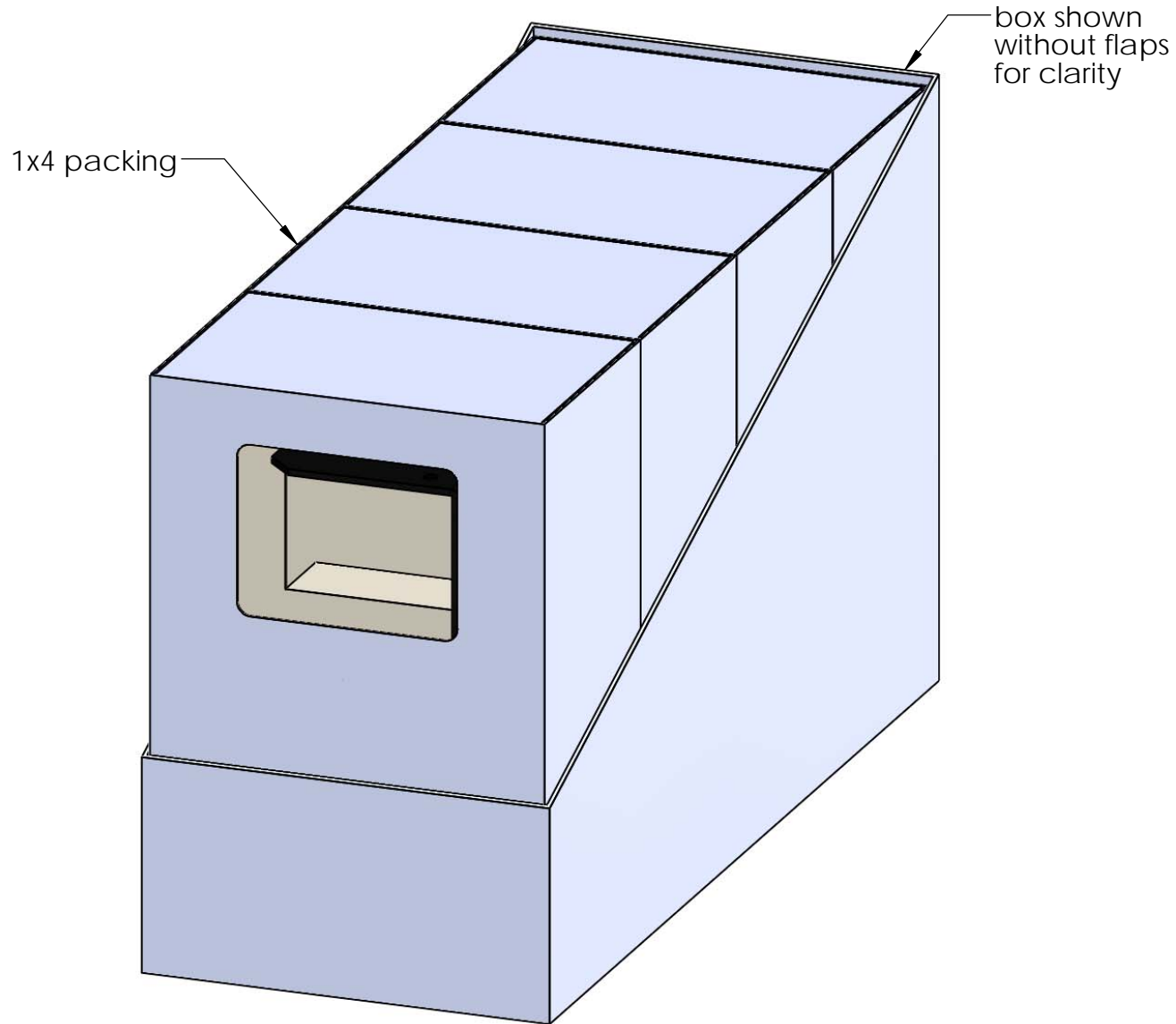

Weight: 31.92 LBS  
Scale: 1:3  
Last updated: 9/12/2015

51718



# Product & Packaging Specs

## 51718 Packing

Item #: Pallet packing

ADD PALLET LABEL

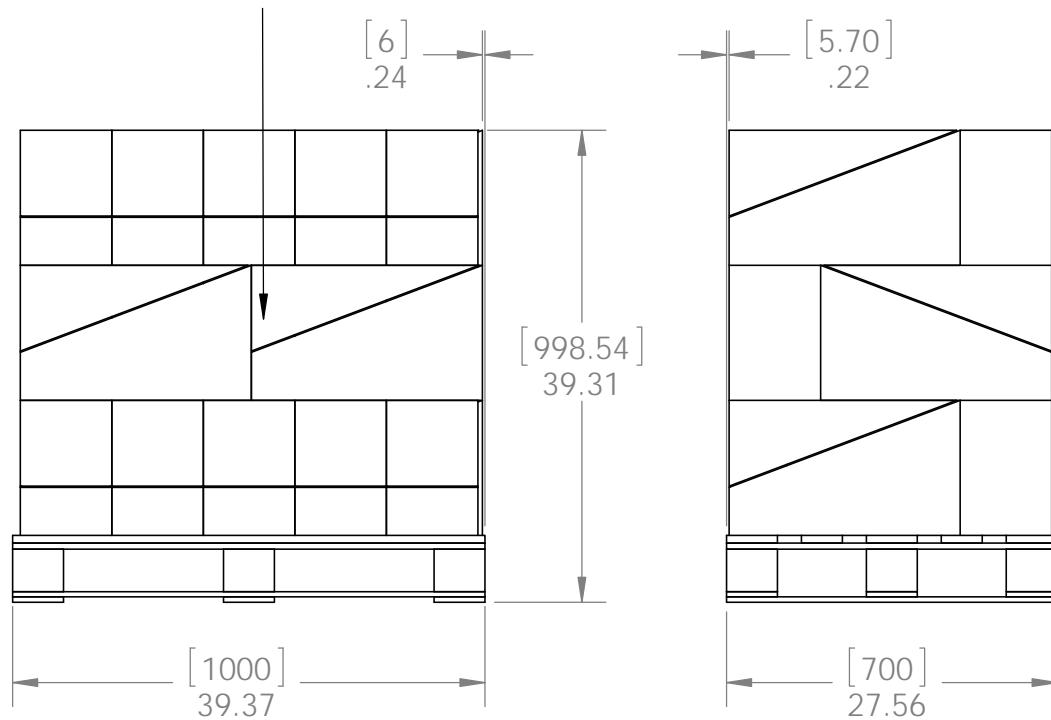

Total number of cases: 21  
 Total number of pieces:  
 21x4=84 pieces on pallet

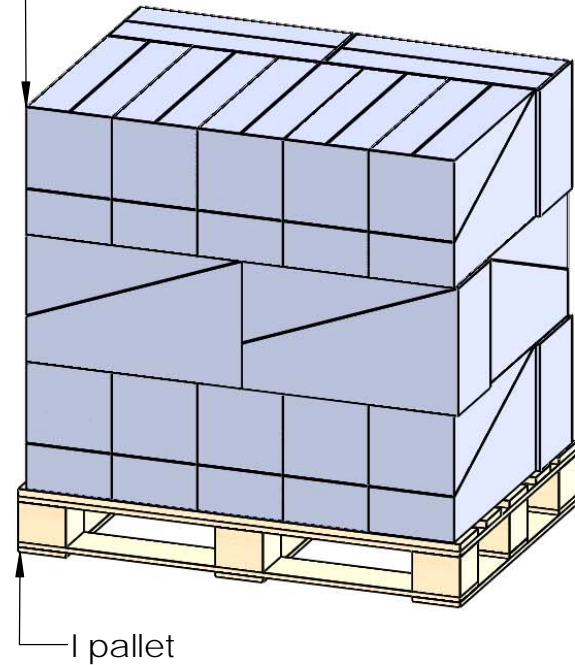

additional pallet packing instructions

- plywood on top layer
- strap to pallet
- clear wrap around boxes

Weight: 721 LBS  
 Scale: 1:16  
 Last updated: 9/12/2015

51718