



# POULANPRO®



## PRLM21i

# Contents

INTRODUCTION.....	2	OPERATION.....	8
SAFETY.....	3	MAINTENANCE.....	9
ASSEMBLY.....	6	TRANSPORTATION AND STORAGE.....	12

## INTRODUCTION

### Operator's manual

The initial language of this operator's manual is English. Operator's manuals in other languages are translations from English.

### Overview

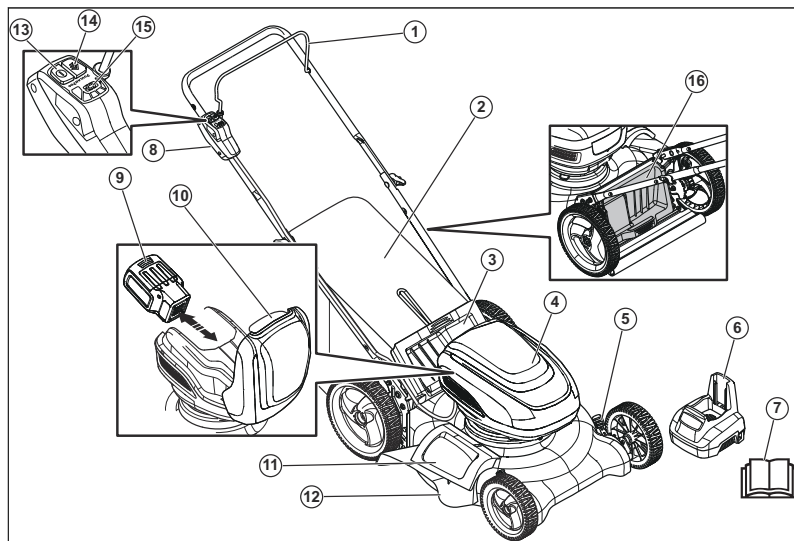

1. Motor control handle
2. Grass catcher
3. Rear door
4. Electrical powerhead
5. Cutting height control
6. Battery charger
7. Operator's manual
8. User control interface
9. Battery pack
10. Battery cover
11. Side discharge guard
12. Side discharge deflector
13. Power button
14. Cutting mode button
15. State of charge lights
16. Rear door

### Symbols on the product



Warning



Read this manual



Use approved eye protection



Use approved hearing protection



Use approved head protection



Warning: rotating blade. Keep hands and feet clear.



Look out for thrown objects and ricochets.



Do not let children near the product



Slope hazard



Electrical shock



The product or packaging cannot be handled as domestic waste. The product

and packaging must be submitted to an appropriate recycling station for the recovery of electrical and electronic equipment.



Do not leave, store or use in the rain or in wet conditions.



Recycle

## Product liability

As referred to in the product liability laws, we are not liable for damages that our product causes if:

- the product is incorrectly repaired.
- the product is repaired with parts that are not from the manufacturer or not approved by the manufacturer.
- the product has an accessory that is not from the manufacturer or not approved by the manufacturer.
- the product is not repaired at an approved service center or by an approved authority.

# SAFETY

## Safety definitions

The definitions below give the level of severity for each signal word.



**WARNING:** Injury to persons.



**CAUTION:** Damage to the product.

**Note:** This information makes the product easier to use.

## General safety instructions

- Use the product correctly. Injury or death is a possible result of incorrect use. Only use the product for the tasks found in this manual. Do not use the product for other tasks.
- Read, understand and obey the instructions in this manual. Obey the safety symbols and the safety instructions. If the operator does not obey the instructions and the symbols, injury, damage or death is a possible result.
- Do not discard this manual. Use the instructions to assemble, to operate and to keep your product

in good condition. Use the instructions for correct installation of attachments and accessories. Only use approved attachments and accessories.

- Do not use a damaged product. Obey the maintenance schedule. Only do the maintenance work that you find an instruction about in this manual. An approved service center must do all other maintenance work.
- This manual cannot include all situations that can occur when you use the product. Be careful and use common sense. Do not operate the product or do maintenance on the product if you are not sure about the situation. Speak to a product expert, your dealer, service agent or approved service center for information.
- Do not use the product if it is changed from its initial specification. Do not change a part of the product without approval from the manufacturer. Only use parts that are approved by the manufacturer. Injury or death is a possible result of incorrect maintenance.
- This product makes an electromagnetic field during operation. The electromagnetic field can cause damage to medical implants. Speak to your physician and medical implant manufacturer before you operate the product.
- Do not let a child operate the product.
- Do not let a person, without knowledge of the instructions, operate the product.

- Always monitor a person, with decreased physical capacity or mental capacity, that uses the product. A responsible adult must always be there.
- Lock the product in an area that children and not approved persons cannot access.
- The product can eject objects and cause injuries. Obey the safety instructions to decrease the risk of injury or death.
- Do not go away from the product while it is on. Stop the product before you go.
- Before and while walking rearward, look behind and down for small children, animals or other risks that can cause you to fall.
- The operator of the product is responsible if an accident occurs.
- Make sure that parts are not damaged before you use the product.
- Refer to national or local laws. They can prevent or decrease the operation of the product in some conditions.
- Do not point ejected material in the direction of others. Do not eject material against a wall or blockage. Material may ricochet back in the direction of the operator.
- Do not operate the product without the correct guards, plates, grass catcher or other safety protective devices in position.

### Work area safety

- Remove branches, twigs, stones and other objects from the lawn before you start to cut.
- Keep persons, including children, and animals at a safe distance from the work area.
- Objects that hit against the cutting equipment can be ejected and cause damage to persons and objects.
- Do not use the product in bad weather, including fog, rain, moist or wet locations, strong winds, intense cold and risk of lightning. Doing work in bad weather can cause fatigue and dangerous conditions, such as slippery surfaces.
- Examine your work area to make sure that your control of the product cannot be prevented.
- Be careful of roots, stones, twigs, pits and ditches. High grass can conceal obstacles.
- Be careful when you go near hidden corners and objects that can prevent your view.

### Safety instructions for operation

- Know the controls and the correct operation of the product before use.
- Do not let children or persons without knowledge of these instructions use the product.
- Do not operate the product while persons, especially children, or animals are near.
- Keep children away from the area to be cut and monitored by an adult.
- Stop the product if children enter the work area.
- Fully examine the area where the product is to be used. Remove all objects which can be ejected by the product during operation.
- Examine the blade, blade bolt, blade assembly and motor base before use for wear and damage.
- Operate the product only in daylight or in good artificial light.
- Do not operate the product in wet grass.
- Be careful near corners, bushes, trees or other objects that can prevent your view.
- Use very high caution when you reverse or pull the product in your direction.
- Do not put hands or feet near or below rotating parts. Always keep clear of the discharge openings.
- Stop the blade when you go across gravel surfaces.
- Stop the motor, remove the battery pack and wait until the blade stops fully before you clean the product, remove the grass catcher or remove material from the discharge chute.
- Do not operate the product when you are tired, ill or under the influence of alcohol or other drugs.
- If the product has unusual vibration, stop the motor, remove the battery pack and check immediately for the cause. Vibration is usually a warning of damage.

### Safety instructions for slopes

- Be careful when you cut on a slope. Slopes can be dangerous. A fall on a slope can cause injury.
- Cut across the face of slopes. Do not cut up and down.
- Be careful when you change direction on a slope.
- Be careful of hidden objects or holes in the lawn. Rough terrain can cause you to fall.
- Do not cut near a steep slope, drop-off, ditch or embankment. You can fall.
- Do not cut on wet grass. You can fall.
- Do not cut on terrain with more than a 15 degree slope.

### Personal protective equipment

Always use the correct personal protective equipment when you operate the product. This includes, at minimum, sturdy footwear, eye protection and hearing protection. Personal protective equipment does not erase the risk of injury but may decrease the grade of injury if an accident occurs.

- Always wear safety glasses or eye protection while you operate the product or do maintenance or repairs.
- Do not operate the product with bare feet or with open shoes. Always use heavy-duty slip-resistant boots with good ankle support while you operate the product.
- Wear heavy, long pants. Do not wear shorts, sandals or go bare foot.

- Use approved protective gloves, if necessary. For example, when attaching, examining or cleaning the blade.
- Always use approved ear protection while you operate the product. Noise for a long period can cause noise-induced hearing loss.

### Protective devices on the product

- Make sure that you regularly do the maintenance to the product.
  - The life of the product increases.
  - The risk of accidents decreases.

Let an approved dealer or an approved service center regularly examine the product to do adjustments or repairs.

- Do not use a product with damaged protective equipment. If the product is damaged, speak to an approved service center.

### Motor control handle

The motor control handle stops the motor. Make sure that the motor stops when the motor control handle is released.

- Start the motor and then release the control handle. The motor then stops.

**Note:** If the motor control handle does not stop the motor, press the power button to stop it. Remove the battery pack and speak to an approved service center.

### Rear deflector and rear door

The rear deflector and rear door decrease the risk of objects being ejected from behind the product into the operator's mow position. The rear deflector is attached between the rear wheels of your product.

- Make sure the rear door is not damaged and that no defects are in view, such as cracks or broken springs. Defects cause the door to close with force. Replace the door or springs if damaged.
- Make sure the rear deflector is not damaged and that no defects are in view, such as cracks or missing hardware. Make sure the deflector is free to rotate. Replace the deflector or hardware if damaged.

### Safety instructions for maintenance



**WARNING:** Only do the maintenance work written in this operator's manual. More extensive work must be done by an approved service agent.

Do the maintenance work correctly to increase the lifetime of the product and decrease the risk of accidents. An approved service agent can do professional repairs. Speak to your

nearest service agent for more information.



**WARNING:** To prevent accidental start during transport, maintenance or repair work, remove the battery pack and wait at minimum 5 seconds to replace it.



**WARNING:** Wear heavy duty gloves when you use the cutting equipment. The blade is very sharp and cuts can easily occur.

- Keep cutting edges sharp and clean for the best and safest performance.
- Let your service agent regularly examine the product and make necessary adjustments and repairs.
- Replace damaged, worn or broken parts.
- Obey instructions for changing accessories. Only use accessories from the manufacturer.



**WARNING:** When not in operation, keep the product, battery pack and battery charger separately in a dry, indoor and lockable area away from children and not approved persons.

### Battery safety

Only use battery packs from the manufacturer and only charge them in a battery charger from the manufacturer.

The rechargeable battery packs are only used as a power supply for related cordless products. To prevent injury, the battery pack must not be used as a power source for other devices.

- Do not disassemble, open or shred battery pack.
- Do not keep battery packs in open sunlight or heat. Keep battery packs away from fire.
- Regularly examine the battery pack charger and the battery pack for damage. Damaged or changed battery packs can cause a fire, explosion or risk of injury. Do not repair or open damaged battery packs.
- Do not use a battery pack or product that is defective, changed or damaged.
- Do not change or repair products or the battery pack. Only let your approved dealer do repairs.
- Do not short circuit a cell or battery pack. Do not save battery packs in a box or drawer where they can be short circuited by other metal objects.
- Do not remove a battery pack from its initial package until necessary for operation.
- Do not mechanically shock battery packs.
- If there is a battery leak, do not let the liquid touch the skin or eyes. If you have touched the liquid, clean the area with a large quantity of water and get medical aid.

- Do not use a battery charger other than what is specified for operation with the battery pack.
- Look at the plus (+) and minus (-) marks on the battery pack and product to make sure of correct operation.
- Do not use a battery pack not made for operation with the product.
- Do not mix battery packs of a different voltage or manufacturer in a device.
- Keep battery packs away from children.
- Always purchase the correct battery packs for the product.
- Keep batteries clean and dry.
- Clean the battery pack terminals with a clean dry cloth if they become dirty.
- Secondary battery packs must be charged before use. Always use the correct battery charger and

refer to the manual for correct charging instructions.

- Do not keep a battery pack on continuous charge when not in operation.
- Save the manual to refer to it in the future.
- Only use the battery pack for its necessary operation.
- Remove the battery pack from the product when not in operation.
- Keep the battery pack away from paper clips, keys, nails, screws, or other small metal objects while in operation. This can make a connection between terminals. Shorting the battery pack terminals together can cause burns or a fire.

---

## ASSEMBLY

---



**WARNING:** Read the safety chapter before you assemble the product.

### To remove the product from the carton

1. Remove loose parts included with the product.
2. Cut down the two end corners of the carton and put the end panel down flat.
3. Remove all package materials.
4. Remove the product from the carton and make sure no loose parts are left in the carton.

### To set the operation position

1. Lift the lower handle section to operation position.

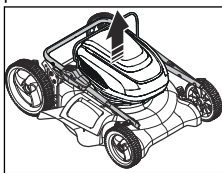

2. Install the supplied carriage bolts in the handle and through the handle brackets. Tighten the nuts with a 1/2 in wrench.

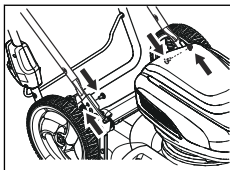

3. Lift the upper handle section into position on the lower handle and tighten the two top knobs.

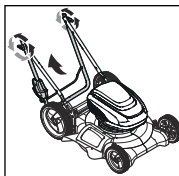

4. Discard all remaining package material from the motor control handle.

### To set the product in transport position

1. Loosen the two handle knobs on the upper handle. Let the handle fold down to the rear.

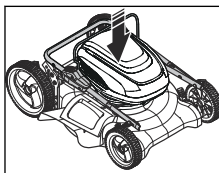

2. Remove the carriage bolts and nuts that attach the lower handles to the handle brackets.
3. Pivot the full handle assembly forward and let it become stable on the handle brackets.

### To assemble the grass catcher

1. Attach the grass catcher frame to the grass bag with the rigid part of the bag on the bottom. Keep the handle of the frame out of the top of the bag.

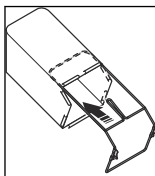

2. Attach the grass bag to the frame with the quick-action clips.

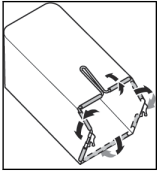

## To change the product to bagging mode

Rear bagging mode collects grass clippings in the grass catcher.



**CAUTION:** Do not operate the product without the rear door closed or the approved grass catcher in position. Do not try to operate the product with the rear door removed or open.

1. Lift the rear door and put the grass catcher frame hooks on the rear door pivot.

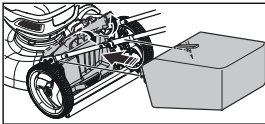

2. Release the rear door and put it on top of the grass bag frame.
3. Remove the side discharging deflector, if installed, and let the side discharge guard close. Make sure that the side discharge door is tightly closed against the product.

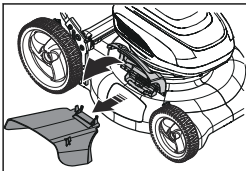

## To change the product to mulching mode

The mulching mode of the product makes grass clippings smaller. The grass clippings then fall onto the lawn and across the grass. Mulched grass biodegrades quickly to give nutrients for the lawn.

1. Lift the rear door and remove the grass bag, if installed, and let the back shield close. Make sure that the rear door is tightly closed against the product.

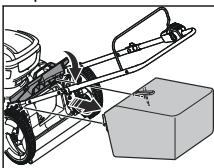

2. Remove the side discharging deflector, if installed, and let the side discharge guard close. Make sure that the side discharge door is tightly closed against the product.

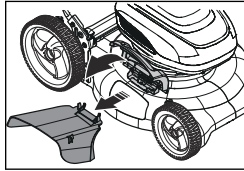

## To change the product to side discharging mode

The side discharging mode of the product is the best cutting mode for a battery powered electrical mower. If you try to cut a large quantity of grass and experience bogging of the motor, or have decreased operation time, change the product to side discharging mode to increase performance and operation time.

1. Lift the rear door and remove the grass bag, if installed.

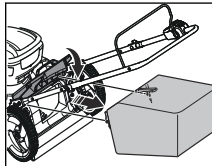

2. Let the rear door close. Make sure that the rear door is tightly closed against the product.
3. Open the side discharge guard and install the side discharge deflector.

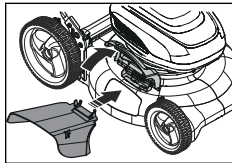

4. Let the side discharge guard close against the deflector. Make sure that the deflector is tightly in position before you operate the product.

## To set the cutting height

The cutting height can be adjusted to 5 (1-5) different positions. Lift the wheels for a lower cut and lower the wheels for a higher cut. The medium position is best for most lawns.



**Note:** The adjuster lever is spring loaded.

1. Squeeze the height adjuster lever in the direction of the wheel.

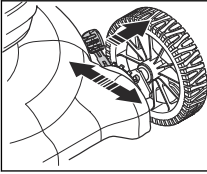

2. Move the wheel up or down for your cutting requirements.
3. Set the same height at all four corners.

## OPERATION



**WARNING:** Read and understand the safety chapter before you operate the product.

### Basic cutting technique

- Always cut with a sharp blade for the best results. A blade that is not sharp cuts unevenly and lets the grass become yellow on the surface of the cut.
- Do not cut more than 1/3 of the length of the grass. This specially applies during dry periods. Cut first with the cutting height set high. Then examine the result and lower to an applicable height. If the grass is too long, operate slowly and cut two times if necessary.
- For very heavy cutting, decrease the width of the cut by making an overlap of the cut path and cutting slowly.
- Cut in different directions each time to prevent stripes in the lawn.
- Regularly hose the grass catcher with water and let dry before use. Pores in cloth grass catchers can become filled with dirt and dust with operation. The grass catcher will then collect less grass.
- The side discharging mode of your product is the best cutting mode. If you try to cut a large quantity of grass and the product runs poorly or has decreased operation time, change the product to side discharging mode for better performance and operation time.

### Before you start the mower

- Keep persons and animals away from the work area.
- Do daily maintenance. See *MAINTENANCE* on page 9.

### To start the product

1. Put in the battery pack until you hear a click. Make sure the battery pack is correctly installed.

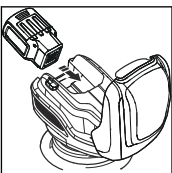

2. Press the power button one time. The button illuminates fully.

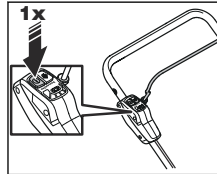

3. Pull the motor control handle in the direction of the handlebar. The power button starts to flash.

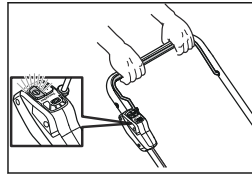

4. Press the flashing power button. The product then starts.

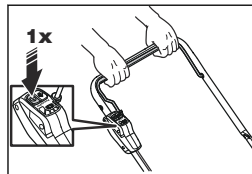

### To stop the product

- Release the motor control handle on the product, or press the power button one time.

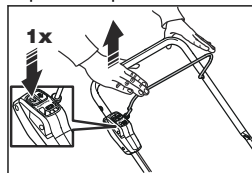

### To empty the grass catcher

1. Lift the grass catcher with the frame handle.
2. Remove grass clippings from the grass catcher from below the handle.
3. Empty grass clippings from the bag with the frame handle and the bag handle.





**CAUTION:** Do not drag the bag when you empty the grass catcher to prevent wear.

## To change the cutting mode

The product can be changed to one of three different cutting modes while in operation by pressing the cutting mode button.

- **Auto mode** - The product automatically adjusts the cutting speed of the product in response to the quantity of grass being cut.
  - **Note:** The product is set to Auto mode by default while in operation.
- **Boost mode** - The product operates at high speed regardless of the quantity of grass being cut.
  - While the product is in operation, press the cutting mode button one time to change from Auto mode to Boost mode. The cutting mode button then illuminates.
- **ECO mode** - The product operates at low speed regardless of the quantity of grass being cut.
  - While the product is in operation, press the cutting mode button one time to change from Boost mode to ECO mode. The cutting mode button then illuminates and flashes.
  - To go back to the default Auto mode, press the cutting mode button one time while the product is in operation. The cutting mode button then stops flashing.

**Note:** If the motor control handle is released during operation, the product stays in the current cutting

mode. If the product automatically stops, or the operator presses the power button, the cutting mode used before is erased from memory and the product starts in Auto mode when started again.

## Battery status indication during operation

The display on the user control interface shows the battery capacity and if there are problems with the battery pack. The battery capacity is shown while the machine is in operation.

LED lights	Battery status
All Green LEDs come on	Fully Charged (100% - 76%)
LED 1, 2 and 3 come on	The battery pack is 75% - 51% charged.
LED 1 and 2 come on	The battery pack is 50% - 26% charged.
LED 1 comes on	The battery pack is 25% - 6% charged.
LED 1 flashes	The battery pack is 5% - 0% charged.

If there is an error with the battery pack during operation, all four green LEDs of the battery state of charge display flash. Remove the battery pack from the machine and press the indicator button on the battery pack to show the error code for the error. The LED's on the battery pack illuminate and show an error code if an error has occurred. Consult the battery manual for a list of error codes and solutions to the errors.

# MAINTENANCE



**WARNING:** Read and understand the safety chapter before you clean, repair or do maintenance on the product.

## General recommendations for maintenance

The warranty on this product does not include incorrect or not careful operation of the product by the operator. To receive full value from the warranty, the operator must do maintenance on the product as written in the instructions of this manual. Different adjustments must be made at different intervals to keep your product in correct work condition.

- Examine the blade for wear each year.

## To examine the tires

- Keep the tires free of unwanted material and chemicals to prevent damage to the rubber.

- Keep the tires away from stumps, stones, ruts, sharp objects and other objects which can cause damage to the tires.

## To do a general inspection

- Check that nuts and screws are tight.
- Make sure no cables are pinched.

## Maintenance schedule

Use the maintenance schedule to see the necessary maintenance requirements of your product, and when the maintenance must occur. The intervals are calculated on average use of the product and may be different because of how frequently you use it.

- Tighten bolts and nuts before each use and before storage.
- Clean and examine the grass catcher, if installed, before and after each use, and before storage.
- Examine the tires before each use.
- Clean the product after each use and before storage. Use a scraper to clean below the deck.

- Examine the blade for damage and cracks in 25 hour intervals. Replace blades more frequently if you cut in sandy soil.
- Lubricate the product in 25 hour intervals.
- Clean and fully charge the battery pack after use and after storage. Charge the battery pack for max. 24 hours before storage.
- Do not keep the battery pack on the battery charger during storage. Charge the battery pack for a maximum of 24 hours.

## To clean the product

- Use a brush to remove unwanted material and grass on the product.
- Keep unwanted material off finished surfaces and wheels.
- Use a scraper below the product to remove the buildup of grass and waste.
- Do not use a high pressure washer to clean the product.
- Do not flush water directly on the electrical powerhead or battery contacts.
- When you clean below the product, remove the battery pack and put the product on its side with the user control interface pointing up.



**CAUTION:** Do not clean the product with water, cleaning fluids or solvents. Remove unwanted material external to the product with a soft brush or dry cloth that does not contain metal.

## To clean the grass catcher

- Pores in cloth grass catchers can become filled with dirt and dust during operation. This causes the grass catcher to collect less grass. To prevent this, regularly hose the grass catcher off with water and let dry before using.
- Examine the grass catcher frequently for wear or deterioration. Replace if necessary.

## To examine the door and deflector

The rear door and rear deflector are attached between the rear wheels of the product. They decrease the risk of objects that may be ejected in the direction of the mow position of the operator.

1. Make sure that the rear door and rear deflector are not damaged.
2. Examine the rear door and rear deflector. Make sure that there are no defects that push the door to close, including cracks or broken springs.
3. Replace the rear door and rear deflector or the springs if they are damaged.

## To replace the side discharge deflector

The side discharge deflector is attached to the side discharge opening of the product. It decreases the

risk of objects to eject in the direction of the mow position of the operator.

1. Make sure that the side discharge deflector is not damaged.
2. Examine the side discharge deflector. Make sure that you do not see defects, such as cracks or broken springs that push the door to close.
3. Replace the side discharge deflector or the springs if they are damaged.

## To sharpen and balance the blade

For best results, keep the blade sharp. Replace a bent or damaged blade.



**CAUTION:** Use gloves, and/or wind the blade with a heavy cloth, to prevent damage to your hands.

1. Sharpen the blade with a file or on a grinding wheel. Do not sharpen the blade when it is installed on the product.



**CAUTION:** We do not recommend that you sharpen the blade. If you do, make sure that the blade is balanced. A blade that is not balanced can cause damage to the product or motor.

2. Put a straight nail in a piece of wood or a wall. Make sure you can see 2-3 cm of the nail.
3. Put the center hole of the blade on the head of the nail. If the blade is balanced, it must stay in a horizontal position. If one of the two ends of the blade moves down, sharpen the heavy end until the blade is balanced.

## To replace the blade



**CAUTION:** Use gloves, and/or wind the blade with a heavy cloth, to prevent injury to your hands.

1. Always remove the battery pack before you do maintenance.
2. Lock the blade with a block of wood.

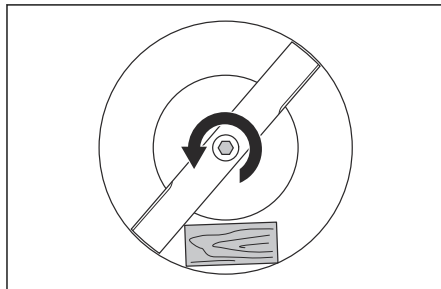

3. Remove the blade bolt.
4. Remove the blade.

5. Examine the blade support and blade bolt for damage.
6. Examine the motor shaft to make sure that it is not bent.
7. When you attach the new blade, point the angled ends of the blade in the direction of the cutting cover.

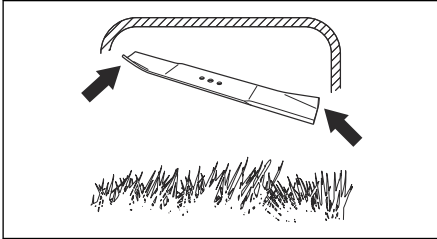

8. Lock the blade with a block of wood. Attach the spring washer and tighten the bolt and washer with a torque of 41-60 Nm.

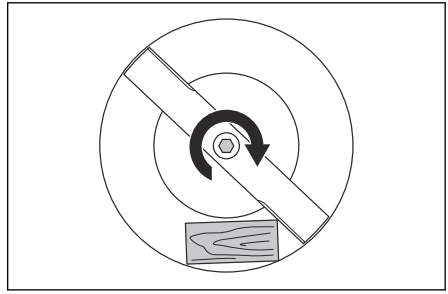

9. Pull the blade around by hand and make sure that it turns freely.
10. Start the product to do a test of the blade. If the blade is not correctly attached, then the vibration in the product or the cutting result is unsatisfactory.

## Error codes

The error codes help you do troubleshooting on the product and/or the battery pack while in operation.

LED screen	Possible faults	Possible steps
No LEDs come on after pressing the power button on the user control interface, battery pack does not function in product	Battery pack not fully put into product or internal fuse is blown	Push the battery pack fully into the powerhead until a click is heard. If the LEDs do not illuminate after the battery pack has been fully put in and the power button has been pressed on the user control interface, speak to an approved service center.
All four battery capacity LEDs flash, no other LEDs come on after pressing the power button	Battery pack not fully put into product or the internal temperature of the battery pack is too hot or too cold.	Push the battery pack fully into the powerhead until a click is heard. If the LEDs continue to flash, the internal temperature of the battery pack may be too low or too high. Allow the battery pack to warm up or cool. To increase the cooling process, the battery pack can be inserted into the battery charger to actively cool the battery pack.
All four battery capacity and power LEDs flash, no other LEDs come on after pressing the power button	Motor control handle held down when the power button is pressed for the first time or internal motor control handle switch failure	Release the motor control handle. If the motor control handle is not held down and the LEDs continue to flash, speak to an approved service center.

LED screen	Possible faults	Possible steps
<p>Product stops operating and all four battery capacity LED's flash, no other LEDs come on.</p>	<p>Battery pack is loose in the powerhead and no longer makes good contact, battery pack is too warm, or cold or other internal battery error</p>	<ol style="list-style-type: none"> <li>1. Stop the product.</li> <li>2. Remove battery pack from product and press the indicator button on the battery pack to show the error code. The LED's on the battery pack come on and show an error code.</li> <li>3. Read the included battery manual for a list of related LED error codes for possible faults and procedures.</li> </ol> <p>If the battery pack does not show an error after pressing the indicator button on the battery pack and only displays the state of charge, the battery pack may have come loose in the powerhead during operation. Install the battery pack correctly into the powerhead until a click is heard.</p>
<p>Product stops operating and the power button flashes while the battery capacity LED's continue to show the current state of charge</p>	<p>Cutting chamber is clogged with grass, motor controller is too warm, or motor fault</p>	<ol style="list-style-type: none"> <li>1. Stop the product.</li> <li>2. Remove the battery pack and turn the product on its side with the user control interface pointing up.</li> <li>3. Examine the blade, blade bolt, blade assembly, motor and motor base for damage. Clear all grass from the bottom of the machine and examine for clogs.</li> <li>4. Install the battery pack and follow the starting procedure to start the machine.</li> </ol> <p>If the error continues to show, let the product cool down. The motor controller may be too warm for operation. If the error continues to show, speak to an approved service center.</p>

---

## TRANSPORTATION AND STORAGE

---

- Keep equipment safe during transportation to prevent damage and accidents.
- For storage, keep equipment in a locked area away from children and persons that are not approved.
- For storage, keep the product and equipment in a dry and frost-proof area.
- When loading or moving the product, do not go more than the maximum recommended operation angle of 15 degrees.
- Clean the product. For more information, see *To clean the product on page 10*.
- Lubricate the product.
- Tighten bolts and nuts.
- Replace or repair damaged components.
- Touch up all rusted or damaged paint surfaces. Sand lightly before painting.
- Use the correct protective cover on the product that does not keep moisture. Do not use plastic because it cannot breathe, lets condensation collect and causes corrosion on the product.
- Always remove the battery pack prior to transportation or storage.







# POULANPRO®

[www.poulanpro.com](http://www.poulanpro.com)

Original instructions

115904127



2017-10-03