

# **Owner's Manual**

Electric Adjustable Bed

# Table of Contents

**Page**

IMPORTANT INFORMATION	3 - 4
WHAT IS INCLUDED	5
INSTALLATION GUIDE	6 - 7
WARNING	8

# IMPORTANT INFORMATION

PLEASE READ THESE INSTRUCTIONS THOROUGHLY BEFORE USING THIS PRODUCT. PROPER OPERATION OF YOUR ADJUSTABLE BED IS NECESSARY TO ENSURE THE LONG LIFE AND DURABILITY YOU EXPECT FROM A HIGH QUALITY PRODUCT.

## 1. Electric Safety

Please ensure you connect the base properly to the power supply. Any incorrect power connection may cause electric shock or fire. FOR OPTIMAL SAFETY, YOUR ADJUSTABLE BED SHOULD BE PLUGGED INTO A SURGE PROTECTOR (not supplied with this adjustable bed).

Always unplug this adjustable bed frame from the electrical outlet before any cleaning or maintenance of the bed frame. To safely disconnect, remove the plug from the outlet. Keep cord away from heated surface. Use only indoors.

## 2. Attention for moving parts

Keep body parts clear of all moving parts to avoid injury while the product is in use. Keep moving parts clear of obstruction during operation.

## 3. In-Home use only

This adjustable bed is designed exclusively for in-home use.

## 4. Small children and pets warning

This product is designed to be used by an adult. Do not allow children to operate this bed without adult supervision. Immediately dispose of all packing materials as they can pose a smothering risk to small children and pets. Injury could occur if children or pets are permitted to play on or under the bed

## **5. Lubrication and Cleaning**

This product is designed to be maintenance free. The lift motor are permanently lubricated and sealed-no additional lubrication is required. Do not apply lubricant to lift motor screws or any nylon nuts or the base may inadvertently shift downward from the elevated position.

## **6. LIFT WARNING**

**DO NOT SIT ON THE HEAD OR FOOT SECTIONS WHILE IN THE RAISED POSITION, OR DURING LIFT OR LOWERING CYCLES.**

## **7. MOVING AFTER INSTALLATION**

Do not place adjustable bed base vertically on its head or foot sections. This may cause injury to persons or damage to the base. Two people are required for moving this base due to its heavy weight.

## **8. WARRANTY WARNING!**

This bed is specifically designed to require no maintenance by you, the user. Any opening or tampering with the control box, motor or hand controls (with the exception of the battery compartment, if equipped) will void the warranty. Do not attempt to alter component wiring or adjust or modify the structure of the product in any way or the warranty will be void. Only those authorized may conduct repairs or part replacement on your adjustable bed.



# Assembly Instructions

Thank you for purchasing our Adjustable Base, Please take the time to read and follow the Instructions below.  
Please check that you have all parts and hardware before assembly:

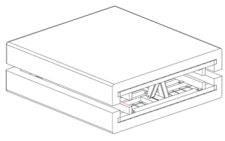

A  
Bed frame, 1pc

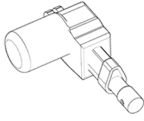

B  
Motors, 2pcs

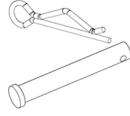

C  
Motor pin & clip,  
4 sets

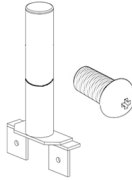

D  
Middle legs, 2pcs  
Middle Leg bolt, 4pcs

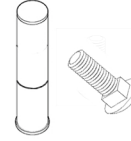

E  
Corner legs, 4pcs  
Corner leg bolts,  
4pcs



F  
Mattress bar  
2pcs

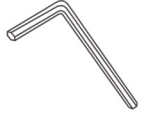

G  
Allen Key,  
1pc

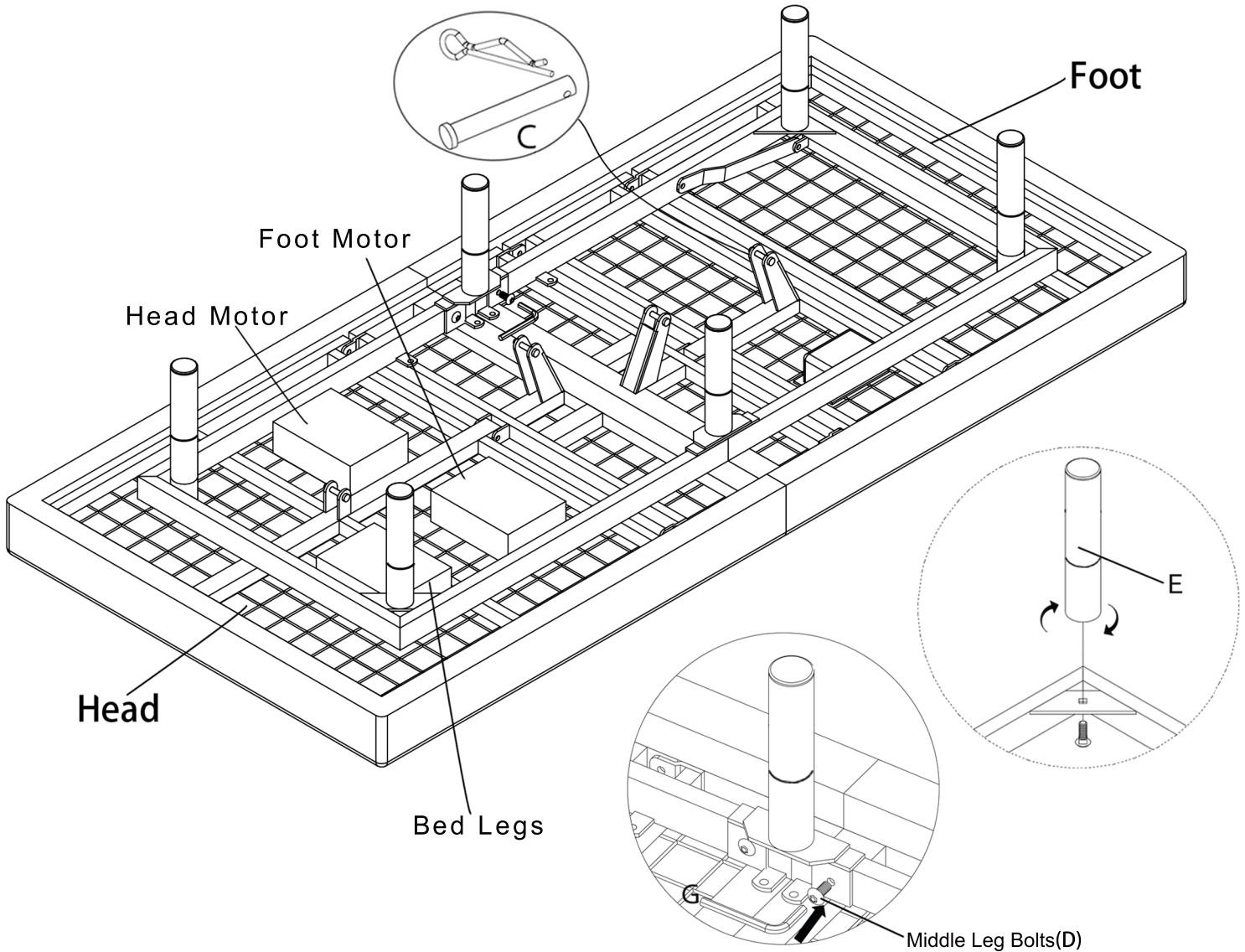

It's highly recommended to use two people for the installation of this product.

To assemble this product, please perform the following steps.

- Step1:**
- 1) Open the Box. Layout the bed frame and put the 2 sections next to each other as shown above;
  - 2) Locate the box containing the bed legs, tighten the 2 Middle Legs (D) with supplied Allen Key (G) and Middle Leg Bolts (D). Then tighten the 4 Corner Legs (E). Tighten firmly;
  - 3) Take motor pins and clips (C) out of the motor bracket (H);

# Assembly Instructions

## Step2

- 1) Open the Head and Foot motor,boxes.  
Use motor pins and clips (C) to assemble the motors (B) to the motor bracket (H) as shown.  
Keep the label "Facing Ground" on top when the motor is installed.
- 2) To ensure your power base is wired properly,please follow "a,b,c,d" as shown,  
Make sure all cords inserted properly.

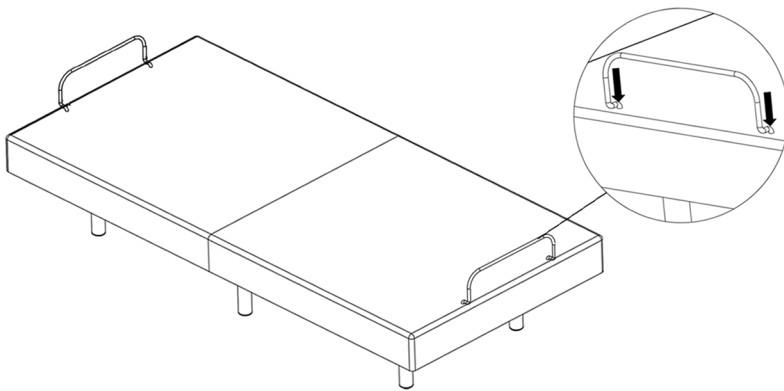
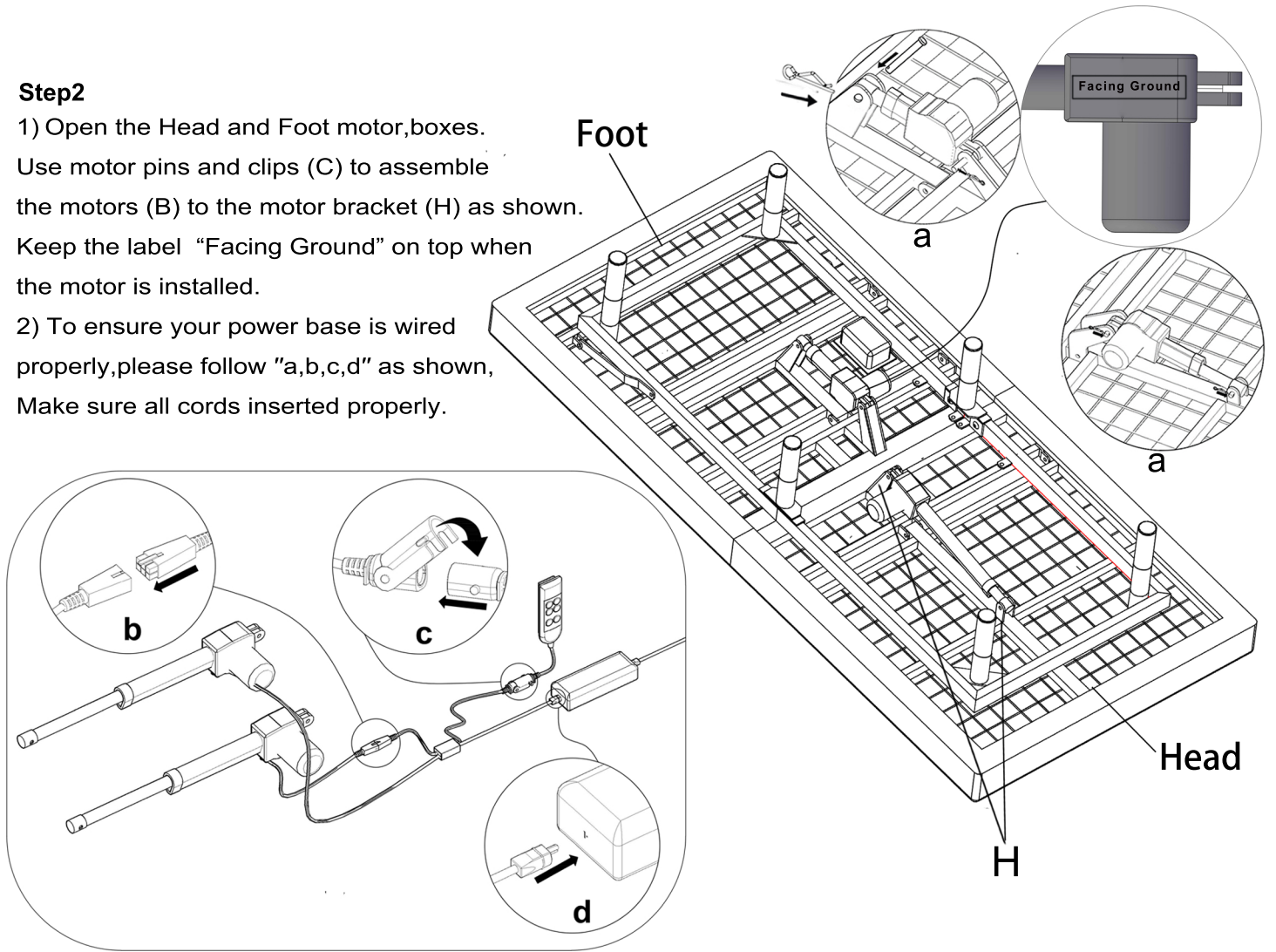

## Step3

- Filp over the bed and insert mattress bar into the bed frame.  
Your Adjustable Base is how completely assembled.

## Motor Replacement:

If a motor needs to be replaced,remove the motor pin and clip from motor bracket to replace.the motor.

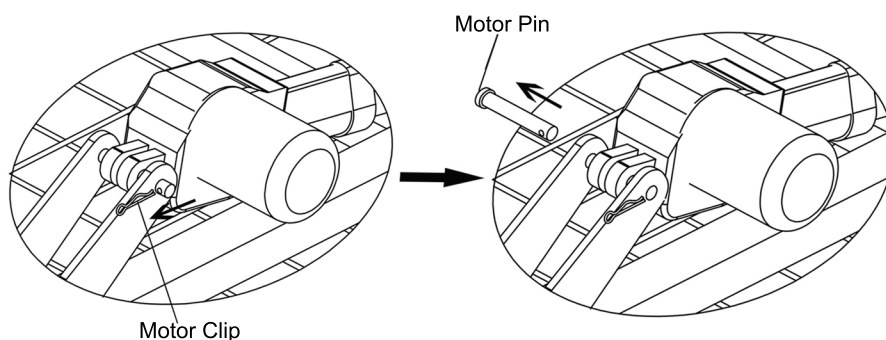

# Accessory Instruction

## Wired Remote

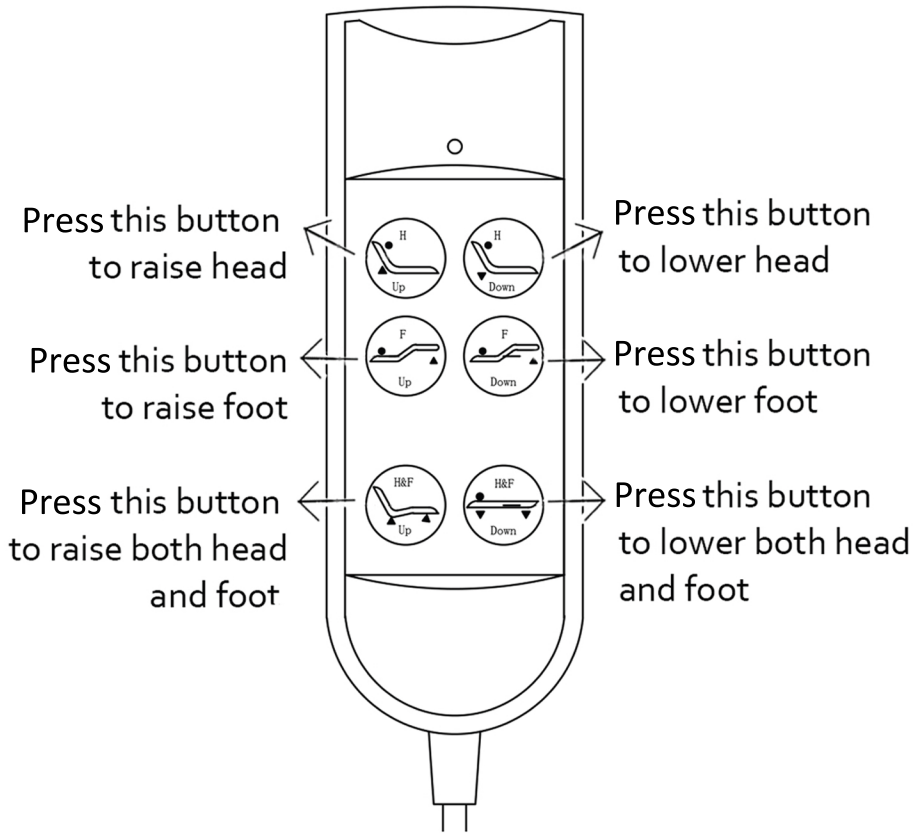

**MOTOR**



**POWER Converter**

## TROUBLE SHOOTING

- A. If there is no power, insure all cables are properly connected, the plug is securely in the power outlet, and the outlet has power.
- B. If the LED power indicator light on the transformer is not on, the transformer needs to be replaced.
- C. If both LED power indicator lights are on and there is no power, the motor needs to be replaced.

# WARNING

**To reduce the risk of burns, fire, electric shock, or injury to persons:**

- Unplug the base from the outlet before adding or removing accessories.
- Close supervision is necessary when this base is used by, or near children, disable persons, or pets
- Use this base only for its intended use as described in these instructions. Do not use attachments not recommended by the manufacturer.
- Never operate this base if it has a damaged cord or plug, if it's not working properly, has been dropped or damaged, or dropped in water.
- Keep the cord away from heated surfaces.
- Never drop or insert any object into any opening.
- Do not operate where aerosol (spray) products are being used or where oxygen is being administered. Do not use near explosive gases.
- To disconnect, remove plug from outlet.